

- △ MAINE HOUSING CONCEPT SUBMISSION 02-01-2011
- △ HISTORIC PRESERVATION SUBMISSION 03-23-2011
- △ 50% MAINEHOUSING REVIEW 04-01-2011
- △ 90% MAINEHOUSING REVIEW 06-03-2011
- △ NPS SUBMISSION 07-01-2011
- △ ISSUED SEPTEMBER 8, 2011

NOTE:
PROVIDE LOCKABLE RATED ACCESS DOORS
IN CLOSETS ADJACENT VERTICAL SHAFTS
FOR FIRE DAMPER MAINTENANCE EACH
FLOOR AS REQUIRED.

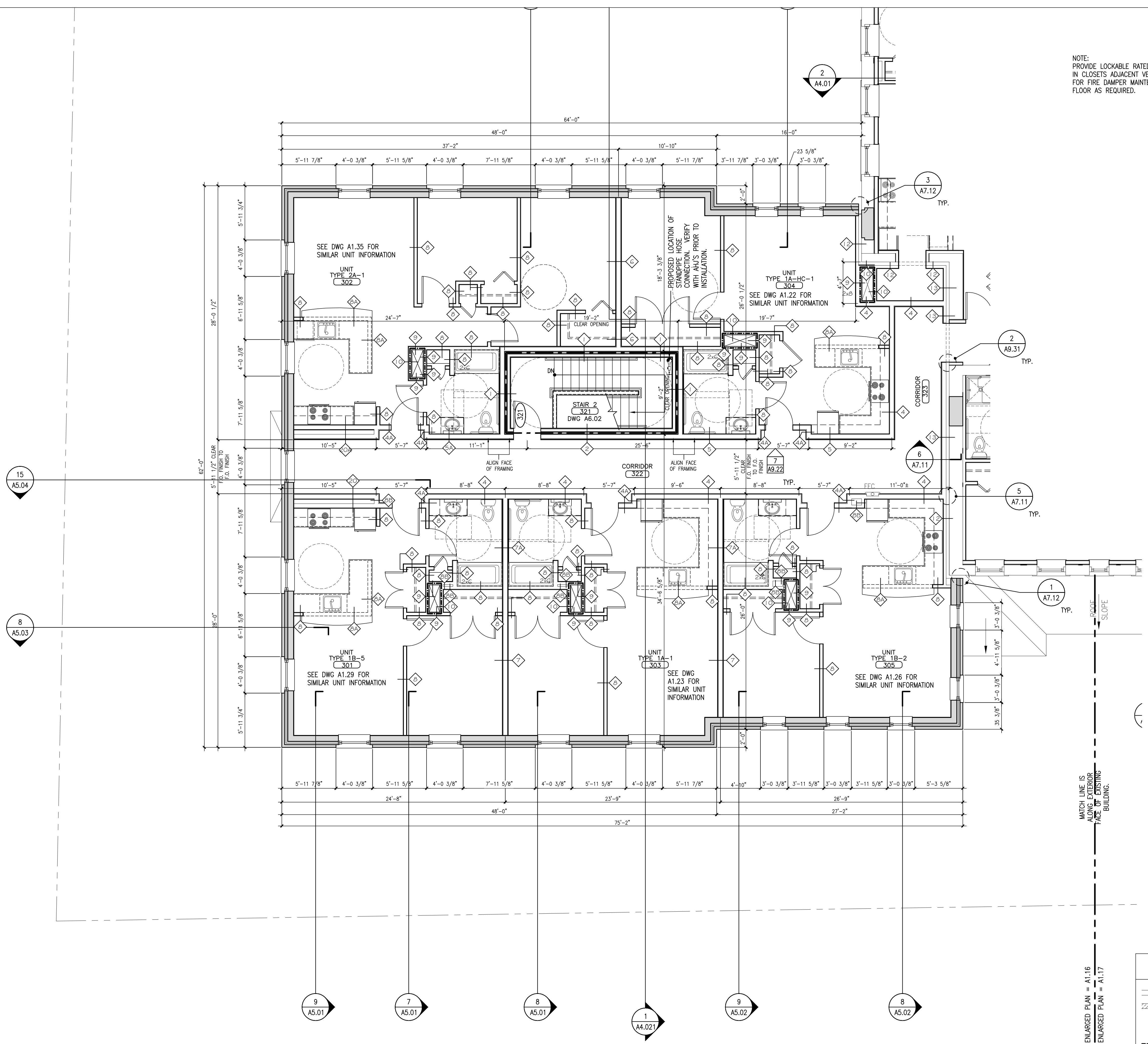

WALL PARTITION LEGEND

	= EXISTING WALL/PARTITION ASSEMBLY TO REMAIN
	= EXISTING HISTORICAL SIGNIFICANT WALL/PARTITION ASSEMBLY TO REMAIN AS IS. • ANY WORK IMPACTING THESE WALLS/PARTITIONS MUST BE AUTHORIZED BY OWNER/ARCHITECT AND HISTORICAL REVIEW TEAM
	= EXISTING WALL/PARTITION TO BE REMOVED. • OTHER DASHED ITEMS WITHIN REMOVALS PLANS ARE ALSO TO BE REMOVED. • REFERENCE REMOVAL PLANS AND NOTES.
	= NEW WALL/PARTITION ASSEMBLY. • REFERENCE PARTITION SCHEDULE
	= INDICATES FIRE RATED WALL/PARTITION ASSEMBLY. • REFERENCE PARTITION SCHEDULE

1 ENLARGED THIRD FLOOR PLAN - NEW ADDITION

SCALE: 3/16" = 1'-0"