

**City of Portland, Maine - Building or Use Permit Application**

389 Congress Street, 04101 Tel: (207) 874-8703, Fax: (207) 874-8716

Permit No: 03-1029	Issue Date:	CBL: 044 E014001
-----------------------	-------------	---------------------

Location of Construction: 45 Brackett St	Owner Name: Pohl Leslie N &	Owner Address: 45 Brackett St Apt 2	Phone:
Business Name:	Contractor Name: Mackenzie, Stephen	Contractor Address: 74 Gertrude Ave Portland	Phone: 2077977706
Lessee/Buyer's Name	Phone:	Permit Type: HVAC	Zone: R6

Past Use: Two Unit	Proposed Use: Two Unit w/oil heating system, 330 gal. tank in basement	Permit Fee: \$75.00	Cost of Work: \$5,300.00	CEO District: 3
Proposed Project Description: Install Oil Heating System in Basement/330 Gallon Tank  <i>legal allowable use: R D.U. only</i>		FIRE DEPT: <input type="checkbox"/> Approved <input type="checkbox"/> Denied	INSPECTION: Use Group: <input checked="" type="checkbox"/> Type: Heating <i>BOX A 1993 Mechanical</i>	
		Signature:	Signature: <i>[Signature]</i>	
PEDESTRIAN ACTIVITIES DISTRICT (P.A.D.)				
Action: <input type="checkbox"/> Approved <input type="checkbox"/> Approved w/Conditions <input type="checkbox"/> Denied				
Signature: _____ Date: _____				

Permit Taken By: gad	Date Applied For: 08/25/2003	<b>Zoning Approval</b>
-------------------------	---------------------------------	------------------------

1. This permit application does not preclude the Applicant(s) from meeting applicable State and Federal Rules.  2. Building permits do not include plumbing, septic or electrical work.  3. Building permits are void if work is not started within six (6) months of the date of issuance. False information may invalidate a building permit and stop all work..	Special Zone or Reviews <input type="checkbox"/> Shoreland <input type="checkbox"/> Wetland <input type="checkbox"/> Flood Zone <input type="checkbox"/> Subdivision <input type="checkbox"/> Site Plan Maj <input type="checkbox"/> Minor <input type="checkbox"/> MM <input type="checkbox"/>	Zoning Appeal <input type="checkbox"/> Variance <input type="checkbox"/> Miscellaneous <input type="checkbox"/> Conditional Use <input type="checkbox"/> Interpretation <input type="checkbox"/> Approved <input type="checkbox"/> Denied	Historic Preservation <input type="checkbox"/> Not in District or Landmark <input type="checkbox"/> Does Not Require Review <input type="checkbox"/> Requires Review <input type="checkbox"/> Approved <input type="checkbox"/> Approved w/Conditions <input type="checkbox"/> Denied
	Date: <i>9/25/03</i>		Date:

**CERTIFICATION**

I hereby certify that I am the owner of record of the named property, or that the proposed work is authorized by the owner of record and that I have been authorized by the owner to make this application as his authorized agent and I agree to conform to all applicable laws of this jurisdiction. In addition, if a permit for work described in the application is issued, I certify that the code official's authorized representative shall have the authority to enter all areas covered by such permit at any reasonable hour to enforce the provision of the code(s) applicable to such permit.

\_\_\_\_\_  
SIGNATURE OF APPLICANT ADDRESS DATE PHONE

\_\_\_\_\_  
RESPONSIBLE PERSON IN CHARGE OF WORK, TITLE DATE PHONE



FILL IN AND SIGN WITH INK 03-1029

# APPLICATION FOR PERMIT HEATING OR POWER EQUIPMENT

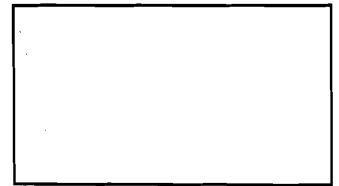

044 E 014

To the INSPECTOR OF BUILDINGS, PORTLAND, ME.

The undersigned hereby applies for a permit to install the following heating, cooking or power equipment in accordance with the Laws of Maine, the Building Code of the City of Portland, and the following specifications:

Location / CBL 45 BRACKET ST Use of Building APART. Bld Date 8/24/03

Name and address of owner of appliance ROBERT FISKE 45 BRACKET ST.

Installer's name and address Steve Mackenzie Heating  
74 Gorham Ave. Port. 04103 Telephone 797-7706

### Location of appliance:

- Basement
- Attic
- Floor
- Roof

### Type of Fuel:

- Gas
- Oil
- Solid

### Appliance Name:

Peerless

U.L. Approved  Yes  No

Will appliance be installed in accordance with the manufacture's installation instructions?  Yes  No

IF NO Explain: \_\_\_\_\_

### The Type of License of Installer:

- Master Plumber # \_\_\_\_\_
- Solid Fuel # \_\_\_\_\_
- Oil # 1340
- Gas # \_\_\_\_\_
- Other \_\_\_\_\_

### Type of Chimney:

- Masonry Lined  
Factory built \_\_\_\_\_
- Metal  
Factory Built U.L. Listing # \_\_\_\_\_
- Direct Vent  
Type \_\_\_\_\_ UL# \_\_\_\_\_

### Type of Fuel Tank

- Oil
- Gas

Size of Tank 330

Number of Tanks 1

Distance from Tank to Center of Flame 20 feet.

Cost of Work: \$ 5300 -

Permit Fee: \$ 75.00

### Approved

### Approved with Conditions

Fire: \_\_\_\_\_  
 Ele.: \_\_\_\_\_  
 Bldg.: \_\_\_\_\_

See attached letter of requirement

Inspector's Signature

Date Approved

Signature of Installer

*[Handwritten Signature]*

White - Inspection    Yellow - File    Pink - Applicant's    Gold - Assessor's Copy

# REAL ESTATE ASSESSMENT RECORD - CITY OF PORTLAND, MAINE

CURR. DESC.	LAND NOS.	STREET	BLDG. NO.	CARD NO.	DEVELOPMENT NO.	AREA	DIST.	ZONE	CHART	BLOCK	LOT	CURR. DESC.
	43	Brackett	42	OF			1		44	E	11	

TAXPAYER ADDRESS AND DESCRIPTION	RECORD OF TAXPAYER	YEAR	BOOK	PAGE	PROPERTY FACTORS			
BRANNING LOUISE B LANE 65 BRACKETT STREET CITY  REAL ESTATE-PORTLAND ME ASSESSORS PLANS ON FILE IN ASSESSORS OFFICE CITY HALL PLAN 44-E-14 BRACKETT ST #43 AREA 2073 SQ FT				TOPOGRAPHY		IMPROVEMENTS		
	LEVEL				<input checked="" type="checkbox"/>	WATER		
	HIGH					SEWER		
	LOW					GAS		
	ROLLING					ELECTRICITY		
	SWAMPY					ALL UTILITIES <input checked="" type="checkbox"/>		
	STREET				TREND OF DISTRICT			
	PAVED				<input checked="" type="checkbox"/>	IMPROVING		
	SEMI-IMPROVED					STATIC <input checked="" type="checkbox"/>		
	DIRT					DECLINING		
SIDEWALK					<input checked="" type="checkbox"/>			
TILLABLE					PASTURE	WOODED	WASTE	

FRONTAGE	DEPTH	UNIT PRICE	DEPTH FACTOR	FRONT FT. PRICE	YEAR 1951	19
91	60	332	80	1850	720	
TOTAL VALUE LAND					590	
TOTAL VALUE BUILDINGS					2800	
TOTAL VALUE LAND AND BUILDINGS					3390	
SQ. FT. TO-FROM CH.		BLK.	LOT			
SQ. FT. TO-FROM CH.		BLK.	LOT			

FRONTAGE	DEPTH	UNIT PRICE	DEPTH FACTOR	FRONT FT. PRICE	19	19
TOTAL VALUE LAND						
TOTAL VALUE BUILDINGS						
TOTAL VALUE LAND AND BUILDINGS						
SQ. FT. TO-FROM CH.		BLK.	LOT			
SQ. FT. TO-FROM CH.		BLK.	LOT			

FRONTAGE	DEPTH	UNIT PRICE	DEPTH FACTOR	FRONT FT. PRICE	19	19
TOTAL VALUE LAND						
TOTAL VALUE BUILDINGS						
TOTAL VALUE LAND AND BUILDINGS						
SQ. FT. TO-FROM CH.		BLK.	LOT			
SQ. FT. TO-FROM CH.		BLK.	LOT			

YEAR	ORIG. COST	RENTAL	720
YEAR	SALE PRICE	EXPENSE	-
YEAR	U. S. R. S.	NET	720

FRONTAGE	DEPTH	UNIT PRICE	DEPTH FACTOR	FRONT FT. PRICE	19	19
TOTAL VALUE LAND						
TOTAL VALUE BUILDINGS						
TOTAL VALUE LAND AND BUILDINGS						
SQ. FT. TO-FROM CH.		BLK.	LOT			
SQ. FT. TO-FROM CH.		BLK.	LOT			

FRONTAGE	DEPTH	UNIT PRICE	DEPTH FACTOR	FRONT FT. PRICE	19	19
TOTAL VALUE LAND						
TOTAL VALUE BUILDINGS						
TOTAL VALUE LAND AND BUILDINGS						
SQ. FT. TO-FROM CH.		BLK.	LOT			
SQ. FT. TO-FROM CH.		BLK.	LOT			

FRONTAGE	DEPTH	UNIT PRICE	DEPTH FACTOR	FRONT FT. PRICE	19	19
TOTAL VALUE LAND						
TOTAL VALUE BUILDINGS						
TOTAL VALUE LAND AND BUILDINGS						
SQ. FT. TO-FROM CH.		BLK.	LOT			
SQ. FT. TO-FROM CH.		BLK.	LOT			

ASSESSMENT RECORD		INCREASE	DECREASE
1950	LAND	225	
	BLDGS.	1075	
	TOTAL	1300	
1951	LAND	350	
	BLDGS.	1675	
	TOTAL	2025	
195	LAND		
	BLDGS.		
	TOTAL		
19	LAND		
	BLDGS.		
	TOTAL		
19	LAND		
	BLDGS.		
	TOTAL		
19	LAND		
	BLDGS.		
	TOTAL		
19	LAND		
	BLDGS.		
	TOTAL		
19	LAND		
	BLDGS.		
	TOTAL		

# RECORD OF BUILDINGS

GRADE DENOTES QUALITY OF CONSTRUCTION: A—EXCELLENT; B—GOOD; C—AVERAGE; D—CHEAP; E—VERY CHEAP

YEAR 19

YEAR 19

*1st 360  
2nd 360  
720*

*1/2 52-532-1 ARW*

## CONSTRUCTION

FOUNDATION	FLOOR CONST.	PLUMBING
CONCRETE	WOOD JOIST ✓	BATHROOM 2 ✓
CONCRETE BLOCK	STEEL JOIST	TOILET ROOM
BRICK OR STONE ✓	MILL TYPE	WATER CLOSET
PIERS	REIN. CONCRETE	LAVATORY
CELLAR AREA FULL ✓	<b>FLOOR FINISH</b>	KITCHEN SINK 2 ✓
1/4 1/2 3/4	B 1 2 3	STD. WAT. HEAT 2 ✓
NO. CELLAR	CEMENT ✓	AUTO. WAT. HEAT
<b>EXTERIOR WALLS</b>	EARTH	ELECT. WAT. SYST.
CLAPBOARD'S ✓	PINE ✓✓	LAUNDRY TUBS
WIDE SIDING	HARDWOOD	NO PLUMBING
DROP SIDING	TERRAZZO	<b>TILING</b>
NO SHEATHING	TILE	BATH FL. & WCOT.
WOOD SHINGLES		TOILET FL. & WCOT.
ASBES. SHINGLES		<b>LIGHTING</b>
STUCCO ON FRAME	<b>ATTIC FLR. &amp; STAIRS</b> ✓	ELECTRIC ✓
STUCCO ON TILE	<b>INTERIOR FINISH</b>	NO LIGHTING
BRICK VENEER	B 1 2 3	NO. OF ROOMS
BRICK ON TILE	PINE ✓✓	BSMT. 2ND 4
SOLID BRICK	HARDWOOD	1ST 4 3RD
STONE VENEER	PLASTER ✓✓	<b>OCCUPANCY</b>
CONC. OR CIND. B.L.	UNFINISHED ✓	SINGLE FAMILY
	METAL CLG.	TWO FAMILY ✓
		APARTMENT
TERRA COTTA		STORE
VITROLITE	RECREAT. ROOM	THEATRE
PLATE GLASS	FINISHED ATTIC 50% ✓	HOTEL
INSULATION	FIREPLACE	OFFICES
WEATHERSTRIP	<b>HEATING</b>	WAREHOUSE
<b>ROOFING</b>	PIPELESS FURNACE	COMM. GARAGE
ASPH. SHINGLES ✓	HOT AIR FURNACE	GAS STATION
WOOD SHINGLES	FORCED AIR FURN.	<b>ECONOMIC CLASS</b>
ASBES. SHINGLES	STEAM	OVER BUILT
SLATE TILE	HOT WAT. OR VAPOR ✓	UNDER BUILT
METAL	NO HEATING	DT 6-19-50 AR. 10M
COMPOSITION		LD. 5 PD. 11M
ROLL ROOFING	GAS BURNER	MS. CK. 3L
INSULATION	OIL BURNER	
	STOKER	

## COMPUTATIONS

UNIT	1951				
1082 S. F.	5730				
S. F.					
ADDITIONS	+ 370				
BASEMENT					
WALLS					
ROOF					
FLOORS					
ATTIC 1/2	+ 260				
FINISH					
FIREPLACE					
HEATING	- 650				
PLUMBING	+ 350				
TILING					
MF+10%	+ 570				
TOTAL	4630				
FACT.+5	+ 290				
REP. VAL.	6920 ✓				

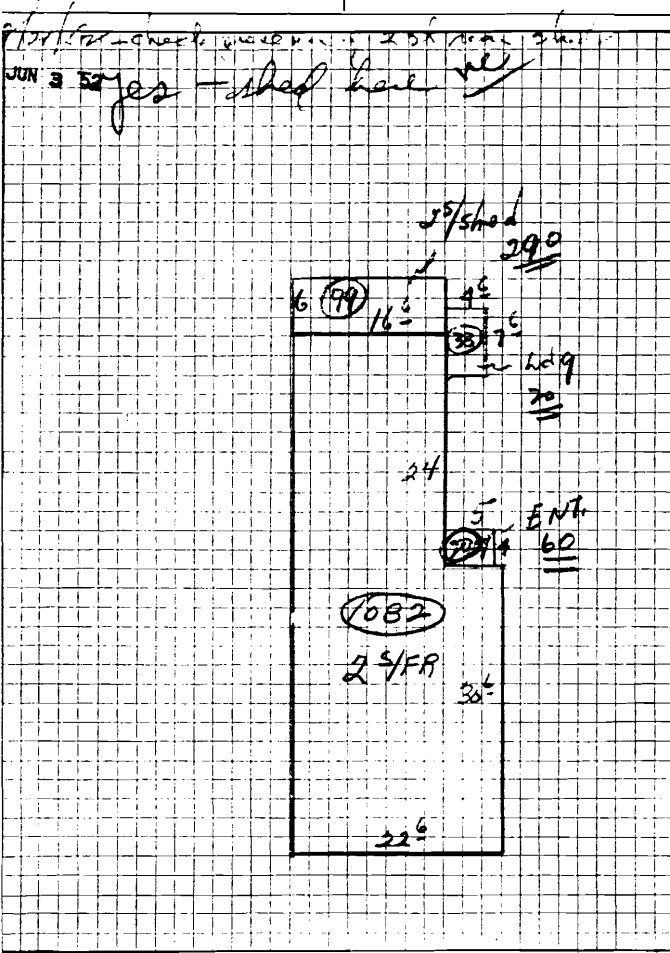

## SUMMARY OF BUILDINGS

OCC Y	TYPE	GR.	AGE	REMOD.	COND.	REP. VAL.	P. D.	PHY. VAL.	F. D.	SOUND VAL.	TAX VAL.	Y.
Dwg	2 5/8 FR	C			F-P	6920	55%	3110	14%	2800	1171	
A												
B												
C												
D												
E												
F												
G												

YEAR	1951	1951 TOTAL BLDGS.			
TAX VAL.					
OLD VAL.					
CHANGE					

PORTLAND STREET DIRECTORY—1955

759

John P Calvert Δ4-2302  
Mrs Maria Pesce © Δ3-6805  
Sebastian Pennisi Δ3-6805  
Richard M Andersen Δ2-0612  
(rear) John J DiSanto  
Francis F Buck  
Emery S Nute  
Emery S Nute jr  
**HEATH STREET begins**  
Mrs Yvonne M Hoffman  
Henry D Williams Δ5-1198  
Kenneth T Forbes  
William R Delaney gro and h ©  
Bayside Candy Kitchen  
Mrs Annie M Walsh  
Henry E Remington  
Frederick A Holt  
Mrs V Grace Stone © Δ2-7515  
Vacant  
Earl W Leclair  
Warren E Peavey  
Clarence E Wildes  
Mrs Elizabeth C Tuttle  
Vacant  
**LANCASTER STREET crosses**  
Bayside Junk Shop Δ5-0872  
Bayside Motors  
Harrison F Crockett  
**BAYSIDE PARK**  
**FOX STREET crosses**  
Capitol Motor Transportation Co  
Inc Δ4-1477  
**PTCo RR TRACKS**

**BOYNTON STREET  
WARD 7**

Weymouth to 21 Forest  
Vacant  
Mrs Madelene Maley  
Gerard J Paulin Δ3-1492  
Earl P Jensen Δ2-8801  
Oscar P Spencer © Δ4-3336  
Noyes E O'Brien  
Amos E Corliss apt 1 Δ3-3900  
Esther M Noel  
George B Silverman © Δ3-6546  
Sherman Kelley ©  
Robert A Verrier warehouse  
Richard P Connolly © Δ3-7391  
Phillip M O'Connor  
Leslie Ricker  
Dominic R Donatelli Δ2-5604  
James J Finley jr  
Benjamin B Robinson Δ2-3418  
Donald W Goodwin Δ3-3530  
John P O'Brien jr Δ2-8722  
Douglas J Goodwin  
Verna L Graham Δ3-8427  
Lesse E Edgerton  
Leon Southard  
Kenneth R McKenney © Δ2-5056  
Alfred J Alward  
Leonard C West Δ4-6486  
Edward D Dougherty Δ2-8840  
Arthur E Ray  
Rayton C Robinson

**5TH AVENUE—PEAKS ISLAND**  
near Forest City landing  
Sea Shore av

**BRACKETT STREET  
WARDS 6, 7**

of Portland bridge to 25 Arse-  
Johnson Automatic Heat  
Δ3-9662  
Thomas J O'Malley  
Edward A Cahill  
Eagle Bleach Water Co Δ4-4879  
Vacant  
Century House used furn & an-  
tiques  
Mary S Clark Δ4-9252  
E M Clark  
**YORK STREET crosses**  
Martin Oliver radio and televi-  
sion  
Edward E Fisher ©  
Vacant  
**EMMER STREET begins**  
Erick F Ridge  
Stephen Noonan Δ3-9074  
Andrew A Walsh © Δ3-1558  
Joseph A Labbe ©

Left Right  
40 Bronick J Batura Δ5-0143  
Mrs Margaret H Conley Δ3-0686  
Mrs Malvina Batura  
41 John J Concannon  
Everett P Connolly  
42 Frederick J Thompson Δ2-2326  
Malachi H Craven Δ4-2171  
44 Edward S Dzialga  
Elias J Radzuez © Δ3-0800  
45 John Works  
William A Glendenning ©  
47 Mary A Hayes  
William R Shuman  
48 Albenie J Bourgeois  
James S Taylor  
Joseph Porter Δ3-3636  
49 John A Griffin Δ4-9598  
Patrick J Flinnerty ©  
Raymond L Hayward  
50 Linwood A Weeman  
51 Delmont H Murphy  
53 Benjamin T Andrew  
Vincent W Kane  
54 **SALEM STREET begins**  
55 Mrs Margaret F Fogg  
55a John C O'Donnell Δ4-2718  
Michael T Mullen Δ4-6540  
56 Joseph J Mulhern Δ3-4380  
57 Mrs Catherine Joyce  
Matthew J Riley Δ2-625  
57a John R King Δ4-0615  
59 Coleman J Kane  
59a James J Thornton  
Mrs Frances T Murphy Δ2-3544  
Robert F O'Brien  
Ivan E Bell  
Mrs Glenice B Randell  
61 Mrs Mary Joyce  
Nehemiah I Connor Δ4-1628  
61a Michael B Jennings Δ4-3316  
Mrs Josephine Thomas ©  
(rear) Frank J Thomas Δ2-6435  
William A Lyden  
64 Adam Romano  
James McDonough Δ3-7162  
64½ Harold J Dibble Δ3-9004  
John Curran  
67 Carl J Kittleson Δ3-0364  
James P Feeney  
Martin J Feeney  
Evelyn F Connors  
Mrs Theresa S DuPont  
70 **DANFORTH STREET crosses**  
73 Fred A Canavan apt 1 Δ5-0353  
Ella M Robbins apt 2  
Catherine E Kemp apt 3  
Francis J Mantak apt 4  
Mrs Grace A Harmon apt 5  
Katherine M Denaco apt 6  
(rear) Jessie Moody  
79 Conrad Tardiff  
80 John J Foley Δ3-7835  
82 John J Foley  
Peter Foley © Δ3-6746  
83 Robert L Dow  
Leroy E Day  
84 Mary F Foley Δ4-3284  
(rear) Stanley M Kopack  
Mrs Nellie Kopack © Δ3-3531  
85 David A Burns  
Louis B Ackerman © Δ3-1271  
Idella Cady  
Joseph Ambrozewicz  
(rear) Steven H Cavies  
Esther Maines  
89 F & R Variety Store Δ3-9218  
Mrs Sadie R. Wilson  
Thomas J Foley  
David A McKenzie © Δ3-7756  
92 **GRAY STREET crosses**  
103 Lewis U. Greene ptr and h ©  
Δ4-2311  
104 Raymond W Young Δ4-6003  
105 Charles N Barton  
(rear) Charles W Upham Δ5-1776  
107 Eugene B Leclair  
Mrs Julie Young  
Catherine Beaulieu  
108 Henry A Prince Δ4-5280  
John J DiMatteo  
Daniel S MacDonald  
109 Lewis J Brown Δ3-3324  
Donald R Trask Δ2-6300  
110 Frank G Bean  
George E Spires  
Elli Roma  
111 Thomas J Dario  
Vacant  
112 Peter J Griffin  
113 Kingman P Noyes  
114 Vacant Store

Left Right  
114a Charles H Talbot Δ2-3857  
(rear) Edith M Kelsey pract  
nurse and h Δ4-9254  
115 Mrs Mary E Campbell  
Mrs Mary A Flaherty © Δ2-8862  
116 **DERMOT COURT begins**  
117 Nelson L Briggs  
118 Harry M Miller Δ3-4865  
119 Lance G Logan  
Vacant  
120 Mrs Millicent A Peabody 3-4240  
121 Wilfred E Ferante  
Vacant  
Mary Primrose  
Merle Stubbs  
Frank Paro  
Clifford H Keating Δ2-7066  
122 Vacant  
122a Edward F Paro  
124 Lola McLeister apts and h  
124a Frank S Cole  
123-130 Leslie Osteen  
Kenneth Radley  
Frank H Roberts  
Frederick Lambert  
Earl Crawford  
Warren Waterhouse  
Arthur Greene  
132 **SPRING STREET crosses**  
135 Edward I Kilbride Δ3-6752  
George W Bourne © Δ3-2274  
Eugene A Wakefield  
Raymond A MacDonald  
136 Mrs Jennie S Marr © Δ4-3767  
138 Edith R Small Δ3-2121  
139 Linwood R Libby  
Lulu B Shepley  
Mrs Della G York  
John Anderson  
Arthur W Guptill  
Bryan E Egan  
143 The 7 rle Club Inc stamp dirs  
Δ5-0400  
Fortunato Pompeo  
Helen T Strout  
144 Ezra F Ferris © Δ4-8050  
145 Russell L Reynolds  
146 Ralph E Dunnell Δ3-2468  
**SPRUCE STREET begins**  
147 Vacant  
Cecil Currie bldg contr and h ©  
Δ2-7254  
George I Williamson  
149 Lee H Jones apts  
Ralph Bowden apt 1  
Chester E Butler apt 2  
Vacant apt 3  
Vacant apt 4  
Albert E Blackton apt 5  
William Palmer apt 6  
Harry Sclar Δ4-5351  
152 Rebecca R Robbins drsmkr and  
h  
Mrs Mary Mitchell  
Patrick Richards  
153 Aller Dress Co Inc clothing mfrs  
Δ3-7022  
156 Ralph W Casso © Δ2-3320  
Elizabeth Gott  
Andrew L Calderwood Δ3-0660  
Albert Hussey  
Irving W Soule jr  
Richard V Credford Δ3-1445  
162 William J Winslow  
Joseph Verrocchi  
Portland Fire Dept Ladder 3  
— **JOY PLACE begins**  
164 Claude C Bowlin  
William H DeMille  
Vernon S Irish Δ4-8733  
165 Bertha Poulin  
Nora J Forestell  
David F Avery  
167 Herbert C Leighton Δ3-2378  
168 Carrie L Gordon © Δ2-1723  
**VARNUM STREET begins**  
169 Joseph M Green  
170 Rev Herbert B Pulsifer ©  
Δ3-9448  
170a Edward T Pulsifer Δ3-4535  
172 Danforth S Hersey  
172a Robert H Dollitt Δ3-5807  
173 Leo M Godin ©  
Gertrude Prew  
Leonard B Cain  
175 Moulton's Garage Inc Δ5-1532  
(rear) Samuel Alley jr auto  
washing  
176 Star Theatrical Enterprises Sup-  
plies & equip Δ3-9520  
178 Charles M Patton Δ4-8067

FLOWERS - WALLACE'S GREENHOUSES

**City of Portland, Maine - Building or Use Permit**

389 Congress Street, 04101 Tel: (207) 874-8703, Fax: (207) 874-8716

<b>Permit No:</b> 03-1029	<b>Date Applied For:</b> 08/25/2003	<b>CBL:</b> 044 E014001
------------------------------	--	----------------------------

<b>Location of Construction:</b> 45 Brackett St	<b>Owner Name:</b> Pohl Leslie N &	<b>Owner Address:</b> 45 Brackett St Apt 2	<b>Phone:</b>
<b>Business Name:</b>	<b>Contractor Name:</b> Mackenzie, Stephen	<b>Contractor Address:</b> 74 Gertrude Ave Portland	<b>Phone</b> (207) 797-7706
<b>Lessee/Buyer's Name</b>	<b>Phone:</b>	<b>Permit Type:</b> HVAC	

<b>Proposed Use:</b> Two Unit w/oil heating system, 330 gal. tank in basement	<b>Proposed Project Description:</b> Install Oil Heating System in Basement/330 Gallon Tank
--	--

**Dept:** Zoning      **Status:** Approved with Conditions      **Reviewer:** Marge Schmuckal      **Approval Date:** 09/25/2003**Note:** The number of dwelling units (3) can not be confirmed. The microfiche and the assessors and the 1955 directory says two units      **Ok to Issue:** 

- 1) This is NOT an approval for an additional dwelling unit. You SHALL NOT add any additional kitchen equipment including, but not limited to items such as stoves, microwaves, refrigerators, or kitchen sinks, etc. Without special approvals.
- 2) This property shall remain a two (2) family dwelling. Any change of use shall require a separate permit application for review and approval.

**Dept:** Building      **Status:** Approved with Conditions      **Reviewer:** Tammy Munson      **Approval Date:** 09/30/2003**Note:**      **Ok to Issue:** 

- 1) Installation shall comply with 1993 BOCA Mechanical Code and State of Maine Oil and Solid Fuel Board Laws and Rules