

DISPLAY THIS CARD ON PRINCIPAL FRONTAGE OF WORK

# CITY OF PORTLAND

BUILDING DEPARTMENT

## PERMIT

Permit Number: 091339

### PERMIT ISSUED

Please Read Application And Notes, If Any, Attached

This is to certify that NILES STEPHEN M & HOLLY SHEEHAN Bio-safe Env  
has permission to adding roof trusses sister on to existing roof within existing footprint  
AT 49 BRACKETT ST CB# 044 E018001 NOV 23 2009

provided that the person or persons, firm or corporation accepting this permit shall comply with all of the provisions of the Statutes of Maine and of the Ordinances of the City of Portland regulating the construction, maintenance and use of buildings and structures, and of the application on file in this department.

Apply to Public Works for street line and grade if nature of work requires such information.

Notification of inspection must be given and written permission procured before this building or part thereof is lathed or otherwise finished-in. 24 HOUR NOTICE IS REQUIRED.

A certificate of occupancy must be procured by owner before this building or part thereof is occupied.

**OTHER REQUIRED APPROVALS**

Fire Dept. \_\_\_\_\_  
Health Dept. \_\_\_\_\_  
Appeal Board \_\_\_\_\_  
Other \_\_\_\_\_  
Department Name

*Thomas M. Moulton* 11/23/09  
Director - Building & Inspection Services

**PENALTY FOR REMOVING THIS CARD**

**City of Portland, Maine - Building or Use Permit Application**  
 389 Congress Street, 04101 Tel: (207) 874-8703, Fax: (207) 874-8716

Permit No: 09-1339	Issue Date:	CBL: 044 E018001
-----------------------	-------------	---------------------

Location of Construction: 49 BRACKETT ST	Owner Name: NILES STEPHEN M & HOLLY J S	Owner Address: 231 MAINE AVE	Phone:
Business Name:	Contractor Name: Bio-safe Enviromental Services	Contractor Address: 5 Delta Drive Westbrook	Phone 2076326165
Lessee/Buyer's Name	Phone:	Permit Type: Alterations - Dwellings	Zone: R-7

Past Use: Single Family Home	Proposed Use: Single Family Home - adding roof trusses sister on to existing roof within existing footprint	Permit Fee: \$190.00	Cost of Work: \$16,500.00	CEO District: 2
Proposed Project Description: adding roof trusses sister on to existing roof within existing footprint		FIRE DEPT: <input type="checkbox"/> Approved <input type="checkbox"/> Denied	INSPECTION: Use Group: R3 Type: 5B IRC 2003	
		Signature: <i>Jm 11/23/09</i>		Signature: <i>Jm 11/23/09</i>
PEDESTRIAN ACTIVITIES DISTRICT (P.A.D.)				
Action: <input type="checkbox"/> Approved <input type="checkbox"/> Approved w/Conditions <input type="checkbox"/> Denied				
Signature: _____ Date: _____				

Permit Taken By: Ldobson	Date Applied For: 11/23/2009
-----------------------------	---------------------------------

**Zoning Approval**

- This permit application does not preclude the Applicant(s) from meeting applicable State and Federal Rules.
- Building permits do not include plumbing, septic or electrical work.
- Building permits are void if work is not started within six (6) months of the date of issuance. False information may invalidate a building permit and stop all work..

<b>Special Zone or Reviews</b> <input type="checkbox"/> Shoreland <input type="checkbox"/> Wetland <input type="checkbox"/> Flood Zone <input type="checkbox"/> Subdivision <input type="checkbox"/> Site Plan Maj <input type="checkbox"/> Minor <input type="checkbox"/> MM <input type="checkbox"/> Date: <i>Jm</i>	<b>Zoning Appeal</b> <input type="checkbox"/> Variance <input type="checkbox"/> Miscellaneous <input type="checkbox"/> Conditional Use <input type="checkbox"/> Interpretation <input type="checkbox"/> Approved <input type="checkbox"/> Denied Date: _____	<b>Historic Preservation</b> <input checked="" type="checkbox"/> Not in District or Landmark <input checked="" type="checkbox"/> Does Not Require Review <input type="checkbox"/> Requires Review <input type="checkbox"/> Approved <input type="checkbox"/> Approved w/Conditions <input type="checkbox"/> Denied Date: <i>Jm 11/23/09</i>
---	---	--

**PERMIT ISSUED**

NOV 23 2009

City of Portland

**CERTIFICATION**

I hereby certify that I am the owner of record of the named property, or that the proposed work is authorized by the owner of record and that I have been authorized by the owner to make this application as his authorized agent and I agree to conform to all applicable laws of this jurisdiction. In addition, if a permit for work described in the application is issued, I certify that the code official's authorized representative shall have the authority to enter all areas covered by such permit at any reasonable hour to enforce the provision of the code(s) applicable to such permit.

SIGNATURE OF APPLICANT	ADDRESS	DATE	PHONE
RESPONSIBLE PERSON IN CHARGE OF WORK, TITLE		DATE	PHONE



# General Building Permit Application

If you or the property owner owes real estate or personal property taxes or user charges on any property within the City, payment arrangements must be made before permits of any kind are accepted.

Location/Address of Construction: <u>49 Brackett St. Portland Me.</u>		
Total Square Footage of Proposed Structure/Area	Square Footage of Lot	Number of Stories <u>2</u>
Tax Assessor's Chart, Block & Lot Chart# <u>44</u> Block# <u>E</u> Lot# <u>18</u>	Applicant * <u>must be owner, Lessee or Buyer</u> * Name <u>Biosafe Environmental</u> Address <u>5 Delta Dr.</u> City, State & Zip <u>Westbrook Me 04092</u>	Telephone: <u>207 632-6145</u>
Lessee/DBA (If Applicable)	Owner (if different from Applicant) Name <u>Steve Niles</u> Address <u>49 Brackett St.</u> City, State & Zip <u>Port Me 04101</u>	Cost Of Work: \$ <u>16,500.00</u> C of O Fee: \$ _____ Total Fee: \$ <u>190</u>
Current legal use (i.e. single family) <u>Single Family</u> Number of Residential Units <u>1</u> If vacant, what was the previous use? <u>N/A</u> Proposed Specific use: <u>Single Family</u> Is property part of a subdivision? <u>NO</u> If yes, please name _____ Project description: <u>Existing 2x4" by 24" roof truss not adequate. Remove roofing, sheathing to framing from exterior. Install 2x10" Framing 16'0", Install new 5/8" decking. Install new 3 tab shingle system. Dense pack with cellulose insulation</u>		
Contractor's name: <u>Biosafe Environmental Services, Inc.</u> Address: <u>5 Delta Dr. 1</u> City, State & Zip <u>Westbrook Me 04092</u> Telephone: <u>854 5262</u> Who should we contact when the permit is ready: <u>Randy Trelethen</u> Telephone: <u>632-6165</u> Mailing address: <u>Same as business</u>		

Please submit all of the information outlined on the applicable Checklist. Failure to do so will result in the automatic denial of your permit.

RECEIVED

In order to be sure the City fully understands the full scope of the project, the Planning and Development Department may request additional information prior to the issuance of a permit. For further information or to download copies of this form and other applications visit the Inspections Division on-line at [www.portlandmaine.gov](http://www.portlandmaine.gov), or stop by the Inspections Division office, room 315 City Hall or call 874-8703.

I hereby certify that I am the Owner of record of the named property, or that the owner of record authorizes the proposed work and that I have been authorized by the owner to make this application as his/her authorized agent. I agree to conform to all applicable laws of this jurisdiction. In addition, if a permit for work described in this application is issued, I certify that the Code Official's authorized representative shall have the authority to enter all areas covered by this permit at any reasonable hour to enforce the provisions of the codes applicable to this permit.

Signature: Randy Trelethen Date: 11/22/09

This is not a permit; you may not commence ANY work until the permit is issue

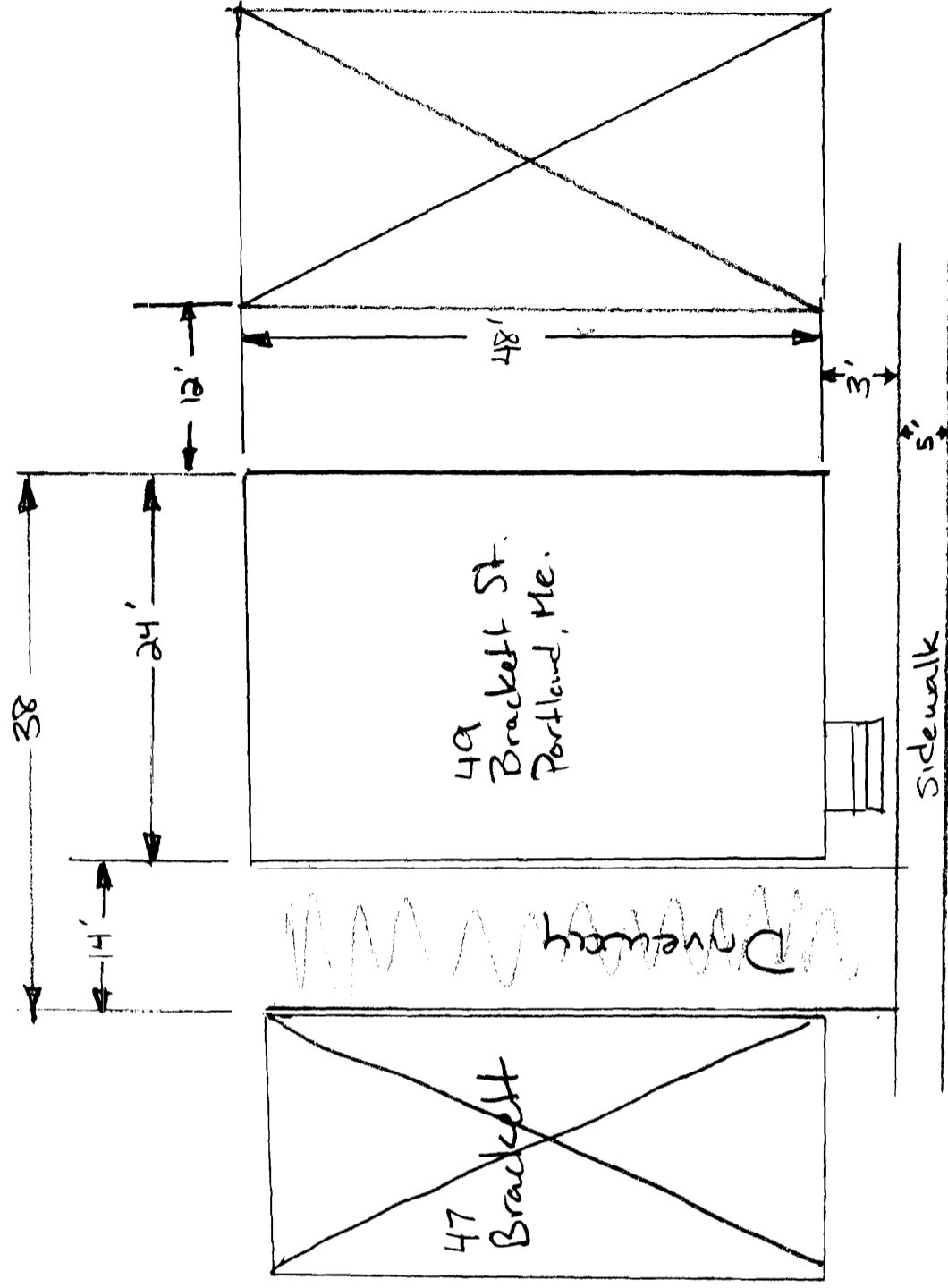

\* 22' From rear of house to property line

Brackett St.

49 Brackett St.  
Portland, Me.  
(Remove and Replace Roofing)

**City of Portland, Maine - Building or Use Permit**  
 389 Congress Street, 04101 Tel: (207) 874-8703, Fax: (207) 874-8716

<b>Permit No:</b> 09-1339	<b>Date Applied For:</b> 11/23/2009	<b>CBL:</b> 044 E018001
------------------------------	--	----------------------------

<b>Location of Construction:</b> 49 BRACKETT ST	<b>Owner Name:</b> NILES STEPHEN M & HOLLY J S	<b>Owner Address:</b> 231 MAINE AVE	<b>Phone:</b>
<b>Business Name:</b>	<b>Contractor Name:</b> Bio-safe Enviromental Services	<b>Contractor Address:</b> 5 Delta Drive Westbrook	<b>Phone</b> (207) 632-6165
<b>Lessee/Buyer's Name</b>	<b>Phone:</b>	<b>Permit Type:</b> Alterations - Dwellings	

<b>Proposed Use:</b> Single Family Home - adding roof trusses sister on to existing roof within existing footprint	<b>Proposed Project Description:</b> adding roof trusses sister on to existing roof within existing footprint
---	--

**Dept:** Zoning      **Status:** Approved with Conditions      **Reviewer:** Tom Markley      **Approval Date:** 11/23/2009  
**Note:**      **Ok to Issue:**   
 1) This is NOT an approval for an additional dwelling unit. You SHALL NOT add any additional kitchen equipment including, but not limited to items such as stoves, microwaves, refrigerators, or kitchen sinks, etc. Without special approvals.

**Dept:** Building      **Status:** Approved with Conditions      **Reviewer:** Tom Markley      **Approval Date:** 11/23/2009  
**Note:**      **Ok to Issue:**   
 1) Fastener schedule per the IRC 2003  
 2) This permit DOES NOT certify the use of the property or building. It only authorizes the construction activities.  
 3) Application approval based upon information provided by applicant. Any deviation from approved plans requires separate review and approval prior to work.

Steve Niles  
49 Bracket St.  
Portland, Me.

\* All within existing footprint

Project # 09-487

- \* 3 Tab shingle system to be installed
- \* No venting required (sloped ceilings/sandwich)
- \* Dense pack cellulose throughout roof system
- \* Blockers to be installed between joists
- \* Eave edge to have 2" rigid insulation blockers installed
- \* Existing joists (2x10) to remain in place.

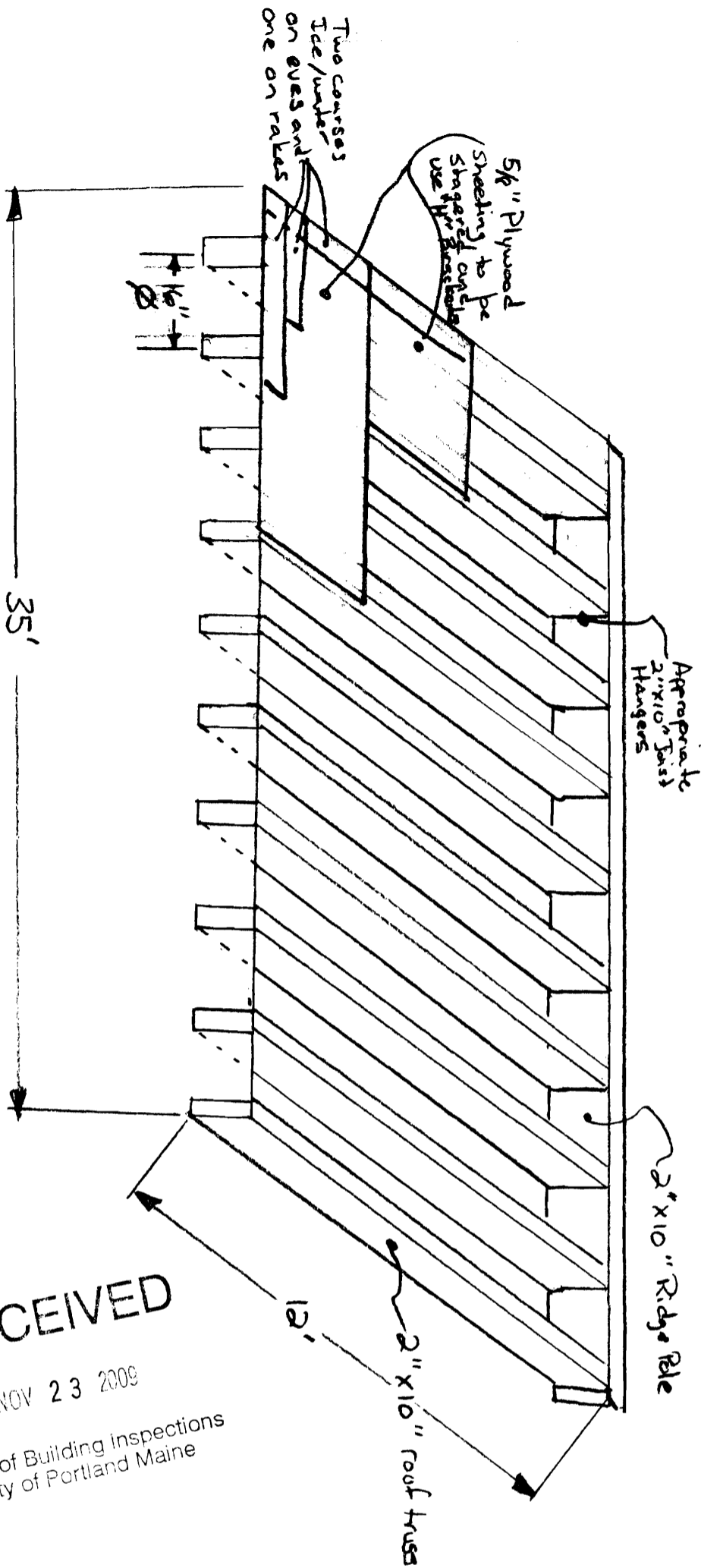

RECEIVED

NOV 23 2009

Dept. of Building Inspections  
City of Portland Maine