

- NOTES
- COORDINATE ALL PIPING AND RISER LOCATIONS WITH ARCHITECT PRIOR TO ROUGH-IN.
 - KEEP ALL PIPING AS TIGHT TO STRUCTURE ABOVE AS POSSIBLE.
 - EXISTING SANITARY PIPING SHALL BE SCOPED TO VERIFY IT CAN BE REUSED.
 - CONTRACTOR IS RESPONSIBLE FOR RADON LAYOUT PER STATE REQUIREMENTS.
 - CONTRACTOR IS RESPONSIBLE FOR VERIFYING EXISTING PLUMBING SERVICE LOCATIONS AND SIZES ARE ADEQUATE FOR PROPOSED BUILDING USAGE.

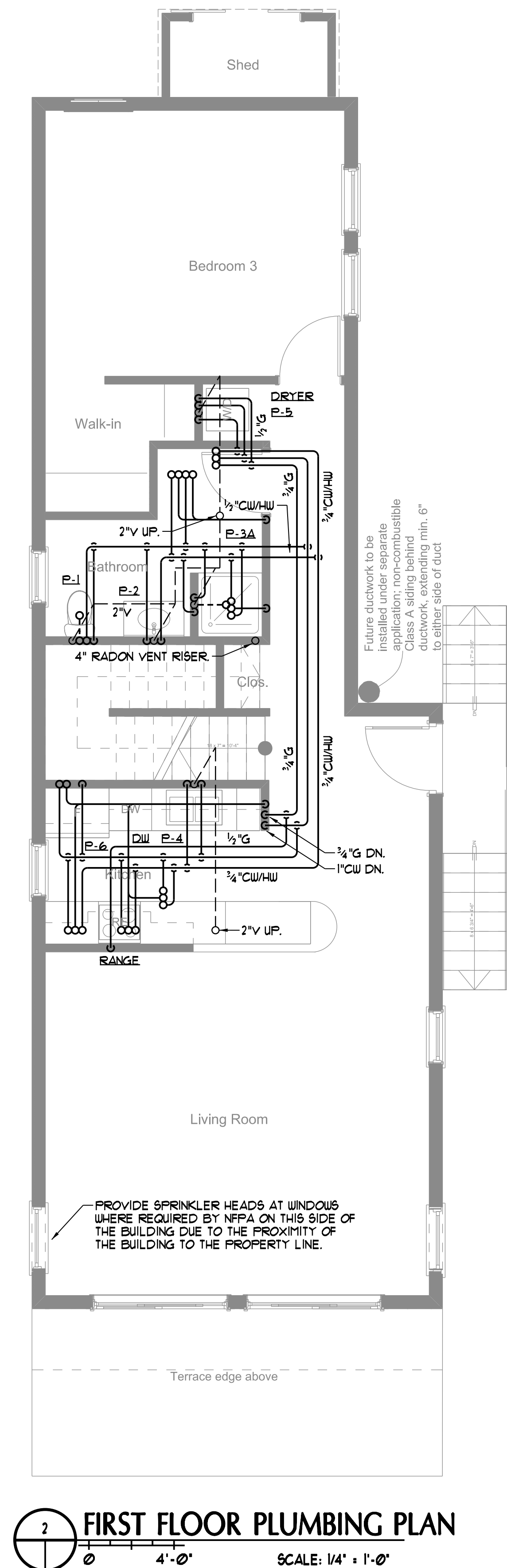

- NOTES
- COORDINATE ALL PIPING AND RISER LOCATIONS WITH ARCHITECT PRIOR TO ROUGH-IN.

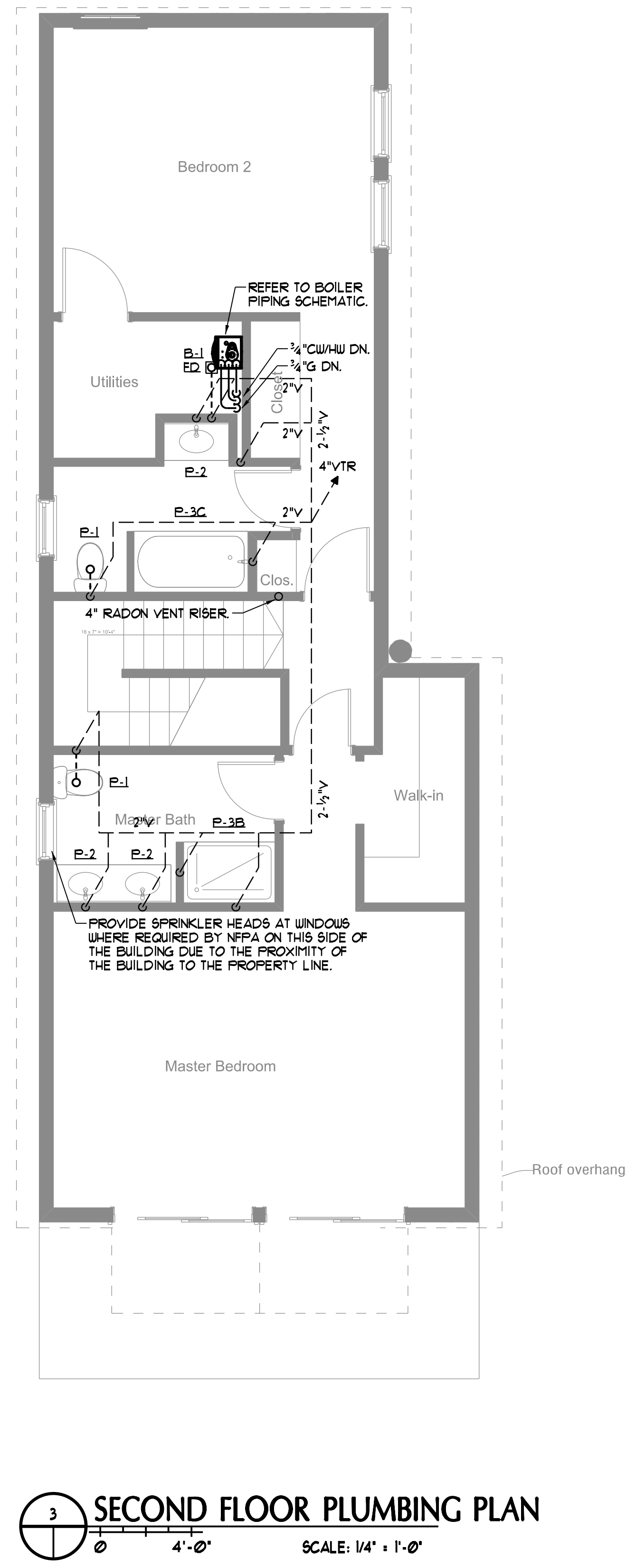

- NOTES
- COORDINATE ALL PIPING AND RISER LOCATIONS WITH ARCHITECT PRIOR TO ROUGH-IN.

227 York Street
Residence - Portland, Maine

Architect:
Reiter Architecture & Design
PO Box 275 -- Brooklin, ME 04616
Tel. 207.359.2300

Structural & Civil Engineer:
Casco Bay Engineering
424 Fore Street -- Portland, ME 04101
Tel. 207.842.2800

Mechanical & Electrical Engineer:
Bennett Engineering
PO Box 297 -- Freeport, ME 04032
Tel. 207.865.9475

Drwg Date / Issued by / Drwg Issue		
5/10/13	BEI	For Bldg Dept Review & Bidding Only, Not For Construction

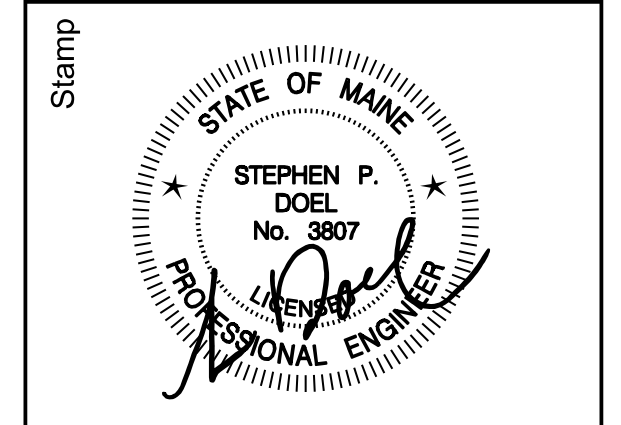

Drawing Title
RESIDENCE PLUMBING PLANS

Drawing Number
M2