

D-02 Lot Line Detail 3" = 1'-0"

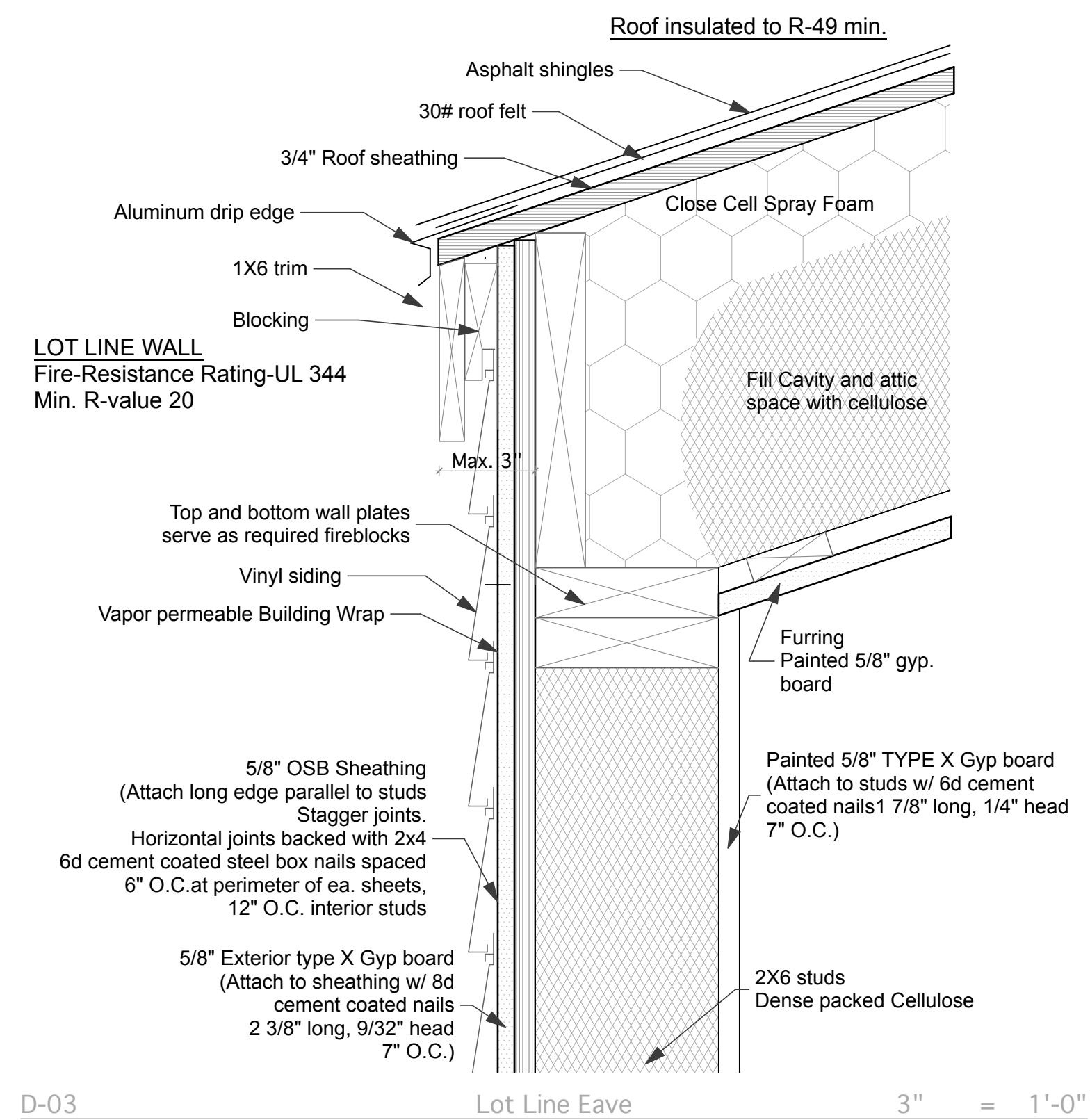

D-03 Lot Line Eave 3" = 1'-0"

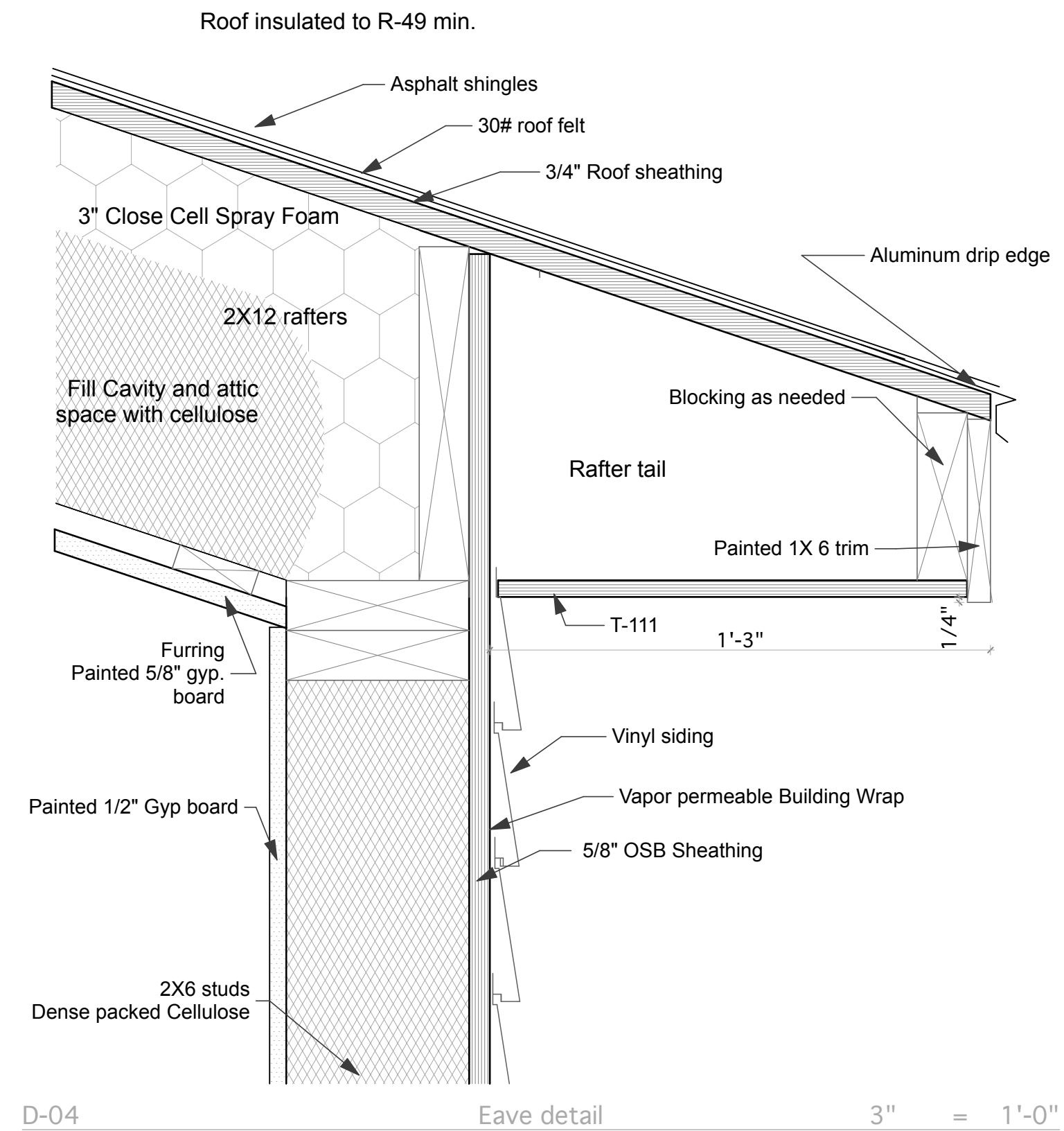

D-04 Eave Detail 3" = 1'-0"

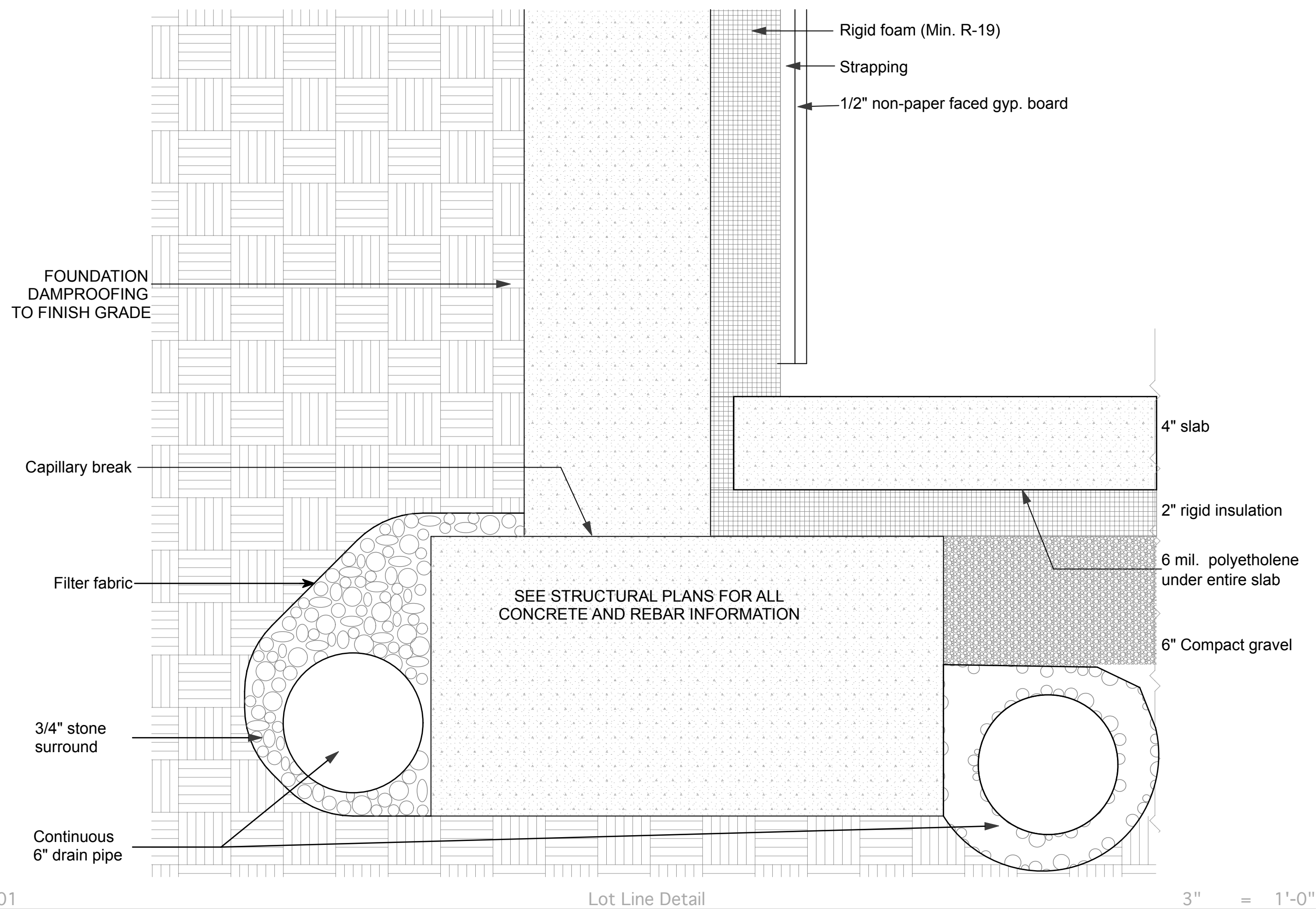

D-01 Lot Line Detail 3" = 1'-0"

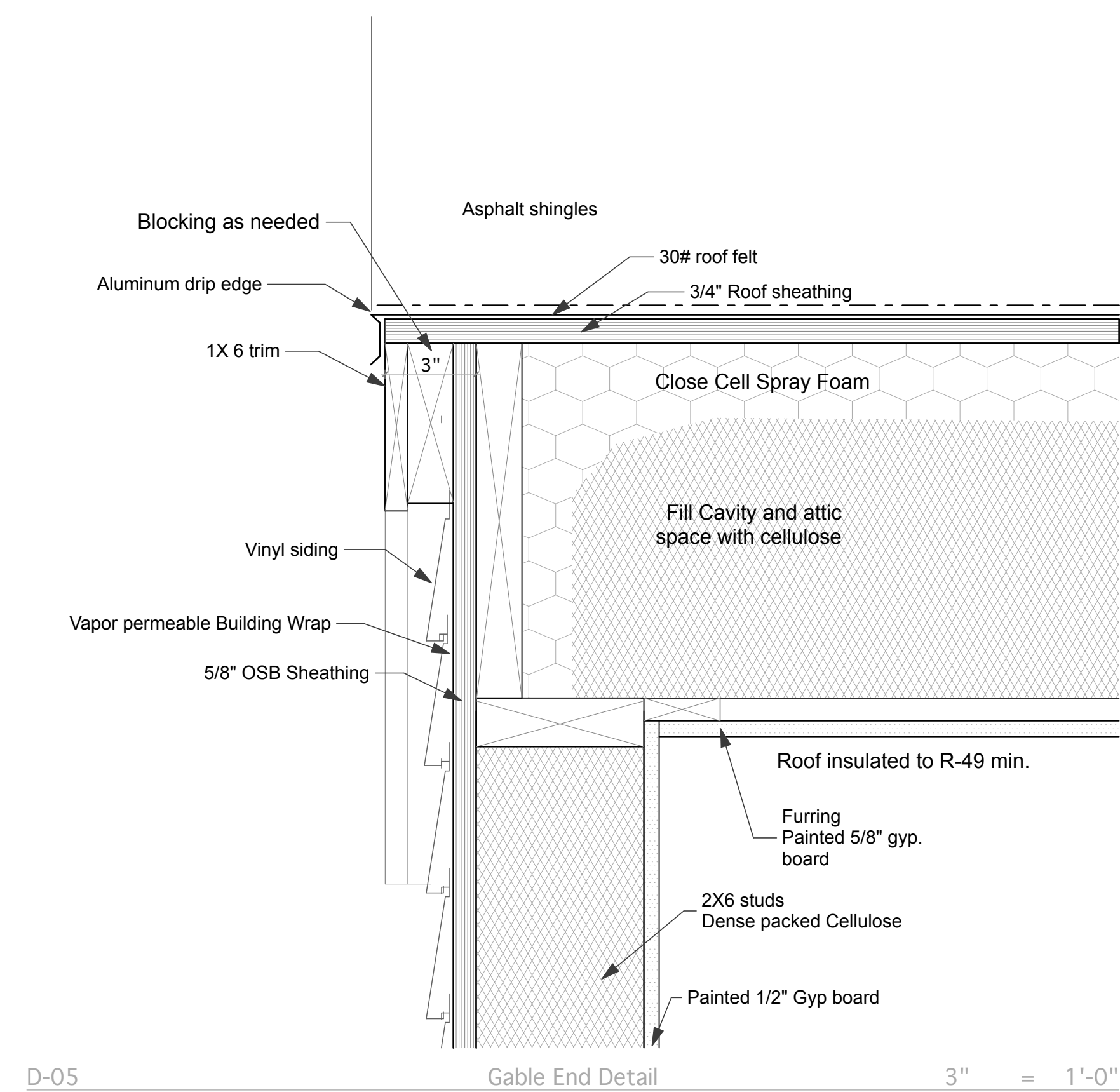

D-05 Gable End Detail 3" = 1'-0"

FOR BUILDING DEPT. REVIEW AND BIDDING ONLY/ NOT FOR CONSTRUCTION

227 York Street  
Residence - Portland, Maine

Document created by: Four Winds Design Mt. Desert ME. (207) 244-7976

Architect:  
Reiter Architecture & Design  
PO Box 275 -- Brooklin, ME 04616  
Tel. 207.359.2300

Structural & Civil Engineer:  
Casco Bay Engineering  
424 Fore Street -- Portland, ME 04101  
Tel. 207.842.2800

MEP & Sprinkler Engineer:  
Bennett Engineering  
PO Box 297 -- Freeport, ME 04032  
Tel. 207.865.9475

Drwg Date / Issued by / Drwg Issue  
May 10, 2013  
For building dept. and bidding only



Drawing Title

Details

Drawing Number

A5.1