

OR TO EXIT
(INKLERED)
BUILDINGS.

GC/OWNER VERIFY EXISTING EMERGENCY LIGHTING IN ALL EGRESS STAIRS ON ALL FLOORS

EXISTING GAS METERS (GAS RANGES IN APTS.)

EXISTING ELECTRIC PANELS

SEE NOTE 2/A3 FOR FLOOR NUMBERING DESIGNATION. TYPICAL FOR ALL STAIR ON ALL FLOORS

GC FIELD INSPECT AND SEAL ALL HOLES, CRACKS AND PENETRATIONS IN WALLS, ALL STAIRS - TYP.

NEW SIGNAGE NOTE 2/A3

EXISTING VERTICAL SLIDING WOOD DOOR TO REMAIN. PROVIDE LOCK. KEY TO KNOX BOX.

APARTMENT ENTRY/EXIT DOOR

EXISTING EXTERIOR MASONRY WALL

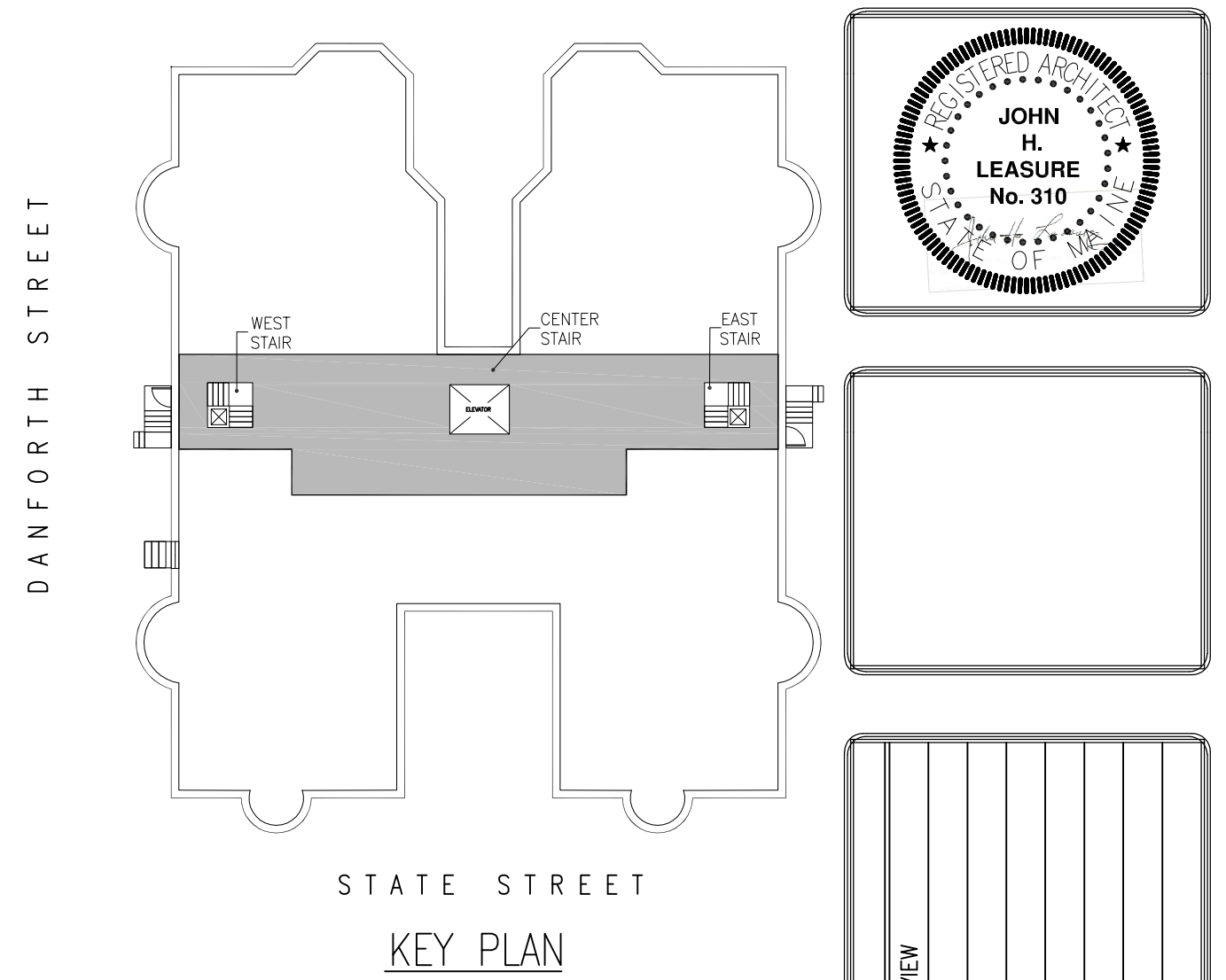
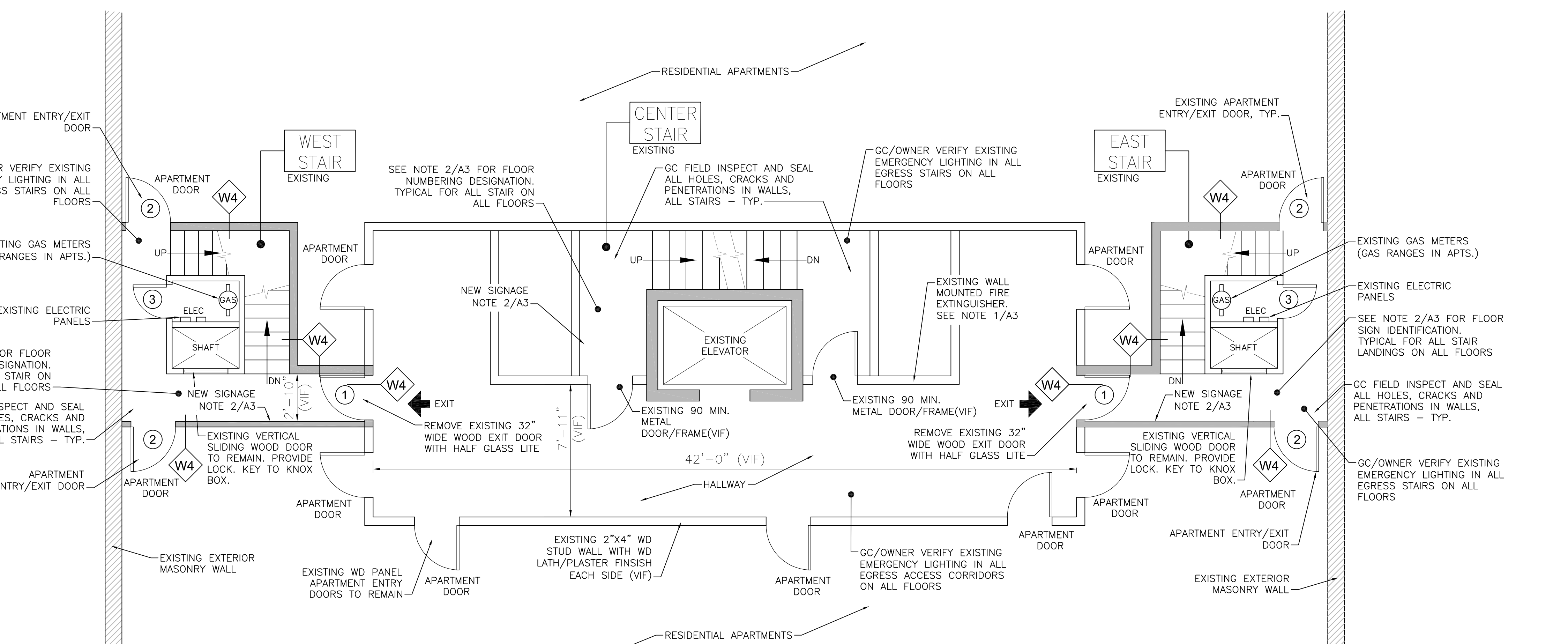

| REV. | DATE | STATUS |
|------|---------|---------------------------------------|
| 1 | 3-08-18 | REVISIONS |
| 2 | 2-26-18 | SUBMITTED FOR PERMITS AND CITY REVIEW |

59 STATE STREET
TYPICAL PARTIAL PLAN FOR SIX FLOORS

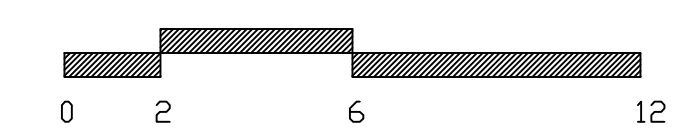

- Entire building shall be equipped with an approved supervised automatic sprinkler system in accordance with NFPA 13

GENERAL NOTES

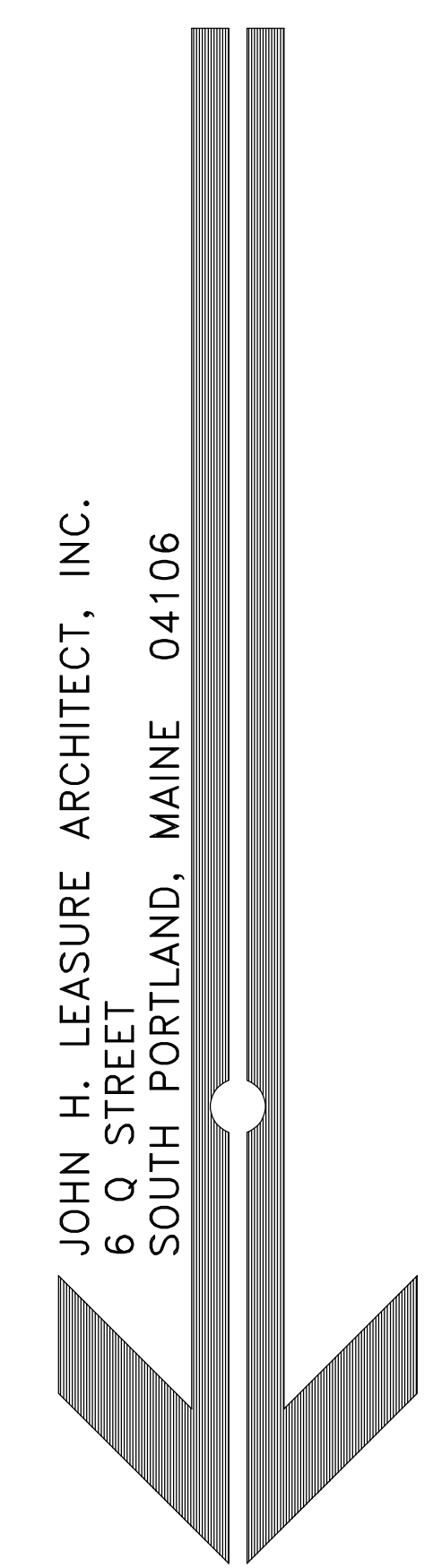

General Notes on Drawing A0 ,
Wall types and Door Schedule on Drawing A3

Existing Apartment Building
59 STATE STREET
PORTLAND, MAINE
PARTIAL TYPICAL FLOOR PLAN

A2