

SECTION 4
1" = 1'-0"

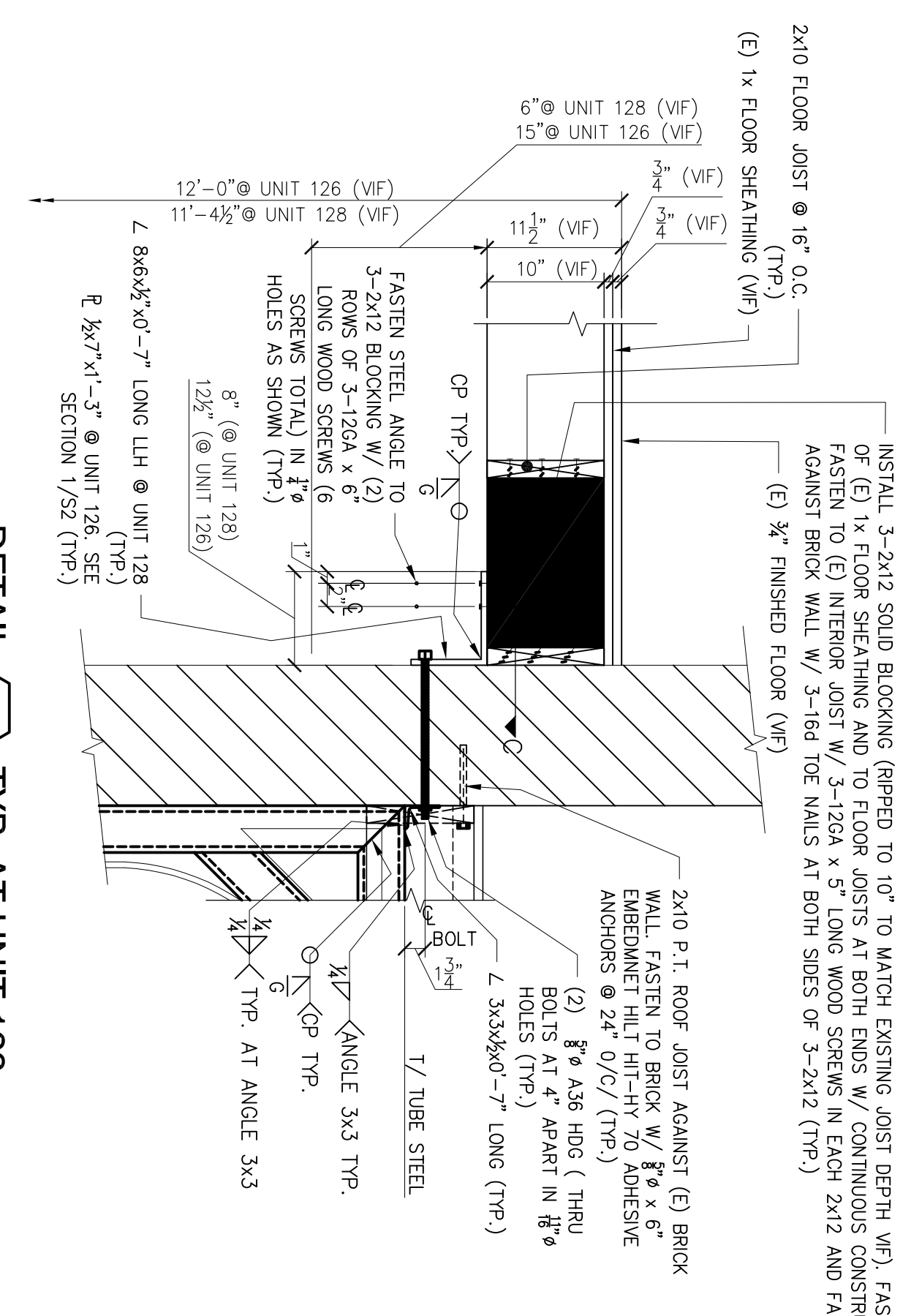

DETAIL C TYP. AT UNIT 128
1" = 1'-0"

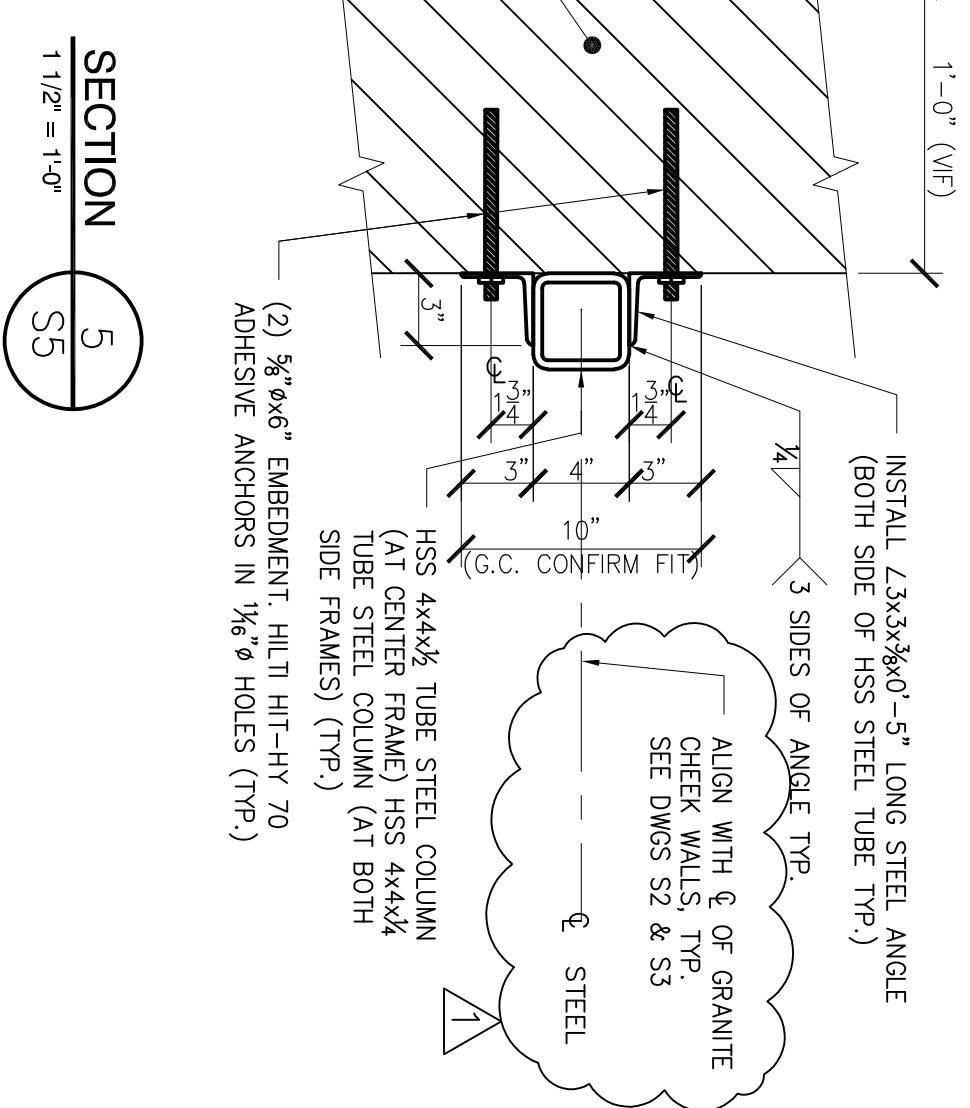

SECTION 5
1 1/2" = 1'-0"

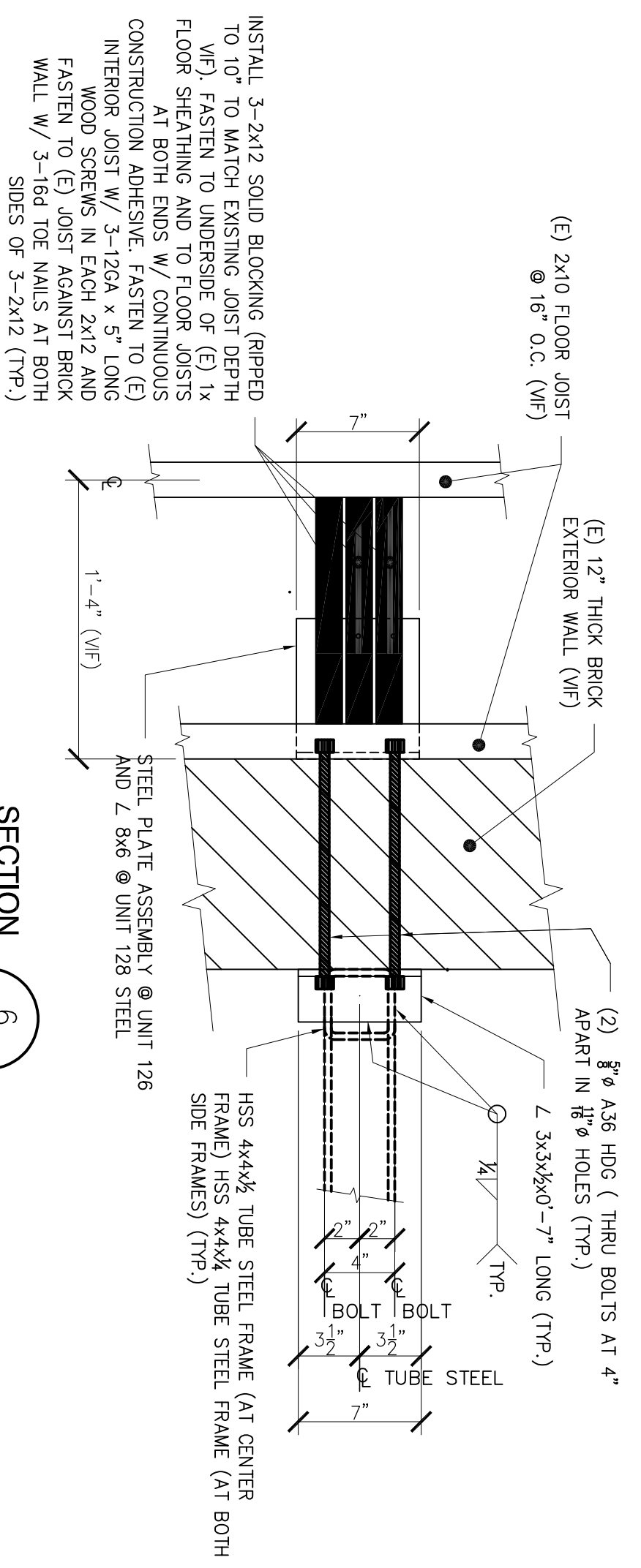

SECTION 6
1 1/2" = 1'-0"

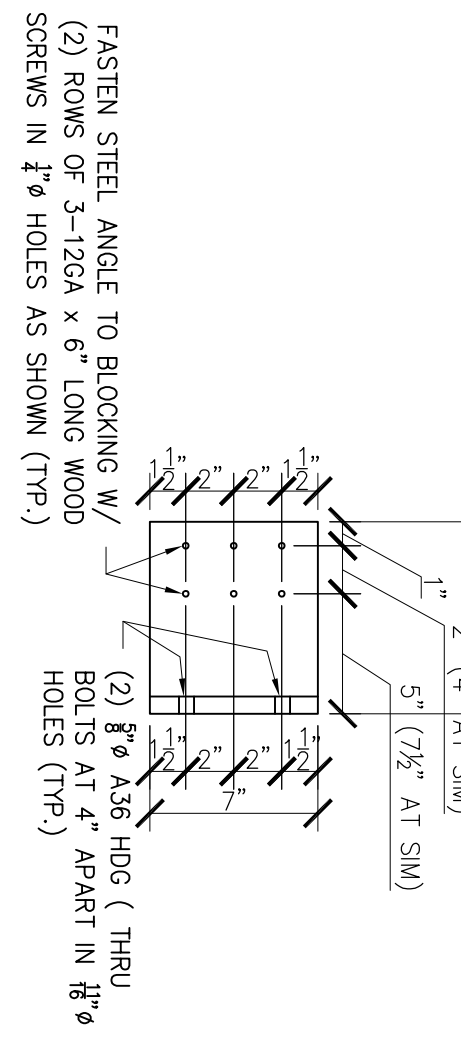

SECTION C-C
1 1/2" = 1'-0"

BUILDING LOCATED AT
126/128 DANFORTH STREET
PORTLAND, MAINE
FRONT ENTRY ROOF/DECK REPAIR
SECTIONS AND DETAILS

designed by:	rev.	date	description	appr'd
JHL	1	9-29-17	REVISIONS	
drawn by:				
JH				
checked by:				
JHL				
scale:			AS NOTED	
date:		11/30/2016		
plot date:		02/24/2017		
project #:		27113B		

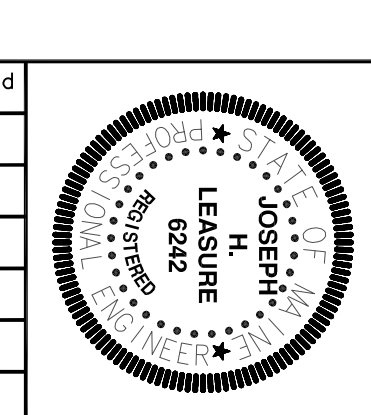

L & L STRUCTURAL ENGINEERING SERVICES, INC.
SIX Q STREET
SOUTH PORTLAND, MAINE 04106
PHONE: (207) 767-4830
FAX: (207) 799-5432

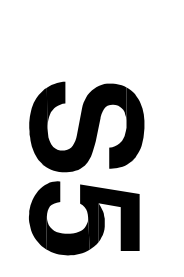

THESE DRAWINGS HAVE BEEN DEVELOPED BY L&L STRUCTURAL ENGINEERING SERVICES, INC. FOR THE TYPED LABEL ENGINEERING SERVICES, INC. AND THEY SHALL NOT BE CONSIDERED AS THE PROPERTY OF L&L STRUCTURAL ENGINEERING SERVICES, INC.