

DETAIL of NEW WALLS

Interior Non-Bearing Wall Detail

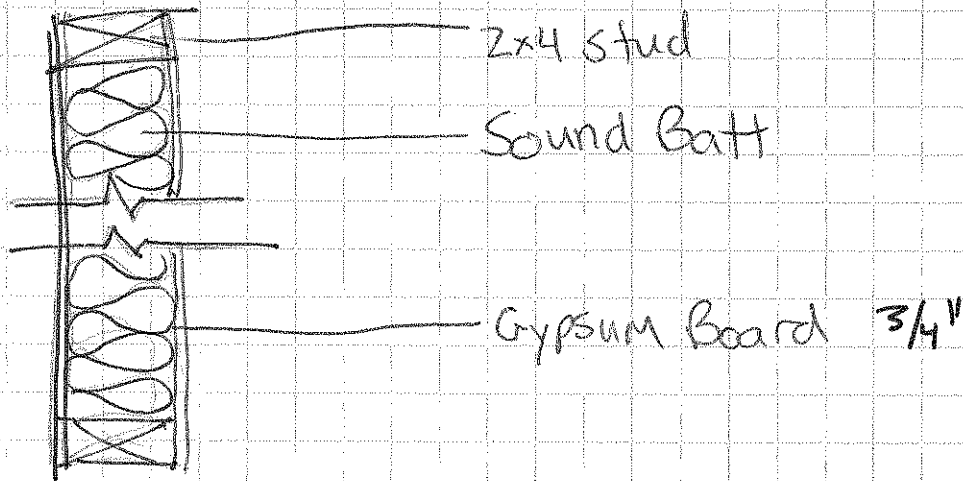

Detail of Structural Beam

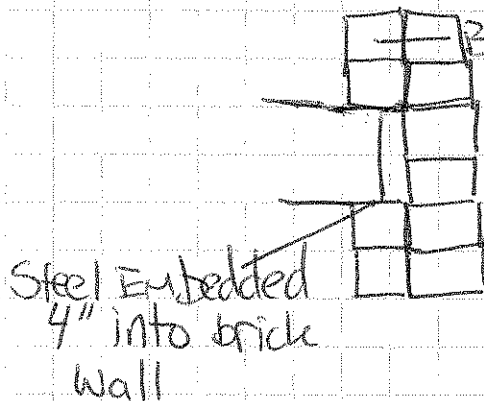

~~Fact~~
A double W8x10 steel beam to span 9' wide clear opening between dining Room and Kitchen.
Beam to be inserted 4" into existing brick walls for support.

Rebrick and grout solid around beam bearing locations.

To be field verified post-demolition

Email Attached