

DISPLAY THIS CARD ON PRINCIPAL FRONTAGE OF WORK CITY OF PORTLAND

Please Read
Application And
Notes, If Any,
Attached

BUILDING INSPECTION PERMIT

Permit Number: 080715

This is to certify that CATHERINE MORRILL DAY NURSERY / Davis Woodweg
has permission to Place preconstructed 8'x8' shelter on the Lower Playground
AT 96 DANFORTH ST 044 A028001

JUL - 7 2008

provided that the person or persons, firm or corporation accepting this permit shall comply with all of the provisions of the Statutes of Maine and of the Ordinances of the City of Portland regulating the construction, maintenance and use of buildings and structures, and of the application on file in this department.

Apply to Public Works for street line and grade if nature of work requires such information.

Notification of inspection must be given and written permission procured before this building or part thereof is leased or otherwise closed-in. 24 HOUR NOTICE IS REQUIRED.

A certificate of occupancy must be procured by owner before this building or part thereof is occupied.

OTHER REQUIRED APPROVALS

Fire Dept. Craig Cass
Health Dept. _____
Appeal Board _____
Other _____
Department Name

Director - Building & Inspection Services

PENALTY FOR REMOVING THIS CARD

City of Portland, Maine - Building or Use Permit Application
 389 Congress Street, 04101 Tel: (207) 874-8703, Fax: (207) 874-8716

Permit No: 08-0715	Issue Date:	CBL: 044 A028001
-----------------------	-------------	---------------------

Location of Construction: 96 DANFORTH ST	Owner Name: CATHERINE MORRILL DAY NU	Owner Address: 96 DANFORTH ST	Phone: 207-874-1115
Business Name:	Contractor Name: Davis Woodworking	Contractor Address: 971 Brighton Avenue Portland	Phone 2077742045
Lessee/Buyer's Name	Phone:	Permit Type: Additions - Commercial	Zone: R-6

Past Use: Educational/Childcare Non-profit	Proposed Use: Educational/Childcare Non-profit - - Place preconstructed 8'x8' shed on the Lower Playground	Permit Fee: \$30.00	Cost of Work: \$1,000.00	CEO District: 2
		FIRE DEPT: <input checked="" type="checkbox"/> Approved <input type="checkbox"/> Denied	INSPECTION: Use Group: Type:	

Proposed Project Description: Place preconstructed 8'x8' shed on the Lower Playground	Signature: <i>Greg Cross</i>	Signature:
PEDESTRIAN ACTIVITIES DISTRICT (P.A.D.)		
Action: <input type="checkbox"/> Approved <input type="checkbox"/> Approved w/Conditions <input type="checkbox"/> Denied		
Signature:		Date:

Permit Taken By: Imd	Date Applied For: 06/18/2008	Zoning Approval	
-------------------------	---------------------------------	------------------------	--

- This permit application does not preclude the Applicant(s) from meeting applicable State and Federal Rules.
- Building permits do not include plumbing, septic or electrical work.
- Building permits are void if work is not started within six (6) months of the date of issuance. False information may invalidate a building permit and stop all work..

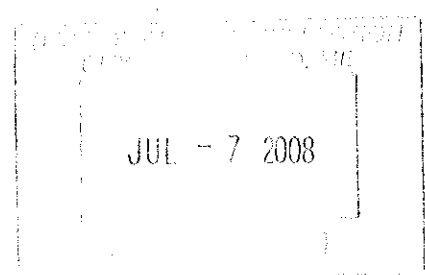

Special Zone or Reviews <input type="checkbox"/> Shoreland <input type="checkbox"/> Wetland <input type="checkbox"/> Flood Zone <input type="checkbox"/> Subdivision <input checked="" type="checkbox"/> Site Plan <i>site plan exemption approved for</i> Maj <input type="checkbox"/> Minor <input type="checkbox"/> MM <input type="checkbox"/> <i>ok with conditions</i> Date: <i>6/19/08</i>	Zoning Appeal <input type="checkbox"/> Variance <input type="checkbox"/> Miscellaneous <input type="checkbox"/> Conditional Use <input type="checkbox"/> Interpretation <input type="checkbox"/> Approved <input type="checkbox"/> Denied Date:	Historic Preservation <i>to D.A</i> <input type="checkbox"/> Not in District or Landmark <input type="checkbox"/> Does Not Require Review <input type="checkbox"/> Requires Review <input type="checkbox"/> Approved <input checked="" type="checkbox"/> Approved w/Conditions <input type="checkbox"/> Denied Date: <i>6/25/08</i> <i>D. Andrews</i>
--	---	---

CERTIFICATION

I hereby certify that I am the owner of record of the named property, or that the proposed work is authorized by the owner of record and that I have been authorized by the owner to make this application as his authorized agent and I agree to conform to all applicable laws of this jurisdiction. In addition, if a permit for work described in the application is issued, I certify that the code official's authorized representative shall have the authority to enter all areas covered by such permit at any reasonable hour to enforce the provision of the code(s) applicable to such permit.

SIGNATURE OF APPLICANT	ADDRESS	DATE	PHONE
RESPONSIBLE PERSON IN CHARGE OF WORK, TITLE		DATE	PHONE



General Building Permit Application

If you or the property owner owes real estate or personal property taxes or user charges on any property within the City, payment arrangements must be made before permits of any kind are accepted.

Location/Address of Construction: <u>96 Danforth St</u>		
Total Square Footage of Proposed Structure/Area <u>8 x 8 ft</u>		Square Footage of Lot
Tax Assessor's Chart, Block & Lot Chart# Block# Lot#	Applicant <u>'must be owner, Lessee or Buyer'</u> Name <u>Catherine Morrill Day Kinsley</u> Address <u>96 Danforth St</u> City, State & Zip <u>Portland, Maine 04101</u>	Telephone: <u>(207) 874 1115</u>
<u>44</u> <u>A</u> <u>28</u>	Owner (if different from Applicant) Name Address City, State & Zip	Cost Of Work: \$ <u>1000.</u> C of O Fee: \$ _____ Total Fee: \$ _____
Lessee/DBA (If Applicable) _____ Current legal use (i.e. single family) <u>not for profit childcare & education</u> If vacant, what was the previous use? _____ Proposed Specific use: _____ Is property part of a subdivision? <u>no</u> If yes, please name _____ Project description: <u>Pre-fab wooden 8x8 toy shed w/ pitched roof to be located in lower playground for the purpose of storing children's toys.</u> Contractor's name: <u>Shed constructed by Davis Woodworking</u> Address: <u>911 Brighton Avenue</u> City, State & Zip: <u>Portland, Maine</u> Telephone: <u>774-2045</u> Who should we contact when the permit is ready: <u>Pauline Grondin - Cardillo</u> Telephone: <u>874-1115</u> Mailing address: <u>96 Danforth St. Portland, Me 04101</u>		

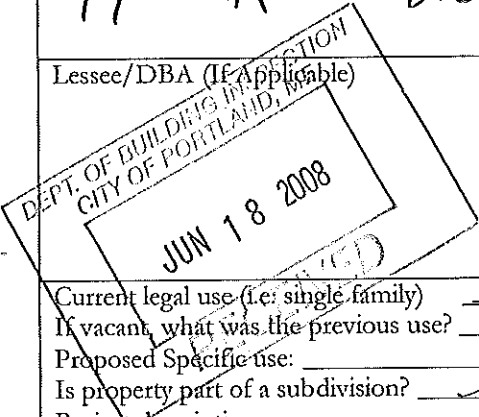

Please submit all of the information outlined on the applicable Checklist. Failure to do so will result in the automatic denial of your permit.

In order to be sure the City fully understands the full scope of the project, the Planning and Development Department may request additional information prior to the issuance of a permit. For further information or to download copies of this form and other applications visit the Inspections Division on-line at www.portlandmaine.gov, or stop by the Inspections Division office, room 315 City Hall or call 874-8703.

I hereby certify that I am the Owner of record of the named property, or that the owner of record authorizes the proposed work and that I have been authorized by the owner to make this application as his/her authorized agent. I agree to conform to all applicable laws of this jurisdiction. In addition, if a permit for work described in this application is issued, I certify that the Code Official's authorized representative shall have the authority to enter all areas covered by this permit at any reasonable hour to enforce the provisions of the codes applicable to this permit.

Signature: Pauline Grondin - Cardillo Date: June 16, 2008

This is not a permit; you may not commence ANY work until the permit is issued

✓ 00

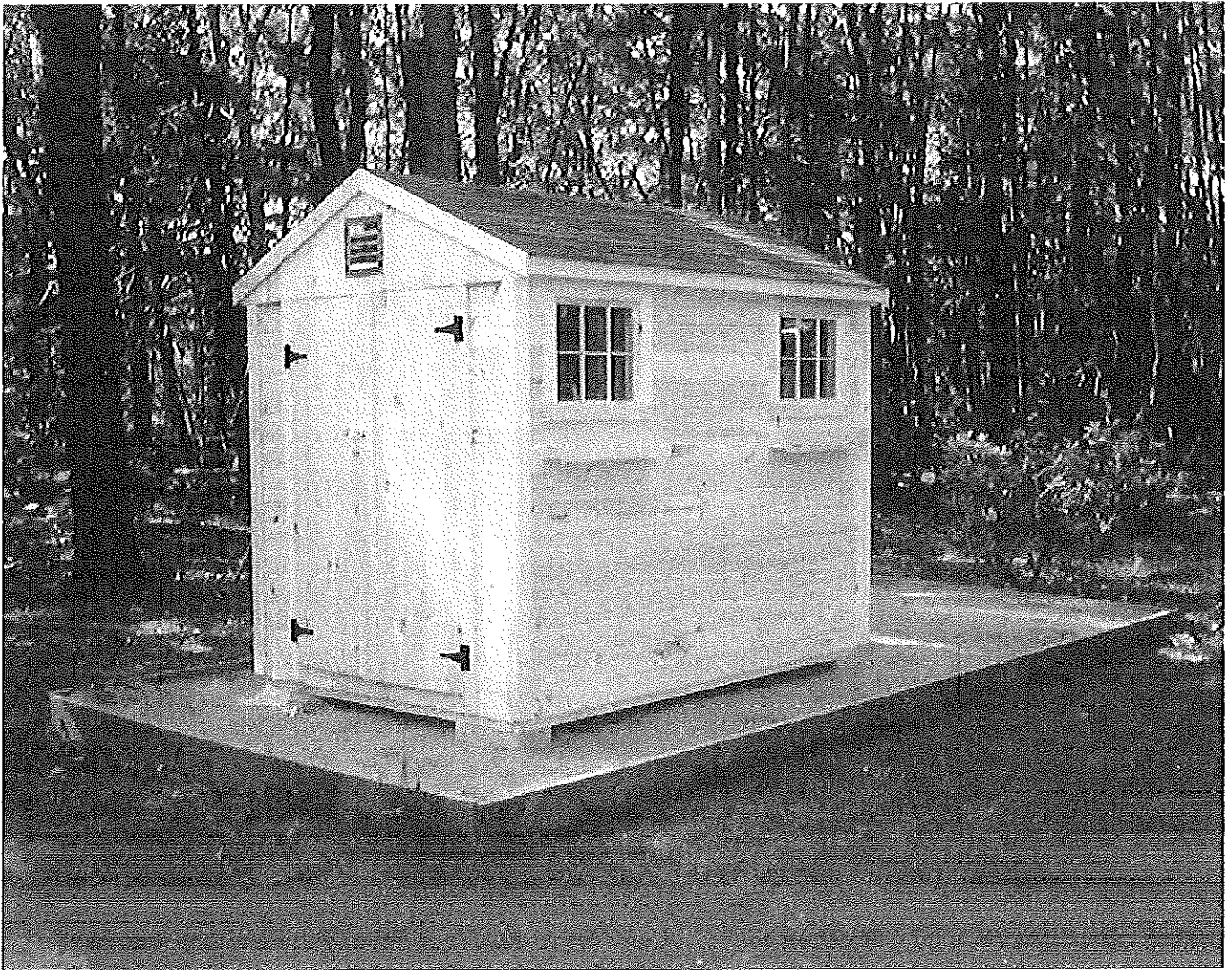

8x8 shed w/ pitched roof

STORAGE SHED LOCATION

8' x8' Shed located 5'-0" from property line.

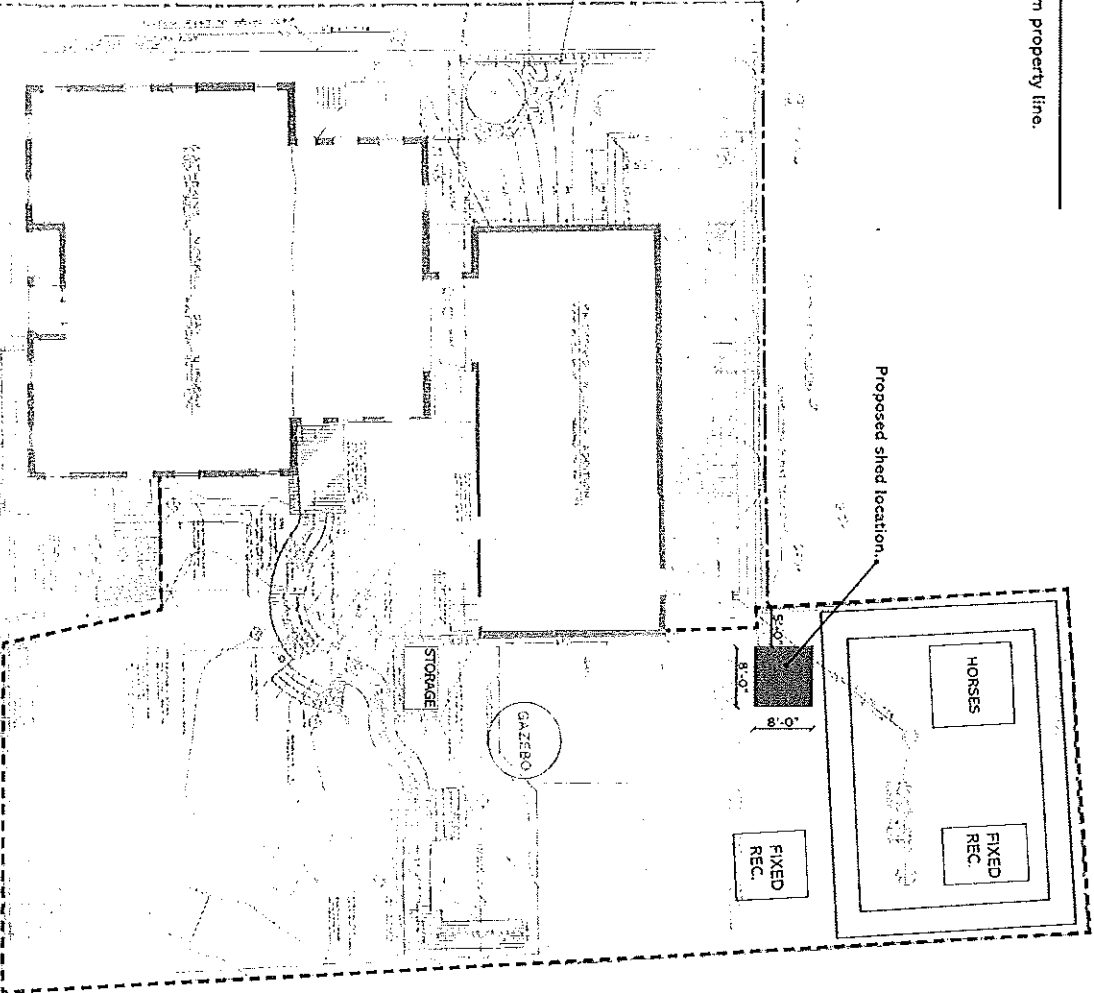

Catherine Morrill Day Nursery
Proposed She Location

<p>STEVENS ARCHITECTS 927 PLEASANT ST. PORTLAND, ME. TEL: 857-2333 FAX: 857-2334 WWW.STEVENSARCHITECTS.COM</p>		<p>DATE: 11/11/11 SCALE: AS SHOWN</p>	
<p>PROJECT: CATHERINE MORRILL DAY NURSERY JOB NO: 11-001</p>		<p>DESIGNED BY: JACOB STEVENS CHECKED BY: JACOB STEVENS DATE: 11/11/11</p>	
<p>CLIENT: CATHERINE MORRILL DAY NURSERY 36 DANFORTH ST. PORTLAND, ME.</p>		<p>PROJECT NO: 11-001</p>	

BUILDING PERMIT INSPECTION PROCEDURES

Please call 874-8703 or 874-8693 (ONLY)

to schedule your inspections as agreed upon

Permits expire in 6 months, if the project is not started or ceases for 6 months.

The Owner or their designee is required to notify the inspections office for the following inspections and provide adequate notice. Notice must be called in 48-72 hours in advance in order to schedule an inspection:

By initializing at each inspection time, you are agreeing that you understand the inspection procedure and additional fees from a "Stop Work Order" and "Stop Work Order Release" will be incurred if the procedure is not followed as stated below.

A Pre-construction Meeting will take place upon receipt of your building permit.

~~Footings/Building Location Inspection: Prior to pouring concrete or setting precast piers~~

Final inspection required at completion of work.

Certificate of Occupancy is not required for certain projects. Your inspector can advise you if your project requires a Certificate of Occupancy. All projects DO require a final inspection.

If any of the inspections do not occur, the project cannot go on to the next phase, **REGARDLESS OF THE NOTICE OR CIRCUMSTANCES.**

CERTIFICATE OF OCCUPANCIES MUST BE ISSUED AND PAID FOR, BEFORE THE SPACE MAY BE OCCUPIED.



Signature of Applicant/Designee

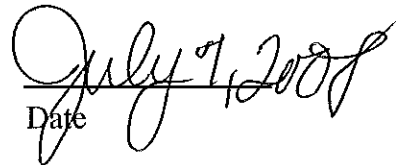

Date

Signature of Inspections Official

Date

City of Portland, Maine - Building or Use Permit

389 Congress Street, 04101 Tel: (207) 874-8703, Fax: (207) 874-8716

Permit No: 08-0715	Date Applied For: 06/18/2008	CBL: 044 A028001
-----------------------	---------------------------------	---------------------

Location of Construction: 96 DANFORTH ST	Owner Name: CATHERINE MORRILL DAY NU	Owner Address: 96 DANFORTH ST	Phone: 207-874-1115
Business Name:	Contractor Name: Davis Woodworking	Contractor Address: 971 Brighton Avenue Portland	Phone: (207) 774-2045
Lessee/Buyer's Name	Phone:	Permit Type: Additions - Commercial	

Proposed Use: Educational/Childcare Non-profit - - Place preconstructed 8'x8' shed on the Lower Playground	Proposed Project Description: Place preconstructed 8'x8' shed on the Lower Playground
---	--

Dept: Historic	Status: Approved with Conditions	Reviewer: Deborah Andrews	Approval Date: 06/25/2008
Note:	Ok to Issue: <input checked="" type="checkbox"/>		
1) * Shed to be maintained in location shown on plan, well back from Danforth Street. * Shed to be painted or opaque stained a dark recessive color to minimize visibility from the street.			
Dept: Zoning	Status: Approved	Reviewer: Marge Schmuckal	Approval Date: 06/19/2008
Note:	Ok to Issue: <input checked="" type="checkbox"/>		
Dept: Building	Status: Approved	Reviewer:	Approval Date:
Note:	Ok to Issue: <input type="checkbox"/>		
Dept: Fire	Status: Approved	Reviewer: Capt Greg Cass	Approval Date: 06/26/2008
Note:	Ok to Issue: <input checked="" type="checkbox"/>		

Comments:

6/26/2008-gg: recieved granted site plan exemption as of 6/28/08. /gg filed with permit (Capt. Cass)



General Building Permit Application

If you or the property owner owes real estate or personal property taxes or user charges on any property within the City, payment arrangements must be made before permits of any kind are accepted.

Location/Address of Construction: <u>96 Danforth St</u>		
Total Square Footage of Proposed Structure/Area <u>8 x 8 ft</u>		Square Footage of Lot
Tax Assessor's Chart, Block & Lot Chart# <u>44</u>	Block# <u>A</u>	Lot# <u>28</u>
Applicant * <u>must</u> be owner, Lessee or Buyer* Name <u>Catherine Morrill Day Kinsey</u> (207) Address <u>96 Danforth St</u> City, State & Zip <u>Portland, Maine 04101</u>		Telephone: <u>874 1115</u>
Lessee/DBA (if Applicable)	Owner (if different from Applicant) Name Address City, State & Zip	Cost Of Work: \$ <u>1000.</u> C of O Fee: \$ _____ Total Fee: \$ _____
Current legal use (i.e. single-family) <u>not for profit Childcare + Education</u> If vacant, what was the previous use? _____ Proposed Specific use: _____ Is property part of a subdivision? <u>no</u> If yes, please name _____ Project description: <u>Pre-fab wooden 8x8 toy shed w/ pitched roof to be located in lower playground for the purpose of storing children's toys. Shed constructed by Davis Woodworking</u>		
Contractor's name: <u>977 Brighton Avenue</u> Address: _____ City, State & Zip: <u>Portland, Maine</u> Telephone: <u>774-2045</u>		
Who should we contact when the permit is ready: <u>Pauline Grandin - Cardillo</u> Telephone: <u>874-1115</u>		
Mailing address: <u>96 Danforth St. Portland, Me 04101</u>		

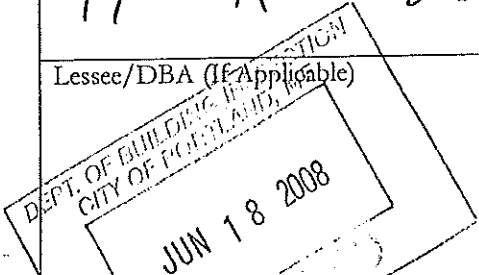

Please submit all of the information outlined on the applicable Checklist. Failure to do so will result in the automatic denial of your permit.

In order to be sure the City fully understands the full scope of the project, the Planning and Development Department may request additional information prior to the issuance of a permit. For further information or to download copies of this form and other applications visit the Inspections Division on-line at www.portlandmaine.gov, or stop by the Inspections Division office, room 315 City Hall or call 874-8703.

I hereby certify that I am the Owner of record of the named property, or that the owner of record authorizes the proposed work and that I have been authorized by the owner to make this application as his/her authorized agent. I agree to conform to all applicable laws of this jurisdiction. In addition, if a permit for work described in this application is issued, I certify that the Code Official's authorized representative shall have the authority to enter all areas covered by this permit at any reasonable hour to enforce the provisions of the codes applicable to this permit.

Signature: Pauline Grandin-Cardillo Date: June 16, 2008

This is not a permit; you may not commence ANY work until the permit is issued

✓ CB

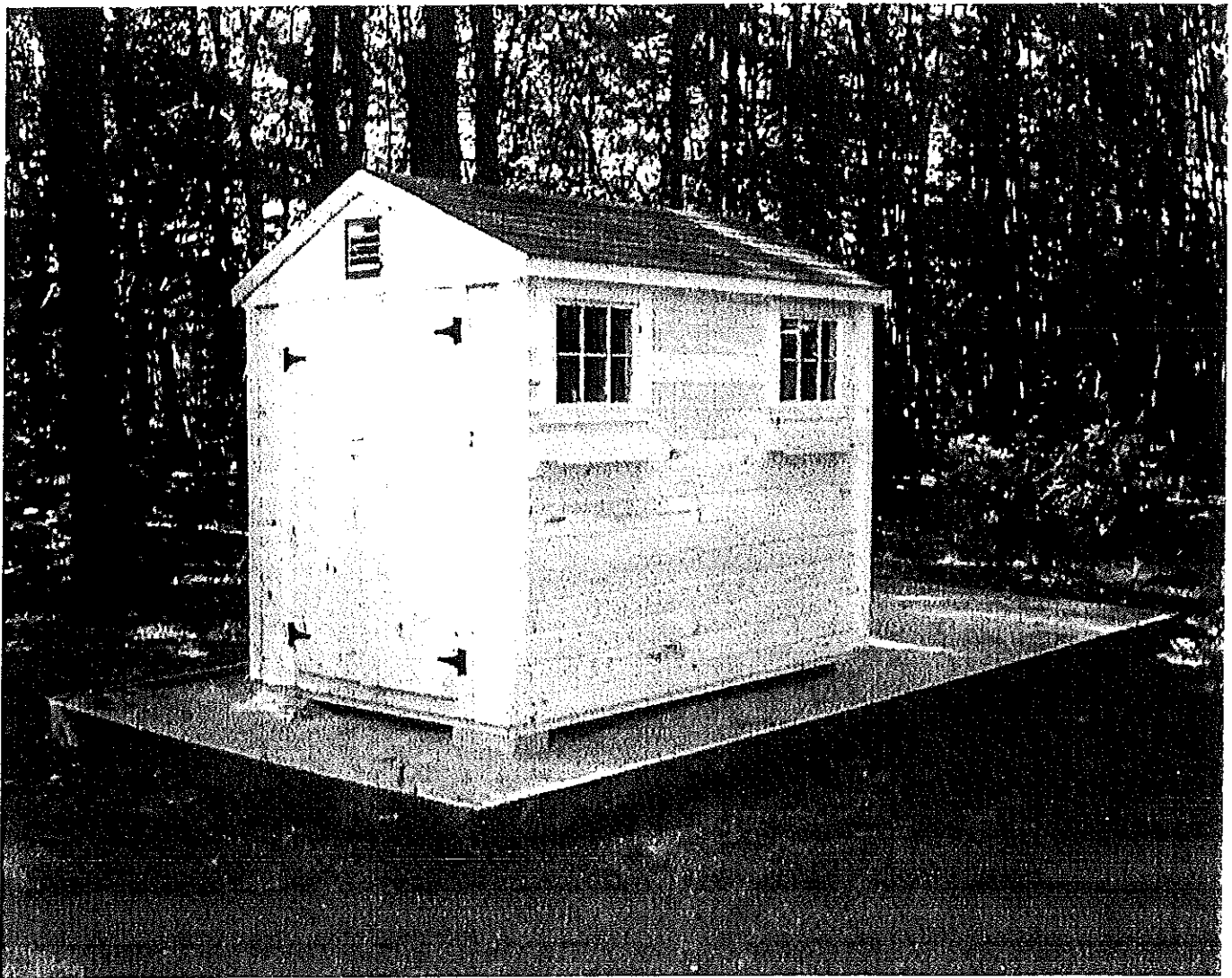

8x8 shed w/ pitched roof

STORAGE SHED LOCATION

8' x8' Shed located 5'-0" from property line.

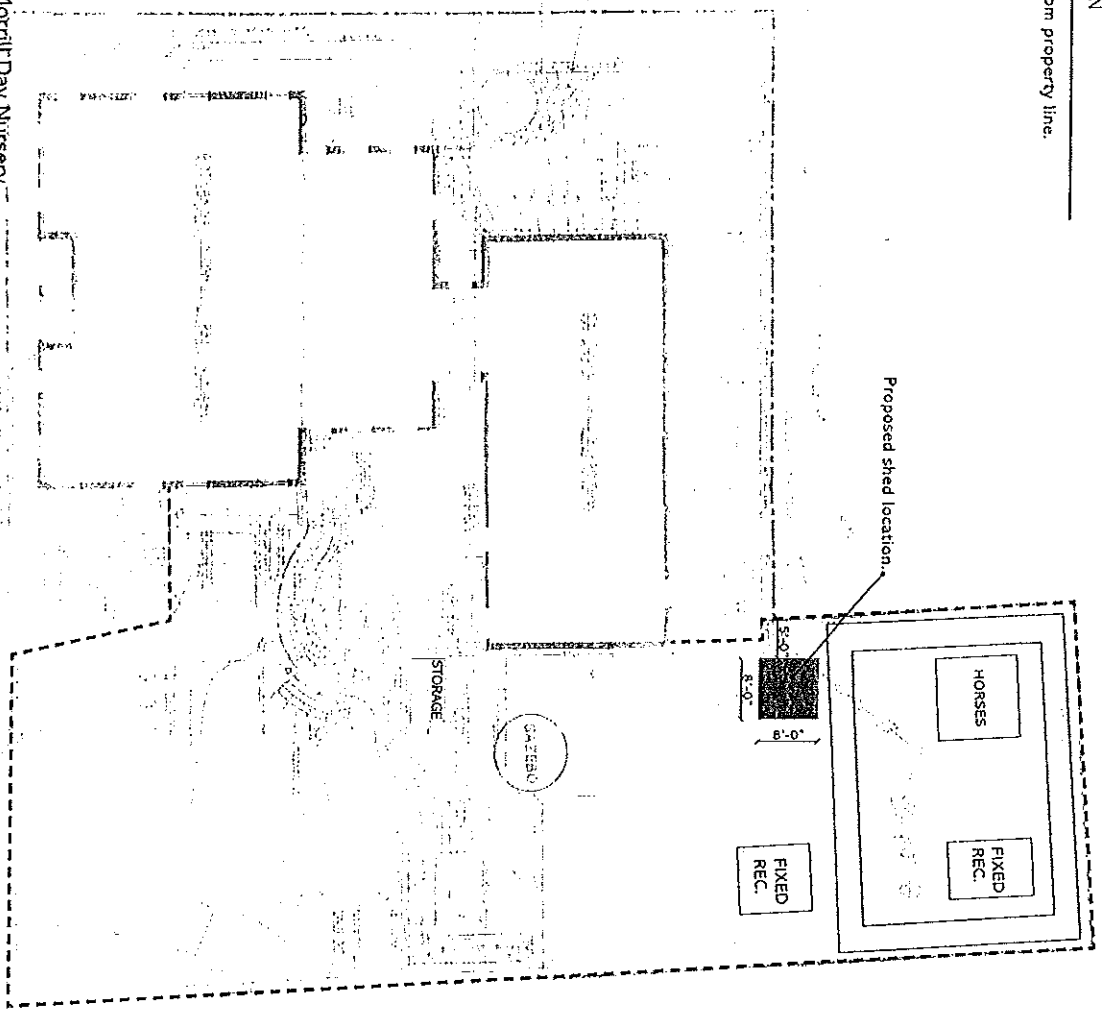

Catherine Morrill Day Nursery
Proposed She Location



CATHERINE MORRILL DAY NURSERY
50 DANFORTH ST. PORTLAND, ME.

SITE PLAN:

STEVENS ARCHITECTS
127 HILLSIDE ST. PORTLAND, ME.

DATE: _____
BY: _____
APP: _____

11-1-03



APPLICATION FOR EXEMPTION FROM SITE PLAN REVIEW

Paullette Codillo
Applicant Catherine Mould Day Nursery
96 Danforth St

6/19/08
Application Date

Applicant's Mailing Address
Paullette - 874-1115
Consultant/Agent/Phone Number

Project Name/Description
96 Danforth St
Address of Proposed Site

CBL: 44-A-28

Description of Proposed Development:
erect 8' x 8' shed in rear of property
for storing children's toys

Please Attach Sketch/Plan of Proposal/Development

Criteria for Exemptions:
See Section 14-523 (4) on back side of form

- a) Within Existing Structures; No New Buildings, Demolitions or Additions
- b) Footprint Increase Less Than 500 Sq. Ft.
- c) No New Curb Cuts, Driveways, Parking Areas
- d) Curbs and Sidewalks in Sound Condition/Comply with ADA
- e) No Additional Parking/ No Traffic Increase
- f) No Stormwater Problems
- g) Sufficient Property Screening
- h) Adequate Utilities

Applicant's Assessment (Yes, No, N/A)	Planning Office Use Only
	<u>erect shed</u>
	<u>yes</u>
	<u>✓</u>
	<u>✓</u>
	<u>✓</u>
	<u>✓</u>
	<u>✓</u>
	<u>✓</u>

Planning Division Use Only

Exemption Granted Partial Exemption Exemption Denied

DEPT. OF BUILDING INSPECTION
 CITY OF PORTLAND, ME
 JUN 25 2008
 RECEIVED

Planner's Signature Barbara Bedard Date 6/25/08