

CONTRACTOR'S NAME

STATE OF MAINE  
DEPARTMENT OF CONSUMER AFFAIRS  
ELECTRICIAN LICENSE

INSPECTION:  
Will be ready on 1-27, 1982 or Will Call: \_\_\_\_\_  
CONTRACTOR'S NAME: Marino's Elec.  
ADDRESS: 68 Taft Ave., Portland, Me.  
TEL: 774-3129  
MASTER LICENSE NO.: \_\_\_\_\_ SIGNATURE OF CONTRACTOR:  
LIMITED LICENSE NO.: 2299 *Marino's Electric Co.*  
*(By J. Gerald Marino)*

INSPECTOR'S COPY — WHITE  
OFFICE COPY — CANARY  
CONTRACTOR'S COPY — GREEN

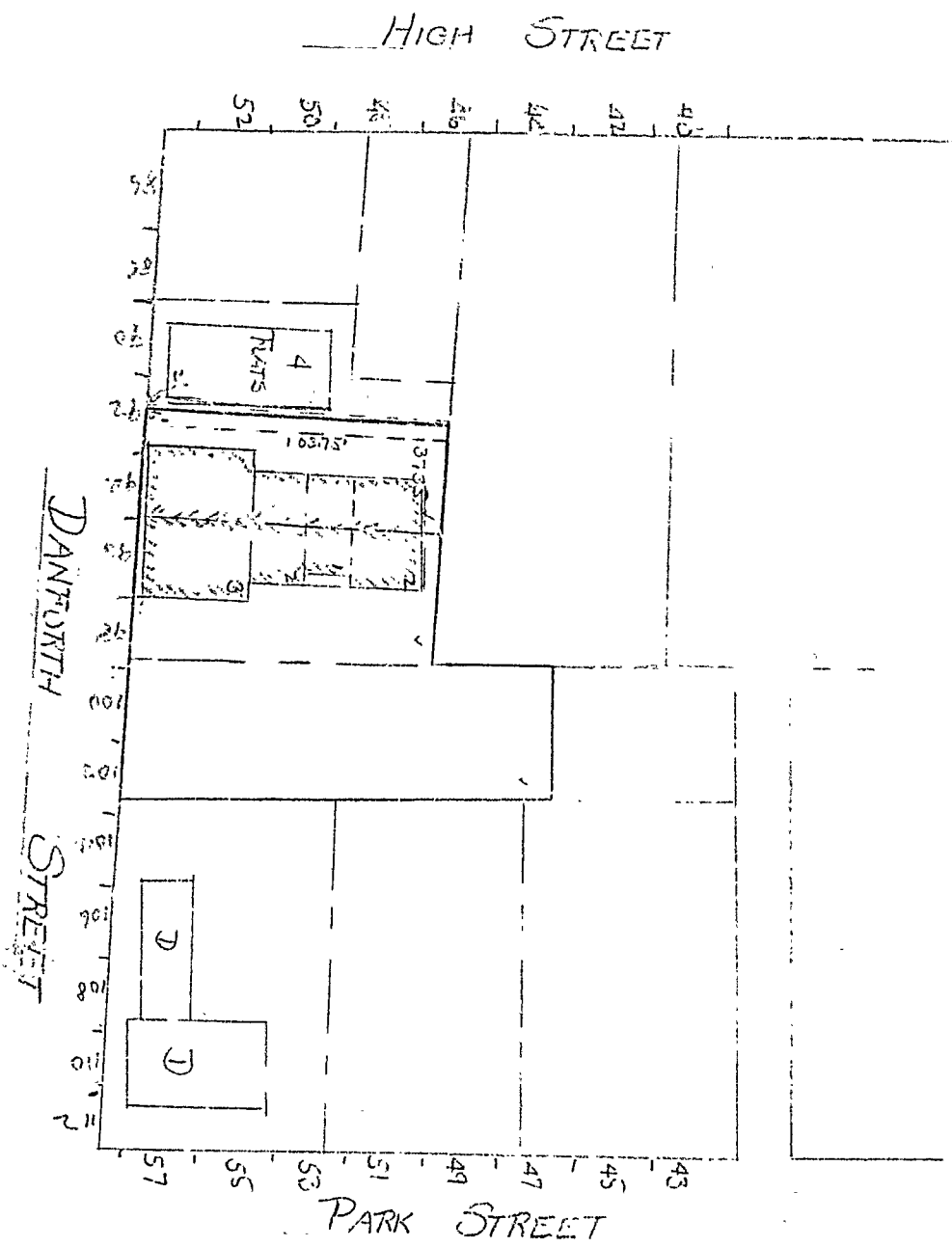

1 addendum to City Hygiene and Health Commission - 1925

AP - 92-94 Danforth St.

April 7, 1965

Miss Sigrid E. Tompkins,  
465 Congress Street

cc: Catherine Morrill Day Nursery  
96 Danforth Street

Dear Miss Tompkins:

The appeals under the Zoning Ordinance and Building Code involving the change of use of the building at the above named location to day nursery use have been sustained. Before further action can be taken by this department towards issuance of a building permit authorizing the change in use, it is necessary that the application already filed be completed by furnishing an estimated cost of the work, by paying the permit fee based thereon, and by filing complete plans of the alterations adequate to show compliance in all respects with Building Code requirements for checking and approval.

The rights granted under the Zoning Ordinance appeal will expire unless work is actually started within six months of the date on which the appeal was sustained. There is no time limit, however, on the rights granted by the Building Code appeal.

Very truly yours,

Albert J. Sears  
Director of Building Inspection

AJS/h

CITY OF PORTLAND, MAINE  
MEMORANDUM

TO: Robert W. Donovan, Asst. Corporation Counsel  
DATE: March 30, 1965

FROM: Albert J. Sears, Building Inspection Director  
cc: Fire Chief

SUBJECT: Building Code appeal by Catherine Morrill Day Nursery  
at 92-94 Danforth Street.

This organization is contemplating the purchase of the other half of the duplex building in which its operations are presently located and extending their activities into it. The nursery is classified as a Type A School under the Building Code, for which construction and safety requirements are rather severe. Since these requirements are drawn mainly with new buildings in mind, compliance with all of them usually presents problems when applied to existing buildings being converted to school use.

While the Day Nursery is willing and able to comply with a great number of the requirements as applied to the building it proposes to use, it is felt that compliance with several of them as outlined in the certification letter and the appeal would create a hardship and practical difficulties.

Since the building has masonry walls, the only deficiency as regards compliance with Code requirements concerning closeness to lot lines is in the lack of fire-resistive windows and doors in such walls. While it is contemplated that most of the existing wood sash in these walls will be replaced with metal sash, for obvious reasons it is felt desirable that plain glass instead of wire glass be used in them. Because of the considerable distance to the building on the next lot, it is felt that relief from this requirement can safely be granted.

While width of existing doors which will serve new classrooms and the widths of existing stairways and corridors are somewhat short of requirements, it is felt that, particularly in view of the limited number of pupils to be involved and their size, the existing facilities will be adequate to afford safe conditions.

Since the automatic sprinkler system in the other half of the building is to be extended to the new half, it is requested that the requirement for enclosure of the kitchen with partitions, ceilings and fire doors of one-hour fire resistance be waived in view of the protection afforded by the sprinkler system. For the same reason omission of a one-hour fire-resistive ceiling over the entire basement or cellar is also requested.

I have discussed these conditions with Fire Chief Johnson and he feels, as do I, that the appeal can safely be granted.

---

AJS/h

AP - 92-74 Danforth St.

March 30, 1965

70-5911  
Miss Sigrid E. Tompkins,  
465 Congress Street

cc: Catherine Morrill Day Nursery  
96 Danforth Street  
cc: John H. McGarrill,  
c/o MHW-FK  
615 Congress Street

Dear Miss Tompkins:

Building permit for extending day nursery use into the first and second stories of the building at the above named location and to make alterations in the other half of this duplex structure, which is presently being used for such a purpose, is not issuable under the Building Code for the following reasons:

1. The side walls are from 10 to 15 feet from the side lot line and the rear wall of a proposed enclosed play area is about 10 feet from the rear lot line; and are not of two-hour fire-resistance with fire-resistive windows as are required by Section 210-b-2 when walls of school buildings are closer than 20 feet to a lot line.
2. Existing doors serving as entrance doors to proposed classrooms are 34 inches wide in first story and 32 inches wide in second story instead of the 36 inch width required by Section 210-a-2.
3. Corridors are to be from 36 inches to 48 inches wide instead of the minimum of 54 inches required by Section 210-a-2.
4. Existing stairways are only 36 inches wide instead of the 48 inches required by Section 210-a-3.
5. Proposed kitchen in first story is not to be enclosed with partitions and ceiling of at least one-hour fire resistance as required by Section 210-f-4.
6. A ceiling of one-hour fire resistance is not to be provided over entire cellar as specified by Section 210-f-7.

We understand that the operators of the nursery school would like, because of the practical difficulty and unnecessary hardship involved in complying with the requirements outlined above, to ask the Municipal Officers (City Council) for relief from compliance with these particular requirements as permitted by Section 115-4-1 of the Building Code. Accordingly an authorized representative should come to this office to file the appeal on forms which are available here.

Very truly yours,

Director of Building Inspection

AJS/h

A.1.- 92-9, Danforth Street

March 12, 1965

Miss Sigrid A. Tompkins  
465 Congress Street

cc to: Catherine Morrill Day Nursery  
96 Danforth Street

Dear Miss Tompkins:

Check against Building Code requirements of preliminary plans for extending day nursery use into first and second stories of building at this location, including alterations in the other half of the duplex building which is presently being used for such a purpose, discloses the following variances from and questions as to compliance with such requirements:

1. No other use, except one accessory to the nursery school, is allowable in the building under the provisions of Section 210-b-1. Therefore if the third story were to be occupied at some future date for office use of another organization, a Building Code appeal would be necessary as well as compliance with whatever the Zoning Ordinance regulations might be at that time.

*3rd story*

*appeal*

2. Walls of the building closer than 20 feet to a lot line are required by Section 210-b-2 to be of two-hour fire-resistance with fire-resistive windows allowed. This restriction will apply to the side wall of the main building and the side and rear walls of the enclosed play area. Since the walls are of brick construction, they furnish the required two-hour fire-resistance, but the existing or proposed windows are not fire-resistive (metal sash and wire-glass). This may be a deficiency you will wish to include in a Building Code appeal.

*not fire resistive but glass play area*

3. The location of means of egress serving the second story are not located in relation to each other so that all occupants would surely be able to reach one of them should the use of the other be blocked by smoke or flame, and therefore does not meet the requirements of Section 212-c-1.2(a).

*fire egress*

4. The location of the two means of egress from the play area also does not comply with this requirement.

*add door less than*

5. Because of lack of knowledge of number of persons to be accommodated in the large classrooms, it is difficult to apply requirements concerning width of doors, number of exits from each room, and swing of doors as specified in Section 210-e-2.

*40 to a room*

*appeal width of doors*

March 12, 1965

- 6. Corridors are not at least 54 inches wide as required by Section 210-e-2, nor are stairways at least 42 inches wide as required by Section 210-e-3. *Appeal*
- 7. Unless the entire building is to be equipped with an automatic sprinkler system, one of the stairways from first to second story must be enclosed for safe egress or an outside fire escape provided, as specified by Section 210-e-4. *will be installed sprinkler system*
- 8. Exit lights and anti-panic hardware are required for outside exit doors in first story. See Section 210-e-8. *- OK*
- 9. A private fire alarm approved by the Fire Department is required. See Section 210-e-7. *- OK*
- 10. *OK* Width of treads and height of risers of existing stairs will need to meet requirements of Section 212-e-5.3. *- ?*
- 11. Heater is required to be enclosed with construction of at least one-hour fire resistance. See Section 210-f-2. *I will enclose*
- 12. Cellar stairs are required to be enclosed in the cellar with partitions of at least one-hour fire resistance. See Section 210-f-1. *I will do*
- 13. Kitchen must be enclosed with partitions of one-hour fire resistance. See Section 210-f-4. *= Appeal on basis of sprinkler system*
- 14. Entire cellar or basement is required to be equipped with a sprinkler system under provisions of Section 210-f-6. *- will be done*
- 15. A ceiling of one-hour fire resistance is required by Section 210-f-7 over entire cellar or basement. *- Appeal on basis of sprinkler system*
- 16. Toilet rooms are required to have waterproof and sanitary floors and bases. See Section 210-g-2. *- see health department*

Because of difficulties and hardships which are bound to arise in applying use requirements set up primarily for new buildings to existing buildings being converted to new uses, Section 115-a-1 of the Building Code authorizes the Municipal Officers (City Council) to waive its requirements where compliance with them would involve practical difficulty or unnecessary hardship and where desirable relief can be granted without substantially departing from the intent and purpose of the Code. It is likely that many of the requirements listed above fall in the category of those which the Municipal Officers have the right to waive under appeal, but it should be borne in mind that the safety of the occupants of the building and its safety features must be of primary concern in their decision as to what requirements may safely be waived.

The plans will therefore need to be developed in line with the requirements outlined above and decisions made as to which of them you wish to appeal. When that has been done, a certification letter on which an appeal can be based can be written. I will be glad to discuss with anyone what arrangements might be worked out that the Fire Chief and myself would feel able to recommend to the Municipal Officers as being adequate to provide reasonably safe conditions.

Very truly yours,

Albert J. Sears  
Building Inspection Director

AJS:m

AP - 92-94 Danforth Street

March 9, 1965

Miss Sigrid E. Tompkins  
465 Congress Street

cc: Catherine Morrill Day Nursery  
96 Danforth St.  
cc: Corporation Counsel

Dear Miss Tompkins:

Building permit for extending into the first and second stories of the building at 92-94 Danforth Street the day nursery use at 96-98 Danforth Street presently occupying the other half of the same duplex building is not issuable under the Zoning Ordinance because a nursery school is not an allowable use in the R-6 Residence Zone in which the property is located unless authorized by the Board of Appeals, as specified by Section 7-A-7b of the Ordinance.

We understand that the operators of the nursery school would like to exercise their appeal rights in this matter. Accordingly you should come to this office to file the appeal on forms which are available here.

The Zoning Ordinance also requires that there be room on the property at 92-94 Danforth Street for at least two off-street parking spaces not less than 8 feet wide and 18 feet long (one for each of the two class rooms to be provided in this half of the building), but does not apply retroactively to the other half of the building unless the number of classrooms there are to be increased. It appears from the plot plan furnished that there is ample open space on the lot to provide at least two such spaces, but if the open land is not to be used for this purpose, a request for relief from complying with the off-street parking requirements of the Ordinance should be included in the appeal.

A check of the requirements of the Building Code applying to the school use is being made insofar as is possible on the basis of the preliminary plans furnished, and information will be forthcoming in another letter as to questions which may arise concerning compliance with that ordinance.

Very truly yours,

Albert J. Sears  
Director of Building Inspection

AJS/h



R6 RESIDENCE ZONE  
APPLICATION FOR PERMIT

Class of Building or Type of Structure: Second Class  
Portland, Maine, March 8, 1965

PERMIT ISSUED  
SEP 27 1965  
CITY OF PORTLAND

To the INSPECTOR OF BUILDINGS, PORTLAND, MAINE App. completed 9-23-65

The undersigned hereby applies for a permit to erect alter repair demolish install the following building structure equipment in accordance with the Laws of the State of Maine, the Building Code and Zoning Ordinance of the City of Portland, plans and specifications, if any, submitted herewith and the following specifications:

Location 94 Danforth St. Within Fire Limits? \_\_\_\_\_ Dist. No. \_\_\_\_\_  
Owner's name and address Catherine Morrill Day Nursery, 96 Danforth St. Telephone \_\_\_\_\_  
Lessee's name and address \_\_\_\_\_ Telephone \_\_\_\_\_  
Contractor's name and address not let Telephone \_\_\_\_\_  
Architect \_\_\_\_\_ Telephone \_\_\_\_\_  
Proposed use of building Day Nursery Specifications:  es Plans  yes No. of sheets 27  
Last use \_\_\_\_\_ No. families \_\_\_\_\_  
Material brick No. stories 2 1/2 Heat \_\_\_\_\_ Style of roof \_\_\_\_\_ Roofing \_\_\_\_\_  
Other buildings on same lot \_\_\_\_\_  
Estimated cost \$ 55,000 Fee \$ 110.00

General Description of New Work

To extend day nursery use now occupying the half of duplex at #96 Danforth Street into the first two stories of the other half of the building at #94 Danforth Street, with alterations as per plans, and specifications.

This is a preliminary application to get settled the question of zoning appeal. In event the appeal is sustained the applicant will furnish complete information estimated cost and pay legal fee.

Bldg code 415/65

Appeal sustained 4/1/65

It is understood that this permit does not include installation of heating apparatus which is to be taken out separately by and in the name of the heating contractor. PERMIT TO BE ISSUED TO Catherine Morrill Day Nursery Allied Engineering Co. Inc. 381 Main St. Gorham Maine

Details of New Work

Is any plumbing involved in this work? \_\_\_\_\_ Is any electrical work involved in this work? \_\_\_\_\_  
Is connection to be made to public sewer? \_\_\_\_\_ If not, what is proposed for sewage? \_\_\_\_\_  
Has septic tank notice been sent? \_\_\_\_\_ Form notice sent? \_\_\_\_\_  
Height average grade to top of plate \_\_\_\_\_ Height average grade to highest point of roof \_\_\_\_\_  
Size, front \_\_\_\_\_ depth \_\_\_\_\_ No. stories \_\_\_\_\_ solid or filled land? \_\_\_\_\_ earth or rock? \_\_\_\_\_  
Material of foundation \_\_\_\_\_ Thickness, top \_\_\_\_\_ bottom \_\_\_\_\_ cellar \_\_\_\_\_  
Kind of roof \_\_\_\_\_ Rise per foot \_\_\_\_\_ Roof covering \_\_\_\_\_  
No. of chimneys \_\_\_\_\_ Material of chimneys \_\_\_\_\_ of lining \_\_\_\_\_ Kind of heat \_\_\_\_\_ fuel \_\_\_\_\_  
Framing Lumber—Kind \_\_\_\_\_ Dressed or full size? \_\_\_\_\_ Corner posts \_\_\_\_\_ Sills \_\_\_\_\_  
Size Girder \_\_\_\_\_ Columns under girders \_\_\_\_\_ Size \_\_\_\_\_ Max. on centers \_\_\_\_\_  
Studs (outside walls and carrying partitions) 2x4-16" O. C. Bridging in every floor and flat roof span over 3 feet.  
Joists and rafters: 1st floor \_\_\_\_\_, 2nd \_\_\_\_\_, 3rd \_\_\_\_\_, roof \_\_\_\_\_  
On centers: 1st floor \_\_\_\_\_, 2nd \_\_\_\_\_, 3rd \_\_\_\_\_, roof \_\_\_\_\_  
Maximum span: 1st floor \_\_\_\_\_, 2nd \_\_\_\_\_, 3rd \_\_\_\_\_, roof \_\_\_\_\_  
If one story building with masonry walls, thickness of walls? \_\_\_\_\_ height? \_\_\_\_\_

If a Garage

No. cars now accommodated on same lot \_\_\_\_\_, to be accommodated \_\_\_\_\_ number commercial cars to be accommodated \_\_\_\_\_  
Will automobile repairing be done other than minor repairs to cars habitually stored in the proposed building? \_\_\_\_\_

APPROVED:  
\_\_\_\_\_  
\_\_\_\_\_  
\_\_\_\_\_

Miscellaneous

Will work require disturbing of any tree on a public street? no  
Will there be in charge of the above work a person competent to see that the State and City requirements pertaining thereto are observed? yes

Catherine Morrill Day Nursery

INSPECTION COPY

Signature of owner by:

*[Handwritten Signature]*



Granted 7/1/65  
65/32

CITY OF PORTLAND, MAINE  
IN THE BOARD OF APPEALS

VARIANCE APPEAL

Catherine Morrill Day Nursery, owner of property at 92-94 Danforth Street under the provisions of Section 24 of the Zoning Ordinance of the City of Portland, hereby respectfully petitions the Board of Appeals for a variance from the provisions of said Ordinance to permit: (1) extending into the first and second stories of the above building the day nursery use at 96-98 Danforth Street; (2) two off-street parking spaces required by Section 14-B-4 of the Ordinance are not to be provided. This permit is presently not issuable under the Zoning Ordinance because a nursery school is not an allowable use in the R-6 Residence Zone in which the property is located.

LEGAL BASIS OF APPEAL: Such variance may be granted only if the Board of Appeals finds that the strict application of the provisions of the Ordinance would result in undue hardship in the development of property which is inconsistent with the intent and purpose of the Ordinance; that there are exceptional or unique circumstances relating to the property that do not generally apply to other property in the same zone or neighborhood, which have not arisen as a result of action of the applicant subsequent to the adoption of this Ordinance whether in violation of the provisions of the Ordinance or not; that property in the same zone or neighborhood will not be adversely affected by the granting of the variance; and that the granting of the variance will not be contrary to the intent and purpose of the Ordinance.

Catherine Morrill Day Nursery

By: [Signature]  
APPELLANT

DECISION

After public hearing held April 1, 1965, the Board of Appeals finds that all of the above conditions do exist with respect to this property and that a variance should be granted in this case.

It is, therefore, determined that a variance from the provisions of the Zoning Ordinance should be granted in this case.

[Signature]  
[Signature]  
[Signature]  
BOARD OF APPEALS

AP - 92-94 Danforth Street

March 9, 1965

Miss Sigrid E. Tompkins  
465 Congress Street

cc: Catherine Morrill Day Nursery  
96 Danforth St.  
cc. Corporation Counsel

Dear Miss Tompkins:

Building permit for extending into the first and second stories of the building at 92-94 Danforth Street the day nursery use at 96-98 Danforth Street presently occupying the other half of the same duplex building is not issuable under the Zoning Ordinance because a nursery school is not an allowable use in the R-6 Residence Zone in which the property is located unless authorized by the Board of Appeals, as specified by Section 7-A-7b of the Ordinance.

We understand that the operators of the nursery school would like to exercise their appeal rights in this matter. Accordingly you should come to this office to file the appeal on forms which are available here.

The Zoning Ordinance also requires that there be room on the property at 92-94 Danforth Street for at least two off-street parking spaces not less than 8 feet wide and 18 feet long (one for each of the two class rooms to be provided in this half of the building), but does not apply retroactively to the other half of the building unless the number of classrooms there are to be increased. It appears from the plot plan furnished that there is ample open space on the lot to provide at least two such spaces, but if the open land is not to be used for this purpose, a request for relief from complying with the off-street parking requirements of the Ordinance should be included in the appeal.

A check of the requirements of the Building Code applying to the school use is being made insofar as is possible on the basis of the preliminary plans furnished, and information will be forthcoming in another letter as to questions which may arise concerning compliance with that ordinance.

Very truly yours,

Albert J. Sears  
Director of Building Inspection

AJS/h

CITY OF PORTLAND, MAINE  
IN THE BOARD OF APPEALS

March 23, 1965

TO WHOM IT MAY CONCERN:

The Board of Appeals will hold a public hearing in the Council Chamber at City Hall, Portland, Maine, on Thursday, April 1, 1965, at 4:00 p.m. to hear the appeal of Catherine Morrill Day Nursery requesting exception to the Zoning Ordinance to permit extending into the first and second stories of the building at 92-94 Danforth Street the day nursery use at 96-98 Danforth Street; two off-street parking spaces required by Section 14-B-4 of the Ordinance are not to be provided.

This permit is presently not issuable under the Zoning Ordinance because a nursery school is not an allowable use in the R-6 Residence Zone in which the property is located.

This appeal is taken under Section 24 of the Zoning Ordinance which provides such variance may be granted only if the Board of Appeals finds that the strict application of the provisions of the Ordinance would result in undue hardship in the development of property which is inconsistent with the intent and purpose of the Ordinance; that there are exceptional or unique circumstances relating to the property that do not generally apply to other property in the same zone or neighborhood, which have not arisen as a result of action of the applicant subsequent to the adoption of this Ordinance or not; that property in the same zone or neighborhood will not be adversely affected by the granting of the variance; and that the granting of the variance will not be contrary to the intent and purpose of the Ordinance.

All persons interested either for or against this appeal will be heard at the above time and place, this notice of required public hearing having been sent to the owners of property within 500 feet of the property in question as required by Ordinance.

BOARD OF APPEALS

Franklin G. Hinckley

Chairman

h

April 7, 1965

Catherine Morrill Day Nursery  
c/o Miss Sigrid Tompkins  
455 Congress Street

Dear Miss Tompkins:

Enclosed please find copy of the decision of the Board of Appeals relating to the request of Catherine Morrill Day Nursery to permit extending into the first and second stories of the building at 92-94 Danforth Street the day nursery use at 96-98 Danforth Street.

It will be noted that this appeal was granted.

Very truly yours,

Robert W. Donovan  
Assistant Corporation Counsel

h  
Enclosure (1)

City of Portland, Maine  
Municipal Officers  
BUILDING CODE

6.7/35  
granted conditionally 4/6/65

March 30, 1965

To the Municipal Officers:

Your appellant, **Catherina Morrill Day Nursery**, who is the **owner** of property at **92-94 Lenforth Street**, respectfully petitions the Municipal Officers of the City of Portland to permit an exception to the provisions of the Building Code relating to this property, as provided by Section 115, Paragraph A of said Building Code, to permit extending day nursery use into the first and second stories of this building and to make alterations in the other half of this duplex structure, which is presently being used for such a purpose. This permit is presently not issuable under the Building Code because: (1) The side walls are from 10 to 15 feet from the side lot line and the rear walls of a proposed enclosed play area is about 10 feet from the rear lot line; and are not of two-hour fire-resistance with fire-resistive windows as are required by Section 210-b-2 when walls of school buildings are closer than 20 feet to a lot line; (2) Existing doors serving as entrance doors to proposed classrooms are 34 inches wide in first story and 32 inches wide in second story instead of the 36 inch width required by Section 210-e-2; (3) Corridors are to be from 36 inches to 48 inches wide instead of the minimum of 54 inches required by Section 210-e-2; (4) Existing stairways are only 35 inches wide instead of the 42 inches required by Section 210-e-3; (5) Proposed kitchen in first story is not to be enclosed with partitions and ceiling of at least one-hour fire resistance as required by Section 210-f-4; (6) A ceiling of one-hour fire resistance is not to be provided over entire cellar as specified by Section 210-f-7.

The facts and conditions which make this exception legally permissible are as follows: An exception may be granted if the Municipal Officers find that enforcement of the Building Code would involve practical difficulty and desirable relief may be granted without substantially departing from the intent and purpose of the Code.

By: *Catherina Morrill Day Nursery*  
Appellant

After public hearing held on the 5th day of April, 1965, the Municipal Officers find that an exception is granted conditionally, condition being that the building shall be open to the public.

It is, therefore, determined that exception to the Building Code may be permitted in this specific case.

*Charles W. Rubin*  
*Donald K. Bishop*  
*Clifton M. Pike*  
*Richard B. White*  
*J. Weston White*  
MUNICIPAL OFFICERS



April 7, 1965

Catherine Day Morrill Day Nursery  
c/o Miss Sigrid Tompkins  
465 Congress Street

Dear Miss Tompkins:

Enclosed please find copy of the decision of the Municipal Officers relating to your request to extend day nursery use into the first and second stories of the building at 92-94 Danforth Street without providing certain requirements under the Building Code.

It will be noted that this request was granted conditionally.

Very truly yours,

Robert W. Donovan  
Assistant Corporation Counsel

h  
Enclosure (1)



FILL IN AND SIGN WITH INK

### APPLICATION FOR PERMIT FOR HEATING, COOKING OR POWER EQUIPMENT

Portland, Maine, October 20, 1959

To the INSPECTOR OF BUILDINGS, PORTLAND, ME.

The undersigned hereby applies for a permit to install the following heating, cooking or power equipment in accordance with the Laws of Maine, the Building Code of the City of Portland, and the following specifications:

Location 82 Bennett St. Use of Building  Dwelling  No Store   Existing Building

Name and address of owner of appliance George W. Matthews, 82 Bennett St.

Installer's name and address Matthews Heating Corp., 125 1/2 St. Telephone

#### General Description of Work

To install oil burning equipment in connection with existing steam heat (conversion)

#### IF HEATER OR POWER BOILER

Location of appliance Any burnable material in floor surface or beneath?

If so, how protected? Kind of fuel?

Minimum distance to burnable material, from top of appliance or casing top of furnace

From top of smoke pipe From front of appliance From sides or back of appliance

Size of chimney flue Other connections to same flue

Is gas fired, how vented? Rated maximum demand per hour

Will sufficient fresh air be supplied to the appliance to insure proper and safe combustion?

#### IF OIL BURNER

Name and type of burner Weaver-Brooks Labeled by underwriters' laboratories?

Will operator be always in attendance? Does oil supply line feed from top or bottom of tank?

Type of floor beneath burner concrete Size of vent pipe 1-0

Location of oil storage basement Number and capacity of tanks 2-270 gal. No. 67

Low water shut off McInnell-Miller Make

Will all tanks be more than five feet from any flame?  yes How many tanks enclosed? none

Total capacity of any existing storage tanks for furnace burner

#### IF COOKING APPLIANCE

Location of appliance Any burnable material in floor surface or beneath?

If so, how protected? Height of legs, if any

Skirting at bottom of appliance? Distance to combustible material from top of appliance

From front of appliance From sides and back From top of smoke pipe

Size of chimney flue Other connections to same flue

Is hood to be provided? If so, how vented? Forced or gravity?

If gas fired, how vented? Rated maximum demand per hour

#### MISCELLANEOUS EQUIPMENT OR SPECIAL INFORMATION

Amount of fee enclosed? 2.00 (\$2.00 for one heater, etc., 50 cents additional for each additional heater, etc., in same building at same time.)

APPROVED: *OK 10-20-59 R.M.G.*

Will there be in charge of the above work a person competent to see that the State and City requirements pertaining thereto are observed?  yes Matthews Heating Corp.

Signature of Installer by: \_\_\_\_\_

10-36

Permit No. 59/1579  
Location 921 Hampshire St  
Owner Acipal Corp  
Date of permit 11-21-59  
Approved 11-20-59 W.A.T.

NOTES

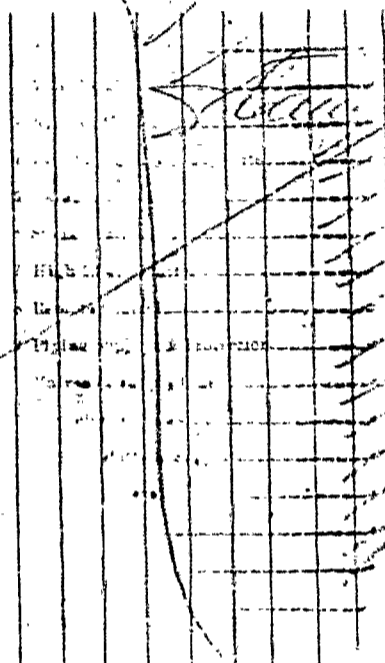



APARTMENT HOUSE ZONE  
APPLICATION FOR PERMIT

Class of Building or Type of Structure Installation

Portland, Maine, June 15, 1949

PERMIT ISSUED  
JUN 17 1949  
CITY of PORTLAND

To the INSPECTOR OF BUILDINGS, PORTLAND, MAINE

The undersigned hereby applies for a permit to ~~erect~~ ~~repair~~ ~~and~~ ~~install~~ the following building structure equipment in accordance with the Laws of the State of Maine, the Building Code and Zoning Ordinance of the City of Portland, plans and specifications, if any, submitted herewith and the following specifications:

Location 92 Danforth Street Within Fire Limits? \_\_\_\_\_ Dist. No. \_\_\_\_\_  
 Owner's name and address A. Seigal, 30 Danforth Street Telephone \_\_\_\_\_  
 Lessee's name and address \_\_\_\_\_ Telephone \_\_\_\_\_  
 Contractor's name and address Milliken Bros., 14 Temple Street Telephone \_\_\_\_\_  
 Architect \_\_\_\_\_ Telephone \_\_\_\_\_  
 Proposed use of building Apartment house Specifications \_\_\_\_\_ Plans no No. of sheets \_\_\_\_\_  
 Last use \_\_\_\_\_ " " \_\_\_\_\_ No. families \_\_\_\_\_  
 Material brick No. stories 4 Heat \_\_\_\_\_ Style of roof \_\_\_\_\_ Roofing \_\_\_\_\_  
 Other buildings on same lot \_\_\_\_\_  
 Estimated cost \$ \_\_\_\_\_ Fee \$ 1.00

General Description of New Work

To install automatic fire alarm using protective lines or fire-detecting wire (made by The Protector Fire Co.) not more than 15' apart nor more than 7' 6" from any wall or partition extending to ceiling, to cover entire basement or cellar and sub-cellar, if any, all public and stair halls, all closets or halls or under stairs, all hazardous rooms and attached garage, if any, gongs, of such tone, strength of signal, number and location as to arouse all persons for whose protection intended—current by dry batteries of capacity to ring all gongs simultaneously at full signal strength, to operate system for at least one year, installed in substantial cabinet of no less than 14 gauge steel or well-seasoned wood at least 3/4" thick with hinged door and catch and located not less than 6" nor more than 6' above floor in dry, clean place where temperature will not go below 40 degrees F. nor above 100 degrees—test button rigidly fastened in place, conveniently located to permit and capable of testing entire system frequently. Alarm silencing switch, if provided will be so arranged that alarm will sound if switch is thrown to "silent" position when alarm is not sounding. Installer will fasten to control box full instructions as to operation and testing of system and where and how to secure servicing if system gets out of order.

It is understood that this permit does not include installation of heating apparatus which is to be taken out separately by and in the name of the heating contractor. PERMIT TO BE ISSUED TO Milliken Bros.  
None Sent to Fire Code?

Details of New Work

Is any plumbing involved in this work? \_\_\_\_\_ Is any electrical work involved in this work? \_\_\_\_\_  
 Height average grade to top of plate \_\_\_\_\_ Height average grade to highest point of roof \_\_\_\_\_  
 Size, front \_\_\_\_\_ depth \_\_\_\_\_ No. stories \_\_\_\_\_ solid or filled land? \_\_\_\_\_ earth or rock? \_\_\_\_\_  
 Material of foundation \_\_\_\_\_ Thickness, top \_\_\_\_\_ bottom \_\_\_\_\_ cellar \_\_\_\_\_  
 Material of underpinning \_\_\_\_\_ Height \_\_\_\_\_ Thickness \_\_\_\_\_  
 Kind of roof \_\_\_\_\_ Rise per foot \_\_\_\_\_ Roof covering \_\_\_\_\_  
 No. of chimneys \_\_\_\_\_ Material of chimneys \_\_\_\_\_ of lining \_\_\_\_\_ Kind of heat \_\_\_\_\_ fuel \_\_\_\_\_  
 Framing lumber—Kind \_\_\_\_\_ Dressed or full size? \_\_\_\_\_  
 Corner posts \_\_\_\_\_ Sill's \_\_\_\_\_ Girt or ledger board? \_\_\_\_\_ Size \_\_\_\_\_  
 Girders \_\_\_\_\_ Size \_\_\_\_\_ Columns under girders \_\_\_\_\_ Size \_\_\_\_\_ Max. on centers \_\_\_\_\_  
 Studs (outside walls and carrying partitions) 2x4-16" O. C. Bridging in every floor and flat roof span over 8 feet.  
 Joists and rafters: 1st floor \_\_\_\_\_, 2nd \_\_\_\_\_, 3rd \_\_\_\_\_, roof \_\_\_\_\_  
 On centers: 1st floor \_\_\_\_\_, 2nd \_\_\_\_\_, 3rd \_\_\_\_\_, roof \_\_\_\_\_  
 Maximum span: 1st floor \_\_\_\_\_, 2nd \_\_\_\_\_, 3rd \_\_\_\_\_, roof \_\_\_\_\_  
 If one story building with masonry walls, thickness of walls? \_\_\_\_\_ height? \_\_\_\_\_

If a Garage

No. cars now accommodated on same lot \_\_\_\_\_, to be accommodated \_\_\_\_\_ number commercial cars to be accommodated \_\_\_\_\_  
 Will automobile repairing be done other than minor repairs to cars habitually stored in the proposed building? \_\_\_\_\_

APPROVED:

OK 6-16-49. [Signature]

Miscellaneous

Will work require disturbing of any tree on a public street? no  
 Will there be in charge of the above work a person competent to see that the State and City requirements pertaining thereto are observed? yes

A. Seigal

Signature of owner

[Signature]

INSPECTION COPY

NOTES

6-21-49. Edwards 33. Kings  
 One on second - one on  
 fourth - then second to  
 third floor transition, part  
 the structure of "lead" is  
 stairs is shown, and  
 the wire is "run" along the  
 the landing, under the  
 third floor <sup>stairs</sup> on the east side  
 of the stair way, which faces  
 the hall way.  
 No instruction in Central file.

Permit No. 219/985  
 Location 92 Orchard St. N.  
 Owner A. Edwards  
 Date of permit 6/17/49  
 Notif. closing-in  
 Inspn. closing-in  
 Final Notif.  
 Final Inspn. 6-24/49  
 Cert. of Occupancy issued

7-5-49

MEMORANDUM FROM DEPARTMENT OF BUILDING INSPECTION, PORTLAND, MAINE  
32 Danforth Street—Installation of automatic fire alarm system by Mr. A. Seigel  
by Williken Bros., Installers

When such a system has been installed, the owner and lessee of the building are responsible for keeping the system in working order at all times so that the system may always be on guard to warn the occupants of the building in case a fire starts. To discharge this responsibility and to have good assurance that he will not be held either financially or criminally liable in case of injury or loss of life in his building due to fire, it is my belief that the owner and lessee must see to it that the alarm system is tested every twenty-four hours. This may be done by merely pressing very briefly the test button to see if the bells ring loud and clear.

Most of these systems have dry batteries for their power, and the batteries will deteriorate in time so that they will not ring the alarm bells satisfactorily, if at all. If the batteries are used briefly by this test every day, they will last longer than when tested less frequently. We try to have one of our inspectors test each system once a month, but that is not often enough by a great deal.

Because this is a safety device whenever it is found that the bells do not ring loud and clear or any other defect appears in the system, the owner or his agent should notify immediately some predetermined party who has agreed in advance to come at once and service the system, whether day or night, Sundays or holidays.

It is recommended that the name of such a party and the address and telephone number be posted permanently on or in the control box of the system.

W McD/G

CC: Mr. A. Seigel  
32 Danforth Street

(Signed) WARREN McDONALD

INSPECTOR OF BUILDINGS

92 Lanforth Street-  
(Automatic fire detection  
and alarm system)-1

June 17, 1949

Mr. A. Seigel  
30 Lanforth Street  
Milliken Brothers  
43 Temple Street

Subject: Permit for installation of automatic  
fire detection and alarm system at 92 Lan-  
forth Street, and question of size, number  
and location of alarm bells in connection  
therewith

Gentlemen:

Permit for the above installation is issued subject to the following:

The important question has arisen as to the adequacy of alarm bells in such a system, in size, number and location, to "unmistakably arouse and warn all persons for whose protection they are intended", as the building code stipulates. If owner and installer of this particular system are not willing to abide by the decision of our inspector as to the size, number and location of these bells to accomplish the stated purpose of the building code, the work of installation should not be started, but bell specifications as to the proposed size, number and location of such bells should be furnished here on a plan which is intelligible to us and which shows the relative location of the bells above the first story and the distances to apartments and location of bedrooms above the first story. It must be borne in mind that the size, number and location of these bells must be such as to unmistakably arouse every person that may be asleep in any part of the building above or below the first story. It is certainly not sufficient to judge by a person hearing the bells when he is wide awake and listening for them.

This is a most troublesome question, and we are keenly aware of the difficulties of an installer as well as an owner in the matter of arranging a contract price for installation of a system, especially when more than one installer is competing for the job. It is certainly desirable that some standard may be arrived at so that all installers will have a good idea as to the necessary size, number and location of the bells. Since each building is different, however, although we have been trying for some time to work out some rules, it seems unlikely that we will be able to find any formula that will determine the issue in every case. In the meantime we are compelled to go ahead and issue permits so that the work may go on, and the only basis upon which we can do it is on the basis that both owner and installer will be willing to adjust the matter to the satisfaction of this department and reasonable share any extra cost that may be incurred.

It is not practicable for an inspector from this department to go to each job in advance and determine the size, number and location of the required bells. We are, however, trying to work out some sort of guide, and in the meantime it seems only reasonable that the owner should pay for additional bells, since the determination of the size, number and location is not, for the present at least, an issue which an installer can know about in advance. We will be able to help in this connection before the installation is started if reasonable layout plans are furnished showing the information indicated above.

Very truly yours,

Inspector of Buildings

WCS/S

P. S. We have reached the conclusion that only bells approved by Underwriters Laboratories, Inc. will be acceptable.

(COPY)

3-15



## City of Portland, Maine

Appeal to the Municipal Officers to Change the Decision of the  
Inspector of Buildings Relating to the Property Owned  
by Harold E. Craven at 94 Danforth Street

February 26, 19 30

To the Municipal Officers:

Your appellant, Harold E. Craven  
who is the owner of property at 94 Danforth Street  
respectfully petitions the Municipal Officers of the City of Portland to change the decision of  
the Inspector of Buildings relating to this property, as provided by Section 13, Paragraph c  
of the Zoning Ordinance, on the ground that the enforcement of the ordinance in this case  
involves unnecessary hardship and because relief may be granted without substantially der-  
ogating from the intent and purpose of the Zoning Ordinance.

The decision of the Inspector of Buildings denies a permit to alter  
the first story of this building and provide an addition in front for the  
purpose of establishing a small retail store in the front part of the  
first story only on the ground that the proposed use is a non-conforming  
one in the Apartment House Zone where the property is located, and because  
the proposed addition would be closer to the street line than ordinarily  
permitted in such a zone.

The reasons for the appeal are as follows: The appellant owns or  
controls two apartment houses on this property and on a lot next to it,  
these buildings housing eighteen families or more. It is his belief that  
he can operate a small grocery store and with the patronage of these  
families as a basis do a profitable business. He believes it is an  
unnecessary hardship upon him to be forced to forego this opportunity.  
He further believes from the fact that the proposed location is only a  
few feet removed from a Limited Business Zone that the store may be  
established without departing substantially from the intent and purpose  
of the Zoning Law.

---

30/5

51073-

March 19, 1930

Mr. H. E. Croves  
92 Danforth Street  
Portland, Maine

Dear Sir:

On March 17th, the Board of Municipal Officers voted to deny your appeal seeking a change in the decision of the Inspector of Buildings with relation to the establishment of a retail store at 94 Danforth Street.

If you will return the receipt for the fee paid to this of fee, your money will be refunded by voucher.

Very truly yours,

Inspector of Buildings.

RM/HC  
CC-Porter-Burnham Co.  
Mr. Leo Sheshong

30/5

Catherine Morrill Day Nursery  
96 Danforth Street  
Portland, Maine

March 12-1930

To whom it may concern -

A store

at 94 Danforth would be an  
advantage to us rather than  
otherwise and we certainly have  
no objections to its being there.

Marion C Holt

Clinton Corey 57 State St.

Mrs Mary A Kirwin 78 Danforth

Mrs C. J. Greenier 55 High St.

15 Danforth

39/5

XXXXXXXXXXXXXXXXXX

IN THE BOARD OF MUNICIPAL OFFICERS

March 14, 1930.

To the Board of Municipal Officers:

The Committee on Zoning and Building Ordinance Appeals to whom was referred the appeal of Harold E. Craven who seeks a change in the decision of the Inspector of Buildings so that he may be permitted to establish a small retail grocery store in the Apartment House Zone at 94 Danforth Street, reports as follows:

A public hearing has been held upon this appeal at which several of the neighboring property owners were represented to be in opposition to the appeal.

Within a short distance from the proposed store is an existing store in the same line of business which appears to obviate any claim of public necessity for the establishment of this store as a non-conforming use.

Recommended that the appeal be denied.

COMMITTEE ON ZONING AND BUILDING  
ORDINANCE APPEALS.

\_\_\_\_\_  
Chairman

\_\_\_\_\_  
\_\_\_\_\_

30/5

March 14, 1930.

PUBLIC HEARING UPON APPEAL OF HAROLD E. CRAVEN AT  
94 DANFORTH STREET.

A public hearing upon the above appeal was held before the Committee on Zoning and Building Ordinance Appeals Wednesday afternoon March 12th. Councillors Wallace, Mrs. Stevens, and Mr. Craig, City Manager, Corporation Counsel, and Inspector of Buildings were present on behalf of the City. Attorney Sheshong appeared representing Mr. Craven in support of the appeal. Mr. Sheshong stressed the closeness of the proposed store to the Limited Business Zone, and submitted a letter signed by three persons (attached) who stated that the store would be an advantage to them, and that they had no objections.

Attorneys Francis Sullivan and Thomas Talbot appeared in opposition representing various property owners in the vicinity, Mr. Talbot representing the Talbot Heirs, owners of property on the corner of Park and Danforth Streets. Mr. Sullivan reported that he had interviewed various residents and property owners in the vicinity, and stated that Mr. Cutter, agent of the J. R. Libby Heirs at 109 Danforth Street, and that the Richardsens at 97 Danforth Street were opposed to the store. Mr. Talbot stated that there appeared to be no public necessity of an additional store as there was already one grocery store a short distance away toward High Street located in the Limited Business Zone.

Inspector of Buildings.

30/5

XXXXXXXXXXXXXX

IN THE BOARD OF MUNICIPAL OFFICERS

March 3, 1930

To Whom It May Concern:

A public hearing will be held before the Committee on Zoning and Building Ordinance Appeals of the Board of Municipal Officers at Room 35, City Hall, Wednesday March 12th at four o'clock in the afternoon upon the appeal of Harold E. Craven with relation to his property at 94 Danforth Street.

Mr. Craven, the appellant, has been denied a building permit to erect a one story brick addition four feet by sixteen feet on the front of his building at 94 Danforth Street, and to convert the front room of the existing building for use as a retail store in connection with the proposed addition on the ground that such a use is not permissible under the Zoning Law in the Apartment House Zone where the property is located.

The appellant states that he proposes to operate in this building a small grocery store, and that he believes an unnecessary hardship is being worked upon him if he is forced to forego this opportunity of establishing a small but in his belief a profitable business. He further states that he believes the permit may be granted without departing substantially from the intent and purpose of the Zoning Law on account of the fact that his building is but a few feet removed from a Limited Business Zone where the store would be permitted.

All persons interested either for or against this appeal will be heard at the above time and place.

COMMITTEE ON ZONING AND BUILDING  
ORDINANCE APPEALS.

LESTER F. WALLACE, Chairman

CC-Mr. Francis Sullivan- Attorney

30/5

XXXXXXXXXXXX  
IN THE BOARD OF MUNICIPAL OFFICERS

March 8, 1930

Mr. Harold E. Craven  
92 Danforth Street  
Portland, Maine

Dear Sir:

A public hearing will be held before the Committee on Zoning and Building Ordinance Appeals of the Board of Municipal Officers at Room 35, City Hall, Wednesday March 13th at four o'clock in the afternoon upon your appeal relating to the construction of a store as an addition to your building at 94 Danforth Street.

You should be present at this hearing or represented in support of your appeal, as failure to be so represented will be considered equivalent to withdrawal of the appeal, and will be so reported to the Board of Municipal Officers.

COMMITTEE ON ZONING AND BUILDING  
ORDINANCE APPEALS.

LESTER F. WALLACE, Chairman

CC- Porter-Burnham Co.





Permit No. \_\_\_\_\_

**APPLICATION FOR PERMIT**Class of Building or Type of Structure Second ClassPortland, Maine, February 24, 1930

To the INSPECTOR OF BUILDINGS, PORTLAND, ME.

The undersigned hereby applies for a permit to erect alter ~~install~~ the following building structure equipment in accordance with the Laws of the State of Maine, the Building Code of the City of Portland, plans and specifications, if any, submitted herewith and the following specifications:

Location 94 Danforth Street Ward 5 Within Fire Limits: Yes Dist. No. 1  
 Owner's or Lessee's name and address H. E. Craven, 94 Danforth St. Telephone \_\_\_\_\_  
 Contractor's name and address Porter-Burnham Co., 157 Kennebec St. Telephone F 5672  
 Architect's name and address \_\_\_\_\_  
 Proposed use of building Store and tenements No. families 4  
 Other buildings on same lot \_\_\_\_\_

## Description of Present Building to be Altered

Material brick No. stories 2 Heat \_\_\_\_\_ Style of roof \_\_\_\_\_ Roofing \_\_\_\_\_  
 Last use tenement house No. families 4

## General Description of New Work

To erect one story brick addition 4' x 16' on front of building  
 To lower floor of one room in front of building about 3', 0-4 using brick piers for support

## Details of New Work

Size, front \_\_\_\_\_ depth \_\_\_\_\_ No. stories \_\_\_\_\_ Height average grade to highest point of roof \_\_\_\_\_  
 To be erected on solid or filled land? solid earth or rock? earth  
 Material of foundation brick & mortar Thickness, top 10" bottom 12"  
 Material of underpinning \_\_\_\_\_ Height \_\_\_\_\_ Thickness \_\_\_\_\_  
 Kind of roof flat 1/2" to foot Roof covering Tary and gravel 5 ply  
 No. of chimneys no Material of chimneys \_\_\_\_\_ of lining \_\_\_\_\_  
 Kind of heat no change Type of fuel \_\_\_\_\_ Distance, heater to chimney \_\_\_\_\_  
 If oil burner, name and model \_\_\_\_\_  
 Capacity and location of oil tanks \_\_\_\_\_  
 Is gas fitting involved? \_\_\_\_\_ Size of service \_\_\_\_\_  
 Corner posts \_\_\_\_\_ Sills \_\_\_\_\_ Girt or ledger board? \_\_\_\_\_ Size \_\_\_\_\_  
 Material columns under girders \_\_\_\_\_ Size \_\_\_\_\_ Max. on centers \_\_\_\_\_  
 Studs (outside walls and carrying partitions) 2x4-16" O.C. Girders 6x8 or larger. Bridging in every floor and flat roof span over 8 feet. Sills and corner posts all one piece in cross section.  
 Joists and rafters: 1st floor 2x8, 2nd \_\_\_\_\_, 3rd \_\_\_\_\_, roof 2x8  
 On centers: 1st floor 16", 2nd \_\_\_\_\_, 3rd \_\_\_\_\_, roof 20"  
 Maximum span: 1st floor 3 1/2', 2nd \_\_\_\_\_, 3rd \_\_\_\_\_, roof 4'  
 If one story building with masonry walls, thickness of walls? \_\_\_\_\_ height? \_\_\_\_\_

## If a Garage

No. cars now accommodated on same lot \_\_\_\_\_, to be accommodated \_\_\_\_\_  
 Total number commercial cars to be accommodated \_\_\_\_\_  
 Will automobile repairing be done other than minor repairs to cars habitually stored in the proposed building? \_\_\_\_\_

## Miscellaneous

Will above work involve removal or disturbing of any shade tree on a public street? no  
 Plans filed as \_\_\_\_\_ his application? yes No. sheets 2  
 Estimated cost \_\_\_\_\_ Fee \$ \_\_\_\_\_  
 Will there be \_\_\_\_\_ ve work a person competent to see that the State and City \_\_\_\_\_ cements \_\_\_\_\_ neto  
 are observed? \_\_\_\_\_

INSPECTION COPY

By Porter-Burnham Co.  
 Signature of owner H. E. Craven

Ward 5 Permit No. 30/

Location 94 Danforth St.

Owner H. E. Claren

Date of permit \_\_\_\_\_

Notif. closing-in \_\_\_\_\_

Inspn. closing-in \_\_\_\_\_

Final Notif. \_\_\_\_\_

Final Inspn. \_\_\_\_\_

Cert. of Occupancy issued \_\_\_\_\_

NOTES

Commit denied of:  
attached to  
ment home.  
old until until  
road of is  
whether this  
plication will  
reworked to  
unit 2 - can  
page.

Ward  
8/24/24



# APPLICATION FOR PERMIT

Permit No. \_\_\_\_\_

Class of Building or Type of Structure Second Class

Portland, Maine, October 11, 1929

To the INSPECTOR OF BUILDINGS, PORTLAND, ME.

The undersigned hereby applies for a permit to ~~erect~~ alter ~~install~~ the following building structure equipment in accordance with the Laws of the State of Maine, the Building Code of the City of Portland, plans and specifications, if any, submitted herewith and the following specifications:

Location 88 94 Danforth Street Ward 5 Within Fire Limits? Yes Dist. No. 1

Owner's or Lessee's name and address Mrs. Harold E. Craven, 92 Danforth St. Telephone \_\_\_\_\_

Contractor's name and address Thomas Skinner Co., 127 Main St. So. Port Telephone F 7738

Architect's name and address \_\_\_\_\_ Telephone \_\_\_\_\_

Proposed use of building dwelling house and dead storage of automobiles No. families 2

Other buildings on same lot 10 family tenement house

### Description of Present Building to be Altered

Material brick No. stories \_\_\_\_\_ Heat \_\_\_\_\_ Style of roof \_\_\_\_\_ Roofing \_\_\_\_\_

Last use 2 family dwelling house No. families 2

### General Description of New Work

To erect one story metal addition 22' x 28' (app.) for dead storage of automobiles  
angle iron frame

### Details of New Work

Size, front \_\_\_\_\_ depth \_\_\_\_\_ No. stories 1 Height average grade to highest point of roof 15'

To be erected on solid or filled land? solid earth or rock? earth

Material of foundation cedar posts Thickness, top \_\_\_\_\_ bottom \_\_\_\_\_

Material of underpinning \_\_\_\_\_ Height \_\_\_\_\_ Thickness \_\_\_\_\_

Kind of roof pitch Roof covering metal

No. of chimneys no Material of chimneys \_\_\_\_\_ of lining \_\_\_\_\_

Kind of heat no Type of fuel \_\_\_\_\_ Distance, heater to chimney \_\_\_\_\_

If oil burner, name and model \_\_\_\_\_

Capacity and location of oil tanks \_\_\_\_\_

Is gas fitting involved? \_\_\_\_\_ Size of service \_\_\_\_\_

Corner posts \_\_\_\_\_ Sills 4x6 Girt or ledger board? \_\_\_\_\_ Size \_\_\_\_\_

Material columns under girders \_\_\_\_\_ Size \_\_\_\_\_ Max. on centers \_\_\_\_\_

Studs (outside walls and carrying partitions) 2x4-16" C. C. Girders 6x8 or larger. Bridging in every floor and flat roof span over 8 feet. Sills and corner posts all one piece in cross section.

Joists and rafters: 1st floor cinder, 2nd \_\_\_\_\_, 3rd \_\_\_\_\_, roof metal

On centers: 1st floor \_\_\_\_\_, 2nd \_\_\_\_\_, 3rd \_\_\_\_\_, roof \_\_\_\_\_

Maximum span: 1st floor \_\_\_\_\_, 2nd \_\_\_\_\_, 3rd \_\_\_\_\_, roof \_\_\_\_\_

If one story building with masonry walls, thickness of walls? \_\_\_\_\_ height? \_\_\_\_\_

### If a Garage

No. cars now accommodated on same lot \_\_\_\_\_, to be accommodated \_\_\_\_\_

Total number commercial cars to be accommodated \_\_\_\_\_

Will automobile repairing be done other than minor repairs to cars habitually stored in the proposed building? \_\_\_\_\_

### Miscellaneous

Will above work require removal or disturbing of any shade tree on a public street? no

Plans filed as part of this application? yes No. sheets 1

Estimated cost \$ 800. Fee \$ 1.00

Will there be in charge of the above work a person competent to see that the State and City requirements pertaining thereto are observed? Yes

INSPECTION COPY

Signature of owner Mrs. Harold E. Craven  
By Thomas Skinner Co.  
J. S. Chisholm

5754

Ward 5 Permit No 291

Location 94 Danforth St.

Owner Mrs. H.E. Claren

Permit 10/11/29

Notif. closing-in \_\_\_\_\_

\_\_\_\_\_ closing-in \_\_\_\_\_

Final Notif. \_\_\_\_\_

Final Inspn. \_\_\_\_\_

Cert. of Occupancy issued \_\_\_\_\_

NOTES

August 9, 1927

Ernest L. Small  
88 Exchange Street  
Portland, Maine

Dear Sir:

Referring to your application for a building permit to make alterations in the building at 80 Danforth Street to provide accommodations for two additional families, the Ordinance does not permit the use of a wooden outside stairway in such a case in the fire district. Furthermore, the location of this so-called fire escape is not satisfactory for the reason that any emergency of fire would make the existing stairway impassable and in all probability prevent reaching the proposed fire escape, especially on the third floor.

We have not completed the check of the plan and must look over the premises to check up on other requirements. We shall require that all of the new kitchenettes having no outside windows be provided with doors containing good sized glazed panels.

This is written in advance of examination of the premises to give you chance to study these details which are obviously unwise, and to save time in issuing the permit.

Yours truly,

Inspector of Buildings

Copy to:  
I. A. Clark  
374 Cumberland Avenue  
Portland, Maine

W/P

Ward 5 Permit No. 27/132 LM.  
 Location 94 Danforth St  
 Owner Ernest L. Small  
 Date of permit Aug 11/27  
 Nbtit. closing-in  
 Insp. closing-in  
 Final Notif.  
 E. INSPECTION NOT COMPLETED  
 Cert. of Occupancy issued

No fire ext.  
 Gas stoves are furnished  
 by landlord. Janitor  
 said he would clean  
 out chimney right  
 away. -AGB

NOTES  
 Harold C. Craven } New  
 94 Danforth Street } Owner

1/28/30 - Chimney full of  
 soot. Needs cleaning  
 out. Fire door to heater  
 room needs stronger  
 springs to keep it closed  
 tightly. Vents for  
 kitchenettes are 6x8  
 holes leading into 5" pipe  
 garraage) areas, not  
 connected to vents pro-  
 vided. No skylight  
 in upper hall 3rd  
 story. Walls on  
 2nd and 3rd floor have  
 a light in it  
 artificial. Side of  
 heater 27" away from  
 wall (over)



Location, Ownership and detail must be correct, complete and legible.  
 Separate application required for every building.  
 Plans must be filed with this application.

## Application for Permit for Alterations, etc.

To the *Portland, June 25, 1919* 191  
 INSPECTOR OF BUILDINGS:

The undersigned applies for a permit to alter the following-described building:—

Location *24 Danforth Street* Ward, *5* in fire-limits? *yes*  
 Name of Owner or Lessee, *Frank W. Sparrow* Address *521 Cottage Rd.*  
 " " Contractor, *Conroy* " "  
 " " Architect, " "  
 Description of Present Bldg. Material of Building is *brick* Style of Roof, *pitch* Material of Roofing, *slate*  
 Size of Building is *30ft* feet long: *13ft* feet wide. No. of Stories, *3*  
 Cellar Wall is constructed of *stone* is inches wide on bottom and batters to inches on top.  
 Underpinning is *stone* is inches thick: is feet in height.  
 Height of Building, *40ft* Wall, if Brick; 1st, 2d, 3d, 4th, 5th,  
 What was Building last used for? *dwelling* No. of Families? *1*  
 What will Building now be used for? *tenement* Estimated Cost, \$ *2,000*

PERMIT MUST BE OBTAINED BEFORE BEGINNING WORK

### DETAIL OF PROPOSED WORK

*Interior alterations, build piazza, etc.*  
*To comply with the building ordinance*

### IF EXTENDED ON ANY SIDE

Size of Extension, No. of feet long? ; No. of feet wide? ; No. of feet high above sidewalk?   
 No. of Stories high? ; Style of Roof? ; Material of Roofing?   
 Of what material will the Extension be built Foundation?   
 If of Brick, what will be the thickness of External Walls? inches; and Party Walls inches.   
 How will the extension be occupied? How connected with Main Building?

### WHEN MOVED, RAISED OR BUILT UPON

No. of Stories in height when Moved, Raised or Built upon? Proposed Foundations   
 No. of feet high from level of ground to highest part of Roof to be?   
 How many feet will the External Walls be increased in height? Party Walls

### IF ANY PORTION OF THE EXTERNAL OR PARTY WALLS ARE REMOVED

Will an opening be made in the Party or External Walls? in Story.   
 Size of the opening? How protected?   
 How will the remaining portion of the wall be supported?

Signature of Owner or Authorized Representative *Frank W. Sparrow*  
 Address *So. Portland, Me*







FILL IN AND SIGN WITH INK

00872

PERMIT ISSUED

AUG 24 1983

APPLICATION FOR PERMIT FOR HEATING, COOKING OR POWER EQUIPMENT

Portland, Maine, August 24, 1983

CITY of PORTLAND

To the INSPECTOR OF BUILDINGS, PORTLAND, ME.

The undersigned hereby applies for a permit to install the following heating, cooking or power equipment in accordance with the Laws of Maine, the Building Code of the City of Portland, and the following specifications:

Location ...92 Danforth Street... Use of Building ...12 apartments... No. Stories ...4... New Building Existing "X"
Name and address of owner of appliance Robert Boyd ...32 Mery Street, Westbrook, Me.
Installer's name and address Roger Beaudoin ...15 Walker Rd., R.F.D. #1, West, Me. 04092 Telephone ...892-3105

General Description of Work

To install ...Boiler/Burner... Replacement

IF HEATER, OR POWER BOILER

Location of appliance ...cellar... Any burnable material in floor surface or beneath? ...no...
Kind of fuel? ...#2 Fuel...
Minimum distance to burnable material, from top of appliance or casing top of furnace ...At least 3' all-around...
From top of smoke pipe ...From front of appliance... From sides or back of appliance...
Size of chimney flue ...12" x 12"... Other connections to same flue ...yes - one other...
If gas fired, how vented? ...
Will sufficient fresh air be supplied to the appliance to insure proper and safe combustion? ...yes

IF OIL BURNER

Name and type of burner Carlin CRD-301... Labelled by underwriters' laboratories? ...yes...
Will operator be always in attendance? ...no... Does oil supply line feed from top or bottom of tank? ...bottom...
Type of floor beneath burner ...concrete... Size of vent pipe ...1 1/2"...
Location of oil storage ...basement... Number and capacity of tanks ...2-275...
Low water shut off ...yes... Make ...MacDonald/Miller... No...
Will all tanks be more than five feet from any flame? ...yes... How many tanks enclosed? ...no...
Total capacity of any existing storage tanks for furnace burners ...2-275...

IF COOKING APPLIANCE

Location of appliance ... Any burnable material in floor surface or beneath? ...
If so, how protected? ... Height of Legs, if any ...
Skirting at bottom of appliance? ... Distance to combustible material from top of appliance? ...
From front of appliance ... From sides and back ... From top of smokepipe ...
Size of chimney flue ... Other connections to same flue ...
Is hood to be provided? ... If so, how vented? ... Forced or gravity? ...
If gas fired, how vented? ... Rated maximum demand per hour ...

MISCELLANEOUS EQUIPMENT OR SPECIAL INFORMATION

Empty lines for miscellaneous information.

Amount of fee enclosed? 15.00.

APPROVED: [Signature line]

Will there be in charge of the above work a person competent to see that the State and City requirements pertaining thereto are observed? ...yes...

Signature of Installer [Handwritten Signature]

CS 300

Signature of Installer

FILE COPY

II 02774



**APPLICATION FOR PERMIT**  
**DEPARTMENT OF BUILDING INSPECTIONS SERVICES**  
**ELECTRICAL INSTALLATIONS**

Date August 24, 1983  
 Receipt and Permit number B08348

To the CHIEF ELECTRICAL INSPECTOR, Portland, Maine:

The undersigned hereby applies for a permit to make electrical installations in accordance with the laws of Maine, the Portland Electrical Ordinance, the National Electrical Code and the following specifications:

LOCATION OF WORK: 92 Danforth Street  
 OWNER'S NAME: Robert Boyd ADDRESS: 32 Emery St., West., Me. 04092

OUTLETS:		FEES
Receptacles	Switches _____ Plugmold _____ ft. TOTAL _____	
FIXTURES: (number of)		
Incandescent _____	Flourescent _____ (not strip) TOTAL _____	
Strip Flourescent _____ ft.	_____	
SERVICES		
Overhead _____	Underground _____ Temporary _____ TOTAL amperes _____	
METERS: (number of) _____		
MOTORS: (number of)		
Fractional _____	_____	
1 HP or over _____	_____	
RESIDENTIAL HEATING:		
Oil or Gas (number of units) <u>x</u>	_____ <u>5.00</u>	
Electric (number of rooms) _____	_____	
COMMERCIAL OR INDUSTRIAL HEATING:		
Oil or Gas (by a main boiler) _____	_____	
Oil or Gas (by separate units) _____	_____	
Electric Under 20 kws _____	Over 20 kws _____	
APPLIANCES: (number of)		
Ranges _____	Water Heaters _____	
Cook Tops _____	Disposals _____	
Wall Ovens _____	Dishwashers _____	
Dryers _____	Compactors _____	
Fans _____	Others (denote) _____	
TOTAL _____	_____	
MISCELLANEOUS: (number of)		
Branch Panels _____	_____	
Transformers _____	_____	
Air Conditioners Central Unit _____	_____	
Separate Units (windows) _____	_____	
Signs 20 sq. ft. and under _____	_____	
Over 20 sq. ft. _____	_____	
Swimming Pools Above Ground _____	_____	
In Ground _____	_____	
Fire/Burglar Alarms Residential _____	_____	
Commercial _____	_____	
Heavy Duty Outlets, 220 Volt (such as welders) 30 amps and under _____	_____	
over 30 amps _____	_____	
Circus, Fairs, etc. _____	_____	
Alterations to wires _____	_____	
Repair after fire _____	_____	
Emergency Lights, battery _____	_____	
Emergency Generators _____	_____	
	INSTALLATION FEE DUE: _____	
FOR ADDITIONAL WORK NOT ON ORIGINAL PERMIT _____	DOUBLE FEE DUE: _____	
FOR REMOVAL OF A "STOP ORDER" (304-16.b) _____	TOTAL AMOUNT DUE: <u>5.00</u>	

INSPECTION: Ring Managers bell  
 Will be ready on Aug. 31, 1983; or Will Call \_\_\_\_\_  
 CONTRACTOR'S NAME: Roger Beaudoin  
 ADDRESS: 15 Webber Rd., R.F.D. #1, West., Me. 04092  
 TEL.: 892-3105  
 MASTER LICENSE NO.: 02774 SIGNATURE OF CONTRACTOR: Roger Beaudoin  
 LIMITED LICENSE NO.: \_\_\_\_\_

INSPECTOR'S COPY — WHITE  
 OFFICE COPY — CANARY  
 CONTRACTOR'S COPY — GREEN



PERMIT # 0 507 BUILDING PERMIT APPLICATION Portland Previous permit # \_\_\_\_\_  
 APPLICANT FILL OUT I - VIII AND DETAILS OF WORK ON REVERSE  
 Please insert N/A (not applicable) for any item not pertaining to your request

I. GENERAL INFORMATION  
 Location/address of construction \_\_\_\_\_ Tel. 773-4991  
 Owner or lessee's name \_\_\_\_\_  
 Address \_\_\_\_\_ Tel. \_\_\_\_\_

Contractor's name \_\_\_\_\_  
 Address \_\_\_\_\_  
 Subcontractors: \_\_\_\_\_  
**PERMIT ISSUED**  
**MAY 28 1987**  
**City Of Portland**

II. NEW SUBDIVISION OR EXISTING LOT REFERENCE  
 Name \_\_\_\_\_  
 Lot \_\_\_\_\_  
 Block \_\_\_\_\_  
 Bk. & pg. Reg./ deeds \_\_\_\_\_  
 Date recorded \_\_\_\_\_  
 Seasonal \_\_\_\_\_ Condominium \_\_\_\_\_ Apartment \_\_\_\_\_  
 III. PROPOSED USE: \_\_\_\_\_ CODE \_\_\_\_\_ If other\*, explain \_\_\_\_\_  
 IV. PAST USE: \_\_\_\_\_  
 V. OWNERSHIP: \_\_\_\_\_ PUBLIC (Federal/ State/ local government) \_\_\_\_\_ PRIVATE (individual/corp./nonprofit) \_\_\_\_\_  
 VI. DESCRIPTION OF WORK: \_\_\_\_\_

VII. BUILDING DIMENSIONS: length \_\_\_\_\_ width \_\_\_\_\_ square footage \_\_\_\_\_ height \_\_\_\_\_ # stories \_\_\_\_\_  
 VIII. EST. CONSTRUCTION COST: \_\_\_\_\_  
 IX. GR. SQ. FT. OF LAND \_\_\_\_\_  
 X. RESIDENTIAL BUILDINGS ONLY: \_\_\_\_\_  
 1. BDRM \_\_\_\_\_ 2. BDRMS \_\_\_\_\_ 3. BDRMS \_\_\_\_\_  
 XI. RESIDENTIAL UNITS: \_\_\_\_\_  
 \* NEW DWELLING UNITS \_\_\_\_\_  
 \* EXISTING DWELLING UNITS \_\_\_\_\_  
 NET RESIDENTIAL UNITS \_\_\_\_\_

XII. SIGNATURE OF APPLICANT: \_\_\_\_\_ DATE: \_\_\_\_\_  
 DO NOT WRITE BELOW THIS LINE

XIII. ZONING: \_\_\_\_\_ STREET FRONTAGE \_\_\_\_\_  
 DISTRICT: front \_\_\_\_\_ back \_\_\_\_\_ side \_\_\_\_\_  
 SETBACKS: front \_\_\_\_\_ back \_\_\_\_\_ side \_\_\_\_\_  
 ZONING BOARD APPROVAL: no  yes  (date) \_\_\_\_\_  
 PLANNING BOARD APPROVAL: no  yes  (date) \_\_\_\_\_

XIV. OFFICE USE: \_\_\_\_\_  
 TAX MAP # \_\_\_\_\_  
 LOT # \_\_\_\_\_  
 VALUE/STRUCTURE PERMIT EXPIRATION \_\_\_\_\_  
 XV. CONDITIONAL USE: variance \_\_\_\_\_ site plan \_\_\_\_\_ subdivision \_\_\_\_\_ shore and floodplain mgmt \_\_\_\_\_  
 special exception \_\_\_\_\_ other \_\_\_\_\_ (explain) \_\_\_\_\_ DATE: \_\_\_\_\_

XVI. SIGNATURE OF FIELD INSPECTOR (CEO): \_\_\_\_\_  
 XVII. FEES:  
 base fee \_\_\_\_\_  
 subdivision fee \_\_\_\_\_  
 site plan review fee \_\_\_\_\_  
 other fees \_\_\_\_\_  
 late fee \_\_\_\_\_  
 TOTAL \$ 25.00

XVIII. SPACE FOR FIGURING /ADDITIONAL COMMENTS:

1. WATER SUPPLY <input type="checkbox"/> public <input type="checkbox"/> private	8. CHIMNEY # flues _____ # fireplaces _____ material _____
2. SEWER <input type="checkbox"/> public <input type="checkbox"/> private, type _____ fuel _____	9. FRAMING: floor joists _____ size _____ max. on centers _____
3. HEAT type _____	ceiling joists _____ rafters _____ studs _____ wall studs _____
4. FOUNDATION type _____ thickness _____ footing _____ pitch _____	10. If 1-story building w/ masonry walls: wall thickness _____ height _____
5. ROOF type _____ covering _____ load _____ # showers _____	11. BEDROOM WINDOWS height _____ width _____ sill height _____ egress window? <input type="checkbox"/> yes <input type="checkbox"/> no
6. PLUMBING # tubs _____ # lavatories _____ # laundry tubs _____ # flushes _____ # other _____	
7. ELECTRICAL service entrance size _____ # smoke detectors _____	
SPRINKLER SYSTEM? <input type="checkbox"/> yes <input type="checkbox"/> no	
NUMBER OF OFF-STREET PARKING SPACES: enclosed _____ outdoors _____	

PLOT PLAN/DETAILS OF WORK ON REVERSE  
 Pink - Tax Assessor  
 Gold - G.P. U.S.

PERMIT # 01082 CITY OF PORTLAND BUILDING PERMIT APPLICATION  
 Please fill out any part which applies to job. Proper plans must accompany form.  
 Owner: Alvin Wolf  
 Address: 1 Laurier Street  
 LOCATION OF CONSTRUCTION: 92 Hawthorn Street  
 CONTRACTOR: John Neilson SUBCONTRACTOR: \_\_\_\_\_  
 ADDRESS: 23 Hawthorn Street TEL: 774-9442  
 Est. Construction Cost: 6,000 Type of Use: multi family  
 Part Use: \_\_\_\_\_  
 Building Dimensions L \_\_\_\_\_ W \_\_\_\_\_ Sq. Ft. \_\_\_\_\_ # Stories: \_\_\_\_\_ Lot Size: \_\_\_\_\_  
 Is Proposed Use: \_\_\_\_\_ Seasonal \_\_\_\_\_ Condominium \_\_\_\_\_ Apartment \_\_\_\_\_  
 Conversion - Explain \_\_\_\_\_ install wheelchair lift \_\_\_\_\_  
 COMPLETE ONLY IF THE NUMBER OF UNITS WILL CHANGE  
 Residential Buildings Only: \_\_\_\_\_ # of Dwelling Units \_\_\_\_\_ # of New Dwelling Units \_\_\_\_\_

Foundations:  
 1. Type of Soil: \_\_\_\_\_  
 2. Set Backs - Front \_\_\_\_\_ Rear \_\_\_\_\_ (Side) \_\_\_\_\_  
 3. Footing Size \_\_\_\_\_  
 4. Foundation Size \_\_\_\_\_  
 5. Other \_\_\_\_\_  
 Floors:  
 1. Sills Size: \_\_\_\_\_ Sills must be anchored.  
 2. Girders Size: \_\_\_\_\_  
 3. Joists Size: \_\_\_\_\_  
 4. Joist Spacing: \_\_\_\_\_  
 5. Bridging Type: \_\_\_\_\_  
 6. Floor Sheathing Type: \_\_\_\_\_  
 7. Other Materials: \_\_\_\_\_  
 Exterior Walls:  
 1. Standing Size: \_\_\_\_\_  
 2. No. Doors \_\_\_\_\_  
 3. Header Size: \_\_\_\_\_  
 4. Corner Posts Size: \_\_\_\_\_  
 5. Bracing: \_\_\_\_\_  
 6. Insulation Type: \_\_\_\_\_  
 7. Sheathing Type: \_\_\_\_\_  
 8. Masonry Materials \_\_\_\_\_  
 9. Metal Masonry \_\_\_\_\_  
 10. Masonry Materials \_\_\_\_\_  
 Interior Walls:  
 1. Standing Size: \_\_\_\_\_  
 2. Header Size: \_\_\_\_\_  
 3. Wall Covering Type: \_\_\_\_\_  
 4. Fire Wall If required \_\_\_\_\_  
 5. Other Materials \_\_\_\_\_  
 White-Tax Assessor Yellow-G.P.C.O.C. White Tag O.P.O. m.s. Copyright G.P.C.O.C. 1987

Permit Received By: \_\_\_\_\_  
 Signature of Applicant: \_\_\_\_\_ Date: \_\_\_\_\_  
 Signature of CEO: \_\_\_\_\_ Date: 9-1-87  
 Inspection Date: \_\_\_\_\_  
 Zoning: \_\_\_\_\_  
 Review Required: \_\_\_\_\_  
 Planning Board Approval: Yes \_\_\_\_\_ No \_\_\_\_\_  
 Conditional Use: Yes \_\_\_\_\_ No \_\_\_\_\_  
 Shore and Floodplain Mgmt: \_\_\_\_\_  
 Other: \_\_\_\_\_  
 Date Approved: \_\_\_\_\_  
 Heating: \_\_\_\_\_  
 Electrical: \_\_\_\_\_  
 Plumbing: \_\_\_\_\_  
 Swimming Pools: \_\_\_\_\_  
 Roof: \_\_\_\_\_  
 Chimneys: \_\_\_\_\_  
 Ceilings: \_\_\_\_\_  
 PERMIT ISSUED  
 SEP 8 1987  
 City Of Portland

PLAT PLAN



FEES (Breakdown From Front)

Base Fee \$ \_\_\_\_\_  
 Subdivision Fee \$ \_\_\_\_\_  
 Site Plan Review Fee \$ \_\_\_\_\_  
 Other Fees \$ \_\_\_\_\_  
 (Explain) \_\_\_\_\_  
 Late Fee \$ \_\_\_\_\_

Type	Inspection Record	Date

COMMENTS

*9/19/88* *Preparation of plat plan*  
*11/29/88* *Completion of plat plan*

*[Large handwritten signature]*

Signature of Applicant \_\_\_\_\_

Date \_\_\_\_\_

LIFT - PLAN C  
92 DAWFORTH ST.  
PORTLAND, ME.

SCALE  
1/2" = 1'

