

NOTE:  
REFER TO L1.0 FOR SITE LAYOUT AND MATERIALS

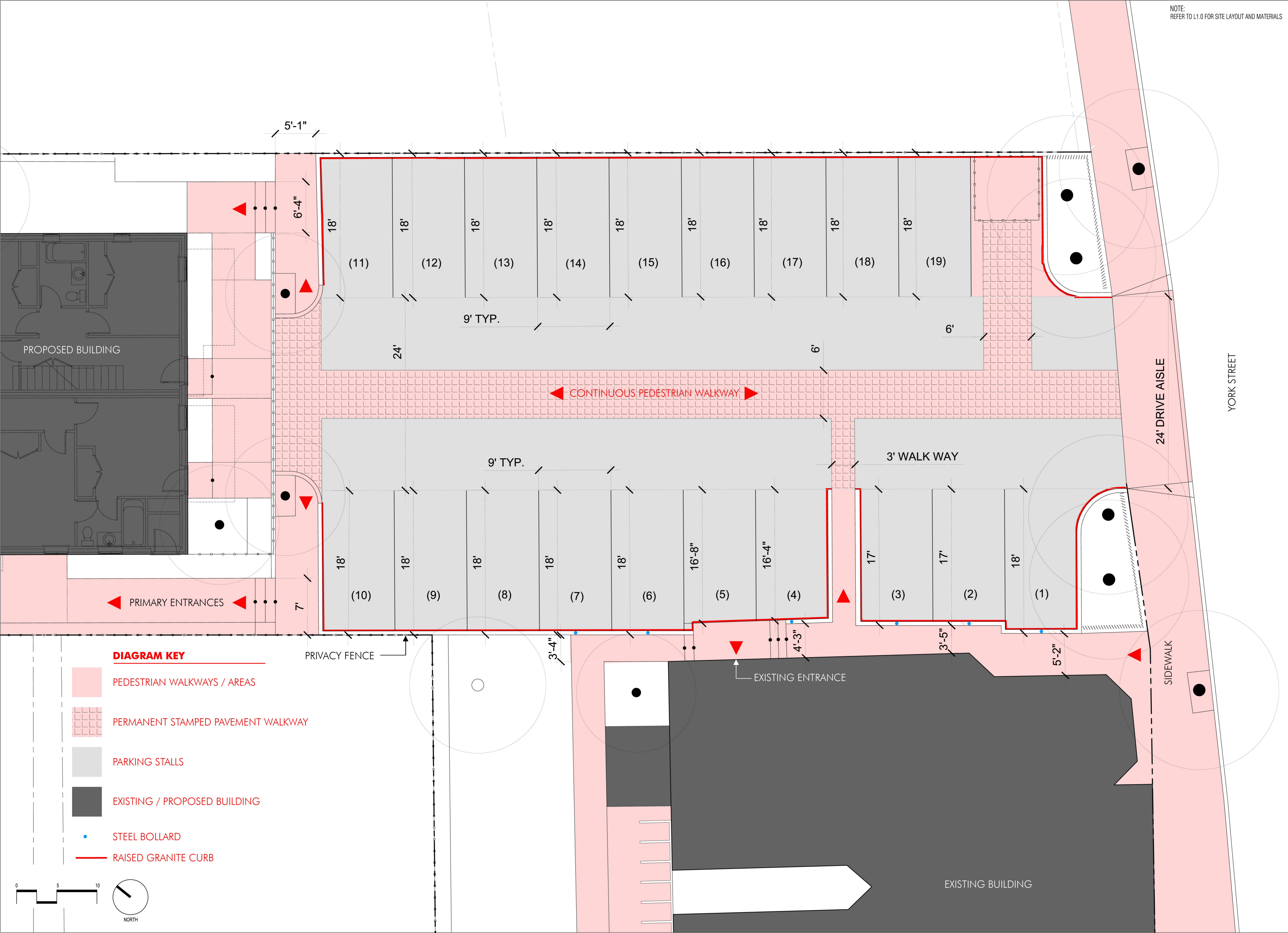

**DIAGRAM KEY**

- PEDESTRIAN WALKWAYS / AREAS
- PERMANENT STAMPED PAVEMENT WALKWAY
- PARKING STALLS
- EXISTING / PROPOSED BUILDING
- STEEL BOLLARD
- RAISED GRANITE CURB



PROJECT:  
**121 YORK ST.**  
PORTLAND, MAINE

CLIENT:  
HARBORVIEW DEVELOPMENT LLC.  
DBA, RED FERN PROPERTIES

date: JULY 5, 2011  
scale: As Noted  
drawn: sd  
checked:

TITLE:  
**EXHIBIT A.**  
DIMENSIONED PARKING PLAN  
(NOT FOR CONSTRUCTION)

SOREN DENIORD DESIGN STUDIO  
43 WELLWOOD RD.  
PORTLAND, ME 04103  
t: 207.400.2450  
soren@sorendenior.com