

NOTE:
REFER TO L1.0 FOR SITE LAYOUT AND MATERIALS

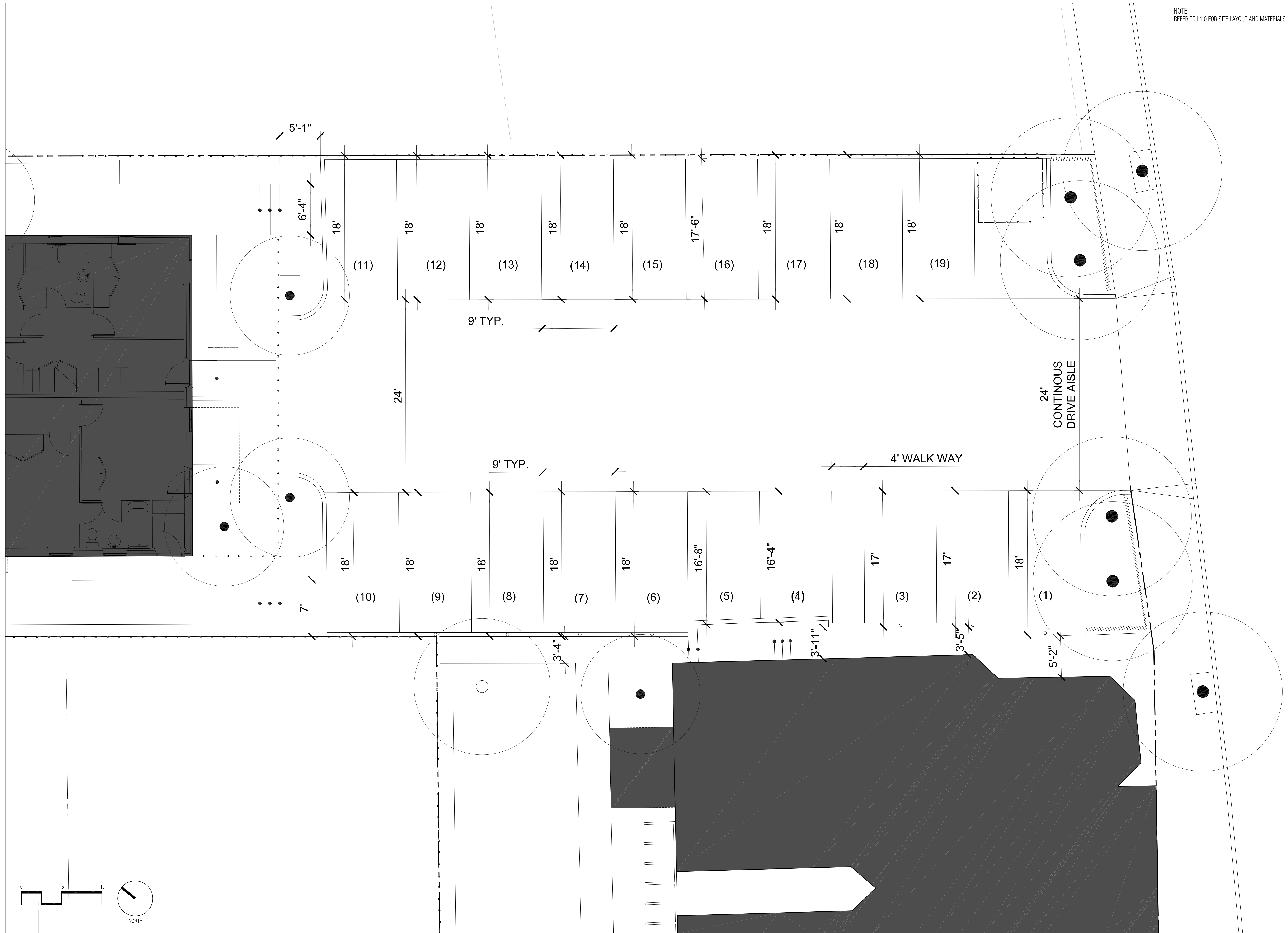

PROJECT:
121 YORK ST.
PORTLAND, MAINE

CLIENT:
HARBORVIEW DEVELOPMENT LLC.
DBA, RED FERN PROPERTIES

date: JULY 5, 2011
scale: As Noted
drawn: sd
checked:

TITLE:
EXHIBIT A.
DIMENSIONED PARKING PLAN
(NOT FOR CONSTRUCTION)

SOREN DENIORD DESIGN STUDIO
43 WELLWOOD RD.
PORTLAND, ME 04103
t: 207-400-2450
soren@sorendeniord.com