

**STAIR No. 1
PARTIAL FIRST FLOOR PLAN**
SCALE: 1/4" = 1'-0"

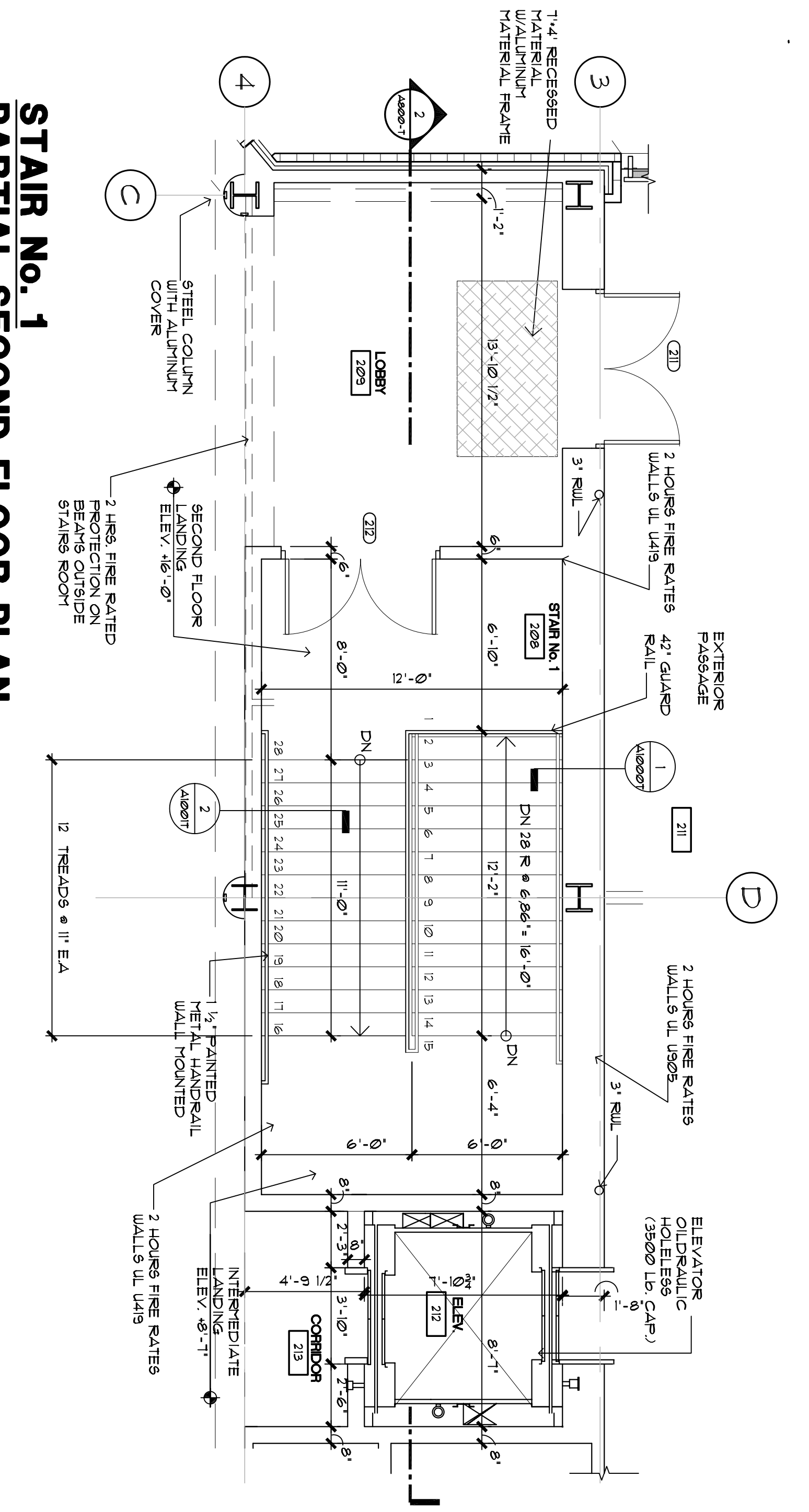

**STAIR No. 1
PARTIAL SECOND FLOOR PLAN**
SCALE: 1/4" = 1'-0"

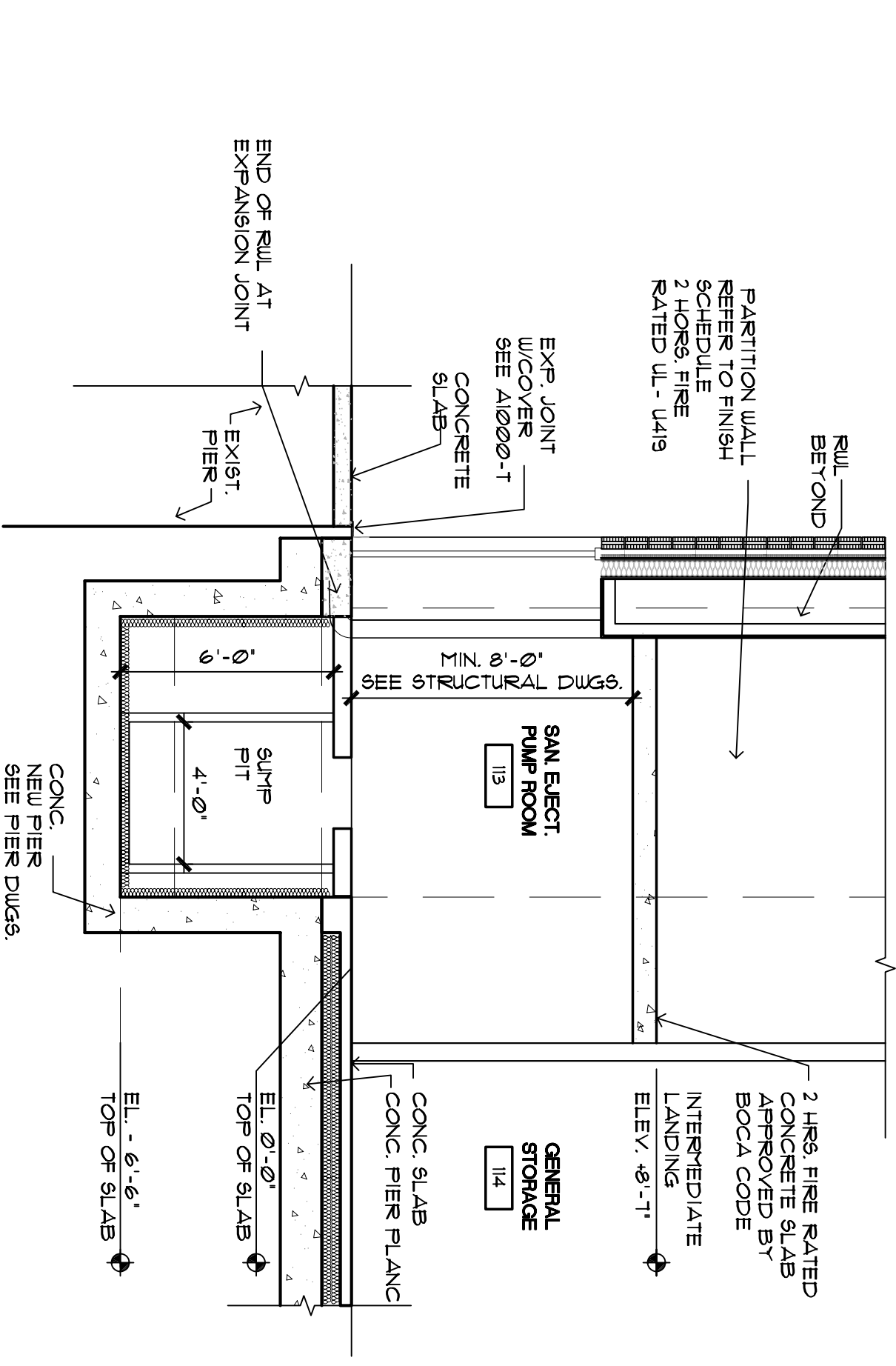

PUMP ROOM AND SUMP SECTION
SCALE: 1/4" = 1'-0"

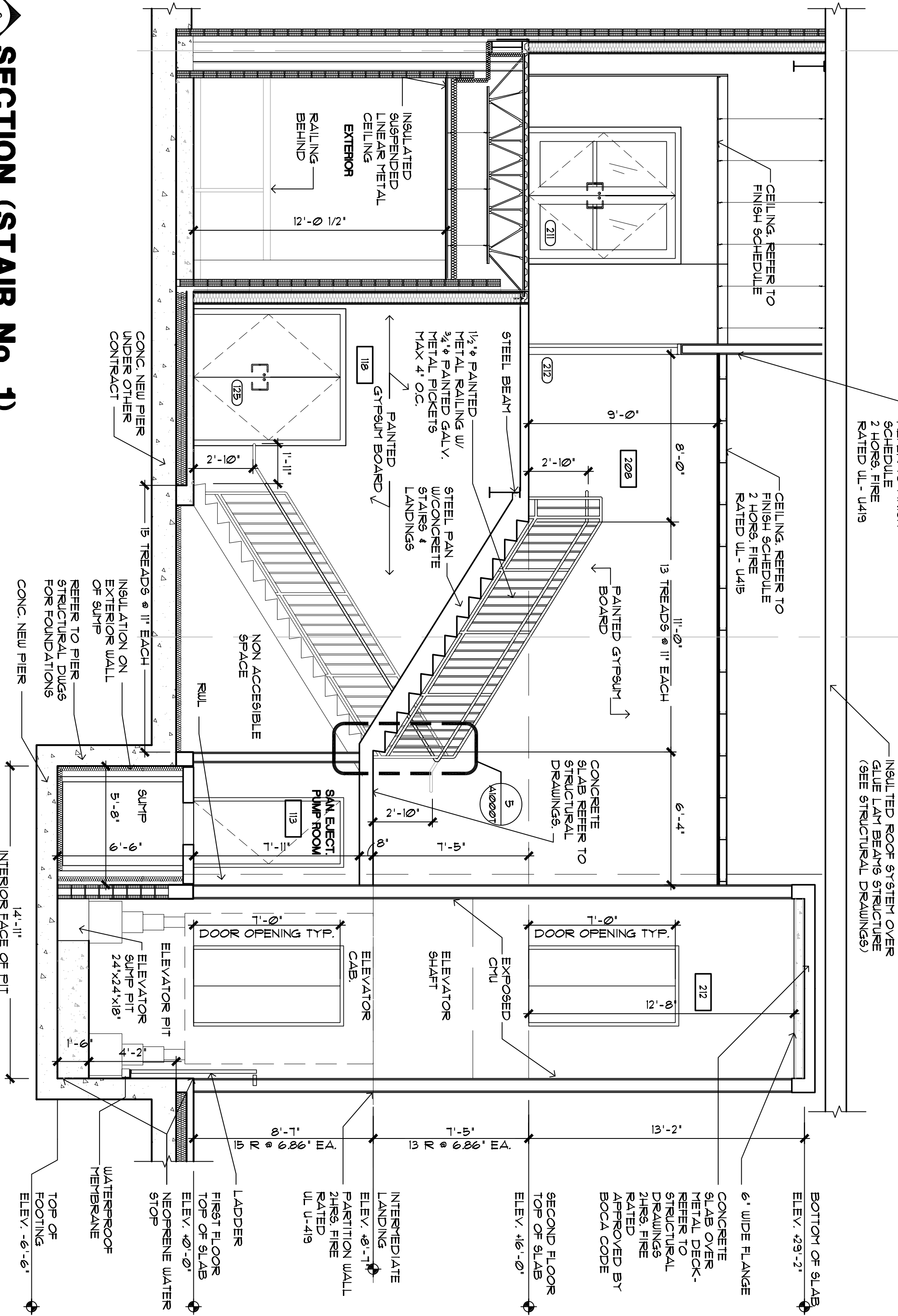

SECTION (STAIR No. 1)
SCALE: 1/4" = 1'-0"

IN ASSOCIATION WITH:
GORRILL-PALMER CONSULTING ENGINEERS
PERATROVICH, NOTTINGHAM, & DRAGE
WINTON SCOTT ARCHITECTS
HALEY & ALDRICH

BEA
INTERNATIONAL

STATE OF MAINE
DEPARTMENT OF TRANSPORTATION

PROJECT NUMBER 009215.00

PIN
009215.00

CITY OF PORTLAND
OCEAN GATEWAY PHASE 1

STAIRS & PIT PLANS & SECTIONS

PROJ. MANAGER PAUL POTTLE	BY	DATE
DESIGN-DETAILED		
CHECKED-REVIEWED		
DESIGN2-DETAILED2		
DESIGN3-DETAILED3		
REVISIONS 1	VAAP 22 DESIGN CHANGE	10/15/05
REVISIONS 2		
REVISIONS 3		
REVISIONS 4		
FIELD CHANGES		

SIGNATURE
P. LICENCE NUMBER
DATE 10/15/05

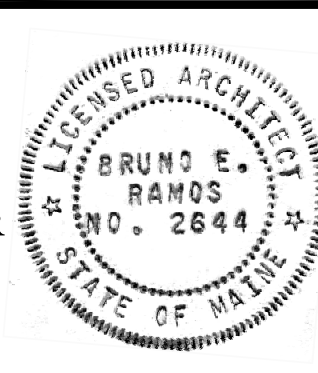

A800-T

161 OF 288