

LONGITUDINAL SECTION
 1 PANEL 'A'

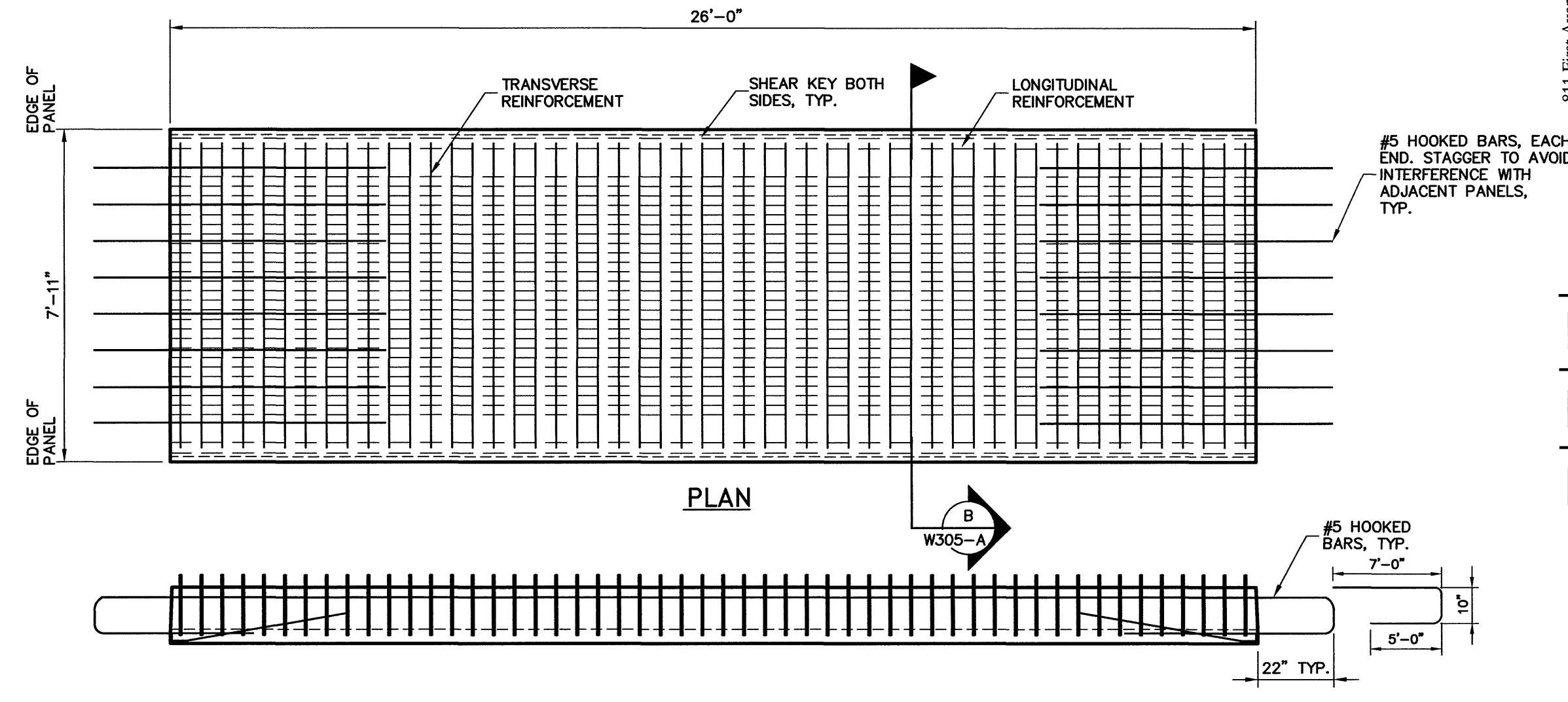

LONGITUDINAL SECTION
 2 PANEL 'B'

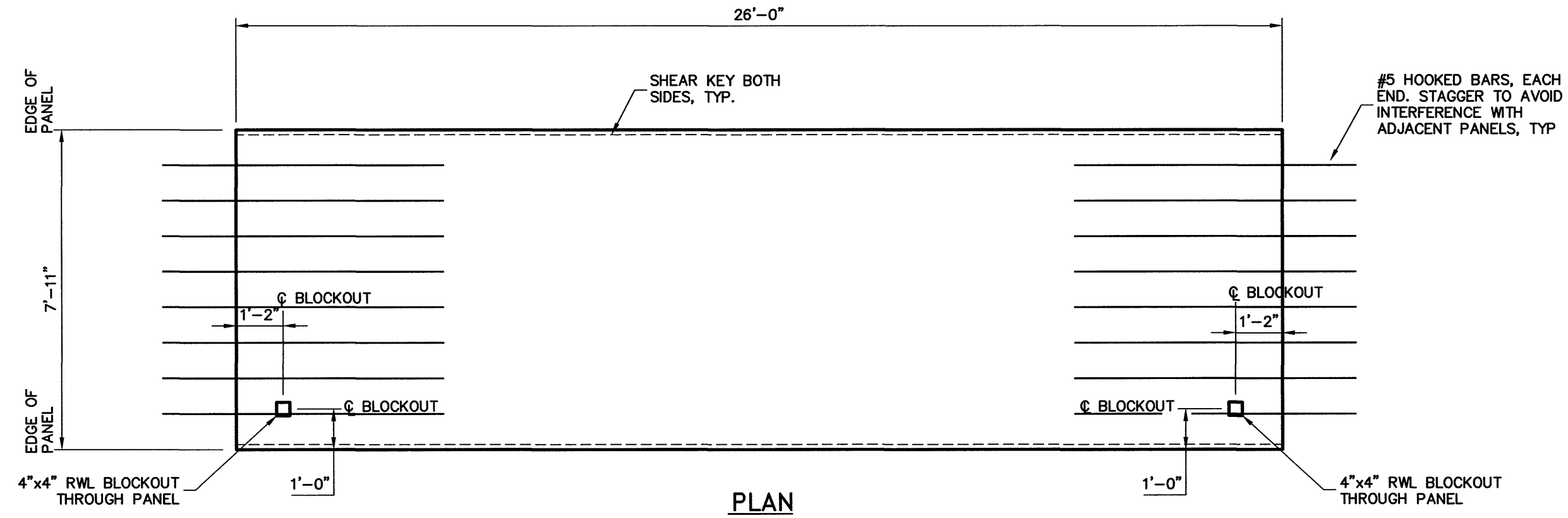

3 PANEL 'B1'
 REINFORCEMENT SIMILAR TO PANEL 'B'

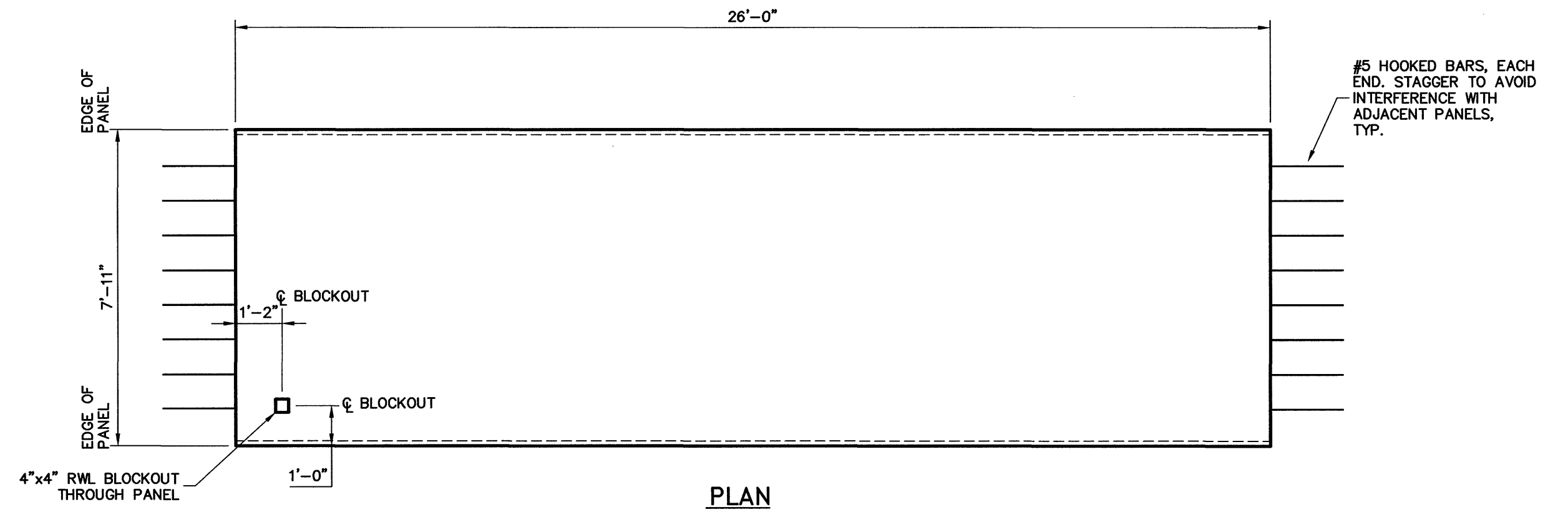

4 PANEL 'B2'
 REINFORCEMENT SIMILAR TO PANEL 'B'

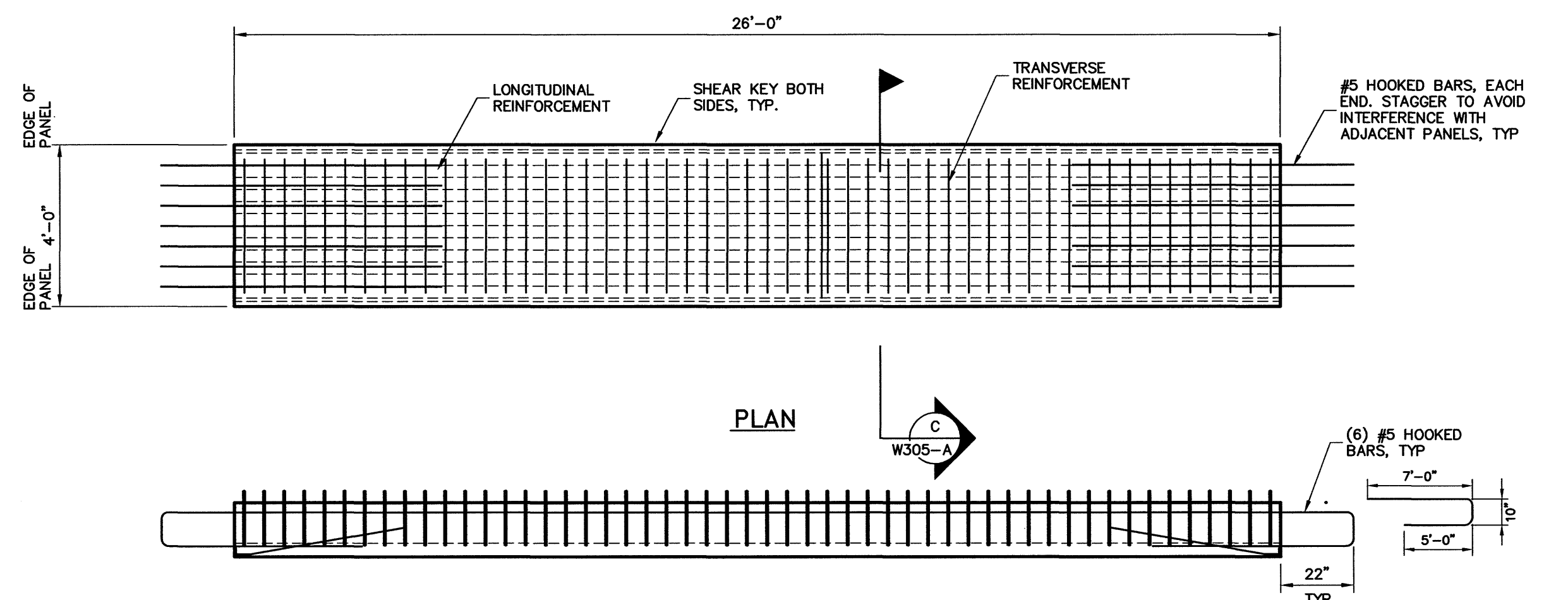

LONGITUDINAL SECTION
 5 PANEL 'C'

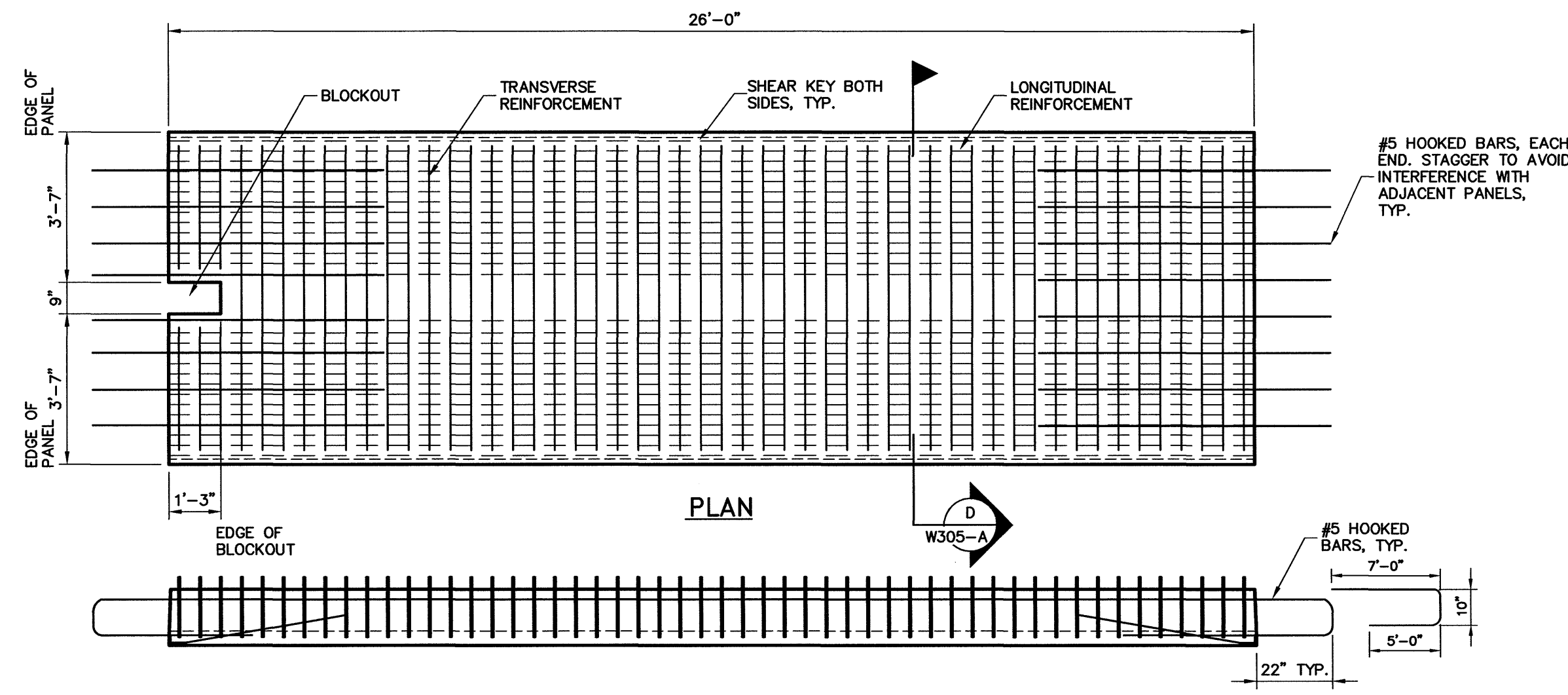

LONGITUDINAL SECTION
 6 PANEL 'D'

811 First Avenue, Suite 570
 Seattle, Washington 98104
 Phone: (206) 624-1387
 Fax: (206) 624-1388
 E-Mail: mail@pndea.com

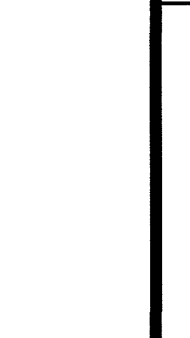

STATE OF MAINE
 DEPARTMENT OF TRANSPORTATION
 PROJECT NUMBER 009215.00
 PIN 009215.00

PROJ. MANAGER	PAUL POTLE	DATE	BY	DATE
DESIGN-DETAILED	RJ	09/01/04	DH	
CHECKED-REVIEWED	OT	09/01/04	DP	
DESIGN-DETAILED				
REVISIONS 1	PER VAAP 16	10/28/03		
REVISIONS 2				
REVISIONS 3				
REVISIONS 4				
FIELD CHANGES				

CITY OF PORTLAND
 OCEAN GATEWAY PHASE 1
 PIER A
 DECK PANELS

W304-A
 99 OF 288