



PAVEMENT LEGEND

-  BITUMINOUS PAVEMENT AREA 1
-  BITUMINOUS PAVEMENT AREA 2
-  BITUMINOUS PAVEMENT AREA 3

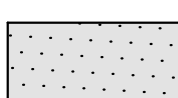
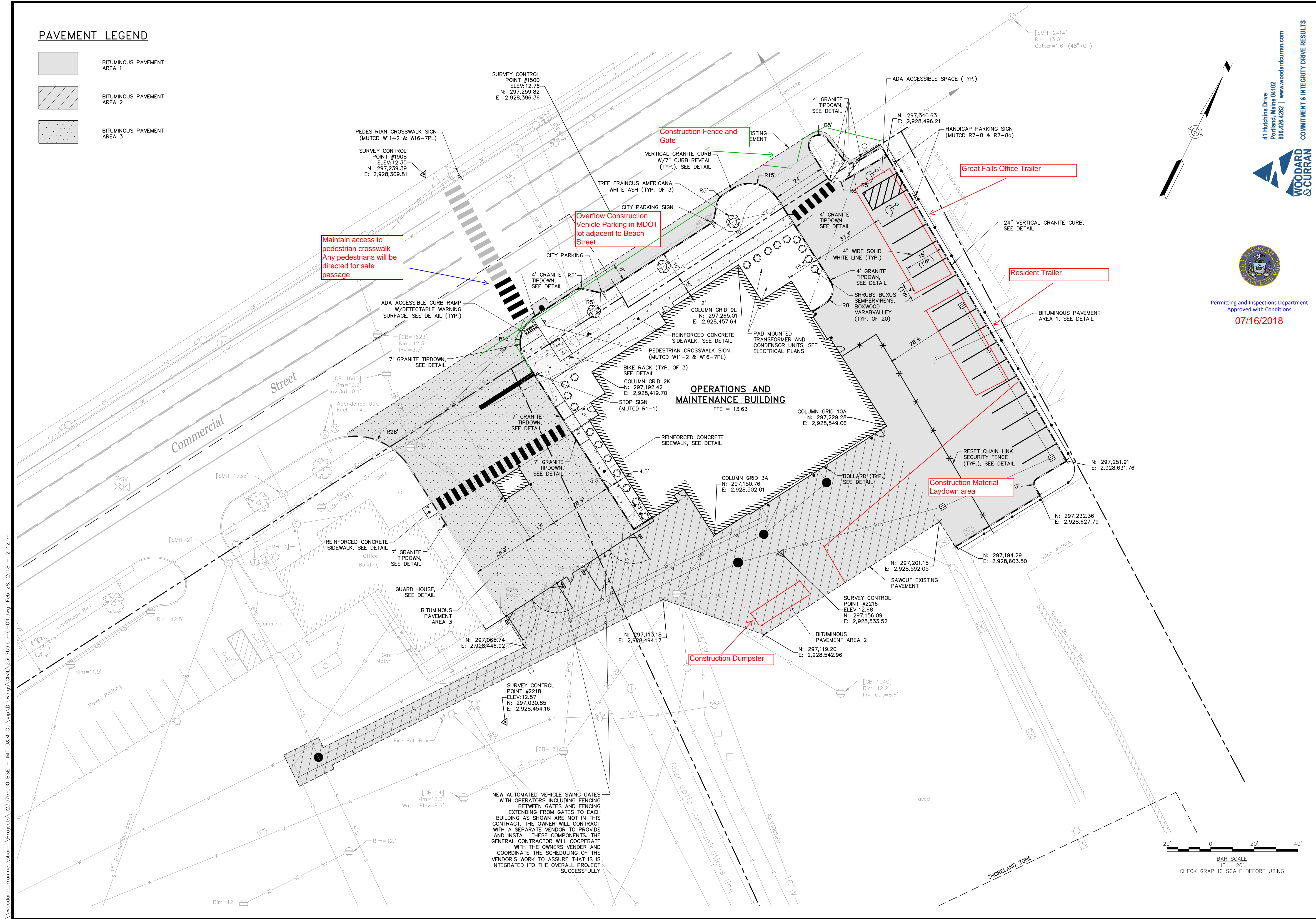

41 Hutchins Drive
Portland, Maine 04102
800.436.4282 | www.woodardcurran.com

WOODARD & CURRAN
COMMITMENT & INTEGRITY DRIVE RESULTS

Permitting and Inspections Department
Approved with Conditions
07/16/2018

STATE OF MAINE
DEPARTMENT OF TRANSPORTATION
2194202
WIN
021942.02

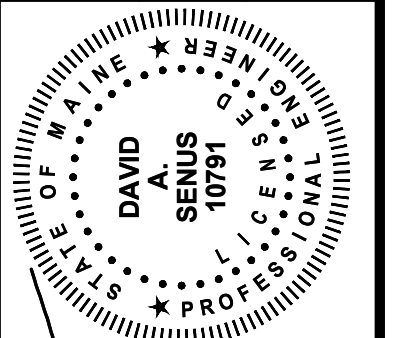

PROJ. MANAGER	JOEL KITTREDGE
DESIGN-DETAILED	02-15-18 [CWS/JBC]
CHECKED-REVIEWED	02-15-18 [DAS]
DESIGN-DETAILED	02-15-18 [DAS]
DESIGNS-DETAILED	02-15-18 [DAS]
REVISIONS 1	
REVISIONS 2	
REVISIONS 3	
REVISIONS 4	
FIELD CHANGES	

PORTLAND INTERNATIONAL MARINE TERMINAL
MAINTENANCE & OPERATIONS BUILDING
PORTLAND
CUMBERLAND COUNTY
SITE PLAN

SHEET NUMBER
C-04
6 OF 58

\\woodardcurran.com\shared\Projects\0230769.00 BSE - IMT O&M Ctr.\wp\Drawings\CIVIL\230769.00-C-04.dwg, Feb. 28, 2018 - 2:42pm