

194 YORK STREET

SCHEDULE

PLANNING
FILE

Type of Document
A—Appeal
C—Complaint
De—Certificate of Occupancy
I—Inequity Applications
P—Permit

Type of Work Under Permit
A—Alteration
C—Change of use
D—Demolition
M—Moving
N—New Building
Rc—Repair or Structural
Rr—Repair Chimney
Rr—Repair after fire
Rr—Repair after fire with alterations
Rr—Repair roof covering

Type of Installation/Permit
Ck—Cooking appliance
Ee—Elevator
Hw—Heating appliance
Hw—Hot water heater
In—Inflammable heater
Eq—Equipment
Fl—Flammable liquids
Re—Refrigeration
De—Detached sign
Re—Rear sign
Ic—Inflatable sign
F—Fire sign
I—Illumination

by
Hall
Hospitals
Industrial

CITY OF PORTLAND, MAINE
Application for Permit to Install Wires

Permit No. 2424
 Issued 12/9/74
 1974

Portland, Maine

To the City Electrician, Portland, Maine:

The undersigned hereby applies for a permit to install wires for the purpose of conducting electric current, in accordance with the laws of Maine, the Electrical Ordinance of the City of Portland, and the following specifications:

(This form must be completely filled out — Minimum Fee, \$1.00)

Owner's Name and Address BARBARA YORK ST Tel. _____
 Contractor's Name and Address T. MAIORANO Tel. 7743572
 Location 194 York St Use of Building _____
 Number of Families _____ Apartments _____ Stores _____ Number of Stories _____
 Description of Wiring: New Work _____ Additions _____ Alterations _____

Pipe _____ Cable _____ Metal Molding _____ BX Cable _____ Plug Molding (No. of feet) _____
 No. Light Outlets _____ Plugs _____ Light Circuits _____ Plug Circuits _____
 FIXTURES: No. _____ Fluor. or Strip Lighting (No. feet) _____
 SERVICE: Pipe _____ Cable _____ Underground _____ No. of Wires 3 Size #2
 METERS: Relocated _____ Added _____ Total No. Meters _____
 MOTORS: Number _____ Phase _____ H. P. _____ Amps _____ Volts _____ Starter _____
 HEATING UNITS: Domestic (Oil) _____ No. Motors _____ Phase _____ H.P. _____
 Commercial (Oil) _____ No. Motors _____ Phase _____ H.P. _____
 Electric Heat (No. of Rooms) _____
 APPLIANCES: No. Ranges _____ Watts _____ Brand Feeds (Size and No.) _____
 Elec. Heaters _____ Watts _____
 Miscellaneous _____ Watts _____ Extra Cabinets or Panels _____
 Transformers _____ Air Conditioners (No. Units) _____ Signs (No. Units) _____
 Will commence 2 1974 Ready to cover in _____ 1974 Inspection _____ 1974
 Amount of Fee \$ 2.00 Signed Tom Majorano

DO NOT WRITE BELOW THIS LINE

SERVICE METER _____ GROUND _____
 VISITS: 1/2-12-74 3 _____ 4 _____ 5 _____ 6 _____
 7 _____ 8 _____ 9 _____ 10 _____ 11 _____ 12 _____

REMARKS:

CS 283 Service called in

INSPECTED BY Libby (OVER)

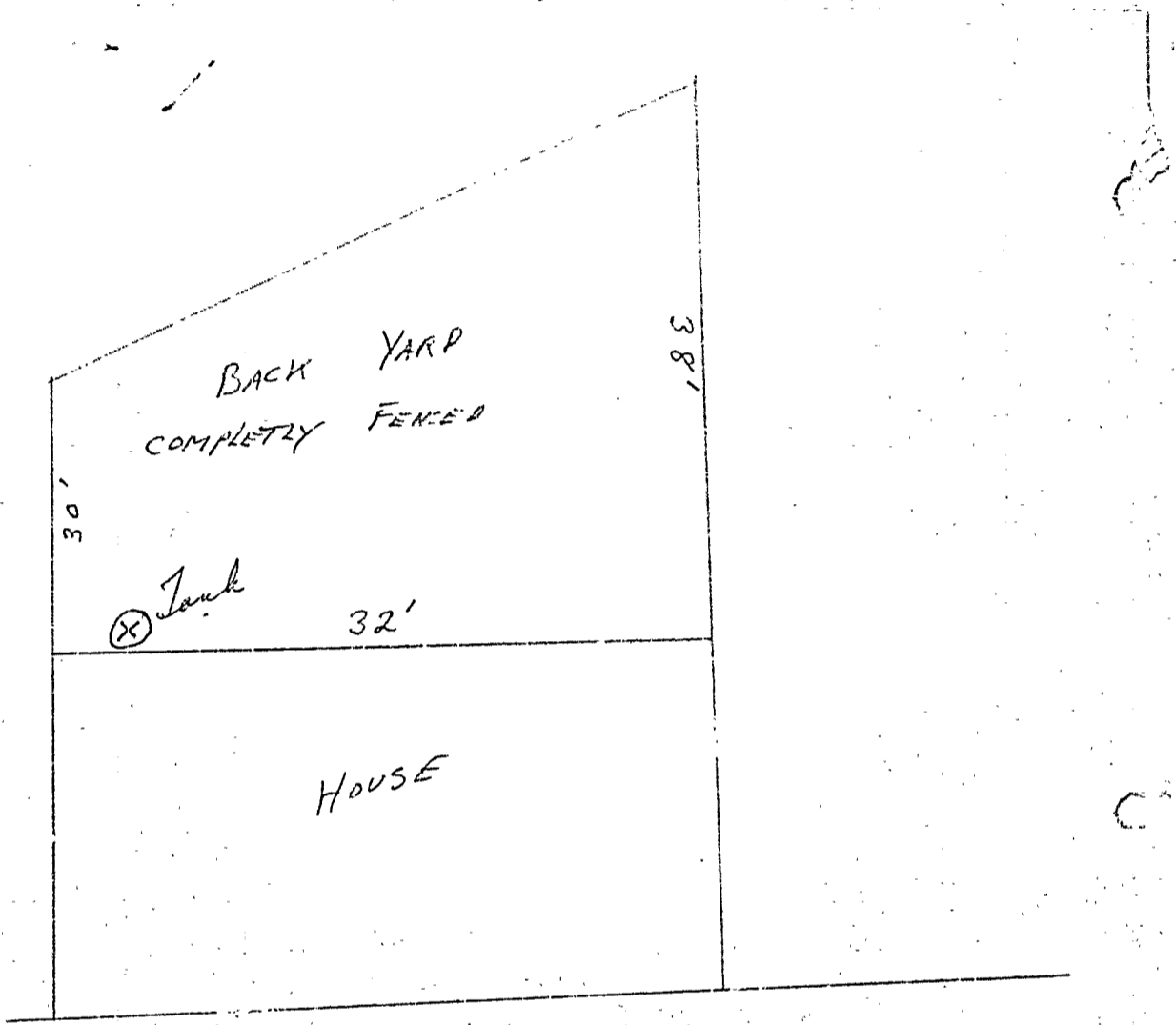

194 YORK ST

PERMIT REQUEST FOR BULK GAS STORAGE 100 GALS

FOR

VINCENT CARDONA

194 YORK ST

PORTLAND, ME

BY

SUBURBAN PROPANE



APPLICATION FOR PERMIT

Class of Building or Type of Structure Installation
Portland, Maine, July 19, 1965

PERMIT ISSUE
007733
JUL 21 1965
CITY OF PORTLAND

To the INSPECTOR OF BUILDINGS, PORTLAND, MAINE

The undersigned hereby applies for a permit to erect alter repair demolish install the following building structure equipment in accordance with the Laws of the State of Maine, the Building Code and Zoning Ordinances of the City of Portland, plans and specifications, if any, submitted herewith and the following specifications:

Location 194 York St. Within Fire Limits? _____ Dist. No. _____
Owner's name and address _____ Telephone _____
Lessee's name and address Vincert Cardona, 194 York St. Telephone _____
Contractor's name and address Suburban Propane Gas Corp. Thompson's Pt. Telephone 774-0387
Architect _____ Specifications _____ Plans yes No. of sheets 1
Proposed use of building _____ No. families _____
Last use _____ No. families _____
Material _____ No. stories _____ Heat _____ Style of roof _____ Roofing _____
Other buildings on same lot _____
Estimated cost \$ _____ Fee \$ 2.00

General Description of New Work

To install (1)-100 gallons propane gas storage tank, outside above ground.
Tank to set on concrete blocks.
Tanks bears Und. Label.

Sent to Fire Dept. 7/19/65
Rec'd from Fire Dept. 7/21/65

It is understood that this permit does not include installation of heating apparatus which is to be taken out separately by and in the name of the heating contractor. **PERMIT TO BE ISSUED TO contractor**

Details of New Work

Is any plumbing involved in this work? _____ Is any electrical work involved in this work? _____
Is connection to be made to public sewer? _____ If not, what is proposed for sewage? _____
Has septic tank notice been sent? _____ Form notice sent? _____
Height average grade to top of plate _____ Height average grade to highest point of roof _____
Size, front _____ depth _____ No. stories _____ solid or filled land? _____ earth or rock? _____
Material of foundation _____ Thickness, top _____ bottom _____ cellar _____
Kind of roof _____ Rise per foot _____ Roof covering _____
No. of chimneys _____ Material of chimneys _____ of lining _____ Kind of heat _____ fuel _____
Framing Lumber—Kind _____ Dressed or full size? _____ Corner posts _____ Sills _____
Size Girder _____ Columns under girders _____ Size _____ Max. on centers _____
Studs (outside walls and carrying partitions) 2x4-16" O. C. Bridging in every floor and flat roof span over 8 feet.
Joists and rafters: 1st floor _____, 2nd _____, 3rd _____, roof _____
On centers: 1st floor _____, 2nd _____, 3rd _____, roof _____
Maximum span: 1st floor _____, 2nd _____, 3rd _____, roof _____
If one story building with masonry walls, thickness of walls? _____ height? _____

If a Garage

No. cars now accommodated on same lot _____, to be accommodated _____ number commercial cars to be accommodated _____
Will automobile repairing be done other than minor repairs to cars habitually stored in the proposed building? _____

APPROVED:

Carl Johnson
CHIEF OF FIRE DEPT.

Miscellaneous

Will work require disturbing of any tree on a public street? no
Will there be in-charge of the above work a person competent to see that the State and City requirements pertaining thereto are observed? yes

Suburban Propane Gas Corp.

CS 301

INSPECTION COPY

Signature of owner by:

Warren R. Bushy

8-13 778

Permit No. 651738
Location 194 Apple Street
Owner Vincent Cardona
Date of permit 7/21/65
Notif. closing-in _____
Inspn. closing-in _____
Final Notif. _____
Final Inspn. _____
Cert. of Occupancy issued _____
Staking Out Notice _____
Form Check Notice _____

NOTES

8-2-65 Not done PA

8-13-65 Completed JAC

X

774



FILL IN AND SIGN WITH INK

APPLICATION FOR PERMIT FOR HEATING, COOKING OR POWER EQUIPMENT

Portland, Maine, Sept. 16, 1949

PERMIT ISSUED 01515 SEP 17 1949 CITY OF PORTLAND

To the INSPECTOR OF BUILDINGS, PORTLAND, MAINE

The undersigned hereby applies for a permit to install the following heating, cooking or power equipment in accordance with the Laws of Maine, the Building Code of the City of Portland, and the following specifications:

Location 194 York Street Use of Building Dwelling house No. Stories New Building Existing " Name and address of owner of appliance Mrs. Mary Riordan, 194 York Street Installer's name and address Portland Sebago Ice Co., 502 Commercial St. Telephone 3-2911

General Description of Work

To install oil burning equipment in connection with existing gravity warm air heating system

IF HEATER, OR POWER BOILER

Location of appliance or source of heat Type of floor beneath appliance If wood, how protected? Kind of fuel Minimum distance to wood or combustible material, from top of appliance or casing top of furnace From top of smoke pipe From front of appliance From sides or back of appliance Size of chimney flue Other connections to same flue If gas fired, how vented? Rated maximum demand per hour

IF OIL BURNER

Name and type of burner Delco Labelled by underwriter's laboratories? Yes Will operator be always in attendance? Does oil supply line feed from top or bottom of tank? bottom Type of floor beneath burner concrete Location of oil storage basement Number and capacity of tanks 1-275 gal. If two 275-gallon tanks, will three-way valve be provided? Will all tanks be more than five feet from any flame? Yes How many tanks fire proofed? Total capacity of any existing storage tanks for furnace burners none

IF COOKING APPLIANCE

Location of appliance Kind of fuel Type of floor beneath appliance If wood, how protected? Minimum distance to wood or combustible material from top of appliance From front of appliance From sides and back From top of smokepipe Size of chimney flue Other connections to same flue Is hood to be provided? If so, how vented? If gas fired, how vented? Rated maximum demand per hour

MISCELLANEOUS EQUIPMENT OR SPECIAL INFORMATION

Amount of fee enclosed? 2.00 (\$2.00 for one heater, etc., 50 cents additional for each additional heater, etc., in same building at same time.)

APPROVED:

OK 9-16-49 [Signature]

Will there be in charge of the above work a person competent to see that the State and City requirements pertaining thereto are observed? Yes

Portland Sebago Ice Co.

Signature of Installer by:

[Signature]

INSPECTION COPY

Permit No. 49/1515 ¹⁰⁻¹⁹⁻⁴⁹ 10-20-49 Glenn Building cut in
 Location 194 York St. Waltham will call me if
 Owner Mrs. Mary Riordan
 Date of permit 9/18/49
 Approved 10-20-49 J. J. K.

NOTES

- 1 Fill Pipe
- 2 Vent Pipe W/HR
- 3 Kind of Heat
- 4 Burner Rel. lity & Support
- 5 Name & Label
- 6 Stack Control
- 7 High Lim. Control
- 8 Remote Control
- 9 Pipe & Support Protection
- 10 Valves in the line
- 11 Capacity of Tank
- 12 Tank Rel. lity & Support
- 13 Tank Distance
- 14 Oil Gauge
- 15 Instruction Card
- 16



Location, Ownership and detail must be correct, complete and legible.
 with the Separate application required for every building.
 Plans must be filed with this application.

Application for Permit for Alterations, etc.

BEFORE COMING TO THE CITY OF PORTLAND, ME., ON OCTOBER 2, 1925

To the INSPECTOR OF BUILDINGS:

Portland, Me., October 2, 1925

Description of Present Bldg.

The undersigned applies for a permit to alter the following described building:—
 Location 194 York Street Ward 6 in fire-limits? no
 Name of Owner or Lessee, Joseph Reardon Address 194 York Street
 " " Contractor, F C Robbins " 55 Alba Street
 " " Architect, _____ " _____
 Material of Building is wood Style of Roof, pitch Material of Roofing, shingle
 Size of Building is _____ feet long; _____ feet wide. No. of Stories, _____
 Cellar Wall is constructed of _____ is _____ inches wide on bottom and batters to _____ inches on top.
 Underpinning is _____ is _____ inches thick; is _____ feet in height.
 Height of Building _____ Wall, if Brick; 1st, _____ 2d, _____ 3d, _____ 4th, _____ 5th, _____
 What was Building last used for? dwelling No. of Families? 1
 What will Building now be used for? dwelling 1 family

Detail of Proposed Work

Build dormer window on roof covered with asphalt
all to comply with the building ordinance

Estimated Cost \$ 200.

If Extended On Any Side

Size of Extension, No. of feet long? _____; No. of feet wide? _____; No. of feet high above sidewalk? _____
 No. of Stories high? _____; Style of Roof? _____; Material of Roofing? _____
 Of what material will the Extension be built? _____ Foundation? _____
 If of Brick, what will be the thickness of External Walls? _____ inches; and Party Walls _____ inches.
 How will the extension be occupied? _____ How connected with Main Building? _____

When Moved, Raised or Built Upon

No. of Stories in height when Moved, Raised, or Built upon? _____ Proposed Foundations? _____
 No. of feet high from level of ground to highest part of Roof to be? _____
 How many feet will the External Walls be increased in height? _____ Party Walls _____

If Any Portion of the External or Party Walls Are Removed

Will an opening be made in the Party or External Walls? _____ in _____ Story.
 Size of the opening? _____ How protected? _____
 How will the remaining portion of the wall be supported? _____

Signature of Owner or Authorized Representative

Address

Joseph Reardon
194 York St

PERMIT MUST BE OBTAINED BEFORE BEGINNING WORK

2261
194

10X

2261



194 York

Oct 2/25

Handwritten text, possibly a name or address, partially obscured by the stamp.

Handwritten text, possibly a name or address, partially obscured by the stamp.

Main body of the document containing multiple lines of text, including a large heading that reads "DEPARTMENT OF LABOR" and other illegible text.

REPRODUCTION OF THIS DOCUMENT IS PROHIBITED WITHOUT THE WRITTEN PERMISSION OF THE NATIONAL ARCHIVES



Location, Ownership and detail must be correct, complete and legible.
 Separate application required for every building.
 Plans must be filed with this application.

Application for Permit for Alterations, etc.

To the *Portland, July 23, 1935* 102

INSPECTOR OF BUILDINGS:

The undersigned applies for a permit to alter the following described building:—

Location *194 York Street* Ward *3* in fire-limits? *no*
 Name of Owner or Lessee *J. D. Reardon* Address *194 York Street*
 " " Contractor *F. O. Robbins* " *55 Alba Street*
 " " Architect " "
 Description of Present Bldg. Material of Building is *wood* Style of Roof *pitch* Material of Roofing *asphalt*
 Size of Building is *35ft* feet long; *25ft* feet wide. No. of Stories *1 1/2*
 Cellar Wall is constructed of *stone* is *12* inches wide on bottom and batters to *12* inches on top.
 Underpinning is *brick* is *12* inches thick; is *2* feet in height.
 Height of Building *20ft* Wall, if Brick; 1st *12* 2d *12* 3d *12* 4th *12* 5th *12*
 What was Building last used for? *dwelling* No. of families? *1*
 What will Building now be used for? *dwelling (one family)*

Description of Present Bldg. PLAN REPORT

PERMIT MUST BE OBTAINED BEFORE BEGINNING WORK

Detail of Proposed Work

Put in dormer windows covered with asphalt roof
all to comply with the building ordinance
 Estimated Cost \$ *150.*

If Extended On Any Side

Size of Extension, No. of feet long?.....; No. of feet wide?.....; No. of feet high above sidewalk?.....
 No. of Stories high?.....; Style of Roof?.....; Material of Roofing?.....
 Of what material will the Extension be built?..... Foundation?.....
 If of Brick, what will be the thickness of External Walls?.....inches; and Party Walls.....inches.
 How will the extension be occupied?..... How connected with Main Building?.....

When Moved, Raised or Built Upon

No. of Stories in height when Moved, Raised, or Built upon?..... Proposed Foundations.....
 No. of feet high from level of ground to highest part of Roof to be?.....
 How many feet will the External Walls be increased in height?..... Party Walls.....

If Any Portion of the External or Party Walls Are Removed

Will an opening be made in the Party or External Walls?..... in..... Story.
 Size of the opening?..... How protected?.....
 How will the remaining portion of the wall be supported?.....

Signature of Owner or Authorized Representative *F. O. Robbins*
 Address *55 Alba*

