

LANDSCAPE NOTES:

(SUBJECT TO COORDINATION WITH LANDSCAPE ARCHITECT.)

1. ALL PLANTS SHALL BE NURSERY GROWN AND WORKMANSHIP SHALL CONFORM TO THE AMERICAN ASSOCIATION OF NURSERYMEN STANDARDS AND SHALL BE SUBJECT TO THE APPROVAL OF THE OWNER'S REPRESENTATIVE BEFORE AND AFTER PLANTING.
2. PLANTS SHALL BE GUARANTEED FOR A PERIOD OF ONE (1) YEAR AFTER INSPECTION AND ACCEPTANCE, AND SHALL HAVE AT LEAST 80% HEALTHY GROWTH AT THE END OF THE GUARANTEED PERIOD.
3. ALL DISTURBED AREAS NOT TO BE PAVED OR OTHERWISE TREATED SHALL RECEIVE 4" LOAM AND SEED.
4. THREE (3) INCH BARK MULCH IS TO BE USED AROUND THE TREE AND SHRUB PLANTING AS SPECIFIED IN THE DETAILS. WHERE BARK MULCH IS USED IN A CURBED ISLAND, THE BARK SHALL MEET THE TOP INSIDE EDGE OF THE CURB. ALL OTHER AREAS SHALL RECEIVE 4" LOAM AND SEED.
5. THE CONTRACTOR SHALL SUPPLY ALL PLANT MATERIALS IN QUANTITIES SUFFICIENT TO COMPLETE THE PLANTING AS SHOWN.
6. PARKING AREA PLANTED ISLANDS TO HAVE A MINIMUM OF 4" TOPSOIL. REMOVE ALL CONSTRUCTION DEBRIS BEFORE TOPSOILING. TOPSOIL SHALL BE PLACED TO TOP OF CURB.
7. ALL PLANT MATERIAL SHALL BE APPROVED BY THE OWNER OR THE OWNER'S REPRESENTATIVE PRIOR TO ARRIVAL ON THE SITE.
8. PLANT MATERIAL SHALL BEAR THE SAME RELATIONSHIP TO FINISHED GRADE AS TO THE ORIGINAL PLANTING GRADE PRIOR TO DIGGING.
9. THE CONTRACTOR SHALL LOCATE, VERIFY, AND MARK ALL EXISTING AND NEWLY INSTALLED UNDERGROUND UTILITIES PRIOR TO ANY LAWN WORK OR PLANTING. ANY CONFLICTS WHICH MIGHT OCCUR BETWEEN PLANTINGS AND UTILITIES SHALL BE IMMEDIATELY REPORTED TO THE OWNER SO THAT ALTERNATE PLANTING LOCATIONS CAN BE DETERMINED.
10. NO SUBSTITUTION OF PLANT MATERIALS SHALL BE ALLOWED WITHOUT THE PRIOR WRITTEN APPROVAL OF THE OWNER.
11. THE CONTRACTOR SHALL BE RESPONSIBLE FOR PROTECTING ALL PLANTING AND LAWNS AGAINST DAMAGE FROM ONGOING CONSTRUCTION. THIS PROTECTION SHALL BEGIN AT THE TIME THE PLANT IS INSTALLED AND CONTINUE UNTIL THE FORMAL ACCEPTANCE OF ALL THE PLANTINGS.
12. SEE PLANTING DETAILS FOR WEED BARRIER INFORMATION.

PLANTING SCHEDULE

KEY	QUANTITY	NAME	SIZE	CONDITION	REMARKS
GB	8	CRINO BLOBA - MAIDENHAIR TREE	4" CAL	B & B	FULL MATCHED SPECIMENS
AR	1	ACER RUBRUM - RED MAPLE	14"-18" HT. 2.5" CAL.	B & B	
SHRUBS	4	TO BE DETERMINED BY LANDSCAPE ARCHITECT/OWNER			
DECEADUOUS TREES	6	TO BE DETERMINED BY LANDSCAPE ARCHITECT/OWNER			

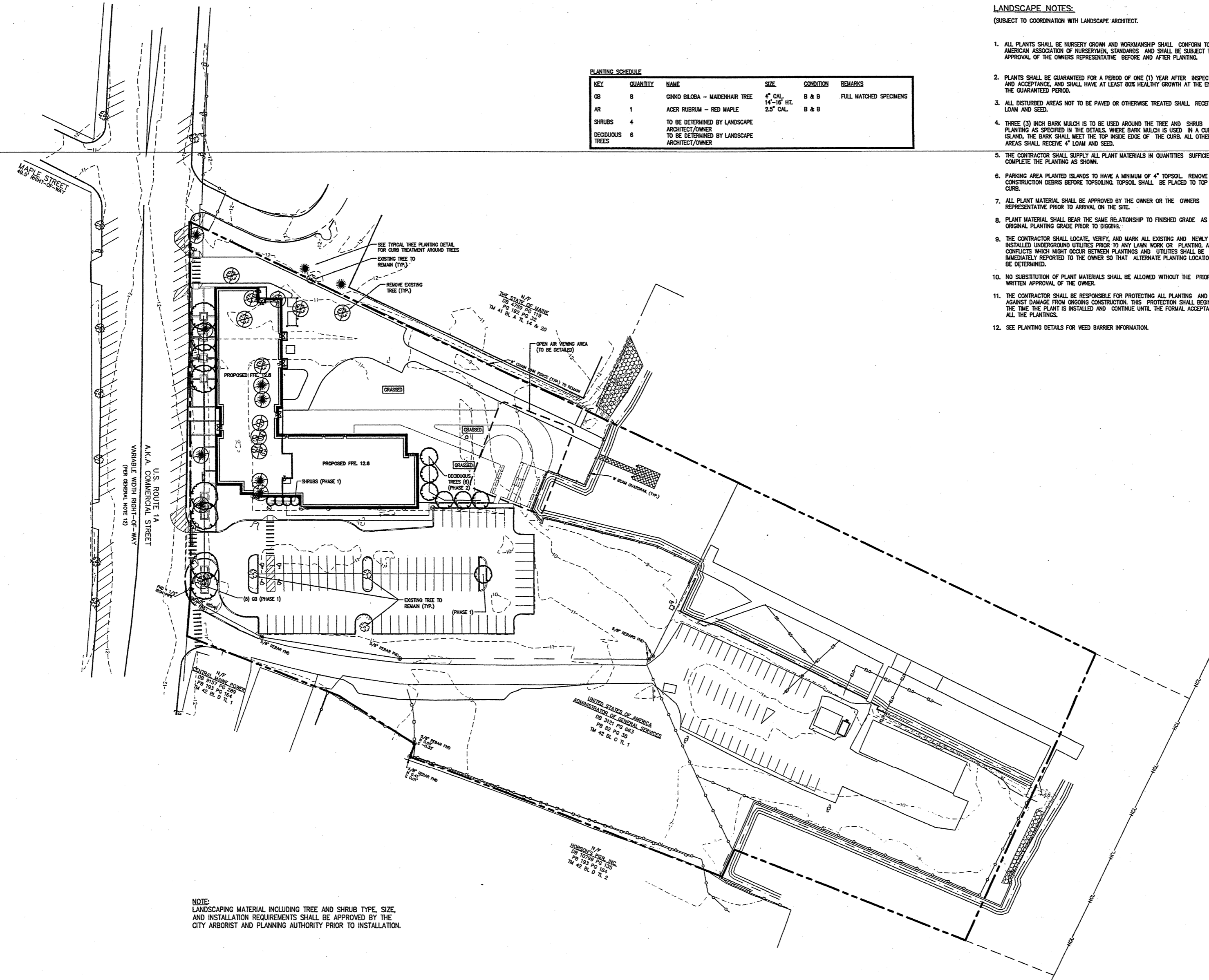

NOTE:
LANDSCAPING MATERIAL INCLUDING TREE AND SHRUB TYPE, SIZE,
AND INSTALLATION REQUIREMENTS SHALL BE APPROVED BY THE
CITY ARBORIST AND PLANNING AUTHORITY PRIOR TO INSTALLATION.

6	FINAL APPROVAL PLANS FOR CITY RECORDS	8.25.03
5	ADDENDUM #1	8.22.03
4	PHASE 1 CONSTRUCTION DOCUMENTS	8.12.03
3	FINAL SUBMISSION TO PORTLAND PLANNING AUTH.	7.30.03
2	DESIGN DEVELOPMENT SUBMISSION	6.13.03
1	SECOND WORKSHOP SUBMISSION TO CITY	6.10.03
REV.	DESCRIPTION	DATE

CURRENT ISSUE STATUS:

DH DeLUCA-HOFFMAN ASSOCIATES, INC.
778 MAIN STREET, SUITE 3
SOUTH PORTLAND, ME 04106
207.778.1121
WWW.DELUCAHOFFMAN.COM

SMRT ARCHITECTURE ENGINEERING PLANNING
SHRT
144 Fore Street/P.O. Box 618
Portland, Maine 04104
tel. (207) 772-3846
fax. (207) 772-1070

THE GULF OF MAINE RESEARCH INSTITUTE
PORTLAND, MAINE

PROJECT: **LANDSCAPING PLAN**

SHEET TITLE:	SCALE: 1" = 40'	DATE:
PROJECT MANAGER: RML	JOB. CAP/DRAWN: CMW	GRAPHIC SCALE: 0" 1"
A/E OF RECORD: DWJ	SMRT CAD FILE: CP101_03034	SHEET No. LP101
PROJECT No. 03034-00/1984.1		

A1 LANDSCAPING PLAN

1" = 40'