

# DISPLAY THIS CARD ON PRINCIPAL FRONTAGE OF WORK CITY OF PORTLAND

BUILDING DEPARTMENT

## PERMIT

Permit Number: 030768

Please Read Application And Notes, If Any, Attached

This is to certify that Gulf of Maine Research Institute / Ouellet  
has permission to demolition fo Existing Building for NEW Gulf of Maine Lab  
AT 344 Commercial St 042 C001001

provided that the person or persons, firm or corporation accepting this permit shall comply with all of the provisions of the Statutes of Maine and of the ordinances of the City of Portland regulating the construction, maintenance and use of buildings and structures, and of the application on file in this department.

Apply to Public Works for street line and grade if nature of work requires such information.

Notification of inspection must be given and written permission procured before this building or part thereof is occupied or closed-in.  
HOURS NOTICE IS REQUIRED.

A certificate of occupancy must be procured by owner before this building or part thereof is occupied.

### OTHER REQUIRED APPROVALS

Fire Dept. \_\_\_\_\_  
Health Dept. \_\_\_\_\_  
Appeal Board \_\_\_\_\_  
Other \_\_\_\_\_  
Department Name

*[Signature]*  
Director - Building & Inspection Services

**PENALTY FOR REMOVING THIS CARD**

**City of Portland, Maine - Building or Use Permit Application**  
 389 Congress Street, 04101 Tel: (207) 874-8703, Fax: (207) 874-8716

Permit No: 03-0768	Issue Date:	CBL: 042 C001001
-----------------------	-------------	---------------------

Location of Construction: 344 Commercial St	Owner Name: Gulf of Maine Research Institute	Owner Address:	Phone: 772-2321
Business Name:	Contractor Name: Ouellet Associates	Contractor Address: 56 Bibber Parkway Brunswick	Phone: 2077250100
Lessee/Buyer's Name	Phone:	Permit Type: Demolitions	Zone: WCZ

Past Use: Naval Reserve Traing Center/Commercial	Proposed Use: Naval Reserve Traing Center/Commercial	Permit Fee: \$443.00	Cost of Work: \$59,950.00	CEO District: 2
Proposed Project Description: demolition fo Existing Building for NEW Gulf of Maine Lab		FIRE DEPT: <input type="checkbox"/> Approved <input type="checkbox"/> Denied	INSPECTION: Use Group: <i>NA</i> Type: <i>DEMO</i> <i>7/22/03</i> Signature: <i>[Signature]</i>	
		PEDESTRIAN ACTIVITIES DISTRICT (P.A.D.) Action: <input type="checkbox"/> Approved <input type="checkbox"/> Approved w/Conditions <input type="checkbox"/> Denied Signature: _____ Date: _____		

Permit Taken By: gad	Date Applied For: 06/30/2003	<b>Zoning Approval</b>
-------------------------	---------------------------------	------------------------

1. This permit application does not preclude the Applicant(s) from meeting applicable State and Federal Rules.  2. Building permits do not include plumbing, septic or electrical work.  3. Building permits are void if work is not started within six (6) months of the date of issuance. False information may invalidate a building permit and stop all work..	<b>Special Zone or Reviews</b> <input type="checkbox"/> Shoreland <input type="checkbox"/> Wetland <input type="checkbox"/> Flood Zone <input type="checkbox"/> Subdivision <input type="checkbox"/> Site Plan Maj <input type="checkbox"/> Minor <input type="checkbox"/> MM <input type="checkbox"/>	<b>Zoning Appeal</b> <input type="checkbox"/> Variance <input type="checkbox"/> Miscellaneous <input type="checkbox"/> Conditional Use <input type="checkbox"/> Interpretation <input type="checkbox"/> Approved <input type="checkbox"/> Denied	<b>Historic Preservation</b> <input checked="" type="checkbox"/> Not in District or Landmark <input type="checkbox"/> Does Not Require Review <input type="checkbox"/> Requires Review <input type="checkbox"/> Approved <input type="checkbox"/> Approved w/Conditions <input type="checkbox"/> Denied
	Date: <i>OK 7/22/03</i>	Date: _____	Date: <i>[Signature]</i>

**CERTIFICATION**

I hereby certify that I am the owner of record of the named property, or that the proposed work is authorized by the owner of record and that I have been authorized by the owner to make this application as his authorized agent and I agree to conform to all applicable laws of this jurisdiction. In addition, if a permit for work described in the application is issued, I certify that the code official's authorized representative shall have the authority to enter all areas covered by such permit at any reasonable hour to enforce the provision of the code(s) applicable to such permit.

SIGNATURE OF APPLICANT	ADDRESS	DATE	PHONE
RESPONSIBLE PERSON IN CHARGE OF WORK, TITLE		DATE	PHONE

**City of Portland, Maine - Building or Use Permit**

389 Congress Street, 04101 Tel: (207) 874-8703, Fax: (207) 874-8716

<b>Permit No:</b> 03-0768	<b>Date Applied For:</b> 06/30/2003	<b>CBL:</b> 042 C001001
------------------------------	--	----------------------------

<b>Location of Construction:</b> 344 Commercial St	<b>Owner Name:</b> Gulf of Maine Research Institute	<b>Owner Address:</b>	<b>Phone:</b> ( ) 772-2321
<b>Business Name:</b>	<b>Contractor Name:</b> Ouellet Associates	<b>Contractor Address:</b> 56 Bibber Parkway Brunswick	<b>Phone:</b> (207) 725-0100
<b>Lessee/Buyer's Name</b>	<b>Phone:</b>	<b>Permit Type:</b> Demolitions	

<b>Proposed Use:</b> Naval Reserve Traing Center/Commercial	<b>Proposed Project Description:</b> demolition fo Existing Building for NEW Gulf of Maine Lab
--	---

<b>Dept:</b> Zoning	<b>Status:</b> Approved	<b>Reviewer:</b> Marge Schmuckal	<b>Approval Date:</b> 07/02/2003
<b>Note:</b>			<b>Ok to Issue:</b> <input checked="" type="checkbox"/>
<b>Dept:</b> Building	<b>Status:</b> Pending	<b>Reviewer:</b> Mike Nugent	<b>Approval Date:</b>
<b>Note:</b>			<b>Ok to Issue:</b> <input type="checkbox"/>

**Comments:**  
07/09/2003-mjn: Won't be ready for pre demo walk through until 7/21/03, it's scheduled, permit to be issued after satisfactory evaluation

# Asbestos Project Notification

State of Maine  
Department of Environmental Protection  
Lead & Asbestos Hazard Prevention Program  
17 State House Station, Augusta, ME 04333  
TEL (207) 287-2651 FAX (207) 287-7826

N  
Page 2 of 2

### Project Code

EMI  
(As listed on page 1)

### 14. Notification Submitted by

Name ENVIRONMENTAL MANAGEMENT, INC.  
Mailing Address P.O. Box 591  
City Brunswick State ME Zip 04911  
Contact Thomas D. Gill  
TEL 219-7549 FAX 201-0892

### 15. Procedure Used to Detect Presence of Asbestos

Assumed Positive  Tested Positive

Sampled By Kim Pinkham #324  
(Print Name)  
Company EMI

### 16. Project Clearance

Visual evaluation by: (List Air Monitor and Company)

EMI

Air Clearance by: (List Air Monitor and Company)

EMI

### 17. Waste Transporter (Must be ME DEP licensed Non-Hazardous Waste Transporter)

Name NEW HARBOR ABSTRACTION, INC.  
Address P.O. Box 227  
City Born State ME Zip \_\_\_\_\_  
Contact Mike Lemor  
TEL 442-1071 FAX \_\_\_\_\_

### 18. Disposal Site

Name MINERVA ENTERPRISES  
Address 9000 HUNTER  
City WINDSOR BURL State OH Zip 45689  
Contact \_\_\_\_\_  
TEL (603) 846 3435 FAX (603) 746 3434

### 19. Certification

I certify that to the best of my knowledge, the information contained in this notification is true and accurate.

Signature [Signature]

Date 7-1-03

20. Emergency Notification Request (Complete when a waiver to the 10-day notification requirement is requested for an emergency asbestos removal project which is necessitated by a sudden, unexpected event (e.g., boiler and associated piping/valves failure), a public health threat (e.g., clean up following a fiber release), or discovery of additional ACM during a renovation or demolition for which a renovation or demolition inspection was conducted (e.g., within a wall cavity or plumbing chase).

Detailed Explanation \_\_\_\_\_

Signature \_\_\_\_\_

Date \_\_\_\_\_

### 20A. ME DEP Action on Emergency Notification Request

ME DEP \_\_\_\_\_

Date \_\_\_\_\_

APPROVED

DISAPPROVED

MAY 21 2003 4:41PM IATL

NO. 475 P. 9

**IATL** International Asbestos  
Testing Laboratories

16000 Horizon Way Unit 100 Mt. Laurel, NJ 08054

Telephone: 856-231-9449 Fax: 856-231-9818

**CERTIFICATE OF ANALYSIS**

**Client:** Environmental Management Inc.  
51 River Rd., PO Box 391  
Brunswick ME 04011

**Report Date:** 05/27/2003  
**Project:** Navy Reserve Bldg., 5/21/03  
**Project No.:** 03-4488

**BULK SAMPLE ANALYSIS SUMMARY**

**Lab No.** 1726415 **Material Description:** Lt. Tan Insulation  
**Client No.:** B-19 **Location:** Hall #53 Above Ceiling Pipe Covering

<u>% Asbestos</u>	<u>Type</u>	<u>% Non-Asbestos Fibrous Material</u>	<u>Type</u>	<u>% Non-Fibrous Material</u>
None Detected	None Detected	15	Cellulose	79
		5	Fibrous Glass	
		1	Wool/Mineral	

**Lab No.** 1726416 **Material Description:** Grey/White Fibrous  
**Client No.:** B-20 **Location:** Room ROOFING

<u>% Asbestos</u>	<u>Type</u>	<u>% Non-Asbestos Fibrous Material</u>	<u>Type</u>	<u>% Non-Fibrous Material</u>
None Detected	None Detected	10	Fibrous Glass	90

**Lab No.** 1726417 **Material Description:** Yellow/Grey  
**Client No.:** B-21 **Location:** Non Fibrous Siding

<u>% Asbestos</u>	<u>Type</u>	<u>% Non-Asbestos Fibrous Material</u>	<u>Type</u>	<u>% Non-Fibrous Material</u>
None Detected	None Detected	None Detected	None Detected	100

**Lab No.** 1726418 **Material Description:** White Insulation  
**Client No.:** [REDACTED] **Location:**

<u>% Asbestos</u>	<u>Type</u>	<u>% Non-Asbestos Fibrous Material</u>	<u>Type</u>	<u>% Non-Fibrous Material</u>
10	Amosite	None Detected	None Detected	83
5	Chrysotile			

**NIST-NVLAP No. 1165 NY-DOH No. 11021 AIEHA Lab No. 444**

*This confidential report relates only to those tests performed and does not represent an endorsement by NIST-NVLAP or any agency of the U.S. government.*

**Analysis Method:** EPA 600/4-93/116

**Comments:** PCM (Phase Contrast Microscopy) method performed. Method not performed unless noted. PCM is not especially suitable in testing asbestos in floor coverings and other non-fibrous organically bound materials. Before this material can be analyzed or tested as non-asbestos containing, confirmation must be made by quantitative TEM.

**Analysis Performed By:** \_\_\_\_\_

**Approved By:** \_\_\_\_\_

**Date:** \_\_\_\_\_

Frank B. Stonefield, III  
Laboratory Director

MAY 21 2003 4:41PM IATL

NO. 479 P. 6

**IATL** International Asbestos  
Testing Laboratories

16000 Horizon Way Unit 100 Mt. Laurel, NJ 08054

Telephone: 856-231-9449 Fax: 856-231-9818

## CERTIFICATE OF ANALYSIS

**Client:** Environmental Management Inc.  
51 River Rd., PO Box 391  
Brunswick ME 04011

**Report Date:** 05/27/2003  
**Project:** Navy Reserve Bldg., 5/21/03  
**Project No.:** 03-4488

### BULK SAMPLE ANALYSIS SUMMARY

<b>Lab No.:</b> 1726413	<b>Material Description:</b> Tan Floor Tile			
<b>Client No.:</b> B-17	<b>Location:</b> Black Mastic	Tan Mastic; Room #9		
<b>% Asbestos</b>	<b>Type</b>	<b>% Non-Asbestos Fibrous Material</b>	<b>Type</b>	<b>% Non-Fibrous Material</b>
PC 1.7	Chrysotile	None Detected	None Detected	PC 91.3
Black Mastic From Above				

<b>Lab No.:</b> 1726413	<b>Material Description:</b> Tan Floor Tile			
<b>Client No.:</b> B-17	<b>Location:</b> Black Mastic	Tan Mastic; Room #3		
<b>% Asbestos</b>	<b>Type</b>	<b>% Non-Asbestos Fibrous Material</b>	<b>Type</b>	<b>% Non-Fibrous Material</b>
None Detected	None Detected	1	Calcians	99
Tan Mastic From Above				

<b>Lab No.:</b> 1726414	<b>Material Description:</b> Lt. Green Floor Tile			
<b>Client No.:</b> B-18	<b>Location:</b> Tan Mastic	Room #6		
<b>% Asbestos</b>	<b>Type</b>	<b>% Non-Asbestos Fibrous Material</b>	<b>Type</b>	<b>% Non-Fibrous Material</b>
None Detected	None Detected	None Detected	None Detected	100

<b>Lab No.:</b> 1726414	<b>Material Description:</b> Lt. Green Floor Tile			
<b>Client No.:</b> B-18	<b>Location:</b> Tan Mastic	Room #6		
<b>% Asbestos</b>	<b>Type</b>	<b>% Non-Asbestos Fibrous Material</b>	<b>Type</b>	<b>% Non-Fibrous Material</b>
None Detected	None Detected	None Detected	None Detected	100
Mastic From Above				

**NIST-NVLAP No. 1165**

**NY-DOH No. 11021**

**AIHA Lab No. 444**

*This confidential report relates only to those tests/analyses and does not represent an endorsement by NIST-NVLAP or any agency of the U.S. government.*

**Analysis Method:** EPA 600/4-92-010

**Comments:** (PC) Indicates Physical Form Count Method performed. Method not performed values noted. PLM is not currently utilized in floor coverings and similar non-divisible organically based materials. Before this material can be contained or treated as non-organic containing, confirmation must be made by qualitative TEM.

**Analysis Performed By:** \_\_\_\_\_

**Approved By:** \_\_\_\_\_

**Date:** \_\_\_\_\_

Frank S. Shoverfield, III  
Laboratory Director

MAY. 27. 2003 4:41PM IATL

NO. 478 P. 7

**IATL** International Asbestos  
Testing Laboratories

16000 Horizon Way Unit 100 Mt. Laurel, NJ 08054

Telephone: 856-231-9449 Fax: 856-251-0818

**CERTIFICATE OF ANALYSIS**Client: Environmental Management Inc.  
51 River Rd., PO Box 391  
Brunswick ME 04011Report Date: 05/27/2003  
Project: Navy Reserve Bldg., 5/21/03  
Project No.: 03-4488**BULK SAMPLE ANALYSIS SUMMARY**

Lab No. 1726411	Material Description: Off-White Insulation			
Client No.: B-15	Location: Room#37 Above Ceiling Pipe Covering			
<u>% Asbestos</u>	<u>Type</u>	<u>% Non-Asbestos Fibrous Material</u>	<u>Trace</u>	<u>% Non-Fibrous Material</u>
28	Chrysotile	None Detected	None Detected	80

Lab No. 1726412	Material Description: Black Floor Tile			
Client No.: B-16	Location: Off-White Floor Tile Room #18			
<u>% Asbestos</u>	<u>Type</u>	<u>% Non-Asbestos Fibrous Material</u>	<u>Trace</u>	<u>% Non-Fibrous Material</u>
PC 2.8	Chrysotile	None Detected	None Detected	PC 97.2
No Mastix				

Lab No. 1726412	Material Description: Black Floor Tile			
Client No.: B-16	Location: Off-White Floor Tile Room #18			
<u>% Asbestos</u>	<u>Type</u>	<u>% Non-Asbestos Fibrous Material</u>	<u>Trace</u>	<u>% Non-Fibrous Material</u>
PC 2.1	Chrysotile	None Detected	None Detected	PC 97.9
No Mastix Floor Tile From Above				

Lab No. 1726413	Material Description: Tan Floor Tile			
Client No.: B-17	Location: Black Mastix Tan Mastix; Room #3			
<u>% Asbestos</u>	<u>Type</u>	<u>% Non-Asbestos Fibrous Material</u>	<u>Trace</u>	<u>% Non-Fibrous Material</u>
PC 2.0	Chrysotile	None Detected	None Detected	98

NIST-NVLAP No. 1165

NY-DOH No. 11021

AIHA Lab No. 444

This analytical report relates only to those tests listed and does not represent an endorsement by NIST-NVLAP or any agency of the U.S. government

Analysis Method: EPA 600/8-03/116

Comments: (C) Intense Surface Pile: Client advised pavement. Method not performed unless mastix. PLM trace consistently positive in flooring schemes in floor coverings and similar non-stable organically bound materials. Before this material can be removed or treated in place, asbestos containing confirmation must be made by qualitative TEM.

Analysis Performed By: \_\_\_\_\_

Approved By: \_\_\_\_\_

Date: \_\_\_\_\_

Frank E. Humphrey, III  
Laboratory Director

MAY. 27. 2003 4:40PM IATL

NO. 476 P. 6

**IATL** International Asbestos  
Testing Laboratories

16000 Horizon Way Unit 100 Mt. Laurel, NJ 08054

Telephone: 856-231-9449 Fax: 856-231-9818

**CERTIFICATE OF ANALYSIS**Client: Environmental Management Inc.  
51 River Rd., PO Box 391  
Brunswick ME 04011Report Date: 05/27/2003  
Project: Navy Reserve Bldg., 5/21/03  
Project No.: 03-4488**BULK SAMPLE ANALYSIS SUMMARY**

Lab No. 1726408	Material Description: White Insulation			
Client No.: B-12	Location: Mech. Room	Pipe Covering		
<u>% Asbestos</u>	<u>Type</u>	<u>% Non-Asbestos Fibrous Material</u>	<u>Type</u>	<u>% Non-Fibrous Material</u>
15	Amesite	None Detected	None Detected	75
10	Chrysotile			

Lab No. 1726409	Material Description: Off-White Insulation			
Client No.: B-15	Location: Boiler Room	Pipe Covering		
<u>% Asbestos</u>	<u>Type</u>	<u>% Non-Asbestos Fibrous Material</u>	<u>Type</u>	<u>% Non-Fibrous Material</u>
20	Chrysotile	None Detected	None Detected	80

Lab No. 1726410	Material Description: Lt. Blue Floor Tile			
Client No.: B-14	Location: Black Mastic	Room #137		
<u>% Asbestos</u>	<u>Type</u>	<u>% Non-Asbestos Fibrous Material</u>	<u>Type</u>	<u>% Non-Fibrous Material</u>
None Detected	None Detected	1	Cellulose	99

Lab No. 1726410	Material Description: Lt. Blue Floor Tile			
Client No.: B-14	Location: Black Mastic	Room #137		
<u>% Asbestos</u>	<u>Type</u>	<u>% Non-Asbestos Fibrous Material</u>	<u>Type</u>	<u>% Non-Fibrous Material</u>
15	Chrysotile	None Detected	None Detected	PC 98.5

NIST-NVLAP No. 1165

NY-DOH No. 11021

AHEA Lab No. 444

This confidential report refers only to those sample tested and does not represent an endorsement by NIST-NVLAP or any agency of the U.S. government.

Analysis Method: EPA 8460-R-93/116

Comments: (PC) follows Standard Point Count Method performed. Method not performed unless noted. PLM is not uniformly reliable in detecting asbestos in floor coverings and similar materials especially hard materials. Before this material can be considered or treated as non-asbestos containing, confirmation must be made by quantitative TEM.

Analysis Performed By: \_\_\_\_\_

Approved By: \_\_\_\_\_

Date: \_\_\_\_\_

Frank B. Hensford, III  
Laboratory Director



MAY. 27. 2003 4:40PM IATL

NO. 473 P. 5

**IATL** International Asbestos  
Testing Laboratories

16000 Harbor Way Unit 100 Mt. Laurel, NJ 08054

Telephone: 856-231-9449 Fax: 856-231-9411

## CERTIFICATE OF ANALYSIS

**Client:** Environmental Management Inc.  
51 River Rd., PO Box 391  
Brunswick ME 04011

**Report Date:** 05/27/2003  
**Project:** Navy Reserve Bldg. 521/05  
**Project No.:** 03-4488

### BULK SAMPLE ANALYSIS SUMMARY

Lab No. 1726403	Material Description: Red Floor Tile	Room #48		
Client No.: B-9	Location: Lt. Tan Mastie			
<u>% Asbestos</u>	<u>Type</u>	<u>% Non-Asbestos Fibrous Material</u>	<u>Type</u>	<u>% Non-Fibrous Material</u>
None Detected	None Detected	1	Cellulose	99

Lab No. 1726405	Material Description: Red Floor Tile	Room #48		
Client No.: B-9	Location: Lt. Tan Mastie			
<u>% Asbestos</u>	<u>Type</u>	<u>% Non-Asbestos Fibrous Material</u>	<u>Type</u>	<u>% Non-Fibrous Material</u>
None Detected	None Detected	None Detected	None Detected	100
Matrix From Above				

Lab No. 1726406	Material Description: Lt. Tan Insulation	Pipe Covering		
Client No.: B-10	Location: Mech. Room			
<u>% Asbestos</u>	<u>Type</u>	<u>% Non-Asbestos Fibrous Material</u>	<u>Type</u>	<u>% Non-Fibrous Material</u>
None Detected	None Detected	19	Cellulose	79
		3	Fibrous Glass	
		1	Woolite/wool	

Lab No. 1726407	Material Description: Lt. Tan Insulation	Pipe Covering		
Client No.: B-11	Location: Mech. Room			
<u>% Asbestos</u>	<u>Type</u>	<u>% Non-Asbestos Fibrous Material</u>	<u>Type</u>	<u>% Non-Fibrous Material</u>
None Detected	None Detected	15	Cellulose	79
		4	Fibrous Glass	
		1	Woolite/wool	

**NIST-NVLAP No. 1165 NY-DOH No. 11021 AIHA Lab No. 444**

*This confidential report relates only to the sample(s) tested and does not represent an endorsement by NIST-NVLAP or any agency of the U.S. government.*

Analysis Method: EPA 600/8-93/116

**Comment:** (PC) Infrared Fourier Transform Method performed. Method not performed unless noted. IRM is not consistently suitable in detecting asbestos in floor coverings and similar non-durable organically bound materials. Before this material can be considered or used as non-asbestos containing, confirmation must be made by quantitative TEM.

Analysis Performed By: \_\_\_\_\_

Approved By: \_\_\_\_\_

Date: \_\_\_\_\_

Frank B. Stronach, III  
Laboratory Director

MAY. 27. 2003 4:39PM IATL

NO. 478 P. 4

**IATL** International Asbestos  
Testing Laboratories

16000 Harbor Way Unit 100 2nd Level, NJ 08054

Telephone: 856-231-9440 Fax: 856-231-9818

**CERTIFICATE OF ANALYSIS**Client: Environmental Management Inc.  
51 River Rd., PO Box 391  
Brunswick ME 04011Report Date: 05/27/2003  
Project: Navy Reserve Bldg, 5-21/03  
Project No.: 03-4488**BULK SAMPLE ANALYSIS SUMMARY**

Lab No. 1726402	Material Description: Lt. Brown Floor Tile
Client No.: B-6	Location: Room #22
<u>% Asbestos</u>	<u>% Non-Asbestos Fibrous Material</u>
PC 2.5	None Detected
Type Crystalline	Type None Detected
Material Matrix	<u>% Non-Fibrous Material</u> PC 97.5

Lab No. 1726403	Material Description: Tan Ceiling Tile
Client No.: B-7	Location: Room #23
<u>% Asbestos</u>	<u>% Non-Asbestos Fibrous Material</u>
None Detected	20
Type None Detected	Type Cellulose
	15
	Fibrous Glass
	<u>% Non-Fibrous Material</u> 65

Lab No. 1726404	Material Description: Grey Floor Tile
Client No.: B-8	Location: Lt. Tan Mastic Room #48
<u>% Asbestos</u>	<u>% Non-Asbestos Fibrous Material</u>
None Detected	1
Type None Detected	Type Cellulose
	<u>% Non-Fibrous Material</u> 99

Lab No. 1726404	Material Description: Grey Floor Tile
Client No.: B-8	Location: Lt. Tan Mastic Room #48
<u>% Asbestos</u>	<u>% Non-Asbestos Fibrous Material</u>
None Detected	None Detected
Type None Detected	Type None Detected
Matrix From Above	<u>% Non-Fibrous Material</u> 100

NIST-NVLAP No. 1165

NY-DOH No. 11021

AJHA Lab No. 444

This analytical report relates only to those samples tested and does not represent an endorsement by NIST-NVLAP or any agency of the U.S. Government.

Analysis Method: EPA 600/2-92/116

Comments: GC/EDS/SEM/EDS/FTIR/ICP-MS Method performed. Method not performed unless stated. NIST is not currently capable of detecting asbestos in floor coverings and similar materials regularly beyond asbestos. Before this material can be considered or treated as non-asbestos containing, confirmation must be made by quantitative TEM.

Analysis Performed By: \_\_\_\_\_

Approved By: \_\_\_\_\_

Date: \_\_\_\_\_

Frank T. Stroud, II  
Laboratory Director

MAY. 27. 2003 4:39PM IATL

NO. 478 P. 3

**IATL** International Asbestos  
Testing Laboratories

16000 Horizon Way Unit 100 MR. Laurel, NJ 09034

Telephone: 856-231-9449 Fax: 856-231-9418

**CERTIFICATE OF ANALYSIS**Client: Environmental Management Inc.  
51 River Rd., PO Box 391  
Brunswick ME 04011Report Date: 05/27/2003  
Project: Navy Reserve Bldg., 5/21/03  
Project No.: 03-4488**BULK SAMPLE ANALYSIS SUMMARY**

Lab No. 1725400	Material Description: Blue Floor Tile			
Client No.: B-4	Location: Tan Mastic	BlackMastic, Room#47	47	
<u>% Asbestos</u>	<u>Type</u>	<u>% Non-Asbestos Fibrous Material</u>	<u>Type</u>	<u>% Non-Fibrous Material</u>
None Detected	None Detected	None Detected	None Detected	100
Tan Mastic				
From Above				

Lab No. 1726400	Material Description: Blue Floor Tile			
Client No.: B-4	Location: Tan Mastic	BlackMastic, Room#47		
<u>% Asbestos</u>	<u>Type</u>	<u>% Non-Asbestos Fibrous Material</u>	<u>Type</u>	<u>% Non-Fibrous Material</u>
PC 1.7	Chrysotile	None Detected	None Detected	PC 98.3
Black Mastic				
From Above				

Lab No. 1726401	Material Description: Blue Floor Tile			
Client No.: B-5	Location: Black Mastic	Room #48 Hallway		
<u>% Asbestos</u>	<u>Type</u>	<u>% Non-Asbestos Fibrous Material</u>	<u>Type</u>	<u>% Non-Fibrous Material</u>
PC 2.0	Chrysotile	None Detected	None Detected	98

Lab No. 1726401	Material Description: Blue Floor Tile			
Client No.: B-5	Location: Black Mastic	Room #48 Hallway		
<u>% Asbestos</u>	<u>Type</u>	<u>% Non-Asbestos Fibrous Material</u>	<u>Type</u>	<u>% Non-Fibrous Material</u>
PC 1.8	Chrysotile	None Detected	None Detected	PC 98.2
Mastic From Above				

NIST-NVLAP No. 1165

NY-DOH No. 11021

AIHA Lab No. 444

This confidential report relates only to those test(s) named and does not represent an endorsement by NIST, NVLAP or any agency of the U.S. government.

Analysis Method: EPA 600/R-93/116

Comments: (PC) indicates Detailed Point Count Method performed. Method not performed unless noted. PLM is not completely reliable in detecting asbestos in floor coverings and similar non-fibrous organically bound materials. Unless this material can be confirmed or treated as non-asbestos containing, confirmation must be made by quantitative TEM.

Analysis Performed By: \_\_\_\_\_

Approved By: \_\_\_\_\_

Date: \_\_\_\_\_

Frank E. Shuffield, III  
Laboratory Director

MAY 27 2003 4:39PM IATEL

NO. 479 P. 2

**IATEL** International Asbestos  
Testing Laboratories

16000 Horizon Way Unit 100 Mt. Laurel, NJ 08054

Telephone: 856-231-9449 Fax: 856-231-9818

**CERTIFICATE OF ANALYSIS**Client: Environmental Management Inc.  
51 River Rd., PO Box 391  
Brunswick ME 04011Report Date: 05/27/2003  
Project: Navy Reserve Bldg., 5/21/03  
Project No.: 03-4488**BULK SAMPLE ANALYSIS SUMMARY**

Lab No. 1726397	Material Description: Tan Ceiling Tile
Client No.: B-1	Location: Hallway
<u>% Asbestos</u>	<u>% Non-Asbestos Fibrous Material</u>
None Detected	20
<u>Type</u>	<u>Type</u>
None Detected	Cellulose
	15
	Fibrous Glass
	<u>% Non-Fibrous Material</u>
	65

Lab No. 1726398	Material Description: Tan Ceiling Tile
Client No.: B-2	Location: Room #47
<u>% Asbestos</u>	<u>% Non-Asbestos Fibrous Material</u>
None Detected	20
<u>Type</u>	<u>Type</u>
None Detected	Cellulose
	15
	Fibrous Glass
	<u>% Non-Fibrous Material</u>
	65

Lab No. 1726399	Material Description: Tan Ceiling Tile
Client No.: B-3	Location: Room #37
<u>% Asbestos</u>	<u>% Non-Asbestos Fibrous Material</u>
None Detected	20
<u>Type</u>	<u>Type</u>
	Cellulose
	15
	Fibrous Glass
	<u>% Non-Fibrous Material</u>
	65

Lab No. 1726400	Material Description: Blue Floor Tile
Client No.: B-4	Location: Tan Marble BlackMastic; Room#47
<u>% Asbestos</u>	<u>% Non-Asbestos Fibrous Material</u>
PC 2.1	None Detected
<u>Type</u>	<u>Type</u>
Chrysotile	None Detected
	<u>% Non-Fibrous Material</u>
	PC 97.9

NIST-NVLAP No. 1165

NY-DOH No. 11021

AIHA Lab No. 444

This confidential report relates only to those item(s) tested and does not represent an endorsement by NIST-NVLAP or any agency of the U.S. government.

Analysis Method: EPA 600/8-92/116

Comments: (PC) Indicate quantity from client limited procedure. Method not performed unless noted. NIST is not currently capable of detecting asbestos in floor covering and similar non-fibrous organically bound materials. Before this material can be considered or treated as non-asbestos containing, confirmation must be made by quantitative TEM.

Analysis Performed By: \_\_\_\_\_

Approved By: \_\_\_\_\_

Date: \_\_\_\_\_

Frank E. Ziegler, III  
Laboratory Director



**OUELLET ASSOCIATES INC.**  
General Contractors & Professional Managers of Construction

*Partnership in Construction*

- Fax
- Date July 9, 2003
- Project: Gulf of Maine Research Institute - Research Laboratory  
350 Commercial Street, Portland
- Subject: Asbestos Abatement Information

Mike Nugent, City of Portland Inspections

As you requested please find the asbestos impact survey for the property at 350 Commercial Street, as well as, the Maine DEP Asbestos Project Notification form on the following 13 pages. If you need any further information please let me know.

David M. Lawrence  
Project Manager

Notification

State of Maine  
 Department of Environmental Protection  
 Lead & Asbestos Hazard Prevention Program  
 17 State House Station, Augusta, ME 04333  
 TEL (207) 287-2651 FAX (207) 287-7826

13603  
 7/2003  
 FORM N  
 Page 1 of 2

1. Code <b>NI</b>	2. Type of Notification <input type="checkbox"/> Emergency (E) <input type="checkbox"/> Non-Scheduled O&M <input checked="" type="checkbox"/> Original (O)	3. Type of Activity <input checked="" type="checkbox"/> Demolition (D) <input type="checkbox"/> Renovation (R)	4. Variances (Check all that apply) <input type="checkbox"/> Non-Standard (NS) <input checked="" type="checkbox"/> Standard (S)
----------------------	---	--	--

5. Asbestos Contractor <b>NEW MEADOWS REMEDIATION, INC.</b> P.O. Box 227 <b>BATH</b> State <b>ME</b> Zip _____ <b>Mike Lander</b> <b>443-1071</b> FAX _____	6. Facility Owner Name <b>OUELLET ASSOC.</b> Mailing Address <b>209 MAINE ST.</b> City <b>BELLEVILLE</b> State <b>ME</b> Zip <b>04011</b> Contact <b>ARUN WADSWORTH</b> TEL <b>725-0100</b> FAX _____
--	--

7. Property Location (Where removal is to take place) Name <b>TURNER NAVY RESERVE CTR.</b> Address <b>COMMERCIAL ST.</b> <b>BATH</b> State <b>ME</b> Zip _____	8. Facility Description Present Use <b>VACANT</b> Prior Use <b>NAVY RESERVE CTR.</b> BLDG Size <b>14000</b> No. Floors <b>1</b> BLDG Age <b>50</b>
---	--

9. Notification Fees (Required fees to accompany notification) 100.00 = ACM amounts 100 LbFt to 1000 SqFt/5000 LbFt. 200.00 = ACM amounts greater than 1000 SqFt/5000 LbFt. Not Required or Incurred in Block #9A)	9A. Notification Fee Not Included <input type="checkbox"/> Single family home exemption <input type="checkbox"/> ACM amount less than 100 SqFt/100 LbFt <input type="checkbox"/> Fees paid quarterly (Non-Scheduled O&M only) <input type="checkbox"/> BGS exemption	10. Project Work Hours <b>7 AM to 4 PM</b> (Show actual hours) Weekdays (Check all that apply): <input checked="" type="checkbox"/> M <input checked="" type="checkbox"/> T <input checked="" type="checkbox"/> W <input checked="" type="checkbox"/> TH <input checked="" type="checkbox"/> F Weekend (Check all that apply): <input type="checkbox"/> Sat <input type="checkbox"/> Sun
---	--	---

11. Scheduled Dates for Asbestos Removal (Complete Block #12 for Phased Projects) Start Date (MM/DD/YY) <b>7-7-03</b> Completion Date (MM/DD/YY) <b>7-30-03</b>	12. Scheduled Dates for Phased Projects Phase 1 Start Date _____ Completion Date _____ Phase 2 Start Date _____ Completion Date _____ Phase 3 Start Date _____ Completion Date _____ Phase 4 Start Date _____ Completion Date _____ Phase 5 Start Date _____ Completion Date _____
---	---

Asbestos (ACM) Removal			ME DEP USE ONLY	
ACM Type	Amount	Measurement	Postmark	Date Received
UAT	21000	SqFt <input checked="" type="checkbox"/> LbFt _____	<b>Hard del. 7-2-03</b>	<b>7-2-03</b>
TSE	<del>400</del> 500	SqFt _____ LbFt <input checked="" type="checkbox"/>	Date Received	Check # <b>4445</b>
		SqFt _____ LbFt _____	NESHAP	
		SqFt _____ LbFt _____	State	
		SqFt _____ LbFt _____	Variance	<b>S</b>

**ENVIRONMENTAL MANAGEMENT, INC.**

P.O. BOX 391 BRUNSWICK, MAINE 04011  
emi990@blazenetme.net

(207) 729-7549  
FAX (207) 721-0892

**RECEIVED**

JUN 02 2003

**OUELLET ASSOCIATES**

May 29, 2003

Mr. David Lawrence  
Ouellette Associates  
289 Maine Street  
Brunswick Maine 04011

Re: Demolition Impact Survey, Navy Reserve Building, Portland Maine

Dear Mr. Lawrence,

On March 21, 2003 a representative of Environmental Management Inc., conducted an asbestos demolition impact survey at the Navy Reserve Building in Portland Maine.

The building is a single level building constructed on a concrete slab. The areas sampled for asbestos on the interior of the building were the floor coving (floor tile) and ceiling tiles found through out the building, and pipe coverings in the boiler room, mechanical room and above ceiling tiles. Most floor tiles samples taken tested positive for asbestos. Pipe coverings samples taken tested positive in several areas. (See attached reports and drawings). All ceiling samples tested non-asbestos.

On the exterior of the building, the areas sampled were the main roofing and siding. All exterior samples tested non- asbestos.

Attached are the corresponding analytical results Linear/square footage table and drawings for your reference. Current Federal Regulations stipulate that any material found to have less than 1% asbestos (trace) is considered a non-asbestos containing material.

If you have any questions, please contact me at 729-7549.

Sincerely,  
Environmental Management Inc.



Kim W. Pinkham

Asbestos Inspector (MDEP #0324)

**ENVIRONMENTAL MANAGEMENT INC.  
BRUNSWICK, MAINE 04011  
(207) 729-7549**

**Linear / Square Footage Table**  
[quantities are estimated]

**CLIENT: OUELLETTE & ASSOCIATES**  
**EM# 03-4488**  
**JOB: Navy Reserve Building**

LOCATION	REF. NUMBER	SQUARE FOOTAGE	LINEAR FOOTAGE
Ceiling Tiles (through out building) non-Asbestos.	B-1,2,3	20,000	
Floor Tiles (through out building ) asbestos.	B-4,5,6,16,17	21,000	
Pipe Covering- elbows&tees (mechanical room ) non-asbestos	B-10,11		10 ct..
Pipe Covering (above ceilings in mechanical room ) asbestos.	B-12		44
Pipe Covering (boiler room )asbestos	B-13	20	
Pipe Covering (above suspended ceilings through out building) asbestos	B-5 a,b,c		450
Roofing -non-asbestos	B-20 a,b,c	23,000	
Siding (exterior) non-asbestos	B-21 a,b,c	30,000	
Note: mastics tested positive for asbestos			
Note: All square and linear footages are estimates.			



— = Pipe Covering

= Floor Tile

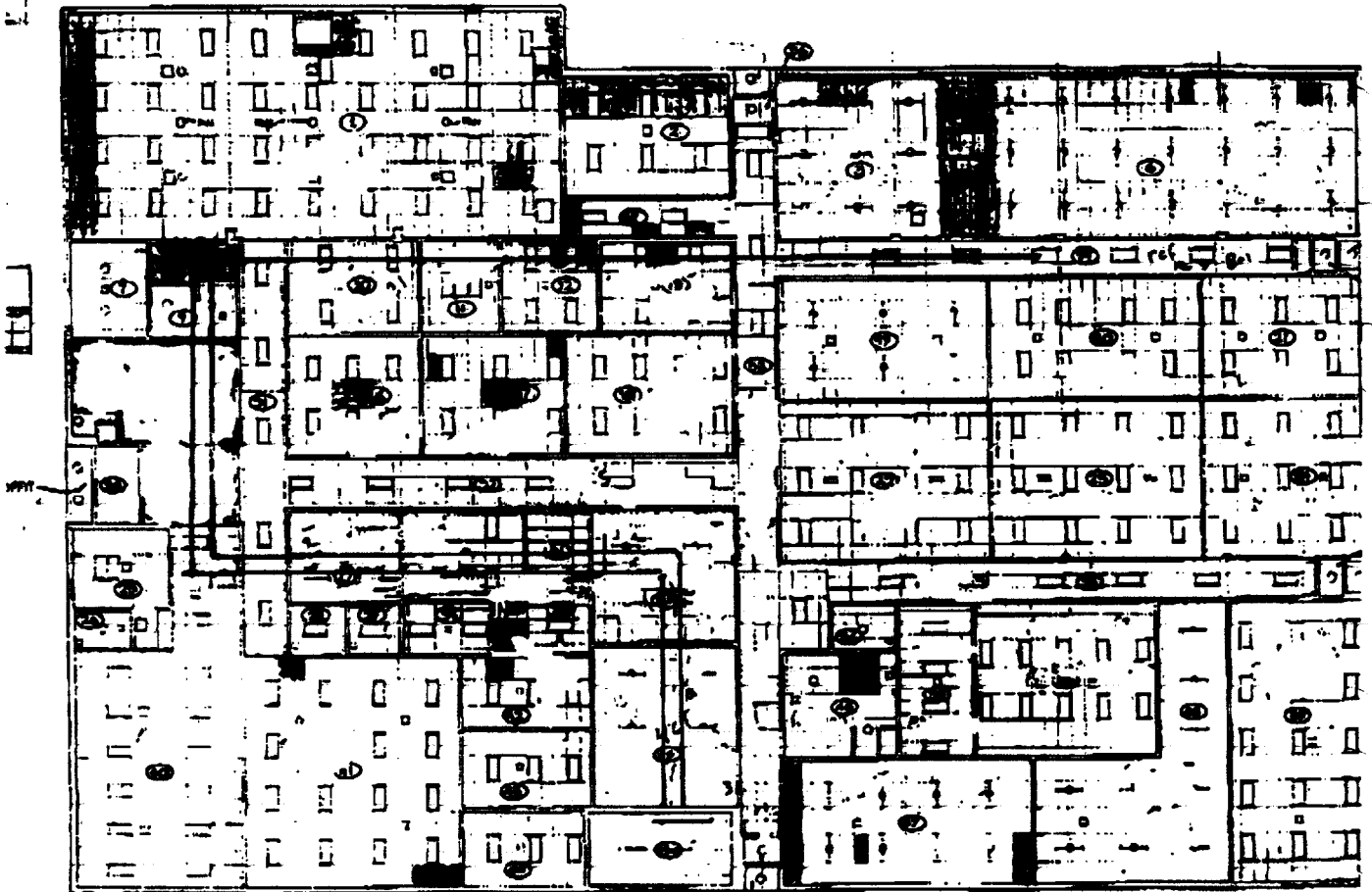

NAVY RESERVE BLDG  
PORTLAND, ME.

03-0768

# All Purpose Building Permit Application for Demolition

If you or the property owner owes real estate or personal property taxes or user charges on any property within the City, payment arrangements must be made before permits of any kind are accepted.

Location/Address of Construction: 350 COMMERCIAL STREET

Total Square Footage of Proposed Structure \_\_\_\_\_ Square Footage of Lot: 7.816 ACRES  
+- 340,470 S.F.

Tax Assessor's Chart, Block & Lot  
Chart# 42 Block# C Lot# 1 Owner: GULF OF MAINE RESEARCH INCORPORATE Telephone: 207-712-2321

Lessee/Buyer's Name (if Applicable) \_\_\_\_\_ Applicant name, address & telephone: Cuellet Assoc., Inc.  
56 Bibber Parkway  
Brunswick, Maine 04011 Cost Of Work: \$ 59,950.-  
Fee: \$ 449.65

Current use: NAVAL RESERVE TRAINING CENTER 207-725-6100  
If the location is currently vacant, what was prior use: \_\_\_\_\_  
Approximately how long has it been vacant: \_\_\_\_\_  
Project description: Removal of existing bldg. to prepare for the Gulf of Maine Research Laboratory  
**DEMOLITION CALL LIST MUST BE SUBMITTED WITH THIS APPLICATION**

PT 443.00  
Pd 449.65

Contractor's name, address & telephone: \_\_\_\_\_  
Who should we contact when the permit is ready: DAVID LAHROVE  
Mailing address: CUELLET ASSOCIATES, INC.  
56 BIBBER PARKWAY  
BRUNSWICK, ME 04011 Phone: 207-725-6100

Acad

**IF THE REQUIRED INFORMATION IS NOT INCLUDED IN THE SUBMISSIONS THE PERMIT WILL BE AUTOMATICALLY DENIED AT THE DISCRETION OF THE BUILDING/PLANNING DEPARTMENT, WE MAY REQUIRE ADDITIONAL INFORMATION IN ORDER TO APPROVE THIS PERMIT.**

I hereby certify that I am the Owner of record of the named property, or that the owner of record authorizes the proposed work and that I have been authorized by the owner to make this application as his/her authorized agent. I agree to conform to all applicable laws of this jurisdiction. In addition, if a permit for work described in this application is issued, I certify that the Code Officer's authorized representative shall have the authority to enter all areas covered by this permit at any reasonable hour to enforce the provisions of the codes applicable to this permit.

Signature of applicant: [Signature] Date: 6/24/02

This is not a permit. you may not commence ANY work until the permit is issued. This is for residential demolition. Commercial demolition will require other types of permitting along with this permit. please inquire with support staff



### CITY OF PORTLAND

The Demolition Call List must be submitted with a Building Permit Application

Property location: 350 COMMERCIAL ST. Chart/Block/Lot 42/C/1

The call list below must be submitted with the building permit application. Please note any "commercial use" demolition will need additional approvals.

When making the submission please include a plot plan showing the location of the structure that is being removed along with a photograph. You may not remove or disconnect any type of lines (private or public) until you have received an *approved building permit*. If the building does not have one of the below utilities please put "does not apply". All Departments in bold must be notified under all circumstances.

#### City Approvals

<u>Department</u>	<u>Number</u>	<u>Contact</u>	<u>Date/Who you spoke with</u>
Public Works Sewer	874-8833	Todd Merkel	<u>JUNE 9, 2003; Todd Merkel</u>
Public Works Traffic (if structure is being moved to another location)	874-8437	Gary Dobson	<u>does not apply</u>
Public Works Sealed Drain Permit	874-8822	Carol Merritt	<u>JUNE 9, 2003; Todd Merkel</u>
Historical Preservation	874-8726	Deb Andrews (PLANNING)	<u>JUNE 7, 2003; Deb Andrews</u>
Fire Dispatch	874-8576	Dispatcher on Duty	<u>JUNE 7, 2003; BRAD Williams</u>

#### Utility Approvals

Dig Safe (must receive 72 hours notice before digging can begin)	1-888-344-7233	Customer Service	<u>JUNE 12, 2003, <sup>ticket # 20032408955</sup> BOSTON</u>
Asbestos	1-207-287-2651	Ed Antz (Maine DEP)	<u>JUNE 7, 2003; Ed Antz</u>

I have contacted all the necessary companies and departments as indicated above.  
Signature: [Signature] Date: 6/9/03

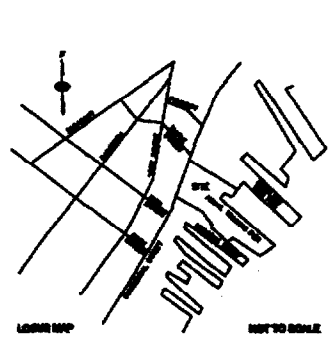
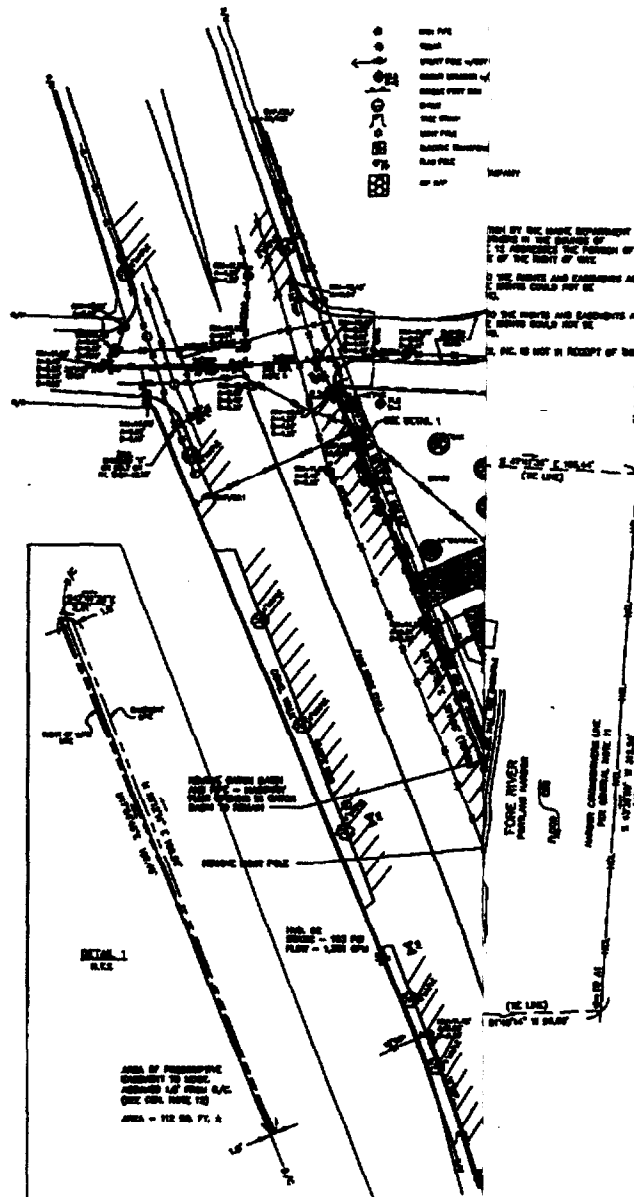

**GENERAL NOTE**

1. ALL DIMENSIONS ARE TO FACE UNLESS OTHERWISE NOTED.

2. ALL WALLS ARE TO BE CONCRETE UNLESS OTHERWISE NOTED.

3. ALL WINDOWS AND DOORS ARE TO BE ALUMINUM UNLESS OTHERWISE NOTED.

4. ALL ROOFING IS TO BE AS SHOWN UNLESS OTHERWISE NOTED.

5. ALL UTILITIES ARE TO BE AS SHOWN UNLESS OTHERWISE NOTED.

6. ALL EXISTING UTILITIES ARE TO BE MAINTAINED UNLESS OTHERWISE NOTED.

7. ALL EXISTING UTILITIES ARE TO BE MAINTAINED UNLESS OTHERWISE NOTED.

8. ALL EXISTING UTILITIES ARE TO BE MAINTAINED UNLESS OTHERWISE NOTED.

9. ALL EXISTING UTILITIES ARE TO BE MAINTAINED UNLESS OTHERWISE NOTED.

10. ALL EXISTING UTILITIES ARE TO BE MAINTAINED UNLESS OTHERWISE NOTED.

2	DESIGN DEVELOPMENT SUBMISSION	6.13.03
1	SECOND SUBMISSION TO CITY	6.10.03
REV.	DESCRIPTION	DATE

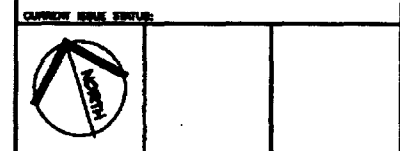

**DALLUCA-HOFFMAN ASSOCIATES, INC.**  
 ARCHITECTS  
 1000 BROADWAY  
 PORTLAND, MAINE 04101  
 WWW.DALLUCAHOFFMAN.COM

**SMRT**  
 ARCHITECTURAL ENGINEERING PLANNING  
 1000 BROADWAY  
 PORTLAND, MAINE 04101  
 TEL: (207) 763-8000  
 FAX: (207) 763-8000

**THE GULF OF MAINE RESEARCH INSTITUTE**  
 PORTLAND, MAINE

**EXISTING CONDITIONS AND DEMOLITION PLAN**

SHEET TITLE:	1" = 40'	DATE:
PROJECT NUMBER:	RAI	GRAPHIC SCALE:
JOB CHG/OWNER:	CHW	SHEET No.:
A/E OF RECORD:	DH	CS101
DATE AND FILE:	CS101-0004	PROJECT No.:
PROJECT No.:	0004-00/1004.1	

**A1** EXISTING CONDITIONS AND DEMOLITION

1" = 40'

CONTRACTOR'S NAME



**OUELLET ASSOCIATES INC.**  
General Contractors & Professional Managers of Construction

*Partnership in Construction*

- Fax
- Date June 18, 2003
- Project: Gulf of Maine Research Institute – Research Laboratory  
350 Commercial Street, Portland, Maine
- Subject: Photos of Existing Building

