

**TYPICAL ELEVATIONS**

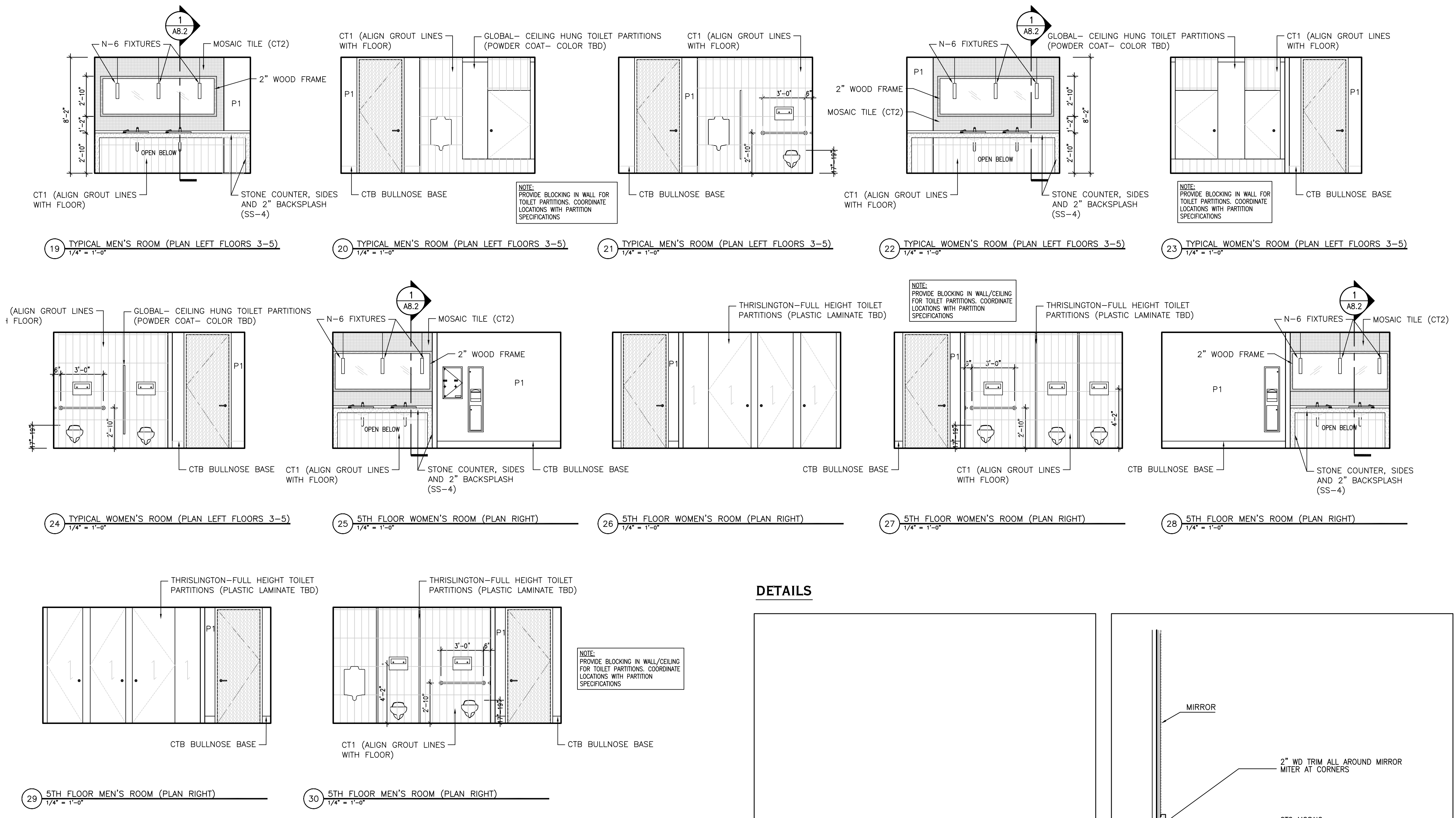

**DETAILS**

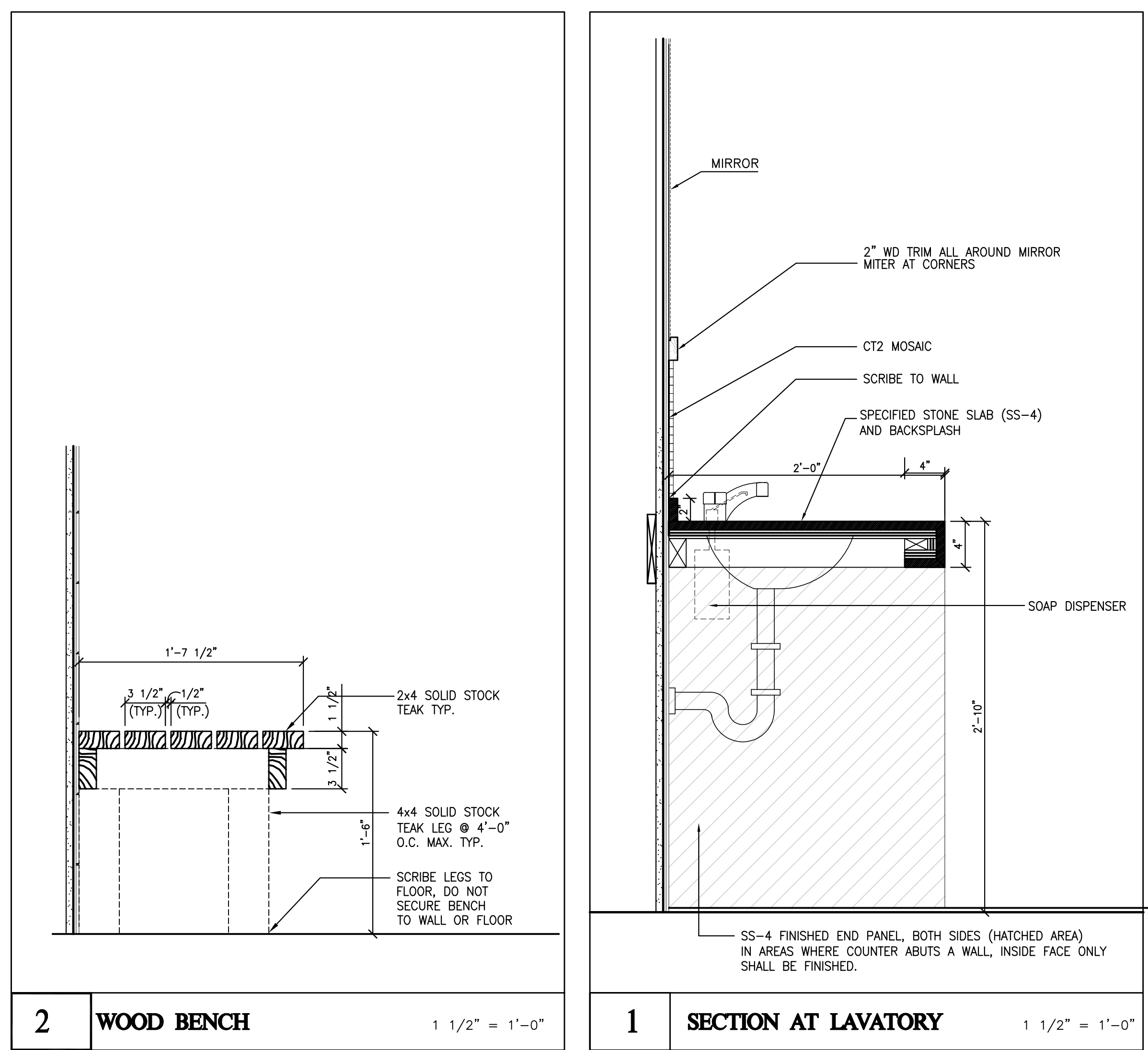

**FINISH SPECIFICATIONS**

**FLOOR FINISH**

CT MANUFACTURER: CREATIVE MATERIALS/ BRUSH STROKE  
STYLE: BEIGE STROKE  
COLOR: SSS7  
SIZE: 12"x24"  
NOTES: ALL RESTROOMS, SEE ELEVATIONS FOR LOCATIONS

**WALL FINISH**

PT1 MANUFACTURER: BENJAMIN MOORE  
NUMBER: NAVAJO WHITE - OC-33  
NOTES: GENERAL PAINT

CT1 MANUFACTURER: CREATIVE MATERIALS/BRUSH STROKE  
STYLE: BEIGE STROKE  
COLOR: SSS7  
SIZE: 6"x24"  
NOTES: ALL RESTROOMS, SEE ELEVATIONS FOR LOCATIONS

CT2 MANUFACTURER: OCEANSIDE GLASS TILE  
STYLE: TESSERA FIELD  
COLOR: COPPERTONE BLEND (#06,#08,#957)  
NOTES: ALL RESTROOMS, SEE ELEVATIONS FOR LOCATIONS

**WALL BASE FINISH**

CTB 6X24" BULLNOSE WALL BASE  
MANUFACTURER: CREATIVE MATERIALS/ BRUSH STROKE  
STYLE: BEIGE STROKE  
COLOR: SSS7  
SIZE: 6"x24"  
NOTES: ALL RESTROOMS

**MILLWORK FINISH**

SS-4 MANUFACTURER: CELADOR  
COLOR: #101/ WHITE POLISHED FINISH  
NOTES: BATHROOM COUNTERS

**ACCESSORIES SPECIFICATIONS**

TA-1 SURFACE MOUNTED MULTI-ROLL TOILET TISSUE DISPENSER.  
BOBRICK, B-7686

TA-2 SURFACE MOUNTED PAPER TOWEL DISPENSER AND WASTE RECEPTACLE.  
BOBRICK, B-380349

TA-3 LAVATORY-MOUNTED AUTOMATIC SOAP DISPENSER.  
BOBRICK, B-826.18

TA-4 SURFACE MOUNTED SANITARY NAPKIN DISPOSAL  
BOBRICK, B-354

TA-5 SURFACE MOUNTED SANITARY NAPKIN VENDOR.  
BOBRICK, B-280025

TA-6 STAINLESS STEEL GRAB BAR  
BOBRICK, B-68137

TA-7 CEILING HUNG TOILET PARTITIONS  
MANUFACTURER: GLOBAL PARTITIONS  
COLOR: POWDER COAT, COLOR TBD  
NOTES: ALL DOORS SHALL HAVE COAT HOOK.  
LOCATION: ALL RESTROOMS ON FLOORS 2,3 & 4.  
REFER TO ELEVATIONS

TA-8 FULL HEIGHT PLASTIC LAMINATE TOILET PARTITIONS  
MANUFACTURER: AUTOMATION SOLUTIONS INC.  
THRISLINGTON "OASIS FULL HEIGHT"  
COLOR: LAMINART, COLOR TBD  
NOTES: ALL DOORS SHALL HAVE COAT HOOK  
LOCATION: RESTROOMS ON FLOOR 5 ONLY

TA-9 LOCKERS  
MANUFACTURER: AUTOMATION SOLUTIONS, INC  
PROSPECT LAMINATE LOCKERS WITH ALUMINUM BODIES  
COLOR: LAMINART, COLOR TBD  
LOCKS: ALUMINUM HASP AND CLASP

**ARCHITECTURAL NOTES**

- METHOD FOR DIMENSIONING WALLS & OPENINGS: FINISH FACE TO FINISH FACE; UNLESS NOTED OTHERWISE.
- PROVIDE WATER RESISTANT GYP. BD. ON ROOM SIDE FOR TOILET ROOMS
- REFER TO MECHANICAL AND PLUMBING DRAWINGS FOR ADDITIONAL NOTES.
- REFER TO ELECTRICAL DRAWINGS FOR POWER IN THESE ROOMS.
- PROVIDE IN WALL BLOCKING IN ALL RESTROOMS FOR TOILET PARTITIONS. COORDINATE WITH SPECIFICATIONS.

TA-10 ROBE/COAT HOOK  
BOBRICK, B-672

TA-11 ADA UNDERCOUNTER SINK & FAUCET  
SEE ENGINEER'S DRAWING FOR SPECIFICATION

TA-12 WALL HUNG ELONGATED TOILET  
SEE ENGINEER'S DRAWING FOR SPECIFICATION

TA-13 WALL HUNG URINAL  
SEE ENGINEER'S DRAWING FOR SPECIFICATION

TA-14 RECESSED MIRROR.  
SIZE: REFER TO ELEVATIONS  
FRAME: 2" WOOD (CHERRY) FRAME

TA-15 SURFACE MOUNTED SEAT COVER DISPENSER  
BOBRICK, B-221

TA-16 PREFABRICATED SHOWER  
SEE ENGINEER'S DRAWINGS FOR SPECIFICATION

TA-17 FRAMELESS PIVOT CLEAR GLASS SHOWER DOOR  
KÖHLER, K-702013-L-BN

NO.	DATE	REVISION