

FIFTH FLOOR PLAN

1/8" = 1'-0"

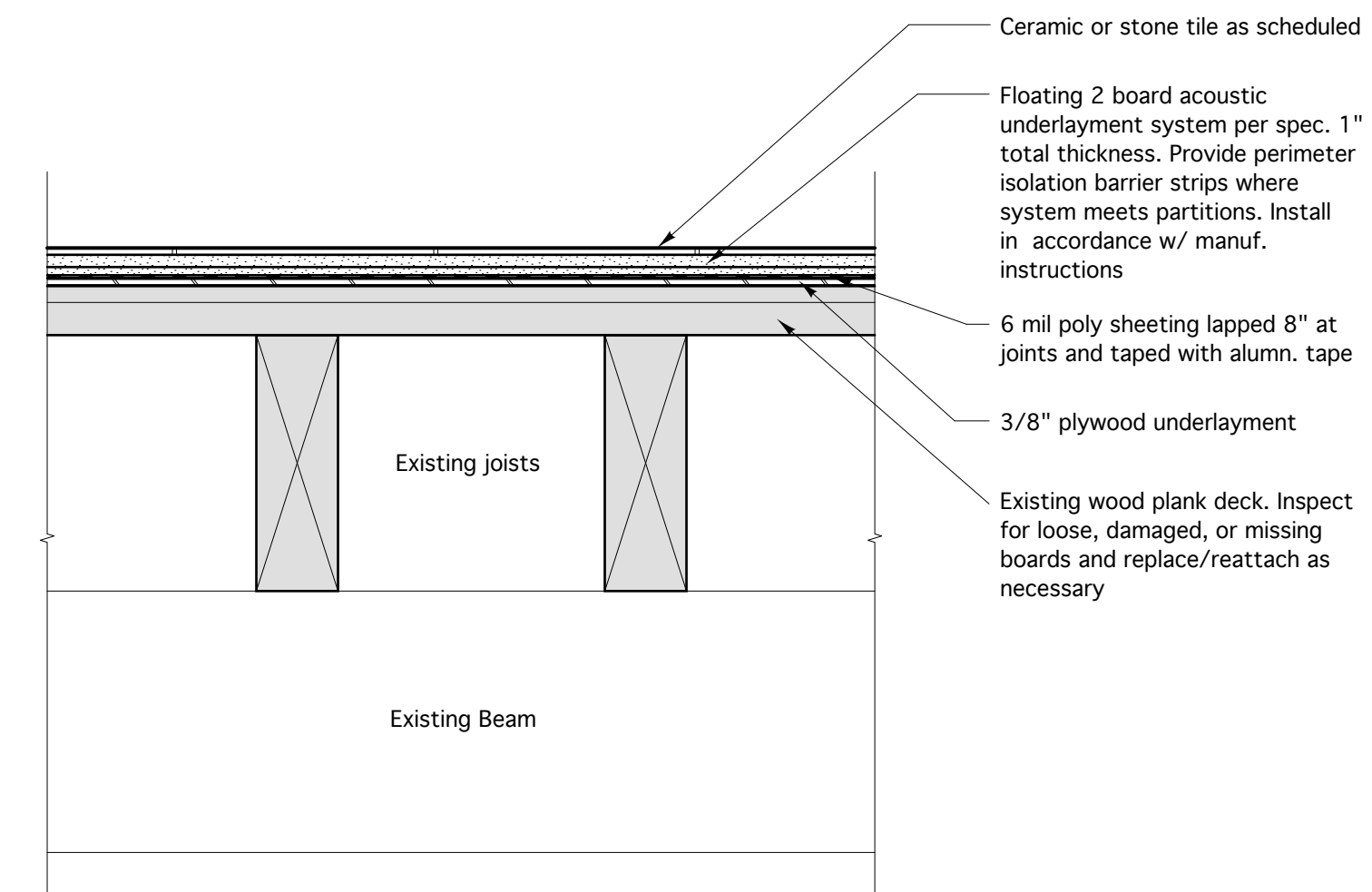

TYPICAL FLOOR UNDERLAYERMENT AT CERAMIC & STONE TILE
Scale: 1 1/2"=1'-0"

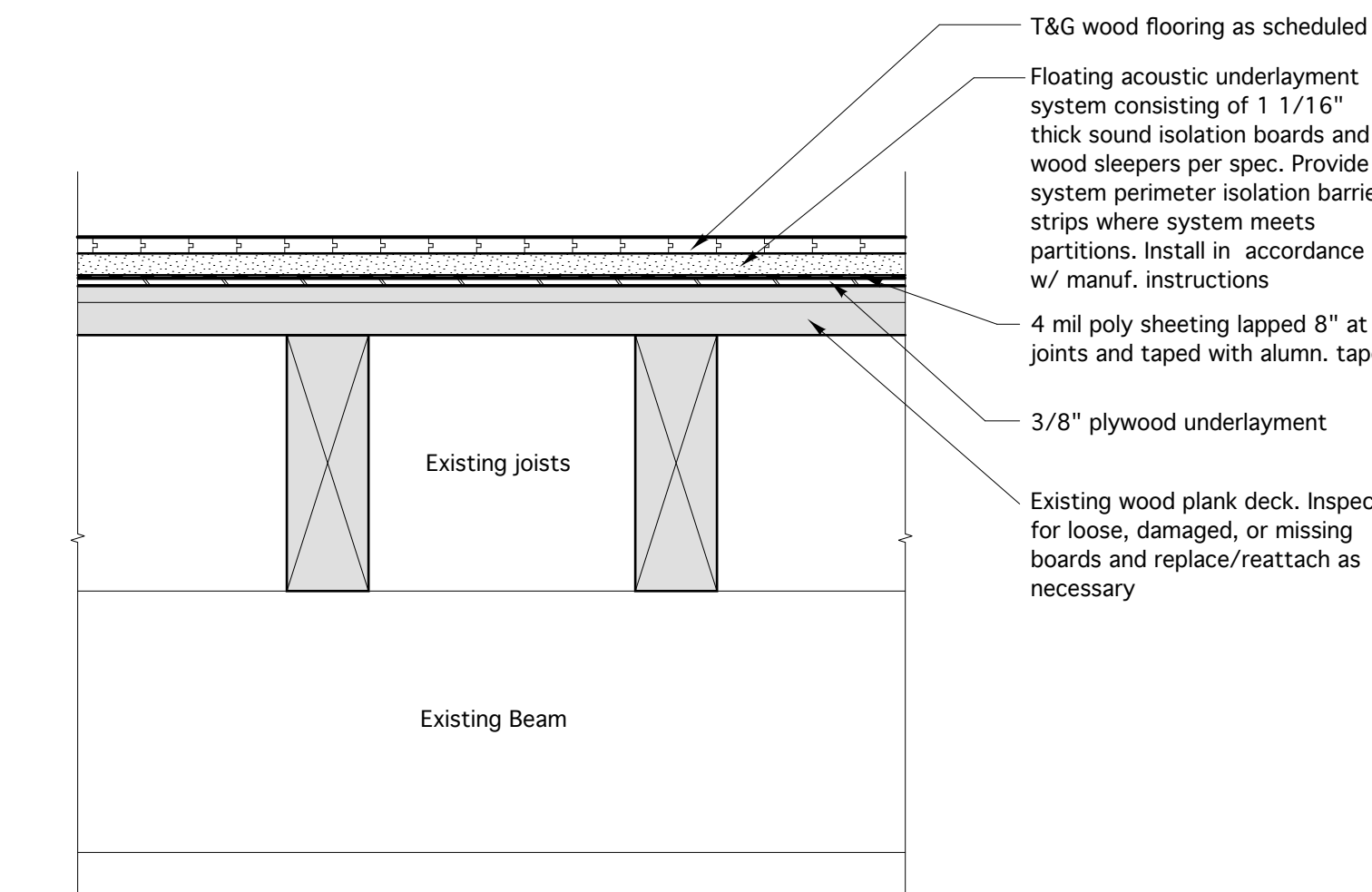

TYPICAL FLOOR UNDERLAYERMENT AT WOOD FLOORING
Scale: 1 1/2"=1'-0"

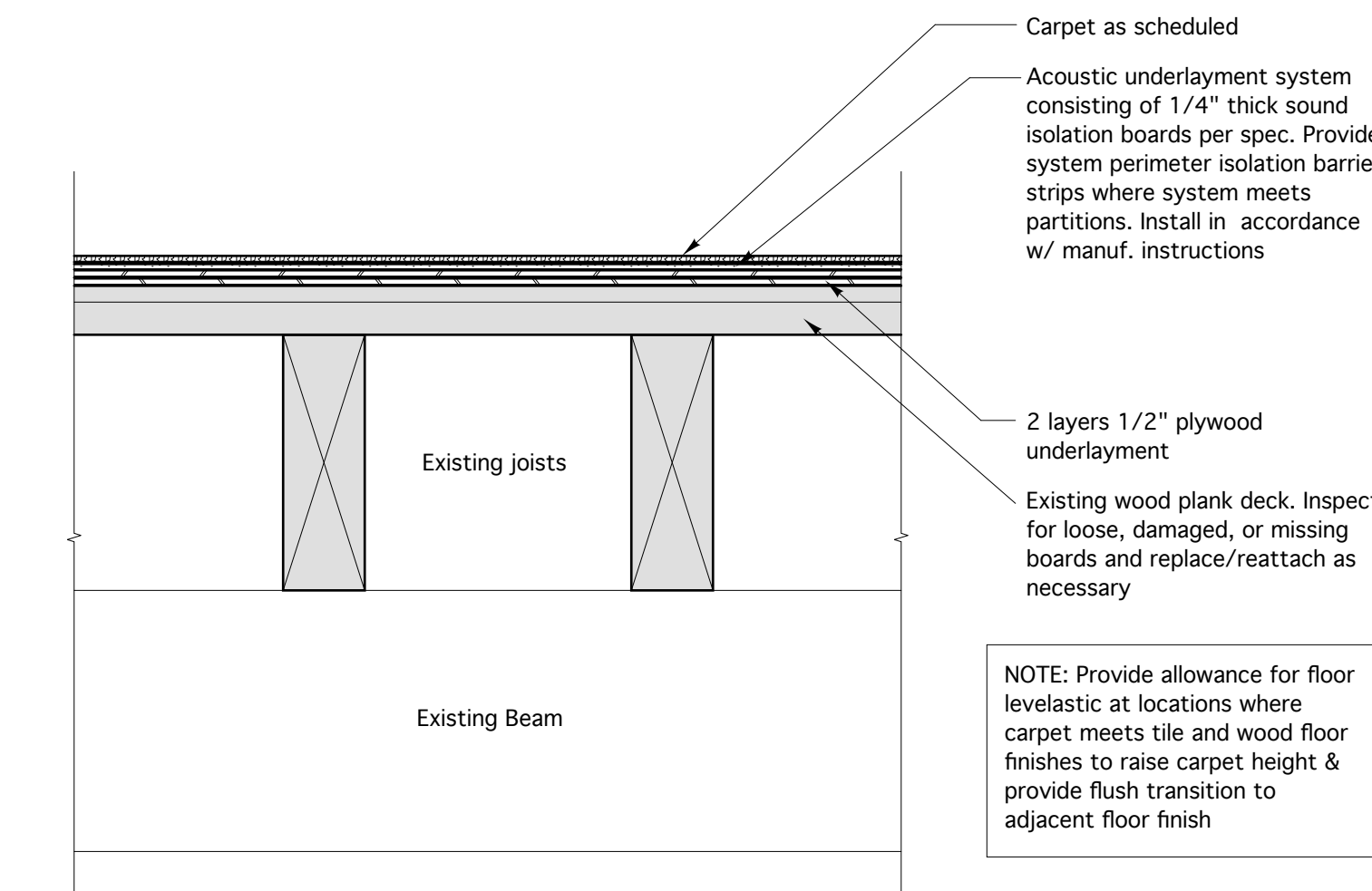

TYPICAL FLOOR UNDERLAYERMENT AT CARPET
Scale: 1 1/2"=1'-0"

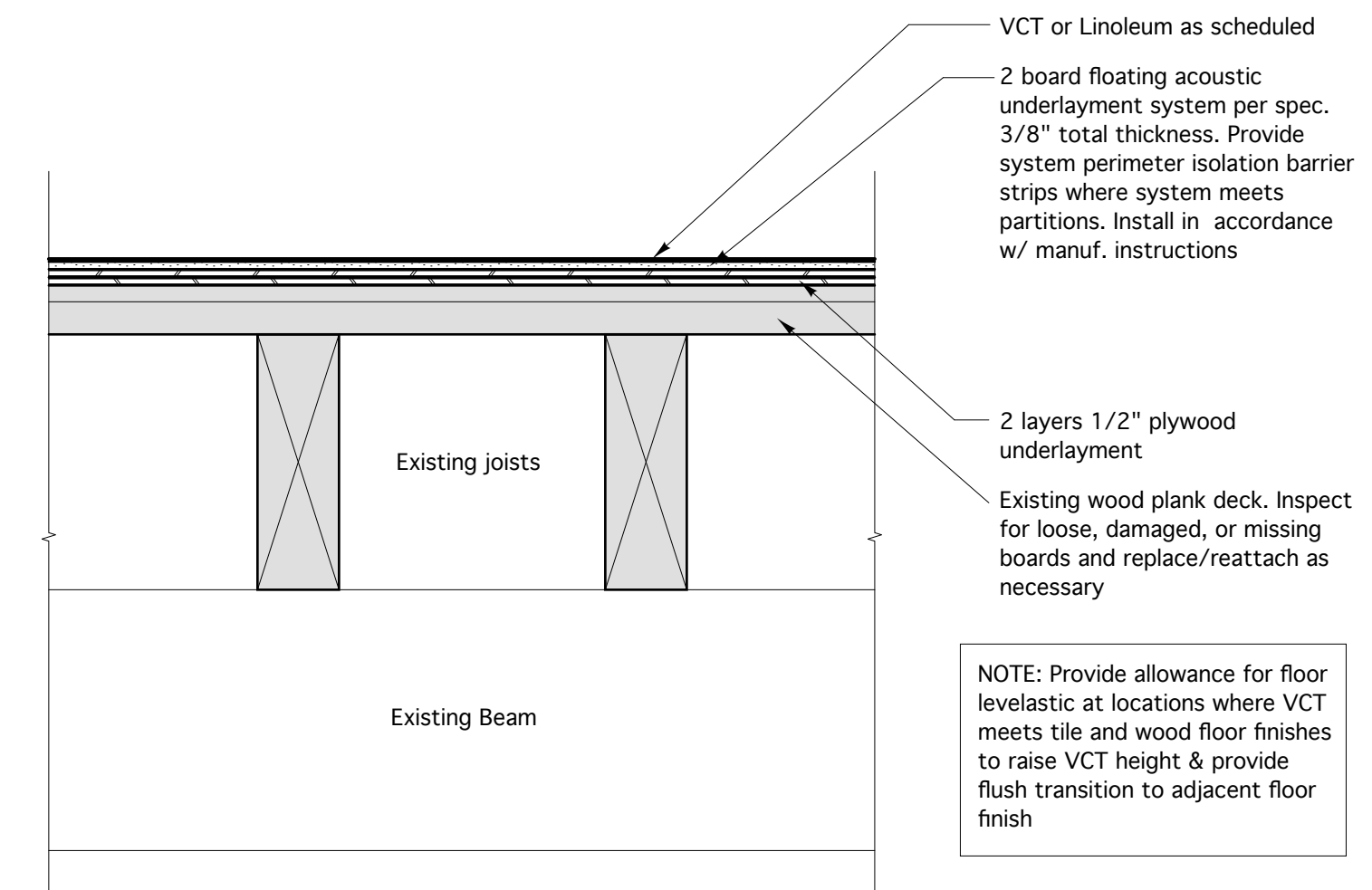

TYPICAL FLOOR UNDERLAYERMENT AT VCT/LINOLEUM
Scale: 1 1/2"=1'-0"

LEGEND

RC 1 Hr.	Room to have 1 hr. rated ceiling: 2 layers of 5/8" Type 'X' GWB attached to underside of existing structure
RC 1 Hr. Batts	Room to have 1 hr. rated ceiling: 2 layers of 5/8" Type 'X' GWB over resilient channels attached to underside of existing structure w/ mineral wool batts between joists.
RC 2 Hr.	Room to have 2 hr. rated ceiling: 2 layers of 5/8" Type 'X' GWB over resilient channels over 1 layer 5/8" Type 'X' attached to underside of exist'g structure or mtl studs as detailed.

==== Rated partition - See partition types on Sht. A6.1 for Rating

GENERAL NOTES

1. All interior brick walls scheduled to remain exposed and all structural framing members including joists, beams, columns, and decking shall be sandblasted and coated with a clear sealer. Typical at all floors except for the 5th floor where sand blasting of all framing elements except columns is not required. No sandblasting work is required at the basement. Samples of blasting and finish will be required for owner review and approval prior to proceeding with work.

PERMIT SET - NOT FOR CONSTRUCTION

Blaise Civil Engineers, PA
780 Broadway
South Portland, ME 04106
T. 207.767.7300
sblaise@blaisece.com

Bartlett Design
942 Washington Street
Bath, ME 04530
T. 207.443.5447 F. 207.443.5560
bartdes@blazenet.net

Mechanical Systems Engineers
Royal River Center, Unit #10
10 Forest Falls Drive, Yarmouth, ME 04096
T. 207.646.1441 F. 207.646.1443

Carroll Associates Landscape Architects
217 Commercial Street, Suite 200
Portland, ME 04101
T. 207.772.1552 F. 207.0712

Becker Structural Engineers, Inc.
75 York Street, Portland, ME 04101
T. 207.879.1838 F. 207.879.1822
www.beckerstructural.com

Winton Scott Architects, PA
5 Milk Street, Portland, ME 04101
207.774.4811 www.wintonscott.com

REV #	DATE	DESCRIPTION

Renovations To:
CUMBERLAND COLD STORAGE BUILDING
Merrill's Wharf, Portland, Maine

FIFTH FLOOR PLAN
A1.5
9.23.2010