

## FOURTH FLOOR PLAN

1/8" = 1'-0"

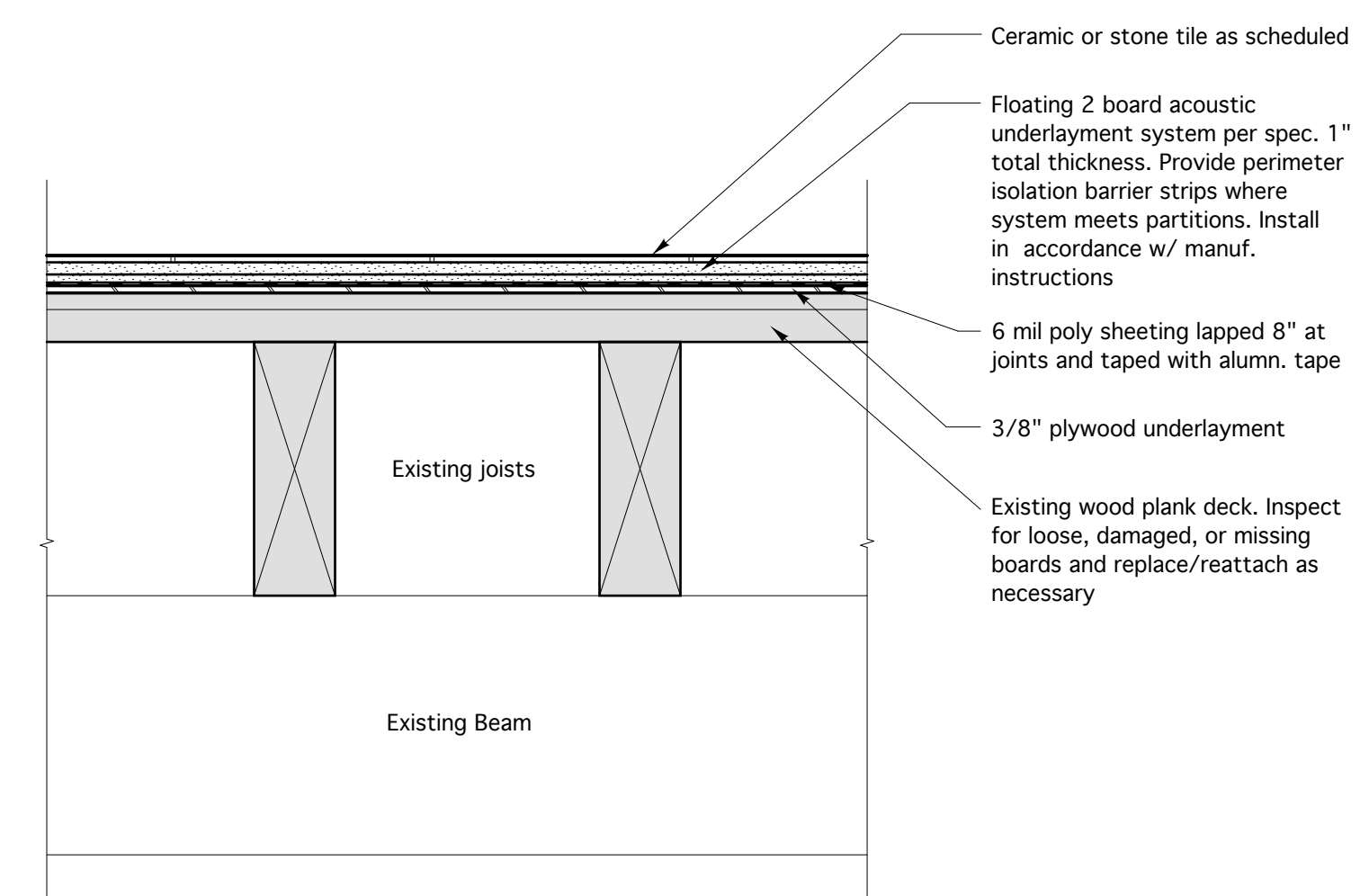

TYPICAL FLOOR UNDERLAYMENT AT CERAMIC & STONE TILE  
Scale: 1 1/2"=1'-0"

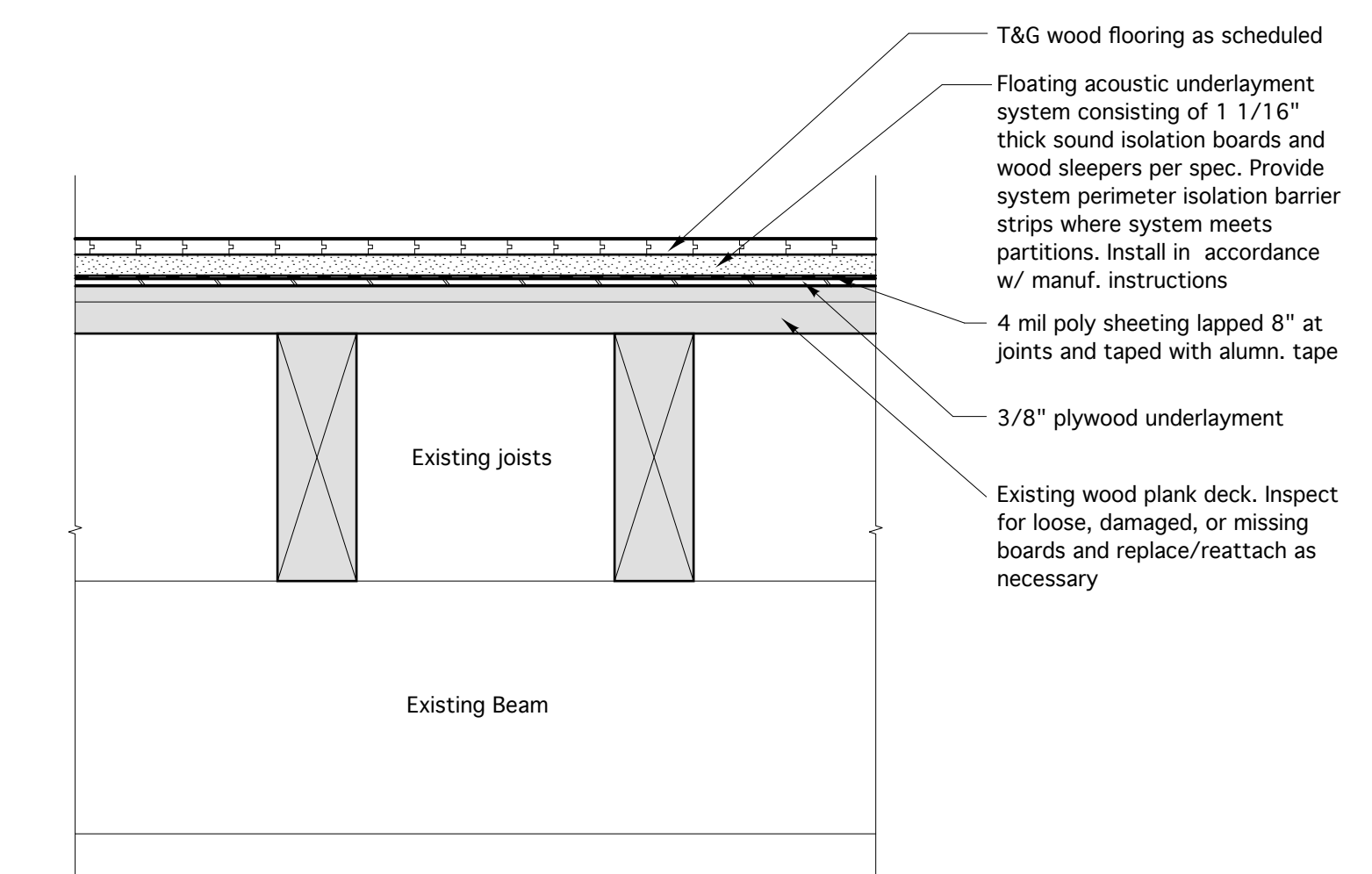

TYPICAL FLOOR UNDERLAYMENT AT WOOD FLOORING  
Scale: 1 1/2"=1'-0"

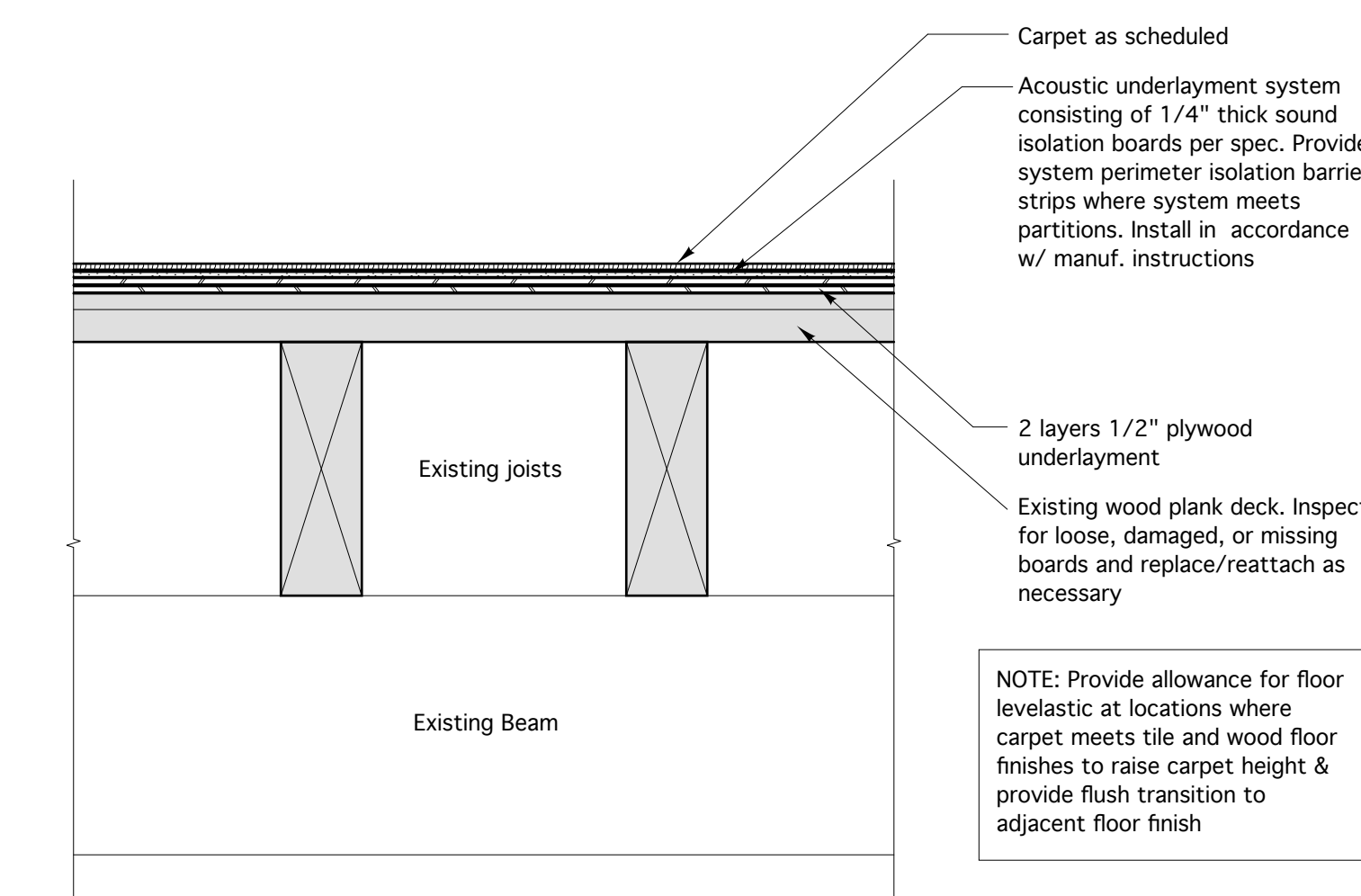

TYPICAL FLOOR UNDERLAYMENT AT CARPET  
Scale: 1 1/2"=1'-0"

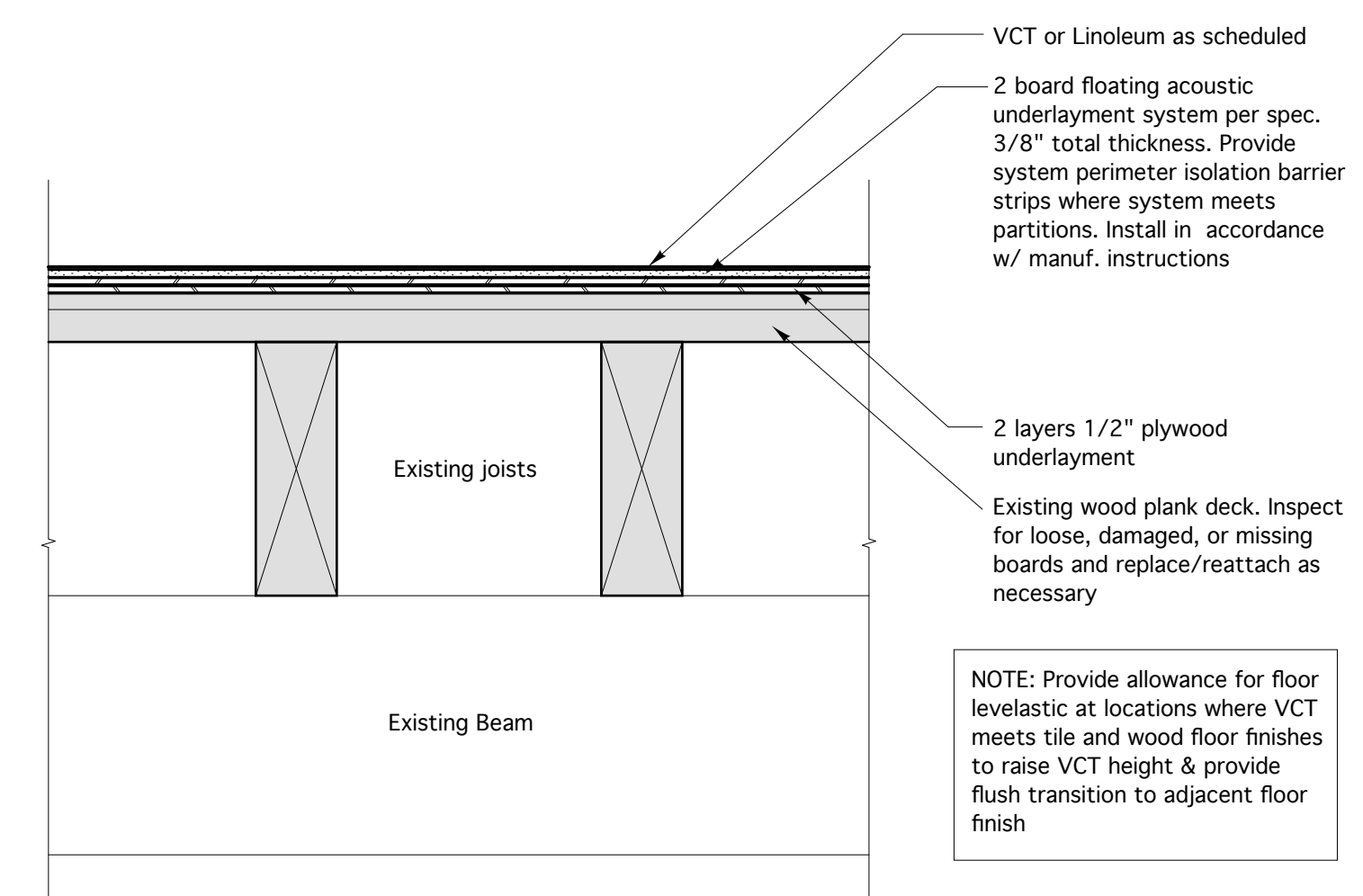

TYPICAL FLOOR UNDERLAYMENT AT VCT/LINOLEUM  
Scale: 1 1/2"=1'-0"

### LEGEND

- RC 1 Hr. Room to have 1 hr. rated ceiling: 2 layers of 5/8" Type 'X' GWB attached to underside of existing structure
- RC 1 Hr. Batts Room to have 1 hr. rated ceiling: 2 layers of 5/8" Type 'X' GWB over resilient channels attached to underside of existing structure w/ mineral wool batts between joists.
- Rated partition - See partition types on Sht. A6.1 for Rating

### GENERAL NOTES

1. All interior brick walls scheduled to remain exposed and all structural framing members including joists, beams, columns, and decking shall be sandblasted and coated with a clear sealer. Typical at all floors except for the 5th floor where sand blasting of all framing elements except columns is not required. No sandblasting work is required at the basement. Samples of blasting and finish will be required for owner review and approval prior to proceeding with work.

PERMIT SET - NOT FOR CONSTRUCTION

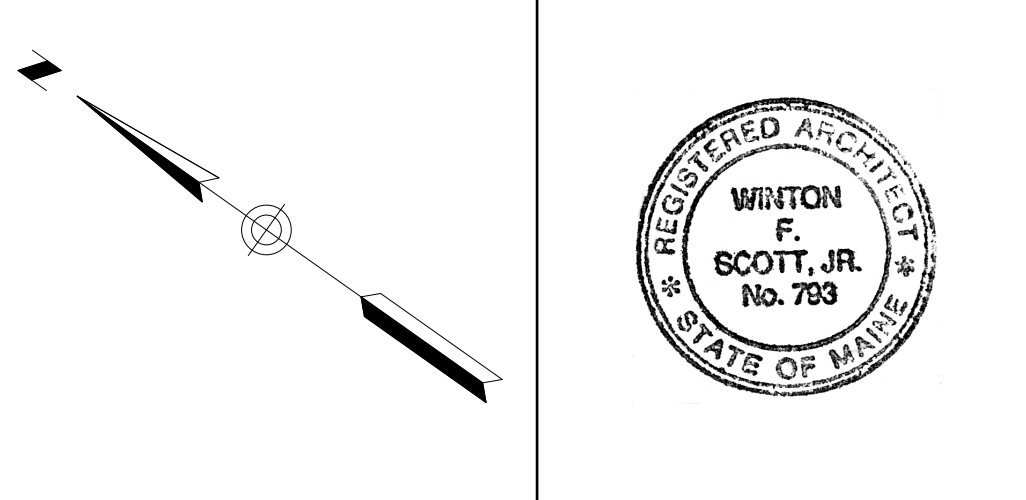

**Blais Civil Engineers, PA**  
780 Broadway  
South Portland, ME 04106  
T. 207.767.7300  
sblaise@blaisece.com

**Bartlett Design**  
942 Washington Street  
Bath, ME 04530  
T. 207.443.5447 F. 207.443.5560  
bartdes@blazenet.net

**Mechanical Systems Engineers**  
Royal River Center, Unit #10  
10 Forest Falls Drive, Yarmouth, ME 04096  
T. 207.846.1441 F. 207.846.1443

**Carroll Associates Landscape Architects**  
217 Commercial Street, Suite 200  
Portland, ME 04101  
T. 207.772.1552 F. 207.0712

**Becker Structural Engineers, Inc.**  
75 York Street, Portland, ME 04101  
T. 207.879.1838 F. 207.879.1822  
www.beckerstructural.com

**Winton Scott Architects, PA**  
5 Milk Street, Portland, ME 04101  
207.774.4811 www.wintonscott.com

REV #	DATE	DESCRIPTION

Renovations To:  
**CUMBERLAND COLD STORAGE BUILDING**  
Merrill's Wharf, Portland, Maine

FOURTH FLOOR PLAN  
**A1.4**  
8.23.2010