

THIRD FLOOR PLAN

1/8" = 1'-0"

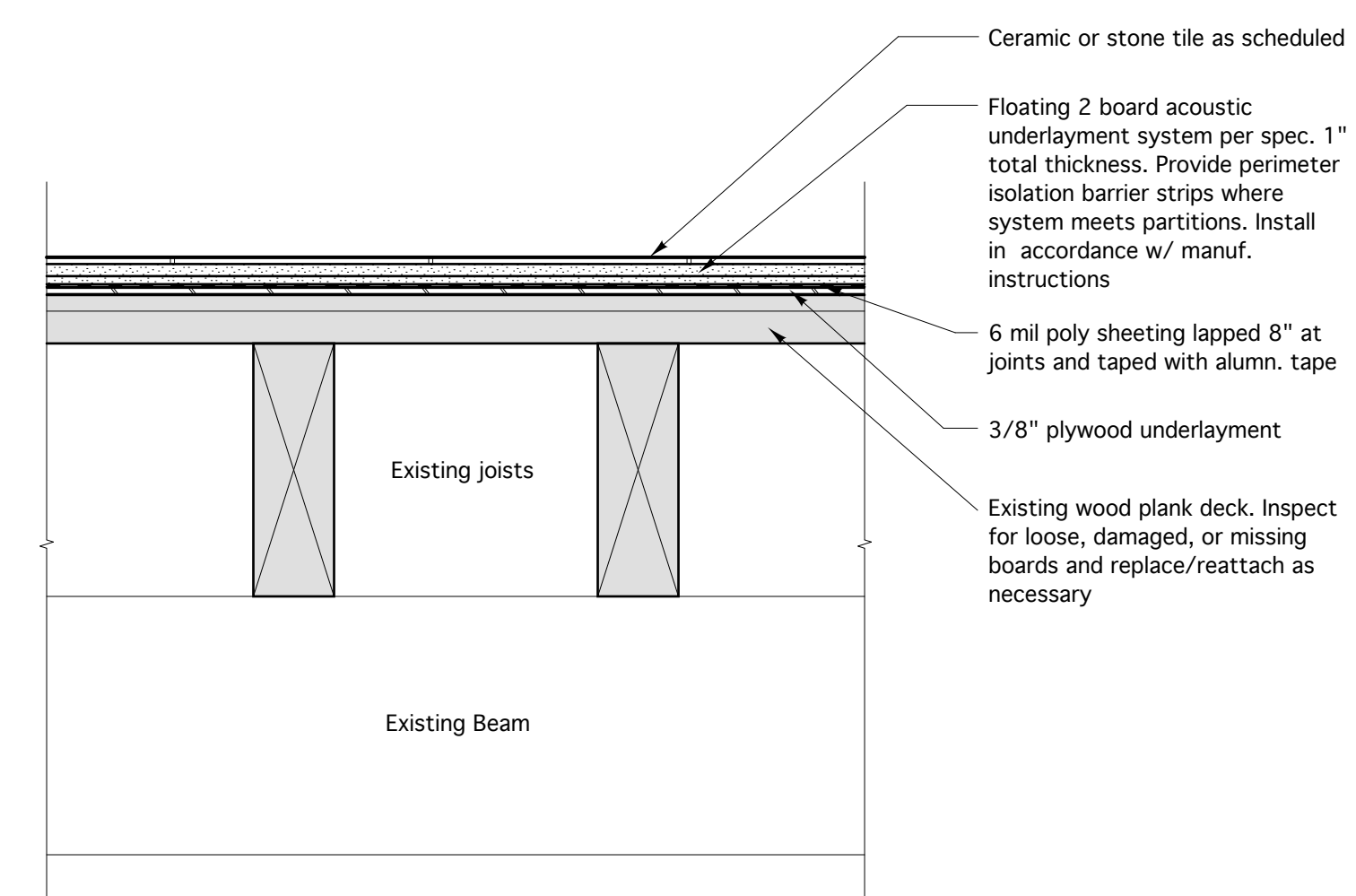

TYPICAL FLOOR UNDERLAYMENT AT CERAMIC & STONE TILE

Scale: 1 1/2"=1'-0"

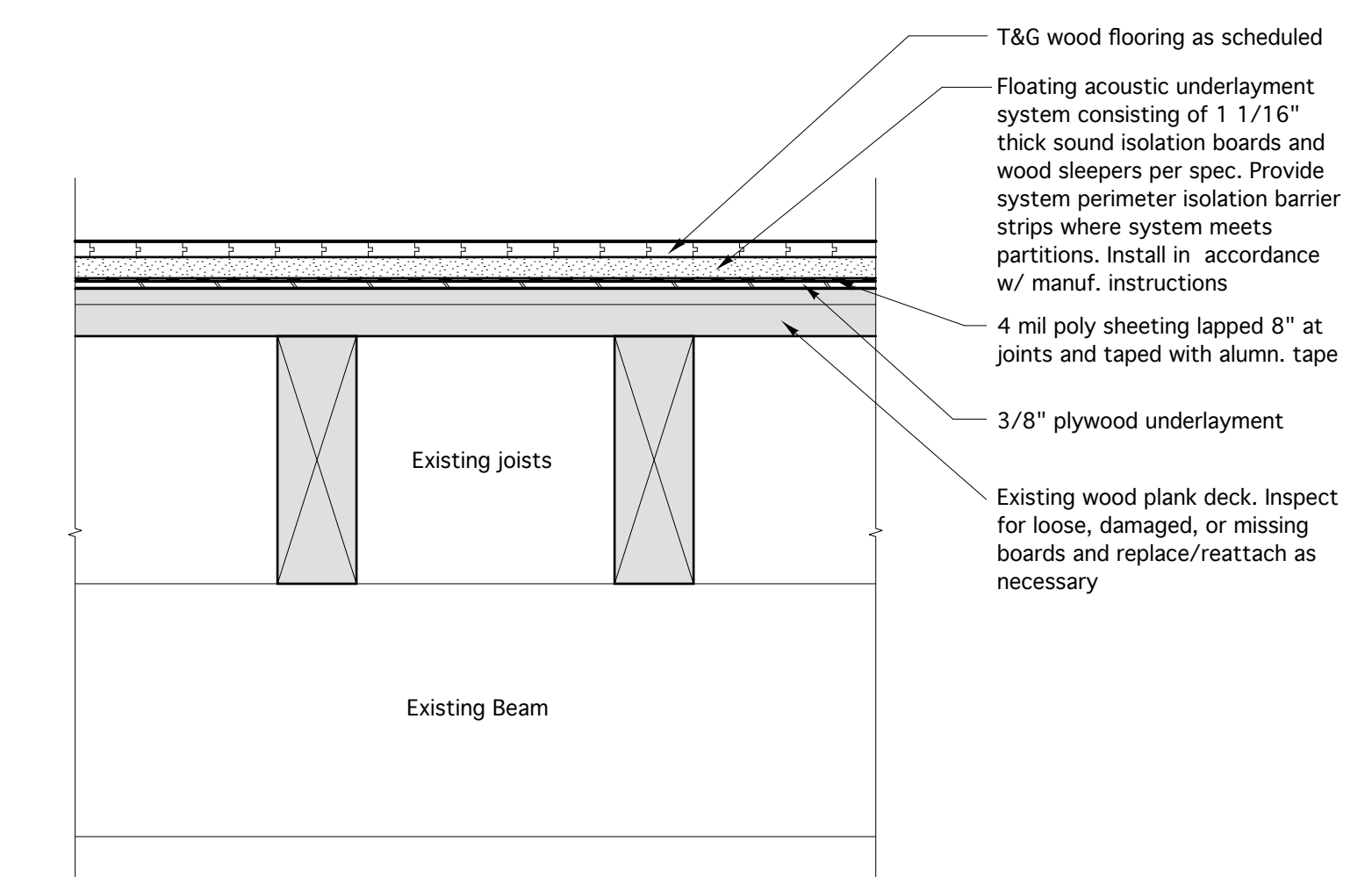

TYPICAL FLOOR UNDERLAYMENT AT WOOD FLOORING

Scale: 1 1/2"=1'-0"

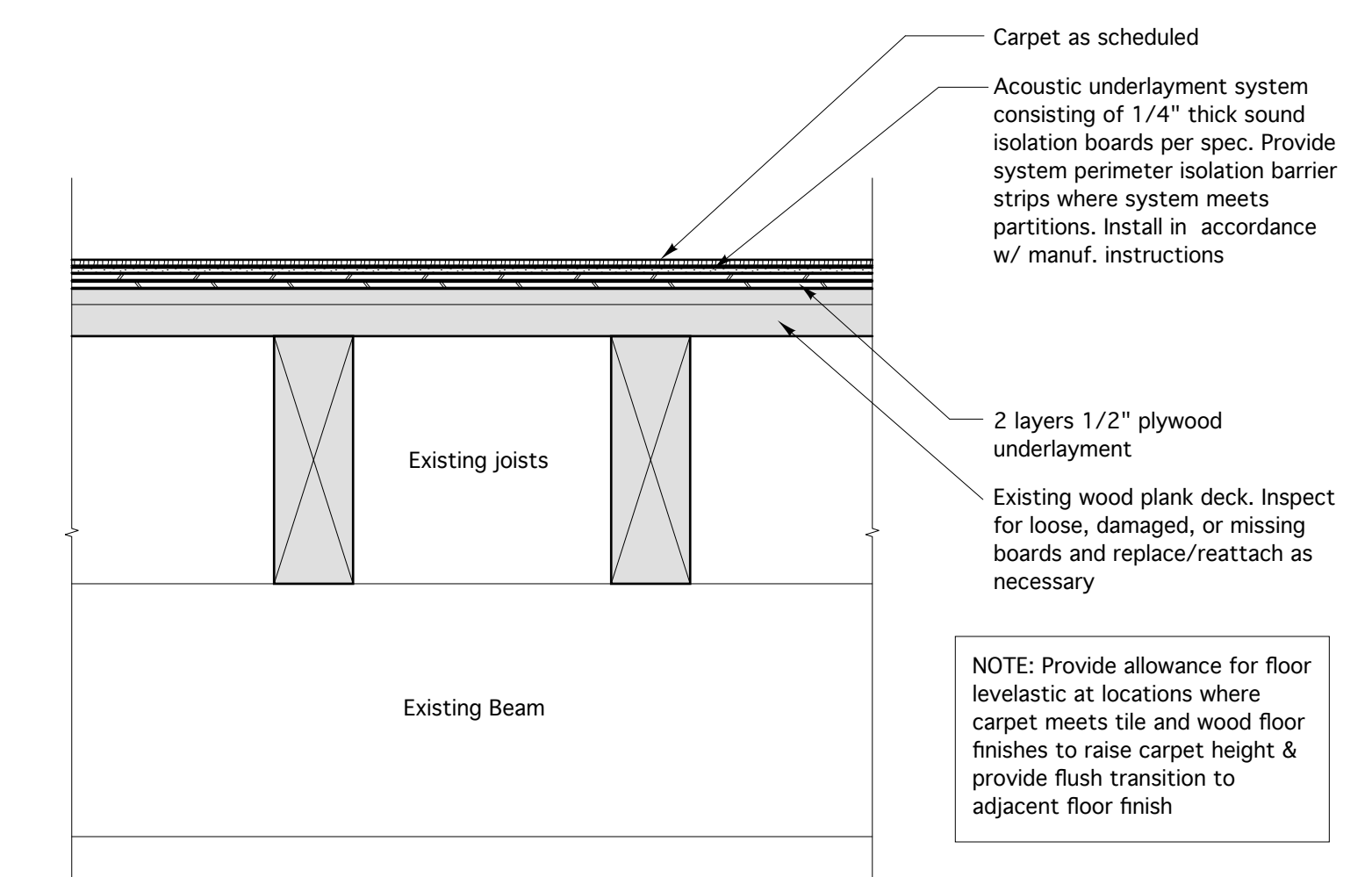

TYPICAL FLOOR UNDERLAYMENT AT CARPET

Scale: 1 1/2"=1'-0"

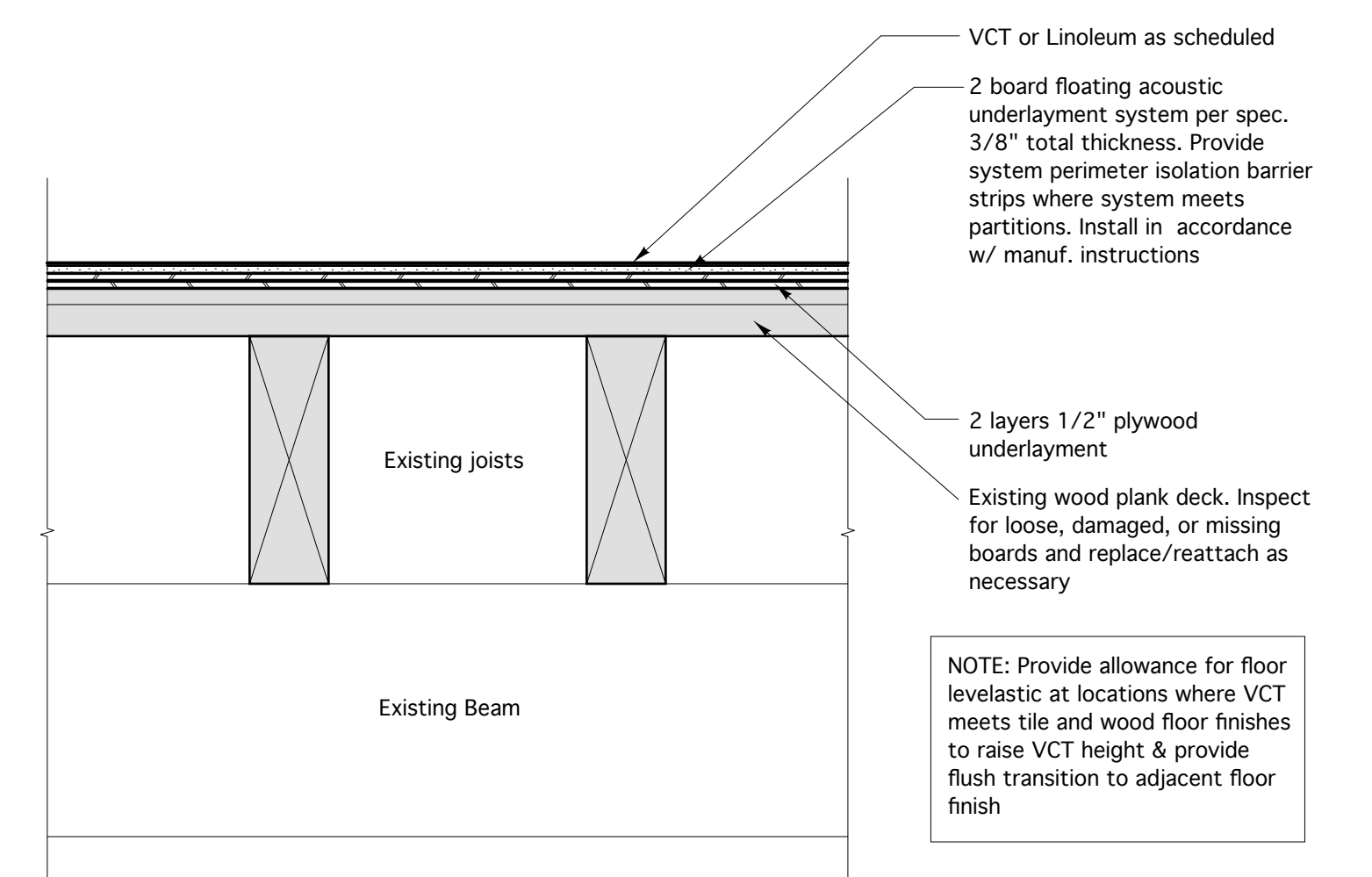

TYPICAL FLOOR UNDERLAYMENT AT VCT/LINOLEUM

Scale: 1 1/2"=1'-0"

LEGEND

- Room to have 1 hr. rated ceiling: 2 layers of 5/8" Type 'X' GWB attached to underside of existing structure
- Room to have 1 hr. rated ceiling: 2 layers of 5/8" Type 'X' GWB over resilient channels attached to underside of existing structure w/ mineral wool batts between joists.
- Rated partition - See partition types on Sht. A6.1 for Rating

GENERAL NOTES

1. All interior brick walls scheduled to remain exposed and all structural framing members including joists, beams, columns, and decking shall be sandblasted and coated with a clear sealer. Typical at all floors except for the 5th floor where sand blasting of all framing elements except columns is not required. No sandblasting work is required at the basement. Samples of blasting and finish will be required for owner review and approval prior to proceeding with work.

PERMIT SET - NOT FOR CONSTRUCTION

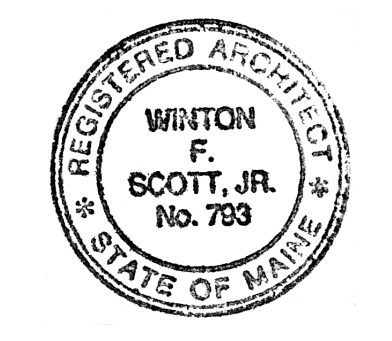

Blais Civil Engineers, PA
 780 Broadway
 South Portland, ME 04106
 T. 207.767.7300
 sblaise@blaisece.com

Bartlett Design
 942 Washington Street
 Bath, ME 04530
 T. 207.443.5447 F. 207.443.5560
 bartdes@blazenet.net

Mechanical Systems Engineers
 Royal River Center, Unit #10
 10 Forest Falls Drive, Yarmouth, ME 04096
 T. 207.846.1441 F. 207.846.1443

Carroll Associates Landscape Architects
 217 Commercial Street, Suite 200
 Portland, ME 04101
 T. 207.772.1552 F. 207.0712

Becker Structural Engineers, Inc.
 75 York Street, Portland, ME 04101
 T. 207.879.1838 F. 207.879.1822
 www.beckerstructural.com

Winton Scott Architects, PA
 5 Milk Street, Portland, ME 04101
 207.774.4811 www.wintonscott.com

REV #	DATE	DESCRIPTION

Renovations To:
CUMBERLAND COLD STORAGE BUILDING
 Merrill's Wharf, Portland, Maine

THIRD FLOOR PLAN

A1.3

8.23.2010