

**FIRST FLOOR KEY PLAN** (Shaded Area = New work to be constructed as part of this project)  
Not To Scale

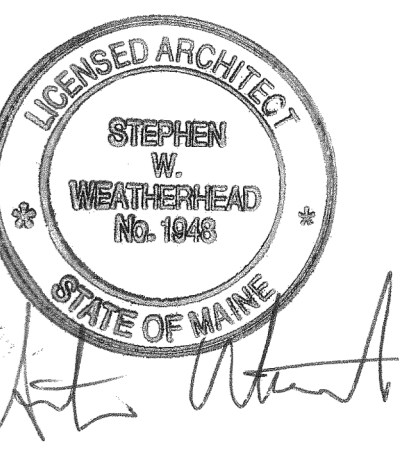

**MERRILL'S WHARF**  
**First & Second Floor Fit Up Project**  
254 Commercial Street, Portland, Maine

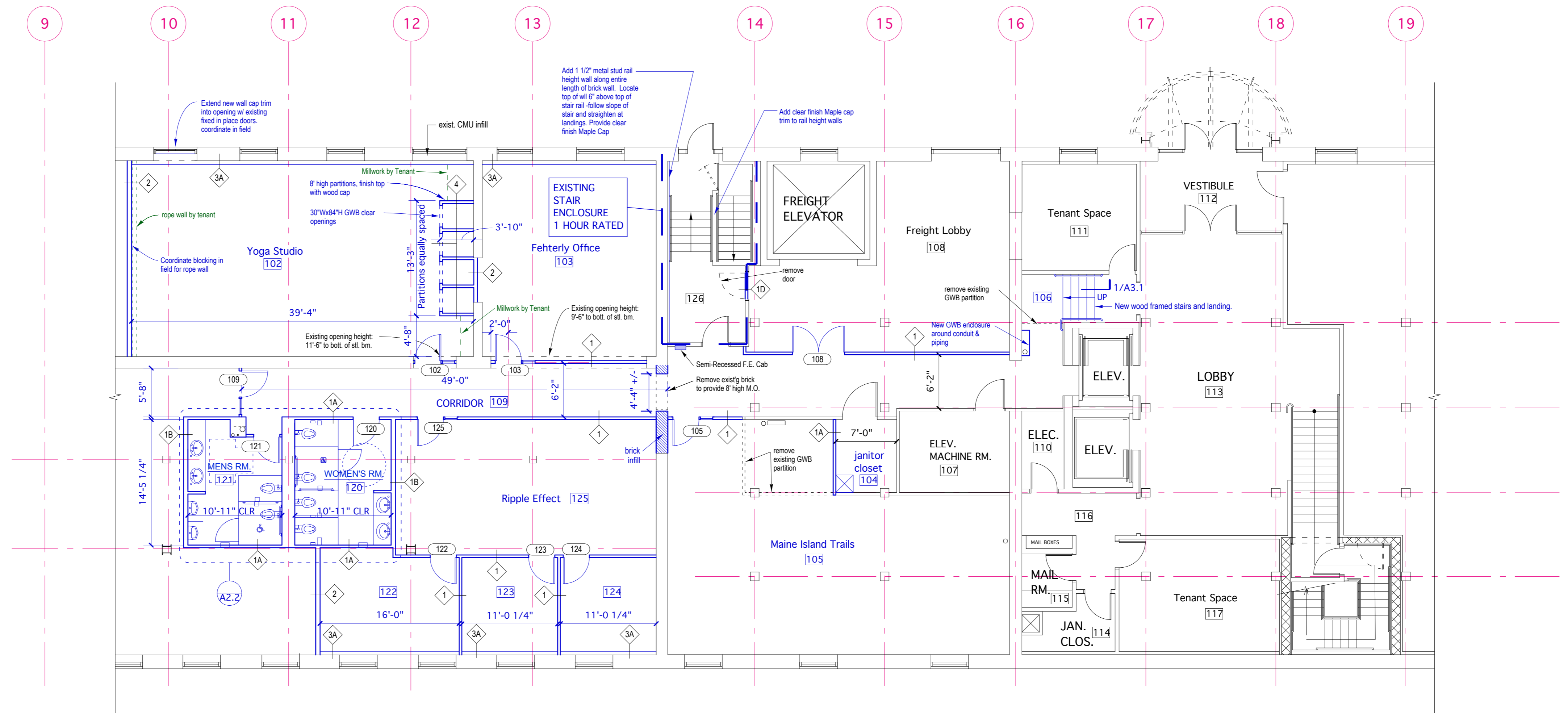

**FIRST FLOOR LAYOUT PLAN**  
1/8" = 1'-0"

Winton Scott Architects  
5 Milk St. Portland, ME 04101  
207.774.6680 | wintonsscott.com

Mechanical Systems Engineers  
Royal River Center #10  
10 Forest Falls Dr., Yarmouth, ME 04096  
207.846.1441 |

Bartlett Design  
942 Washington St., Bath, ME 04530  
207.443.5447 | bartlettdesigninc@comcast.net>

SCALE: AS NOTED

**FIRST FLOOR PLAN**

**A1.1**