

Handwritten: SIGN BOARD

Handwritten: STALLS W/ BAR

Install 5/8" MDF plywood painted dark gray at back side of Door/Window Frame

SEE STRUCTURAL NOTES FOR THIS AREA

New door & frame installed in existing aluminum storefront framing

FLOOR PLAN
1/4"=1'-0"

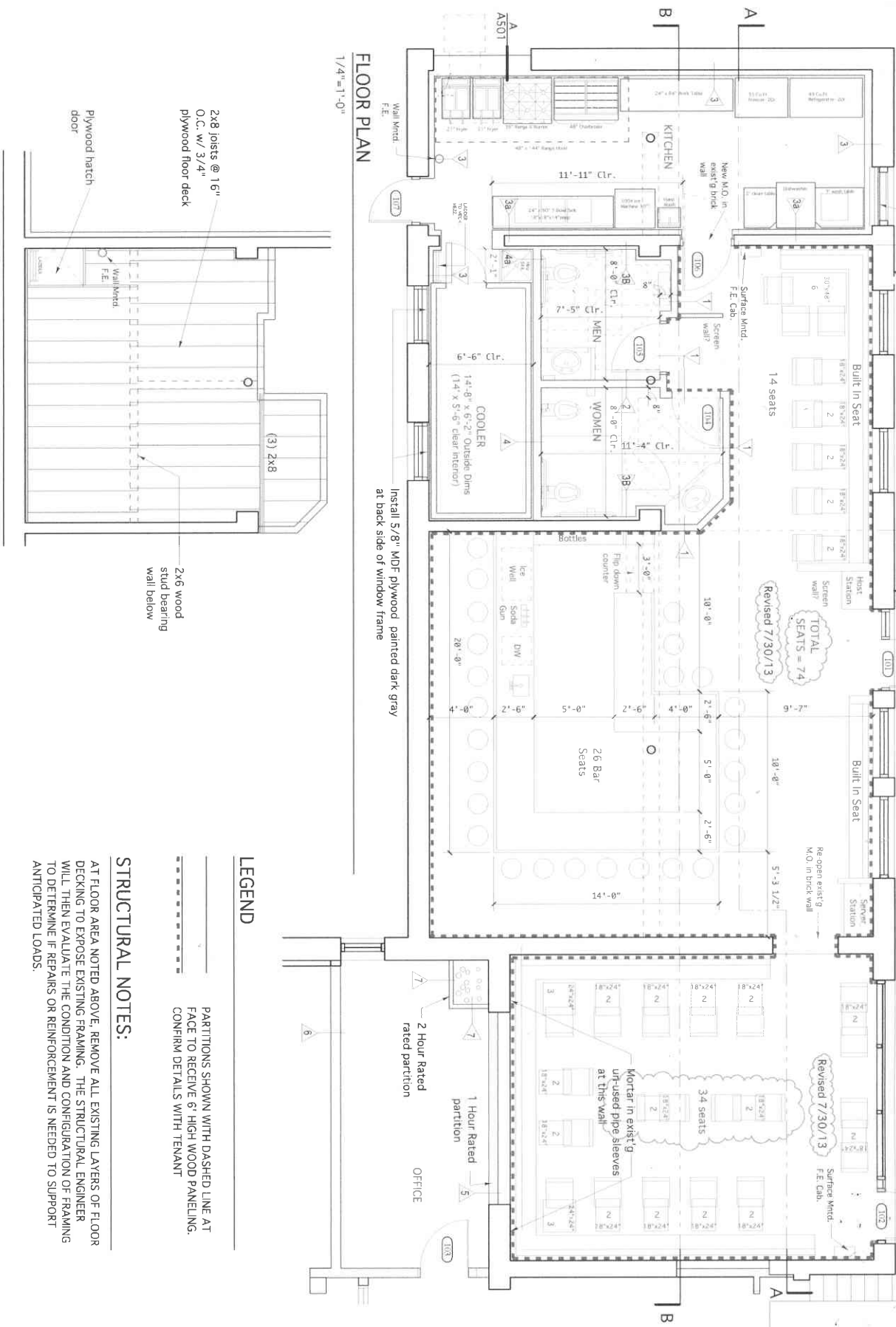

Install 5/8" MDF plywood painted dark gray at back side of window frame

2x8 joists @ 16" O.C. w/ 3/4" plywood floor deck

2x6 wood stud bearing wall below

plywood hatch door

LEGEND

PARTITIONS SHOWN WITH DASHED LINE AT FACE TO RECEIVE 6" HIGH WOOD PANELING. CONFIRM DETAILS WITH TENANT

STRUCTURAL NOTES:

AT FLOOR AREA NOTED ABOVE, REMOVE ALL EXISTING LAYERS OF FLOOR DECKING TO EXPOSE EXISTING FRAMING. THE STRUCTURAL ENGINEER WILL THEN EVALUATE THE CONDITION AND CONFIGURATION OF FRAMING TO DETERMINE IF REPAIRS OR REINFORCEMENT IS NEEDED TO SUPPORT ANTICIPATED LOADS.



WINTON SCOTT ARCHITECTS
5 Main Street
Portland, Maine 04101
207.774.4811
www.wintonscott.com

KING'S HEAD
Tenant Fit Up

Merrill's Wharf
Portland, Maine

REVISIONS
5/9/13
6/8/13

PERMIT DOCUMENTS
JUNE 8 2013
Layout Plan
Scale: As Noted

MECHANICAL MEZZ. PLAN
1/4"=1'-0"

A 101