

PROJECT NOTES:

- INTERLOCK SHUNT TRIP CIRCUIT BREAKERS SERVING CIRCUITS TO ITEMS BELOW RANGE EXHAUST HOOD WITH HOOD FIRE SUPPRESSION SYSTEM TO DEACTIVATE CIRCUITS UPON DISCHARGE OF HOOD SUPPRESSION SYSTEM.
- ALL RECEPTACLES IN KITCHEN SHALL BE GFI RATED PER THE NATIONAL ELECTRICAL CODE.
- INSTALL SEAL-OFF FITTINGS ON CONDUIT PENETRATING THE WALK-IN COOLER.
- PROVIDE CONTROL WIRING BETWEEN THE COOLER EVAPORATOR AND COOLER CONDENSER. COORDINATE WITH EQUIPMENT SUPPLIER.
- MOUNT, WIRE, AND INTER-CONNECT VAPOR-PROOF LIGHTS IN WALK-IN COOLER AND FREEZER. LIGHTS PROVIDED BY THE EQUIPMENT SUPPLIER. CIRCUIT LIGHTS TO KITCHEN LIGHTING CIRCUIT.
- ELECTRICAL CONTRACTOR TO PROVIDE LIGHTING SWITCH FOR KITCHEN HOOD LIGHTS. LOCATE LIGHTING SWITCH ADJACENT TO HOOD EXHAUST SWITCH. VERIFY EXACT LOCATION WITH MECHANICAL CONTRACTOR.
- PROVIDE INSTALLATION AND WIRING OF KITCHEN HOOD COMPONENTS FURNISHED BY THE HOOD SUPPLIER, INCLUDING I/O PROCESSOR, KEYPAD, TEMPERATURE SENSOR, OPTIC SENSOR, VARIABLE FREQUENCY DRIVE, AND HOOD LIGHTS.
- CONNECT KITCHEN HOOD SUPPRESSION SYSTEM WITH FIRE ALARM SYSTEM TO INDICATE AN ALARM CONDITION UPON SUPPRESSION DISCHARGE. CIRCUIT FIRE SUPPRESSION SYSTEM TO KP #16.
- NOT USED.
- EXTEND INCOMING SERVICE FROM UTILITY COMPANY SERVICE METER WITH MAIN CIRCUIT BREAKER UNDER THE FLOOR SLAB. RISE TO PANEL KP LOCATED IN THE MECHANICAL MEZZANINE IN A 2-1/2" CDT.
- VERIFY ALL ELECTRICAL CONNECTIONS AND CIRCUIT REQUIREMENTS WITH KITCHEN EQUIPMENT SUPPLIER PRIOR TO ROUGH-IN.
- EXTEND EXISTING BUILDING FIRE ALARM SYSTEM AS REQUIRED TO ACCOMMODATE DEVICES SHOWN, NEW DEVICES SHALL MATCH EXISTING MANUFACTURER AND TYPE. PROVIDE A FIRE ALARM SYSTEM BOOSTER FOR NEW INDICATING DEVICES. CIRCUIT TO PANEL KP #18.
- CONCEAL WIRING WHERE POSSIBLE. WHERE SURFACE WIRING IS NECESSARY, PROVIDE SURFACE METAL RACEWAY PAINTED TO MATCH THE SURFACE TO WHICH IT IS ATTACHED. ROUTE SURFACE RACEWAY IN STRAIGHT LINES PARALLEL TO WALLS/BEAMS.
- CONNECT EF-1 AND EF-2 (120V, 1PH, 50W) TO ROOM LIGHTING CIRCUIT. FAN TO HAVE INTEGRAL MOTION SENSOR.
- UNLESS SPECIFICALLY NOTED OTHERWISE, 3-PHASE LOADS SHALL BE CIRCUITED WITH 3 #12, 1 #12 GND, IN A 3/4" CDT.

PANEL KP (MECHANICAL MEZZANINE):

- 120/208 VOLT, 3 PHASE, 4 WIRE, 225A, MLO, 72 CIRCUIT BREAKERS
- PROVIDE THE FOLLOWING CIRCUIT BREAKERS:
- 60A/3P SHUNT TRIP - DISHWASHER
 - 20A/1P SHUNT TRIP - GAS EQUIPMENT UNDER RANGE HOOD
 - 45A/3P - CONDENSING UNIT CC-1
 - 20A/3P - COOLER COMPRESSOR SF-1, MAU-1, AH-1
 - 20A/1P - GAS FURNACE, GAS WATER HEATER, MOTOR OPERATED DAMPERS
 - 20A/1P - COOLER, COOLER EVAPORATOR
 - 20A/1P - KITCHEN EQUIPMENT, KITCHEN RECEPTACLES
 - 20A/1P - FIRE SUPPRESSION SYSTEM, F/A BOOSTER
 - 20A/1P - BAR EQUIPMENT
 - 20A/1P - RECEPTACLES
 - 20A/1P - LIGHTING
 - 20A/1P - SPARES

(NOTE 11)
DISHWASHER
BOOSTER HEATER
208V, 3PH

(NOTE 11)
REFRIGERATOR
120V, 1PH, 12A

(NOTE 11)
FREEZER
120V, 1PH, 10A

(NOTE 11)
ICE MACHINE
120V, 1PH, 7.8A

(NOTES 1,11)
GAS CHARBROLIER
120V, 1PH, 10A

(NOTES 1,11)
GAS RANGE
120V, 1PH, 5A

SF-1
208V, 3PH, 1.5HP

(NOTES 1,11)
GAS FRYER
120V, 1PH, 5A

UTILITY CO.
SERVICE METER
WITH MAIN
CIRCUIT BREAKER
(NOTE 10)

3 #8,
1 #10 GND,
1" CDT

CONDENSING UNIT CC-1
208V, 3PHM 34.4MCA

NEW UNDERGROUND
ELECTRICAL SERVICE FROM
EXISTING PAD MOUNTED
SERVICE TRANSFORMER

COOLER (NOTE 11)
120V, 1PH, 4A

COOLER COMPRESSOR (NOTE 11)
208V, 3PH, 9.4A

COOLER EVAPORATOR (NOTE 11)
120V, 1PH, 1.8A

MAKEUP AIR UNIT MAU-1
208V, 3PH, 1-1/2HP

(10) EXISTING
CONDENSING UNITS

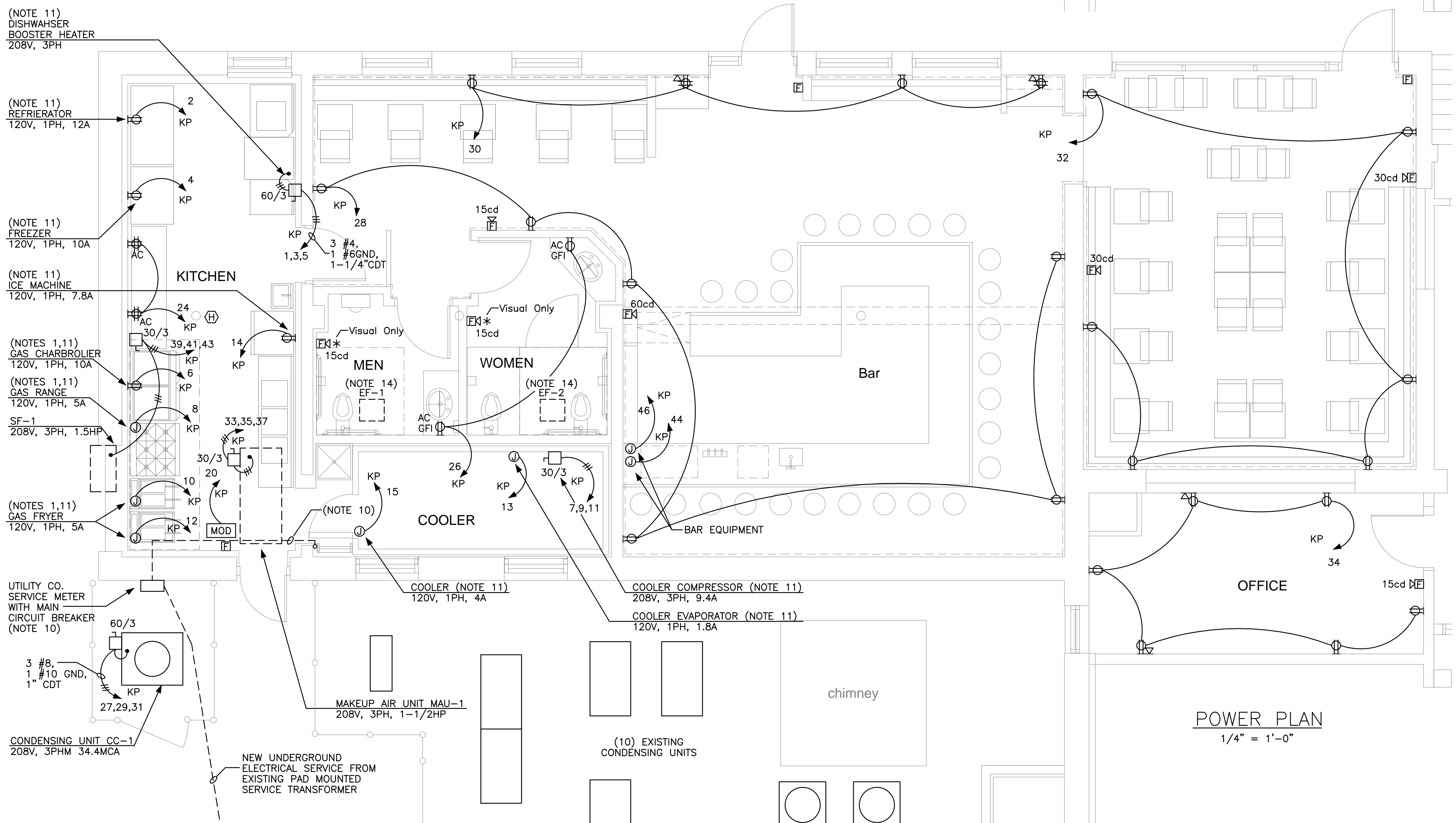

5 Milk Street
Portland, Maine 04101
207 774 4811
www.wintonscott.com

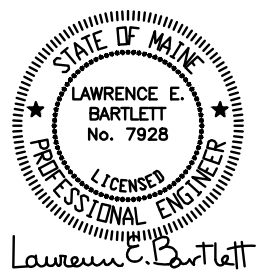

**KING'S HEAD
Tenant Fit Up**

Merrill's Wharf
Portland, Maine

REVISIONS

PERMIT DOCUMETS
June 07, 2013

POWER PLAN
1/4" = 1'-0"

Power Plan
Scale: As Noted