

ISSUE HISTORY

- 1 12/23/14 – ISSUE FOR PRICING
- 2 1/25/16 – ISSUE FOR PERMIT/CONST.

LIST OF DRAWINGS

T001	TITLE SHEET
A001	DEMOLITION PLAN – 1ST FLOOR
A011	RCP DEMOLITION PLAN – 1ST FLOOR
A101	CONSTRUCTION PLAN – 1ST FLOOR
A201	INTERIOR ELEVATIONS – 1ST FLOOR
A301	ENLARGED PARTIAL PLAN – 1ST FLOOR
A401	REFLECTED CEILING PLAN – 1ST FLOOR
A701	WALL TYPE DETAILS
A702	MISC. DETAILS
A800	DOOR TYPES
A901	FINISH PLAN/SCHEDULE – 1ST FLOOR



GENERAL NOTES

1. GENERAL CONTRACTOR SHALL PROVIDE ANY MECHANICAL WORK REQUIRED ON A DESIGN BUILD BASIS. REBALANCE SYSTEM WHEN COMPLETE.
2. GENERAL CONTRACTOR SHALL PROVIDE ALL ELECTRICAL WORK ON A DESIGN BUILD BASIS.
3. GENERAL CONTRACTOR SHALL PROVIDE ALL FIRE PROTECTION WORK ON A DESIGN BUILD BASIS.
4. MEP DESIGN BUILD SCOPE OF WORK SHALL MEET ALL APPLICABLE STATE AND CITY CODE REQUIREMENTS.
5. ALL WORK SHALL CONFORM TO FEDERAL, STATE AND MUNICIPAL CODES AND ORDINANCES. THESE SHALL SUPERSEDE DRAWINGS, NOTES AND DIMENSIONS IN ALL CASES. THE ARCHITECT SHALL BE NOTIFIED OF SUCH CHANGES BEFORE WORK IS STARTED. OBTAIN PERMITS BEFORE STARTING WORK AND OBTAIN APPROVALS OF ALL REGULATORY AGENCIES UPON COMPLETION AND AS REQUIRED.
6. THE CONTRACT DOCUMENTS CONSIST OF THE DRAWINGS & SPECIFICATIONS. GENERAL CONDITIONS OF THE CONTRACT FOR CONSTRUCTION—AIA DOCUMENT A201 (1987 EDITION), OWNER—CONTRACTOR AGREEMENTS AND ALL AGENDA ISSUED PRIOR TO AND ALL PLAN CHANGES ISSUED AFTER EXECUTION OF THE CONTRACT.
7. UNLESS OTHERWISE INDICATED IN THE CONSTRUCTION DOCUMENTS AS BEING NOT IN CONTRACT (N.I.C.) OR EXISTING. ALL ITEMS, MATERIALS AND INSTALLATION OF SAME ARE A PART OF THE CONTRACT DEFINED BY THE CONSTRUCTION DOCUMENTS. THE CONTRACTOR SHALL PROVIDE AND INSTALL ALL ACCESSORIES, COMPONENTS AND ASSEMBLIES REQUIRED FOR THE WORK SHOWN.
8. CONTRACTOR SHALL SUBMIT A DETAILED PROJECT SCHEDULE. CONTRACTOR IS SOLELY RESPONSIBLE FOR CONSTRUCTION SEQUENCING, METHODS AND TECHNIQUES.
9. THE GENERAL CONTRACTOR IS RESPONSIBLE FOR PAYING AND OBTAINING ALL PERMITS, INSPECTIONS, REQUIRED TESTS AND UTILITY CONNECTIONS UNLESS OTHERWISE NOTED.
10. CONTRACTOR SHALL PROVIDE AND IS SOLELY RESPONSIBLE FOR PUBLIC AND EMPLOYEE PROTECTION AS NECESSARY AND AS REQUIRED BY THE CODES, ORDINANCES AND REGULATIONS OF GOVERNMENTAL AGENCIES HAVING JURISDICTION AT THE PROJECT PLACE.
11. CONTRACTOR TO INSPECT THE AREA OF WORK PRIOR TO STARTING AND NOTIFY THE ARCHITECT OF ANY DISCREPANCIES BETWEEN THESE DRAWINGS AND THE ACTUAL CONDITIONS. DO NOT SCALE THESE DRAWINGS.
12. PRIOR TO CLOSING ANY WALLS OR CEILINGS, ALL SYSTEMS (HVAC, PLUMBING, ELECTRICAL) SHALL BE INSPECTED, AND WHERE REQUIRED, TESTING BY CONTRACTOR'S ENGINEERS AND BY PROPER AUTHORITIES HAVING JURISDICTION TO INSURE THEIR PROPER INSTALLATION AND FUNCTION.
13. THE ARCHITECT RESERVES THE RIGHT TO MOVE ANY FIXTURE, RECEPTACLE OR BUILT-IN OBJECT UP UNTIL THE TIME HE/SHE SHALL APPROVE THE WALLS OR CEILINGS TO BE CLOSED. THIS APPROVAL SHALL TAKE PLACE PRIOR TO THE INSPECTORS APPROVAL SO AS NOT TO CONFLICT WITH ANY BUILDING OFFICIALS DECISIONS.
14. AT NEW CONSTRUCTION PROVIDE ONE PRIMER COAT AND TWO TOP COATS OF PAINT. ADJACENT SURFACES. PROVIDE VINYL BASE TO MATCH BUILDING SPECIFICATIONS.
15. SUBMIT SAMPLES, SHOP DRAWINGS & SCHEDULES FOR ARCHITECT REVIEW & APPROVAL FOR THE FOLLOWING:
 - a. PAINT & VINYL BASE SAMPLES
 - b. DOORS, FRAMES, HARDWARE SCHEDULES & PRODUCT DATA SHEETS
 - c. MILLWORK SHOP DRAWINGS & SAMPLES
 - d. CEILING SYSTEM
 - e. LIGHT FIXTURES
16. IN THE EVENT OF DISCREPANCIES BETWEEN ANY DRAWINGS AND/OR SPECIFICATIONS, THE COSTLIER OR MORE RESTRICTIVE CONDITIONS SHALL BE DEEMED THE CONTRACT REQUIREMENT, UNLESS OTHERWISE STATED IN WRITING, FROM THE OWNER.
17. GENERAL CONTRACTOR SHALL WARRANT WORK PERFORMED FOR A PERIOD OF ONE YEAR FROM THE DATE OF FINAL ACCEPTANCE.
18. IT SHALL BE THE RESPONSIBILITY OF THE CONTRACTOR TO KEEP THE PREMISE CLEAN OF DEBRIS, RUBBISH, EXCESS MATERIALS, ETC.
19. CHARGES FOR EXTRA WORK DONE BY THE CONTRACTOR WILL NOT BE HONORED UNLESS THE WORK AND THE AMOUNT ARE AGREED TO BY THE OWNER IN WRITING BEFORE THE WORK IS DONE, BASED UPON UNIT PRICING.
20. AS REQUIRED BY CODE, EACH CONTRACTOR AND EACH SUBCONTRACTOR SHALL OBTAIN REQUIRED INSPECTION OF THAT PORTION OF WORK.
21. ALL DIMENSIONS ARE TO THE FACE OF DRYWALL OR MASONRY U.O.N.
22. QUALITY CONTROL:
 - A. SITE MEETINGS: CONTRACTOR TO CONDUCT SITE MEETINGS AND WRITE MEETING MINUTES AT FREQUENTCY AS DIRECTED BY OWNER. CONTRACTOR AND ALL SUB-CONTRACTORS MUST BE PRESENT, UNLESS WAIVED BY OWNER.
 - B. INSTALLATION: EXCEPT AS MORE STRINGENT REQUIREMENTS ARE INDICATED ON THESE DRAWINGS AND IN THESE NOTES, COMPLY WITH GENERALLY ACCEPTED INDUSTRY STANDARDS AND INSTALL PRODUCTS IN STRICT COMPLIANCE WITH MANUFACTURER'S PRINTED INSTRUCTIONS.
 - C. WHEN EVALUATING APPEARANCE OR CONFORMANCE WITH DESIGN INTENT, THE WORDS 'ACCEPTABLE', 'VISIBLE', 'INVISIBLE', 'MATCHING', 'ALIGNED' AND SIMILAR TERMS OF JUDGEMENT SHALL MEAN 'ACCEPTABLE, ETC., IN THE OPINION OF THE ARCHITECT OR OWNER.'

INTERIOR CONSTRUCTION:

MARINE TRADE CENTER – PORTLAND, MAINE

SITE PLANS

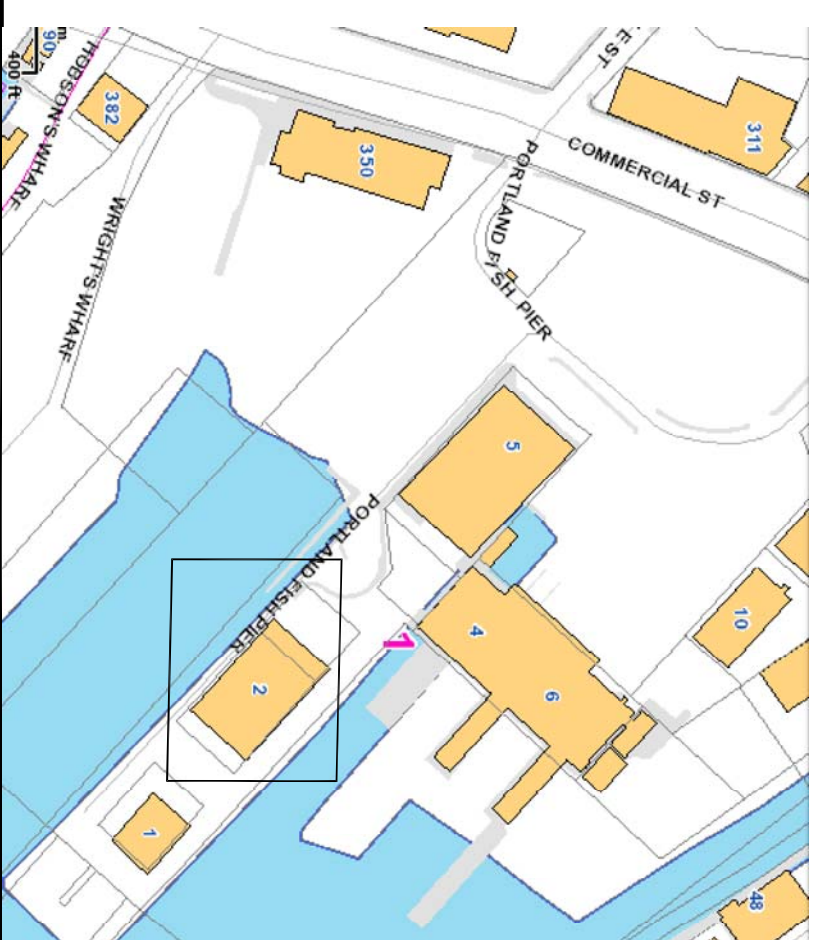
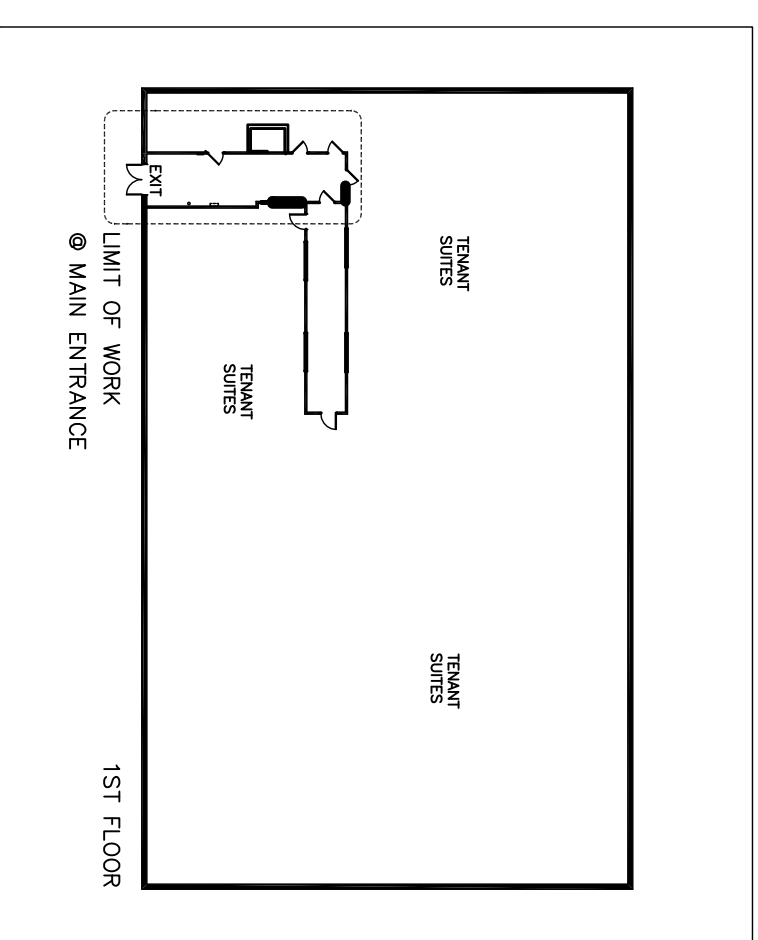

NO	DATE	REVISIONS

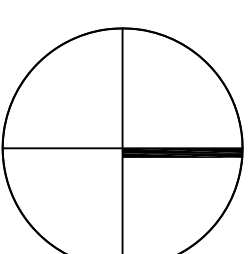

MARINE TRADE CENTER
2 PORTLAND FISH PIER
PORTLAND, ME

TITLE	TITLE SHEET	SCALE AS NOTED
CHECKED BY	1	DATE 12/22/14
DRAWN BY	JAT	



T001

14.201