

DISPLAY THIS CARD ON PRINCIPAL FRONTAGE OF WORK CITY OF PORTLAND

BUILDING INSPECTION

Permit Number: 030787

Please Read Application And Notes, If Any, Attached

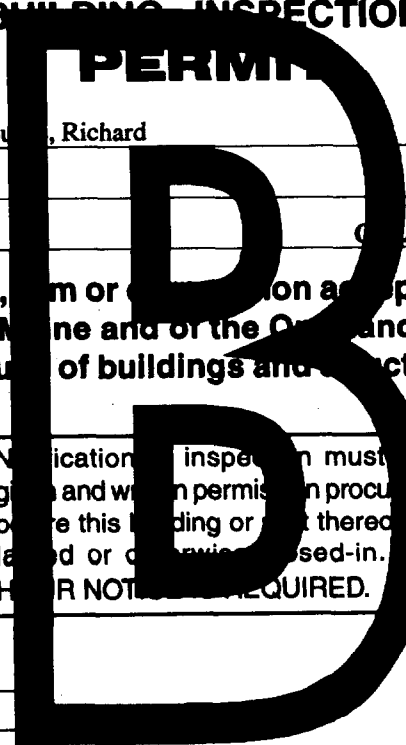

This is to certify that Baxter Place Associates/Plouffe, Richard
has permission to Install 4' x 4' hanging sign.
AT 305 Commercial St 040 F009001

provided that the person or persons, firm or corporation accepting this permit shall comply with all of the provisions of the Statutes of Maine and of the Ordinances of the City of Portland regulating the construction, maintenance and use of buildings and structures, and of the application on file in this department.

Apply to Public Works for street line and grade if nature of work requires such information.

Notification inspection must be given and when permit is procured before this building or part thereof is altered or otherwise used-in. HOUR NOTICES ARE REQUIRED.

A certificate of occupancy must be procured by owner before this building or part thereof is occupied.

OTHER REQUIRED APPROVALS

Fire Dept. _____
Health Dept. _____
Appeal Board _____
Other _____
Department Name

[Signature]
Director - Building Inspection Services

PENALTY FOR REMOVING THIS CARD

City of Portland, Maine - Building or Use Permit Application
 389 Congress Street, 04101 Tel: (207) 874-8703, Fax: (207) 874-8716

Permit No: 03-0787	Issue Date:	CBL: 040 F009001
-----------------------	-------------	---------------------

Location of Construction: 305 Commercial St	Owner Name: Baxter Place Associates	Owner Address: 305 Commercial St	Phone:
Business Name: n/a	Contractor Name: Plourde, Richard	Contractor Address: 340 Granite Hill Road Manchester	Phone 2076231262
Lessee/Buyer's Name n/a	Phone: n/a	Permit Type: Signs - Permanent	Zone: B3

Past Use: Commercial / Gallery	Proposed Use: Gallery/ Install 4' x 4' hanging sign.	Permit Fee: \$62.00	Cost of Work: \$0.00	CEO District: 2
Proposed Project Description: Install 4' x 4' hanging sign.		FIRE DEPT: <input type="checkbox"/> Approved <input type="checkbox"/> Denied	INSPECTION: Use Group: SIGN Type: NA 7/18/03 Signature: [Signature]	
		PEDESTRIAN ACTIVITIES DISTRICT (P.A.D.) Action: <input type="checkbox"/> Approved <input type="checkbox"/> Approved w/Conditions <input type="checkbox"/> Denied Signature: _____ Date: _____		

Permit Taken By: gg	Date Applied For: 07/08/2003	Zoning Approval		
------------------------	---------------------------------	------------------------	--	--

1. This permit application does not preclude the Applicant(s) from meeting applicable State and Federal Rules. 2. Building permits do not include plumbing, septic or electrical work. 3. Building permits are void if work is not started within six (6) months of the date of issuance. False information may invalidate a building permit and stop all work..	Special Zone or Reviews <input type="checkbox"/> Shoreland <input type="checkbox"/> Wetland <input type="checkbox"/> Flood Zone <input type="checkbox"/> Subdivision <input type="checkbox"/> Site Plan Maj <input type="checkbox"/> Minor <input type="checkbox"/> MM <input type="checkbox"/> Date: 07/15/03	Zoning Appeal <input type="checkbox"/> Variance <input type="checkbox"/> Miscellaneous <input type="checkbox"/> Conditional Use <input type="checkbox"/> Interpretation <input type="checkbox"/> Approved <input type="checkbox"/> Denied Date:	Historic Preservation <input type="checkbox"/> Not in District or Landmark <input type="checkbox"/> Does Not Require Review <input checked="" type="checkbox"/> Requires Review <input checked="" type="checkbox"/> Approved <input type="checkbox"/> Approved w/Conditions <input type="checkbox"/> Denied D.A 7/17/03 Date:
------------------------------------------------------------------------------------------------------------------------------------------------------------------------------------------------------------------------------------------------------------------------------------------------------------------------------------------------------------------------	--------------------------------------------------------------------------------------------------------------------------------------------------------------------------------------------------------------------------------------------------------------------------------------------------------------------------------------------	-----------------------------------------------------------------------------------------------------------------------------------------------------------------------------------------------------------------------------------------------------------------------------	--------------------------------------------------------------------------------------------------------------------------------------------------------------------------------------------------------------------------------------------------------------------------------------------------------------------------------------------------------------

D. Andrews
7/17/03

CERTIFICATION

I hereby certify that I am the owner of record of the named property, or that the proposed work is authorized by the owner of record and that I have been authorized by the owner to make this application as his authorized agent and I agree to conform to all applicable laws of this jurisdiction. In addition, if a permit for work described in the application is issued, I certify that the code official's authorized representative shall have the authority to enter all areas covered by such permit at any reasonable hour to enforce the provision of the code(s) applicable to such permit.

 SIGNATURE OF APPLICANT ADDRESS DATE PHONE

 RESPONSIBLE PERSON IN CHARGE OF WORK, TITLE DATE PHONE

SIGNAGE/AWNING PRE-APPLICATION QUESTIONNAIRE

PLEASE ANSWER ALL QUESTIONS

B-3

ADDRESS: 305 COMMERCIAL ST. ZONE:

CBL:

SINGLE TENANT LOT? YES NO X MULTI TENANT LOT? YES X NO

MORE THAN ONE SIGN TOTAL WITH PROPOSED SIGN? YES X NO

tell which sign -

INFORMATION ON PROPOSED SIGN(S):

FREESTANDING (e.g., pole) SIGN? YES NO DIMENSIONS PROPOSED:

BLDG. WALL SIGN? (attached to bldg) YES X NO DIMENSIONS PROPOSED: 4' x 4' sq. BY BRACKET

INFORMATION ON ALREADY EXISTING AND PERMITTED SIGN(S):

FREESTANDING (e.g., pole) SIGN? YES NO DIMENSIONS:

BLDG. WALL SIGN(attached to bldg) ? YES X 3 NO DIMENSIONS: 4' x 4', 4' x 5' + 4' x 4'

AWNING? YES NO X DIMENSIONS:

LOT FRONTAGE (FEET): 810' = 150'

TENANT/ALLOCATED BUILDING SPACE FRONTAGE (FEET): 50' x 2' (100' = 1/3 FRONTAGE OF BUILDING)

AWNING YES NO X IS AWNING BACKLIT? YES NO

HEIGHT OF AWNING: LENGTH OF AWNING: DEPTH:

IS THERE ANY COMMUNICATION, MESSAGE, TRADEMARK OR SYMBOL ON IT? YES NO

IF YES, TOTAL S.F. OF PANELS WITH COMMUNICATIONS/MESSAGE/TRADEMARK/SYMBOL? s.f.

A SITE SKETCH AND BUILDING SKETCH SHOWING EXACTLY WHERE EXISTING AND NEW SIGNAGE IS LOCATED MUST BE PROVIDED. SKETCHES AND/OR PICTURES OF PROPOSED SIGNAGE ARE ALSO REQUIRED.

SIGNATURE OF APPLICANT: [Signature] DATE: 2/7/03

***** FOR OFFICE USE ONLY *****

CHECKLIST FOR SIGN/AWNING APPLICATION

Applicants for a sign or awning permit are required to submit the following information to the Code Enforcement Office at the time of application:

- Certificate of Liability listing the City as additional insured if any portion of the sign abuts or encroaches on any public right of way, or can fall into any public right of way. Amount must equal \$400,000.00. ✓
- Letter of permission from the owner indicating the permissions granted and the tenant/space building frontage. ✓
- A sketch plan of lot indicating location of buildings, driveways, and any abutting streets or rights of way, lengths of building frontages, street frontages, and all existing setbacks. Indicate on the plan all existing and proposed signs with their dimensions and specific locations.
- A sketch or photo of any proposed sign(s) indicating content, dimensions, materials, source of illumination, and construction method, as well as specifics of installation/attachment. ✓
- Certificate of Flammability required for awning or canopy at time of application.
- UL# required for lighted signs at the time of Final Inspection. Failure to provide this information will invalidate the Sign Permit.
- Pre-Application Questionnaire completed and attached. Photos of existing signage attached. ✓

**Permit Fee for signage or awning-with-signage:
\$30.00 plus \$1.00 per square foot of sign.**

**Permit Fee for awning-without-signage is based on cost of work:
\$30.00 for the first \$1,000.00, plus \$7.00 for each additional \$1,000.00.**

Signage/Awning Permit Application

If you or the property owner owes real estate or personal property taxes or user charges on any property within the City, payment arrangements must be made before permits of any kind are accepted.

Location/Address of Construction: <u>FOUNDRY LANE 305 COMMERCIAL ST.</u>		
Total Square Footage of Proposed Structure <u>4' X 4'</u>	Square Footage of Lot <u>1300 SQ FT.</u>	
Tax Assessor's Chart, Block & Lot Chart# <u>040</u> Block# <u>F</u> Lot# <u>009</u>	Owner: <u>FISHMAN REALTY MGT.</u> <u>KEN ASTOR</u>	Telephone: <u>9/0</u> <u>FISHMAN REALTY</u> <u>773-2722</u>
Lessee/Buyer's Name (if Applicable) <u>JENNIFER BURTON</u> <u>DIRA FOUNDRY LANE</u>	Applicant name, address & telephone: <u>JENNIFER BURTON</u> <u>PO BOX 454</u> <u>PTD., ME 04112</u> <u>207 773 2722</u>	Total s.f. of signage x \$1.00 per s.f. plus \$30.00 = Total Fee: <u>\$ 46.00</u> Awning Fee = Cost Of Work: \$ <u>0</u> Total Fee: \$ <u>46.00</u>
Current use: <u>GALLERY</u>	<p style="text-align: right;">OWRS \$16.00 PAYABLE WHEN P/O \$324</p>	
If the location is currently vacant, what was prior use: <u>VISITORS CENTER</u>		
Approximately how long has it been vacant: <u>6 MONTHS</u>		
Proposed use: <u>GALLERY / STOREFRONT</u>	Project description: <u>NEW SIGNAGE</u>	
<p>→ SIGN MAKER: <u>MAXICELLY 14 PROSPECT ST. BAY HARBOR, 207 288-</u></p>		
Contractor's name, address & telephone: <u>PATRICK PLOURDE 256 TOBEY RD - NEW GLOUCESTER, ME</u>		
Who should we contact when the permit is ready: <u>JENNIFER BURTON ME</u>		
Mailing address: <u>P.O. BOX 454 772-2722</u> <u>926-3130, 838-2534</u> <u>PORTLAND, ME 04112</u>		
We will contact you by phone when the permit is ready. You must come in and pick up the permit and review the requirements before starting any work, with a Plan Reviewer. A stop work order will be issued and a \$100.00 fee if any work starts before the permit is picked up. PHONE: <u>773-2722 +841-2834</u>		

IF THE REQUIRED INFORMATION IS NOT INCLUDED IN THE SUBMISSIONS THE PERMIT WILL BE AUTOMATICALLY DENIED AT THE DISCRETION OF THE BUILDING/PLANNING DEPARTMENT. WE MAY REQUIRE ADDITIONAL INFORMATION IN ORDER TO APPROVE THIS PERMIT.

I hereby certify that I am the Owner of record of the named property, or that the owner of record authorizes the proposed work and that I have been authorized by the owner to make this application as his/her authorized agent. I agree to conform to all applicable laws of this jurisdiction. In addition, if a permit for work described in this application is issued, I certify that the Code Official's authorized representative shall have the authority to enter all areas covered by this permit at any reasonable hour to enforce the provisions of the codes applicable to this permit.

Signature of applicant: <u>Jennifer Burton</u>	Date: <u>7-4-03</u>
------------------------------------------------	---------------------

This is NOT a permit, you may not commence ANY work until the permit is issued.

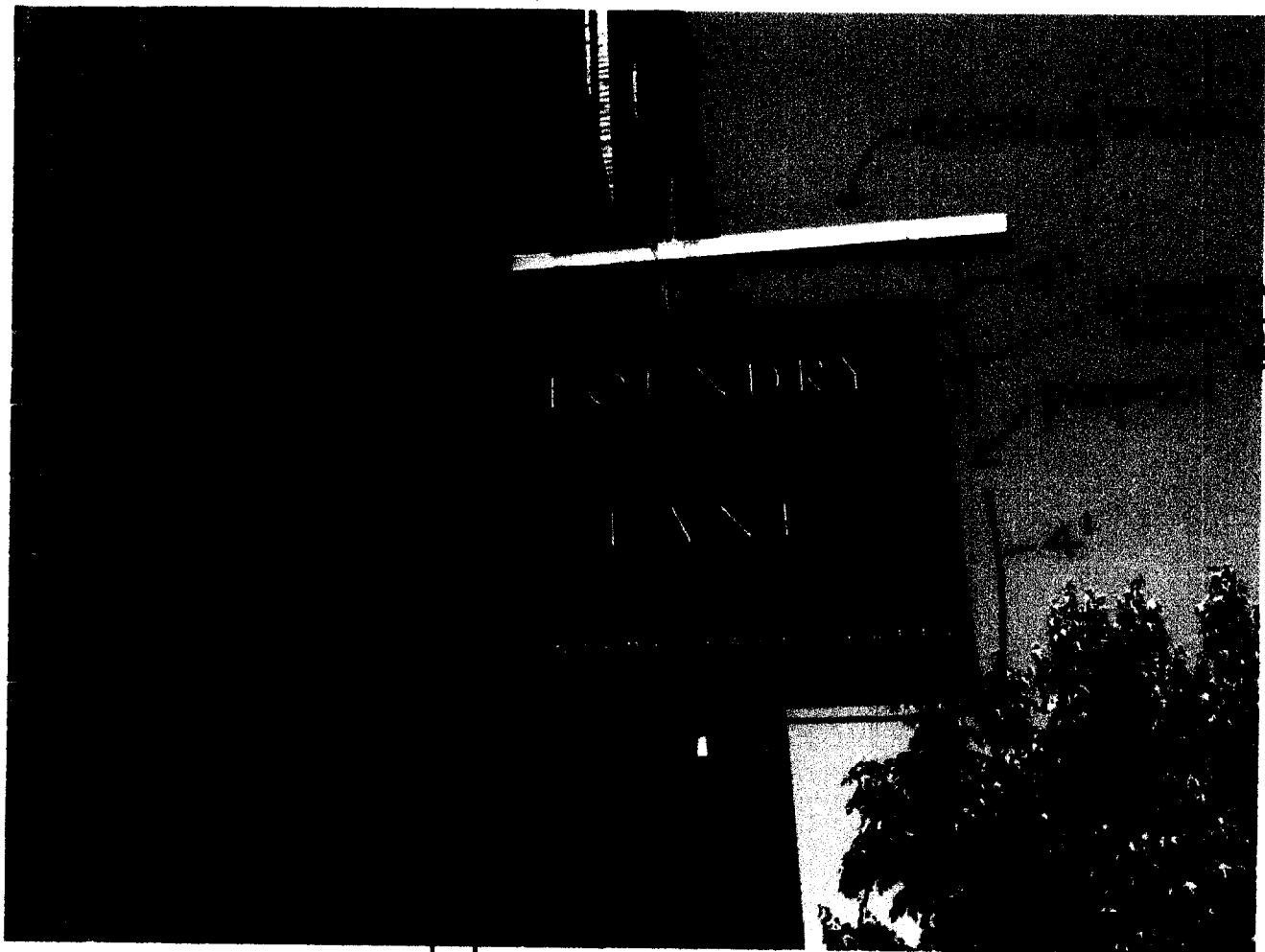

N/
TO
BRACKET

10' FROM BOTTOM OF SIGN
TO STREET (SIDEWALK)

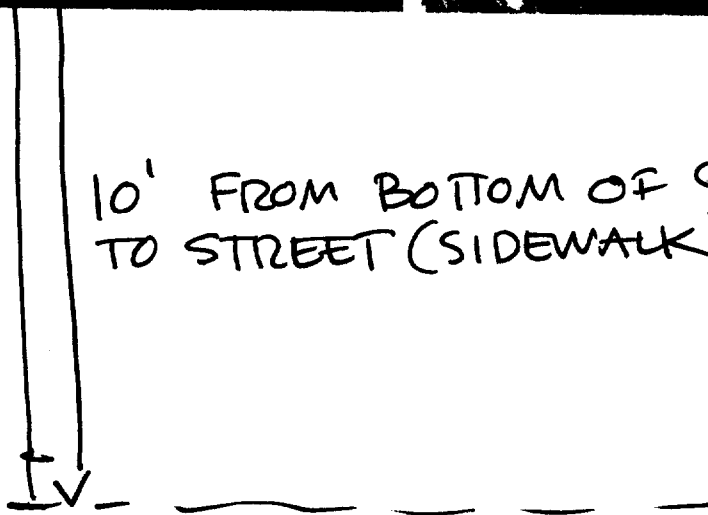

(A) PROPOSED SIGN FOR EXISTING BRACKET = 4' SQUARE

(B) KNAUGHTY HAIR SIGN = 4x5'

(C) JAMESON SIGN 4x4 1/2'

(D) POND COVE PRINT SIGN 4x4'

(E) LENGTH OF BLDG = 150'

OUR FRONTAGE = 50' WINDOW EXPOSURE

305 COMMERCIAL ST.

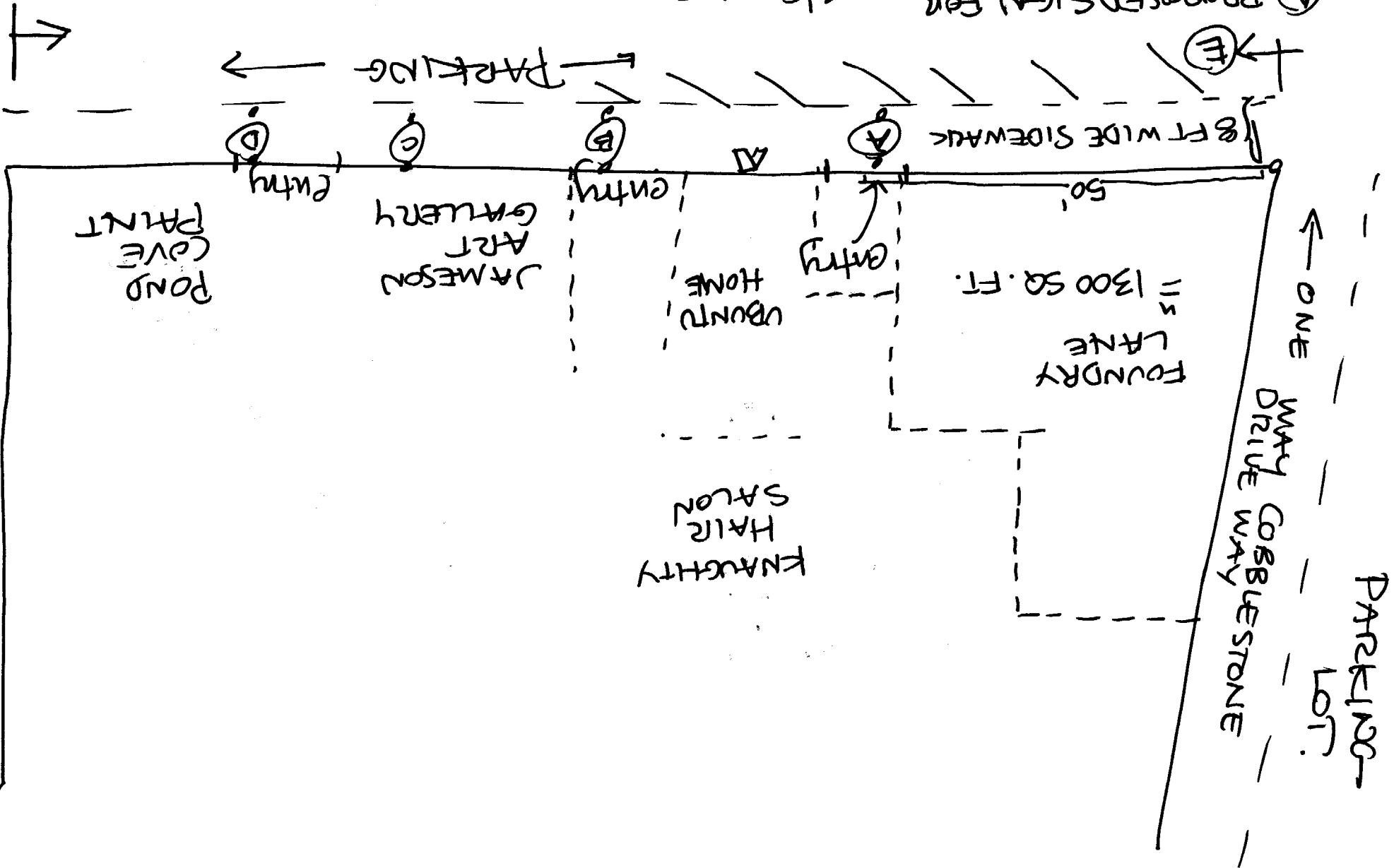

PARKING

CENTER ST

ONE WAY DRIVE WAY COBBLESTONE
PARKING LOT

POND COVE PRINT

JAMESON ART GALLERY

KNAUGHTY HAIR SALON

UBUNTU HOME

FOUNDRY LANE
= 1300 SQ. FT.

50' FT WIDE SIDEWALK

PARKING

PARKING LOT

BUILDING
FACE

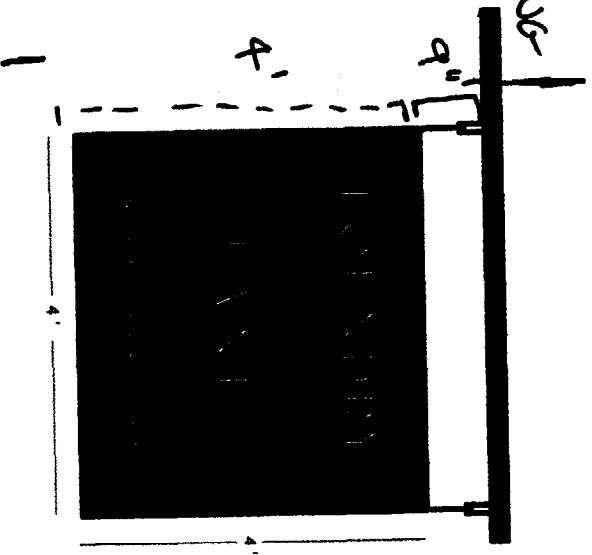

PROPOSED SIGN:
4X4' PAINTED
PLYWOOD, TWO
SIDED, TO BE
HUNG FROM
EXISTING
BRACKET

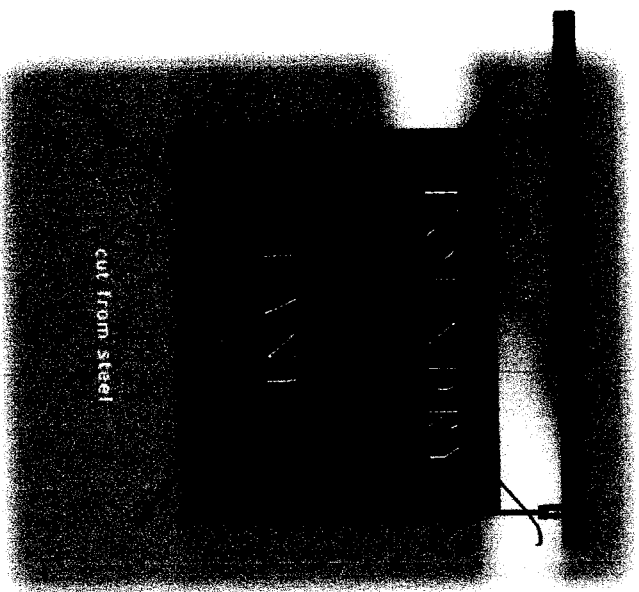
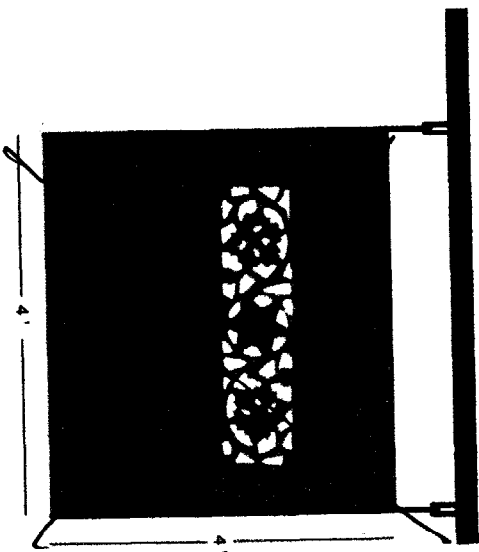

cut from steel

ACORD CERTIFICATE OF LIABILITY INSURANCE

DATE (MM/DD/YYYY)
07/07/2003

PRODUCER O'Hearn Insurance Agency 1087 Forest Ave Portland, Me. 04103 207-797-9400		THIS CERTIFICATE IS ISSUED AS A MATTER OF INFORMATION ONLY AND CONFERS NO RIGHTS UPON THE CERTIFICATE HOLDER. THIS CERTIFICATE DOES NOT AMEND, EXTEND OR ALTER THE COVERAGE AFFORDED BY THE POLICIES BELOW.	
INSURERS AFFORDING COVERAGE		NAICS	
INSURED Foundry Lane C/O Jennifer Burton 305 Commerical St Portland, ME 04101 207-761-0917		INSURER A: Zurich NA INSURER B: INSURER C: INSURER D: INSURER E:	

COVERAGES

THE POLICIES OF INSURANCE LISTED BELOW HAVE BEEN ISSUED TO THE INSURED NAMED ABOVE FOR THE POLICY PERIOD INDICATED. NOTWITHSTANDING ANY REQUIREMENT, TERM OR CONDITION OF ANY CONTRACT OR OTHER DOCUMENT WITH RESPECT TO WHICH THIS CERTIFICATE MAY BE ISSUED OR MAY PERTAIN, THE INSURANCE AFFORDED BY THE POLICIES DESCRIBED HEREIN IS SUBJECT TO ALL THE TERMS, EXCLUSIONS AND CONDITIONS OF SUCH POLICIES. AGGREGATE LIMITS SHOWN MAY HAVE BEEN REDUCED BY PAID CLAIMS.

NO.	ACORD	TYPE OF INSURANCE	POLICY NUMBER	POLICY EFFECTIVE DATE (MM/DD/YY)	POLICY EXPIRATION DATE (MM/DD/YY)	LIMITS
A		GENERAL LIABILITY <input checked="" type="checkbox"/> COMMERCIAL GENERAL LIABILITY <input type="checkbox"/> CLAIMSMADE <input checked="" type="checkbox"/> OCCUR GEN'L AGGREGATE LIMIT APPLIES PER: <input checked="" type="checkbox"/> POLICY <input type="checkbox"/> PROJ <input type="checkbox"/> LOC	PAS 41945032	03/12/03	03/12/04	EACH OCCURRENCE \$1,000,000
		DAMAGE TO RENTED PREMISES (EA occurrence) \$1,000,000 MED EXP (Anyone person) \$10,000 PERSONAL ADVI INJURY \$1,000,000 GENERAL AGGREGATE \$2,000,000 PRODUCTS-COMP/OP/PAGG \$2,000,000				
		AUTOMOBILE LIABILITY <input type="checkbox"/> ANY AUTO <input type="checkbox"/> ALL OWNED AUTOS <input type="checkbox"/> SCHEDULED AUTOS <input type="checkbox"/> HIRED AUTOS <input type="checkbox"/> NON-OWNED AUTOS				COMBINED SINGLE LIMIT (EA accident) \$ BODILY INJURY (Per person) \$ BODILY INJURY (Per accident) \$ PROPERTY DAMAGE (Per accident) \$
		GARAGE LIABILITY <input type="checkbox"/> ANY AUTO				AUTO ONLY - EA ACCIDENT \$ OTHER THAN AUTO ONLY: EA ACC \$ AGG \$
		EXCESS UMBRELLA LIABILITY <input type="checkbox"/> OCCUR <input type="checkbox"/> CLAIMSMADE DEDUCTIBLE RETENTION \$				EACH OCCURRENCE \$ AGGREGATE \$ \$ \$ \$
		WORKERS COMPENSATION AND EMPLOYERS' LIABILITY ANY PROPRIETOR/PARTNER/EXECUTIVE OFFICER/EMPLOYEE/STUDENT If yes, describe under SPECIAL PROVISIONS below OTHER				<input type="checkbox"/> INC STAFF/TOOL/LIMITS <input type="checkbox"/> OTHER E.L. EACH ACCIDENT \$ E.L. DISEASE - EA EMPLOYEE \$ E.L. DISEASE - POLICY LIMIT \$

DESCRIPTION OF OPERATIONS/LOCATIONS/VEHICLES/EXCLUSIONS/ADDED BY ENDORSEMENT/SPECIAL PROVISIONS

CERTIFICATE HOLDER

Additional Insured:
 City of Portland
 Congress St
 Portland, Me 04101

CANCELLATION

SHOULD ANY OF THE ABOVE DESCRIBED POLICIES BE CANCELLED BEFORE THE EXPIRATION DATE THEREOF, THE ISSUING INSURER WILL ENDEAVOR TO MAIL 30 DAYS WRITTEN NOTICE TO THE CERTIFICATE HOLDER NAMED TO THE LEFT, BUT FAILURE TO DO SO SHALL IMPOSE NO OBLIGATION OR LIABILITY OF ANY KIND UPON THE INSURER, ITS AGENTS OR REPRESENTATIVES.

AUTHORIZED REPRESENTATIVE



2 Cotton Street
Portland, Maine 04101
PO Box 15430
Portland, Maine 04112-5430

Phone (207) 775-6561
FAX (207) 871-0914

July 7, 2003

To whom it may concern:

Please accept this letter as permission by Fishman Property Management, agent for Ken Astor, for Jenepher Burton and Foundry Lane to install signage using the existing sign bracket previously used by The Convention & Visitor's Bureau on the outside of Baxter Place, 305 Commercial Street, Portland, Maine.

Thank you for your attention to this.

Sincerely,

A handwritten signature in black ink, appearing to read "James VanValkenburgh".

James VanValkenburgh