

LEGEND

- BUILDING
- FENCE
- SIGN - TWO POST
- SIGN - SINGLE POST
- BOUNDARY LINE/R.O.W.
- EASEMENT
- MAXIMUM SETBACK LINE
- CURB LINE
- RETAINING WALL
- PROPOSED CONTOUR
- 47 — EXISTING CONTOUR, 1 FOOT
- 45 — EXISTING CONTOUR, 5 FOOT
- POLE MOUNTED LIGHT
- OOE — UNDERGROUND ELECTRIC
- OOC — UNDERGROUND COMMUNICATIONS
- UOU — UNDERGROUND UTILITIES
- G — GAS LINE
- G — GAS VALVE
- W — FIRE HYDRANT
- W — WATER VALVE
- U — UTILITY POLE
- 4 — CUT WIRE OR POLE SUPPORT
- S — SEWER PIPE
- S — SEWER MANHOLE
- D — DRAINAGE PIPE
- D — DRAINAGE MANHOLE
- C — CATCH BASIN
- C — EXISTING CATCH BASIN
- C — EXISTING CATCH BASIN W/ CURB INLET
- T — TEOCOM MANHOLE
- T — ELECTRIC MANHOLE
- COBBLE STONE
- BRICK PAVERS
- BROOM FINISH CONCRETE
- ASPHALT PAVEMENT
- TREE

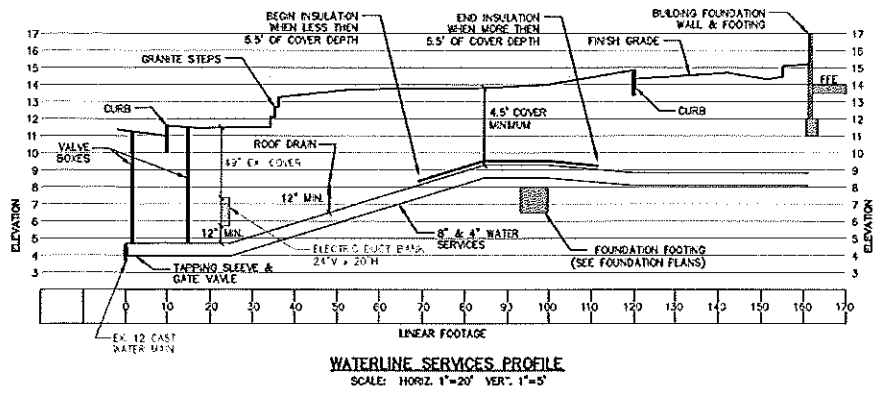

WATERLINE SERVICES PROFILE
SCALE: HORIZ. 1"=20' VER. 1"=5'

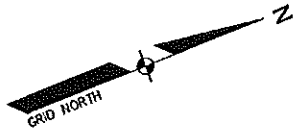
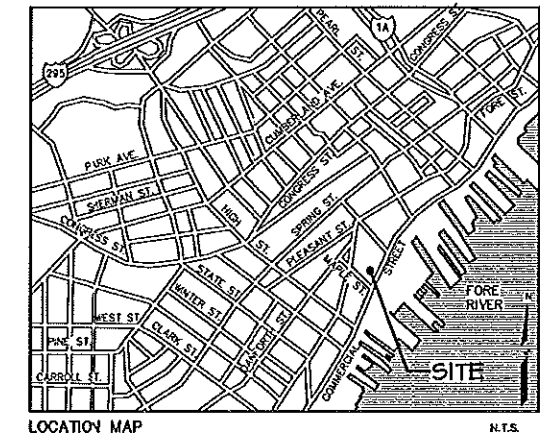

LOCATION MAP N.T.S.

GENERAL NOTES:

1. ALL WORK WITHIN THE STREET RIGHT OF WAY WILL MEET THE STANDARDS IN THE CITY OF PORTLAND'S DESIGN AND TECHNICAL MANUALS.
2. GREASE TRAP CALCULATIONS:
THE STATE OF MAINE SUBSURFACE WASTEWATER DISPOSAL RULES ARE UTILIZED TO CALCULATE THE AVERAGE DAILY PROCESS FLOW FROM THE FACILITY WITH NO SANITARY OR OTHER EXTRANEOUS WASTES FLOWING THROUGH THE TRAP.
PROCESS FLOW CALCULATION:
Q = (M)(S)(LF) WHERE:
Q IS THE LIQUID CAPACITY OF EXTERNAL GREASE INTERCEPTION IN GALLONS
M IS THE TOTAL NUMBER OF MEALS SERVED PER DAY
S IS THE GALLONS OF WASTEWATER PER MEAL, TYP. 2.0 GALLONS
LF IS A LEAKING FACTOR DEPENDING ON TYPE OF FACILITIES PRESENT
LF IS 1.0 WITH DISH WASHING
LF IS 0.5 WITHOUT DISH WASHING
MEALS PER DAY:
HOTEL: 50 SEATS AT 2 MEALS PER DAY = 100 MEALS
RESTAURANT LOUNGE: 78 SEATS AT 2 MEALS PER DAY = 156 MEALS
RESTAURANT DINING: 158 SEATS AT 3 MEALS PER DAY = 474 MEALS
TOTAL MEALS PER DAY = 730 MEALS
PROCESS FLOW Q = (730)(2.0)(1.0) = 2,920 GALLONS
3. EXISTING TREES INDICATED TO REMAIN ARE SUBJECT TO REPLACEMENT REQUIREMENTS. SEE THE LANDSCAPE OR DEMOLITION PLAN FOR TREE PRESERVATION AND/OR REPLACEMENT NOTES.

DATE	REVISION	SCHEDULE
05-04-13	MOVED ELECTRIC UTILITY ROOM AND REVISED ELECTRIC & COMM. CONDUIT	B.L.B.
04-12-13	REVISED GAS, WATER, DRAINAGE, SEWER AND THE DUMPSTER ENCLASURE	B.L.B.
04-23-13	REVISED DRAINAGE PIPE REFERENCE WITHIN THE CITY R.O.W. AND REVISED WATER SERVICE GATE VALVE LOCATING TO THE PROPERTY LINE	B.L.B.

COPECHEE
CONSTRUCTION CORPORATION
11 CORPORATE DRIVE, BELMONT, NH 03220
PHONE (603) 337-9888 FAX (603) 337-9781

UTILITY PLAN

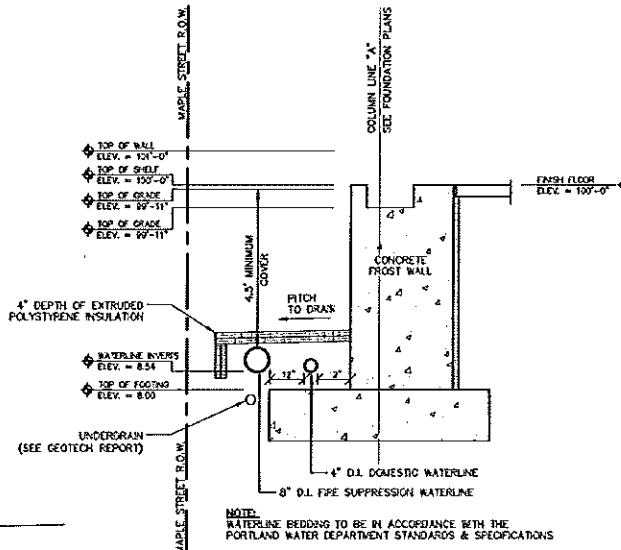

WATERLINE SERVICE & FOUNDATION SECTION A-A
CITY OF PORTLAND APPROVED SITE PLAN
Subject to Dept. Conditions
Date of Approval: 1-22-2013
as amended 4-23-2013
re proposed changes
GRAPHIC SCALE
1" = 20'
1" = 80' ft

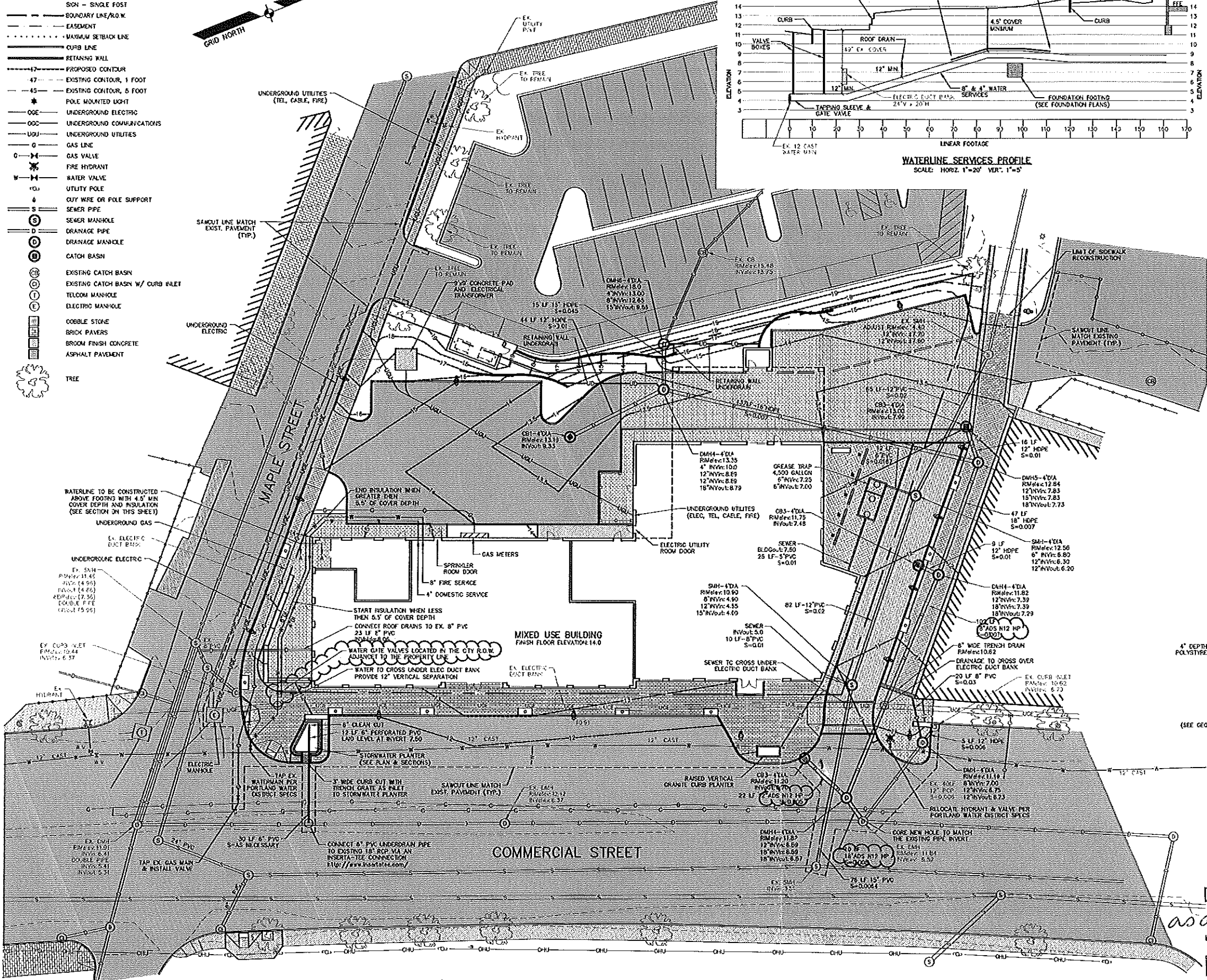

COMMERCIAL & MAPLE STREET MIXED USE DEVELOPMENT
PORTLAND, ME
PROJECT: C05
DATE: 10-22-12
SCALE: 1"=20'
DRAWN BY: B.L.B.
SHEET 5 OF 14

Inspector's