

Consultants

Revisions  
10.28.14 Portland CEO Comments

TIQA  
311 Commercial Street  
Portland, Maine

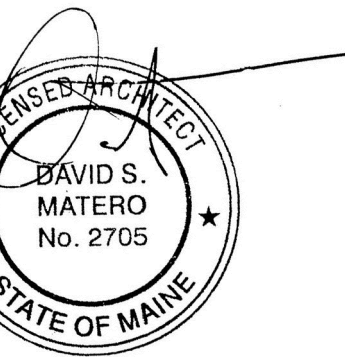

Job Number: 14.000  
Date: 10.28.14  
Scale: 3/16" = 1'-0"

Drawing Title:  
Code Review Plan

R.3  
Issue for  
Permit

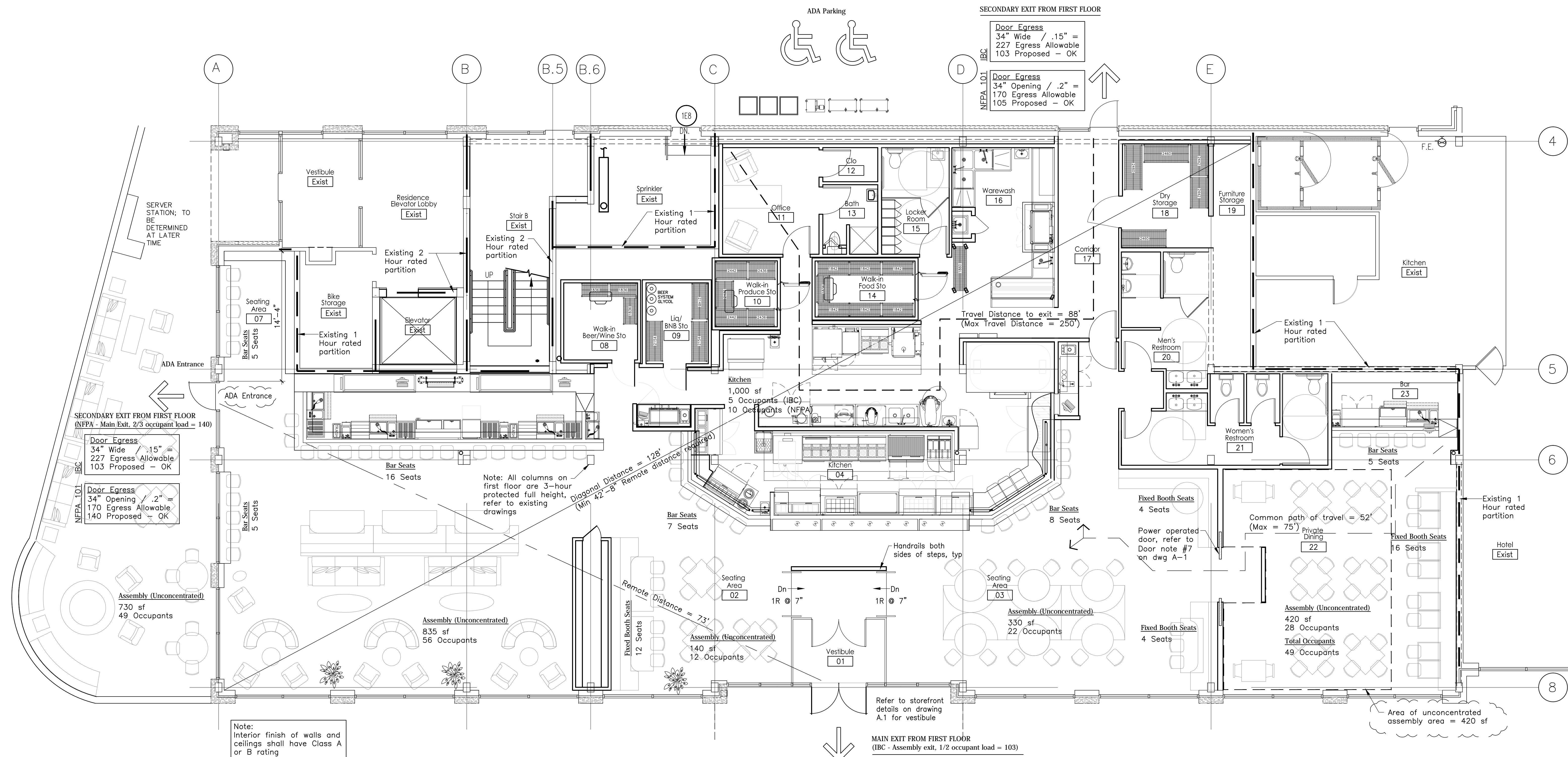

EGRESS - IBC (Table 1004.1.1)			EGRESS - Life Safety (Table 7.3.1.2)		
Room	Area	Occupants	Room	Area	Occupants
Assembly Space (Unconcentrated)	1,565 sf @ 15 sf net =	108 Occupants	Assembly Space (Unconcentrated)	1,565 sf @ 15 sf net =	108 Occupants
Bar Seating	46 Seats =	46 Occupants	Bar Seating	46 Seats =	46 Occupants
Fixed Booth Seating	36 Seats =	36 Occupants	Fixed Booth Seating	36 Seats =	36 Occupants
Kitchen	1,000 sf @ 200 gross sf =	5 Occupants	Kitchen	1,000 sf @ 100 gross sf =	10 Occupants
<b>Total First Floor</b>		<b>205 Occupants</b>	<b>Total First Floor</b>		<b>210 Occupants</b>
<b>Total Occupants</b>		<b>205 Occupants</b>	<b>Total Occupants</b>		<b>210 Occupants</b>
<b>Outdoor Patio Seating</b>			<b>Outdoor Patio Seating</b>		
Assembly Space (Unconcentrated)	730 sf @ 15 sf net =	49 Occupants	Assembly Space (Unconcentrated)	730 sf @ 15 sf net =	49 Occupants
<b>Total Ground Floor Patio Occupants</b>		<b>49 Occupants</b>	<b>Total Ground Floor Patio Occupants</b>		<b>49 Occupants</b>

**1 First Floor Code Review Plan**  
Scale: 3/16" = 1'-0"

0 3' 6' 9'  
18"  
3/16" = 1'-0"

Note: Interior finish of walls and ceilings shall have Class A or B rating

Note: All columns on first floor are 3-hour protected full height, refer to existing drawings

Area of unconcentrated assembly area = 420 sf