

ISSUE	DATE	DESCRIPTION OF ISSUE	BY
A	8/5/14	MECHANICAL CONNECTIONS	CMB
B	8/20/14	CONCRETE PER SHOP PROPOSAL	CMB
C	9/1/14	SERVER STATION CONCRETE	CMB
D	9/22/14	CEILING SUPPORTS	CMB
E	9/25/14	EQUIPMENT CONCRETE	CMB
F	9/26/14	FINAL SET	JRD

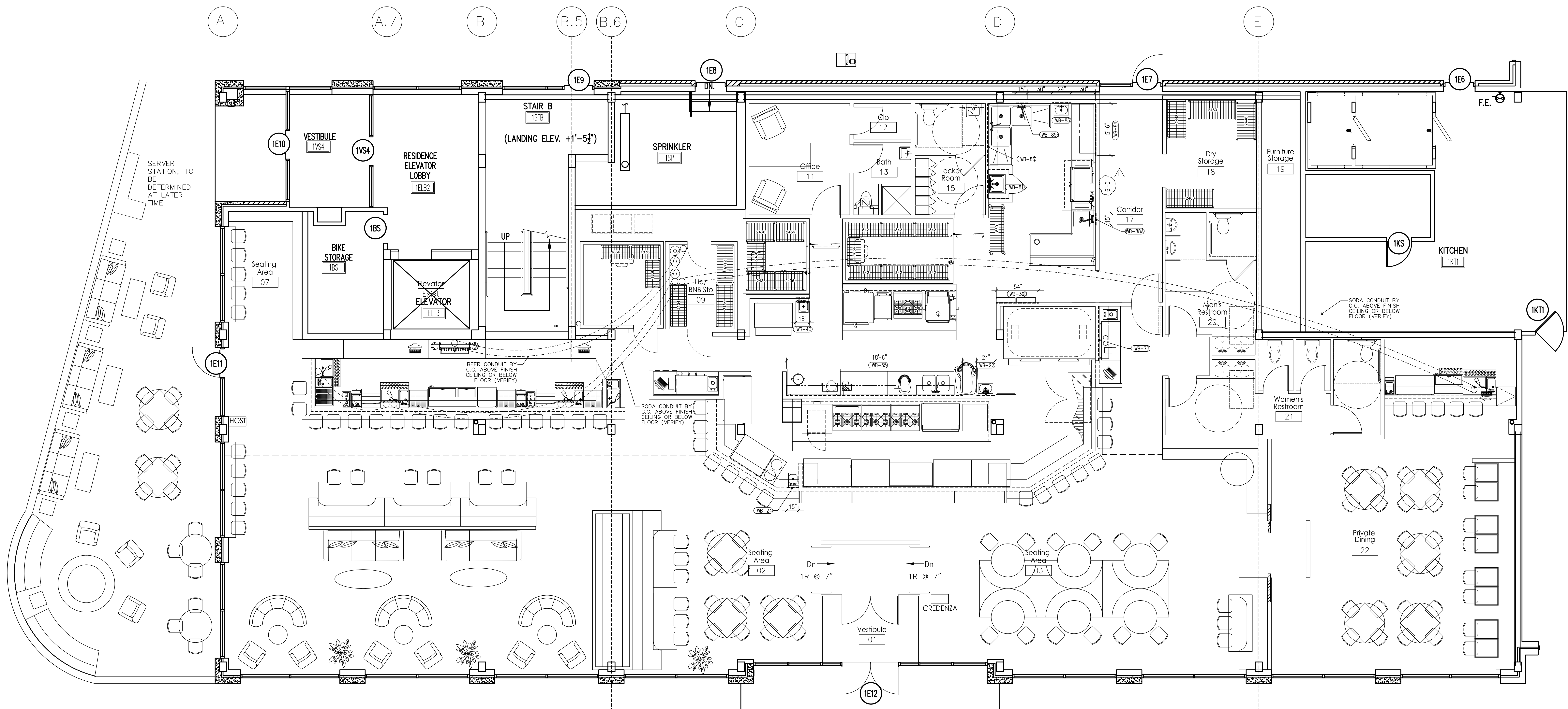

WALL BLOCKING SCHEDULE

WB-22	3/4" WALL BLOCKING FROM 24" TO 84"-AFF FOR ITEM 22, HAND SINK & ITEM 71, POT FILL FAUCET. SOAP & TOWEL DISPENSERS ARE BY OTHERS.
WB-24	3/4" WALL BLOCKING FROM 24" TO 84"-AFF FOR ITEM 24, HAND SINK. SOAP & TOWEL DISPENSERS ARE BY OTHERS.
WB-30	3/4" WALL BLOCKING FROM 72"-AFF TO FINISH CEILING FOR ITEMS 39-D & 66-D, FIRE SUPPRESSION SYSTEMS. SOAP & TOWEL DISPENSERS ARE BY OTHERS.
WB-40	3/4" WALL BLOCKING FROM 24" TO 84"-AFF FOR ITEMS 40, WATER FILTER ASSEMBLIES & ITEM 24, HAND SINK. SOAP & TOWEL DISPENSERS ARE BY OTHERS.
WB-55	3/4" WALL BLOCKING FROM 48" TO 84"-AFF FOR ITEMS 55 & 60, WALL SHELVES.
WB-73	3/4" WALL BLOCKING FROM 48" TO 72"-AFF FOR ITEM 73, WALL SHELF.
WB-81	3/4" WALL BLOCKING FROM 48" TO 72"-AFF FOR ITEM 81, MOP SINK FAUCET & MOP HANGER.
WB-83	3/4" WALL BLOCKING FROM 24" TO 84"-AFF FOR ITEM 83, HAND SINK. SOAP & TOWEL DISPENSERS ARE BY OTHERS.
WB-84	3/4" WALL BLOCKING FROM 48" TO 84"-AFF FOR ITEM 84, RACK SHELF.
WB-88	3/4" WALL BLOCKING FROM 48" TO 72"-AFF FOR ITEM 88-B, PRE-RINSE FAUCET.
WB-88	3/4" WALL BLOCKING FROM 48" TO 72"-AFF FOR ITEM 88, WALL SHELF.
WB-88A	3/4" WALL BLOCKING FROM 48" TO 72"-AFF FOR ITEM 88-A, PRE-RINSE FAUCET.

APPROVAL

APPROVED AS SUBMITTED
 APPROVED AS NOTED
 NOT APPROVED/RESUBMIT

REVIEW BY: _____ DATE: _____

GENERAL NOTES

- A**
THESE PLANS ARE PREPARED FOR THE CONVENIENCE OF OTHERS TO LOCATE MECHANICAL PORTS OR CONNECTIONS FOR FOODSERVICE EQUIPMENT. THEY ARE AS ACCURATE AS CAN BE DETERMINED AT THIS DATE. DIMENSIONS MAY DEVELOP BETWEEN DIMENSIONS SHOWN, FINISHED DIMENSIONS, AND UTILITY CONNECTIONS/SHOP INFORMATION.
- B**
TRIMARK/UNITED-EAST IS NOT RESPONSIBLE FOR ANY UTILITY REQUIREMENTS REGARDING EXISTING EQUIPMENT TO BE REUSED. IT IS THE RESPONSIBILITY OF THE GENERAL CONTRACTOR AND ELECTRICAL, PLUMBING & HVAC CONTRACTORS TO VERIFY & COORDINATE ALL SERVICE REQUIREMENTS WITH OWNER TO INSURE PROPER CONNECTIONS.
- C**
TRIMARK/UNITED-EAST IS NOT RESPONSIBLE FOR ANY UTILITY REQUIREMENTS REGARDING EXISTING EQUIPMENT IN KITCHEN EQUIPMENT CONTRACT. IT IS THE RESPONSIBILITY OF THE GENERAL CONTRACTOR AND ELECTRICAL, PLUMBING & HVAC CONTRACTORS TO VERIFY & COORDINATE ALL SERVICE REQUIREMENTS WITH OWNER TO INSURE PROPER CONNECTIONS.
- D**
ALL ELECTRICAL, PLUMBING, AND MECHANICAL UTILITY REQUIREMENT INFORMATION LISTED ON THE FOODSERVICE PLANS, IS SUBJECT TO CHANGE BASED UPON FINAL EQUIPMENT PROPOSAL, SELECTED BY THE OWNER AND/OR CONTRACTOR.

FOODSERVICE EQUIPMENT PLAN Special Conditions

PROJECT #	14-129
QUOTE #	*****
DRAWN BY:	CMB
CHECKED BY:	-
CONTRACT REP:	JRD
DRAWING SCALE:	1/4"=1'-0"
SHEET NUMBER:	K.501