

4 FOURTH FLOOR PLAN  
A0.2 1/16" = 1'-0"

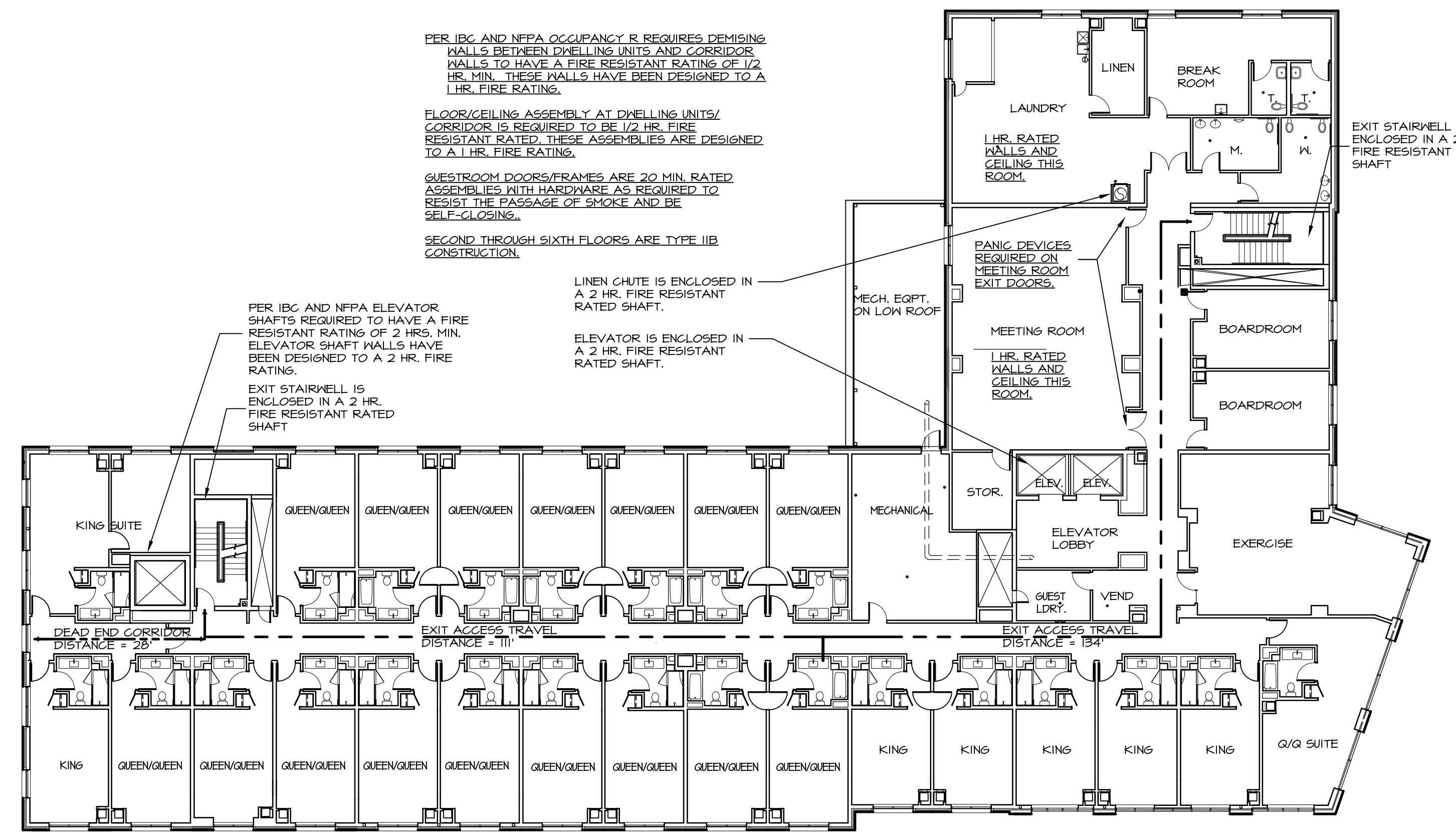

2 SECOND FLOOR PLAN  
A0.2 1/16" = 1'-0"

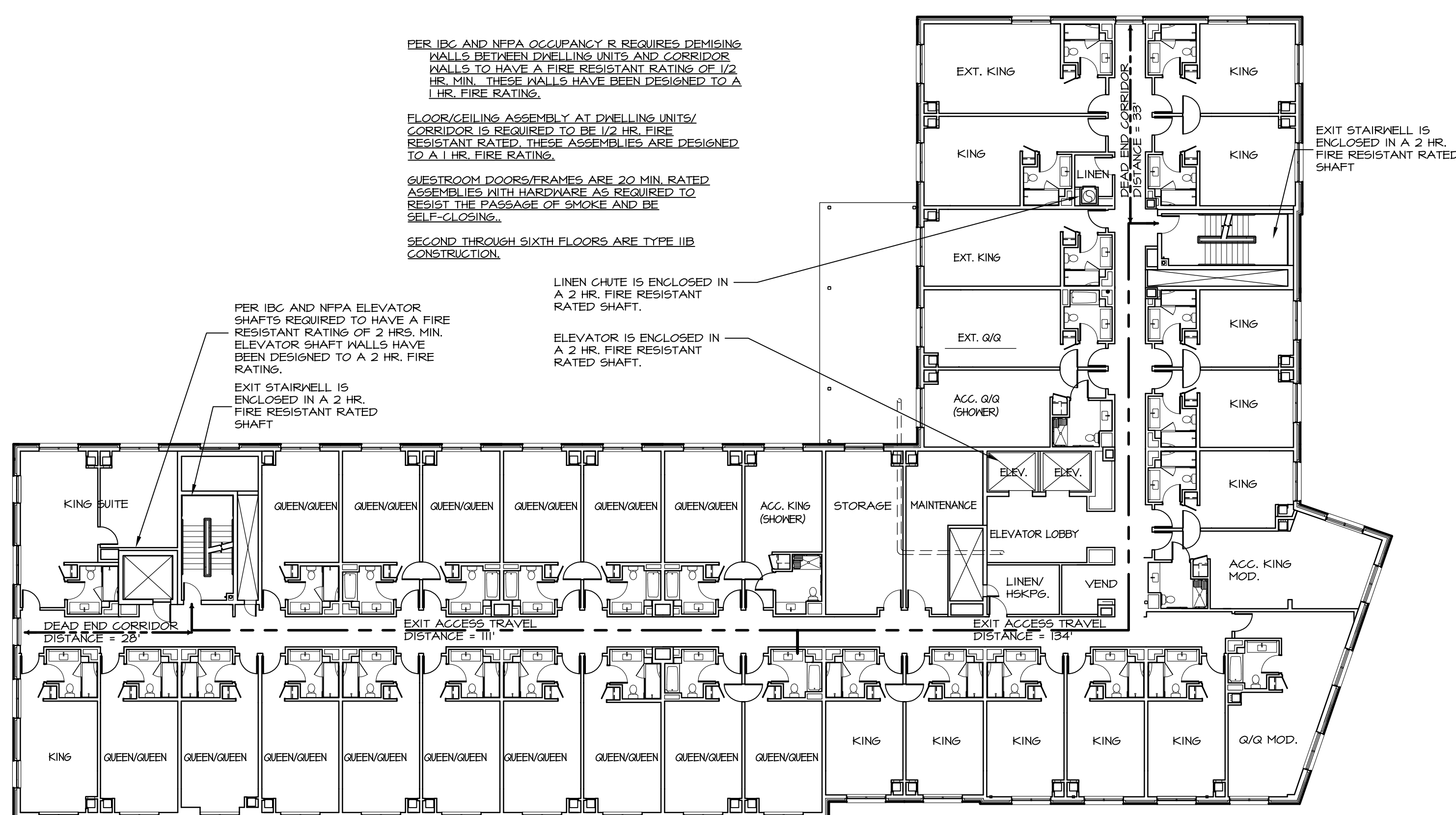

3 THIRD FLOOR PLAN  
A0.2 1/16" = 1'-0"

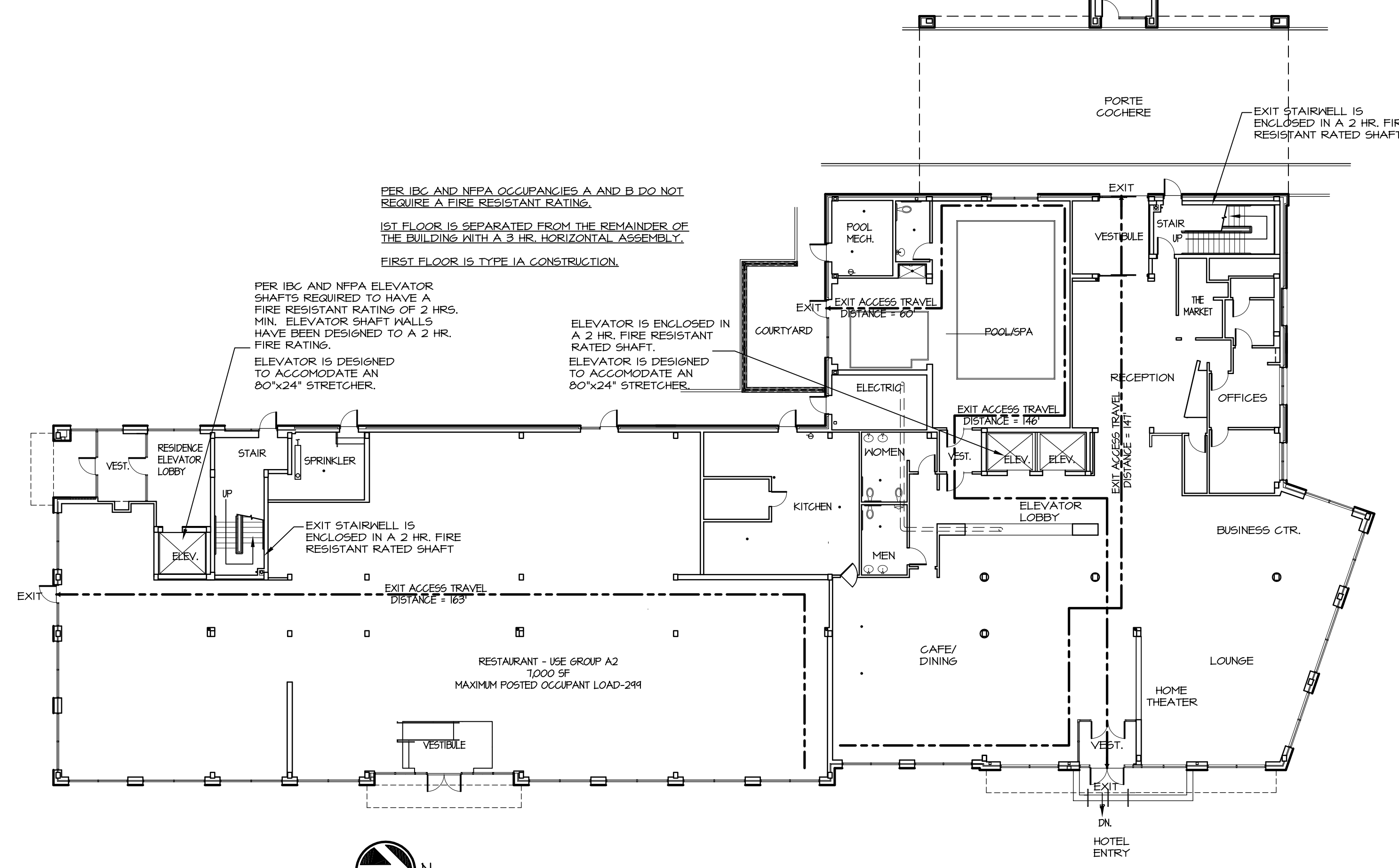

1 FIRST FLOOR PLAN  
A0.2 1/16" = 1'-0"



DATE	REVISION SCHEDULE
06-04-13	REVISION DESCRIPTION
06-18-13	ADDED NOTE FOR GUESTROOM DOOR RATINGS

**COPECEE**  
CONSTRUCTION CORPORATION  
11 CORPORATE DRIVE, BELMONT NH 03220  
PHONE (603) 527-9090 FAX (603) 527-9191

CODE PLANS  
INFORMATION

PROJECT: COMMERCIAL & MAPLE STREET  
MIXED USE DEVELOPMENT  
PORTLAND, ME

DATE: 05-09-13  
SCALE: SEE PLAN  
DRAWN BY: KPH  
SHEET: A0.2