

REFLECTED CEILING PLAN LEGEND

- 2'x2' REVEALED EDGE SMOOTH FACE SUSPENDED ACOUSTICAL CEILING TILE AND WHITE PAINTED METAL GRID UNLESS NOTED OTHERWISE
- 2'x4' SQUARE EDGE SMOOTH FACE SUSPENDED ACOUSTICAL CEILING TILE AND PAINTED METAL GRID. COLOR AS NOTED
- GYPSUM WALL BOARD WITH SMOOTH FINISH
- GYPSUM WALL BOARD WITH TEXTURED FINISH
- EXHAUST FAN GRILLE
- RETURN AIR GRILLE
- SUPPLY AIR DIFFUSER
- RECESSED DOWNLIGHT
- FLUORESCENT STRIP LIGHT
- 2'x2' RECESSED FLUORESCENT LIGHT WITH PRISMATIC LENS
- 2'x4' RECESSED FLUORESCENT LIGHT WITH PRISMATIC LENS
- PENDANT FIXTURE
- WALL WASHER RECESSED FIXTURE
- SURFACE MOUNTED FIXTURE
- WALL MOUNTED FIXTURES
- FLEXIBLE SUSPENDED LIGHT TRACK
- TRACK MOUNTED FIXTURE
- STRAIGHT LIGHT TRACK
- LINEAR RECESSED WALL WASHER
- DECORATIVE LIGHT FIXTURES
- LINEAR DIFFUSERS
- COMBINATION EXHAUST FAN/LIGHT UNIT

CEILING TYPE ABBREVIATIONS

- TYPE 1 = (1) LAYER OF 5/8" GYP. BD. 7/8" 25 GA. METAL FURRING CHANNELS AT 24" O.C. SUSPENDED W/ 12 5/16 HANGER WIRE FROM STEEL ROOF DECK. WHERE REQUIRED PROVIDE 1 1/2" 16 GA. COLD ROLLED CHANNELS SPACED 48" O.C. SUSPENDED W/ 12 5/16 HANGER WIRE FROM STEEL FLOOR DECK. TYPICAL LOCATIONS INCLUDE 6TH FLOOR RESIDENCE CEILING.
- TYPE 2 = NON-RATED S.A.C.T. SUSPENDED HANGER WIRE FROM STEEL ROOF DECK. TYPICAL LOCATIONS INCLUDE 6TH FLOOR PUBLIC CORRIDORS.
- TYPE 3 = NON-RATED SUSPENDED ACOUSTICAL CEILING SYSTEM SUSPENDED AT CEILING HGT. SHOWN ON RCP PLANS; (1) LAYER OF 5/8" GYP. BD. ON 25 GA. METAL FURRING CHANNELS @ 24" O.C. WIRED TO FLOOR JOISTS W/ 18 5/16 HANGER WIRE (DBL. STRAND); (3 HR. FIRE-RATED UL. ASSEMBLY 6512) TYPICAL LOCATIONS INCLUDE: HOTEL KITCHEN, OFFICES.
- TYPE 4 = (2) LAYERS OF 5/8" GYP. BD.; (1) LAYER OF 1/2" 440 SOUND BARRIER BY HOMASOTE OR EQUAL; 25 GA. 7/8" FURRING CHANNELS AT 24" O.C. TIED TO 1 1/2" 16 GA. COLD ROLLED MAIN CHANNELS AT 24" O.C. SUSPENDED W/ 12 5/16 HANGER WIRE FROM RSIC-DC04 SOUND ISOLATION CLIPS BY PAC INTERNATIONAL ATTACHED TO METAL FLOOR DECK; 6" LAYER OF THERMAFIBER SOUND ATTENUATION FIRE BLANKETS (SAFB) OR EQUAL, FITTED TIGHTLY IN PLACE (NO VOIDS); (3 HR. FIRE-RATED UL. ASSEMBLY 6512) TYPICAL LOCATIONS INCLUDE RESTAURANT/KITCHEN AT RENTAL SPACE.
- TYPE 5 = (1) LAYER 5/8" GYP. BD. ON 25 GA. METAL FURRING CHANNELS @ 24" O.C. TIED TO 1 1/2" 16 GA. COLD ROLLED MAIN CHANNELS AT 48" O.C. SUSPENDED AT CEILING HGT. SHOWN ON RCP PLANS; (1) LAYER OF 5/8" GYP. BD. ON 25 GA. METAL FURRING CHANNELS @ 24" O.C. WIRED TO FLOOR JOISTS W/ 18 5/16 HANGER WIRE (DBL. STRAND); (3 HR. FIRE-RATED UL. ASSEMBLY 6512) TYPICAL LOCATIONS INCLUDE: POOL LOBBY, CAFE LOUNGE, LOBBY RESTROOMS.
- TYPE 6 = "510 THERM CLASSIC SYSTEM" OR EQUAL EIF SYSTEM W/ 1" RIGID EPS INSULATION; (1) LAYERS OF 5/8" DENSGLASS OR EQUAL 7/8" 25 MSG GALV. STEEL FURRING CHANNELS 16" O.C. 1 1/2" 16 GA. COLD ROLLED CHANNELS SPACED 24" O.C. SUSPENDED W/ 12 5/16 HANGER WIRE FROM RSIC-DC04 SOUND ISOLATION CLIPS BY PAC INTERNATIONAL ATTACHED TO FRAMING ABOVE AT 48" O.C. MAX; 6" (R-11 MIN) LAYER OF FIBERGLASS BATT FITTED TIGHTLY IN PLACE (NO VOIDS); (3 HR. FIRE-RATED UL. ASSEMBLY 6512) @ 1/3 OF JOISTS ABOVE THIS SYSTEM) TYPICAL LOCATIONS INCLUDE: PORTE COCHERE CEILING.
- TYPE 7 = (1) LAYER OF 5/8" GYP. BD. ON 25 GA. METAL FURRING CHANNELS @ 24" O.C. WIRED TO FLOOR JOISTS W/ 18 5/16 HANGER WIRE; (3 HR. FIRE-RATED UL. ASSEMBLY 6512) TYPICAL LOCATIONS INCLUDE STAIR B @ 1ST FLOOR.
- TYPE 8 = (1) LAYER OF 5/8" GYP. BD.; 25 GA. GALV. 7/8" DEEP METAL FURRING CHANNEL AT 24" O.C. SECURED W/ DOUBLE STRAND OF 18 5/16 GALV. HANGER WIRE TO 1 1/2" 16 GA. COLD ROLLED CHANNELS SPACED 48" O.C. SUSPENDED W/ 12 5/16 HANGER WIRE FROM STEEL ROOF JOIST (1 HR. FIRE-RATED UL. ASSEMBLY 6514)
- TYPE 9 = (1) LAYER OF 5/8" GYP. BD.; 25 GA. METAL FURRING CHANNELS AT 24" O.C. FASTENED TO STEEL STRUCTURE. (1 HR. RATED UL. ASSEMBLY 6501) TYPICAL LOCATIONS INCLUDE: GUESTROOM CORRIDOR SOFFITS, GUESTROOM BATHROOM CEILING.
- TYPE 10 = NOT USED.
- TYPE 11 = ACRYLIC SPRAY FINISH ON (1) LAYER OF 5/8" EXTERIOR GYP. BD.; 25 GA. GALV. 7/8" DEEP METAL FURRING CHANNEL AT 24" O.C. SECURED W/ DOUBLE STRAND OF 18 5/16 GALV. HANGER WIRE TO 1 1/2" 16 GA. COLD ROLLED CHANNELS SPACED 48" O.C. SUSPENDED W/ 12 5/16 HANGER WIRE FROM STEEL ROOF JOIST (1 HR. FIRE-RATED UL. ASSEMBLY 6514)
- TYPE 12 = (1) LAYER OF 5/8" GYP. BD.; 25 GA. METAL FURRING CHANNELS AT 24" O.C. FASTENED TO STEEL STRUCTURE. (1 HR. RATED UL. ASSEMBLY 6501) TYPICAL LOCATIONS INCLUDE: GUESTROOM CEILING, LAUNDRY ROOM.
- TYPE 13 = NOT USED
- TYPE 14 = NON-FIRE-RATED STAINED STRIP WOOD CEILING FASTENED THROUGH (1) LAYER OF 5/8" GYP. BD.; 25 GA. METAL FRAMING AT 24" O.C. SUSPENDED TO STRUCTURE ABOVE, WITH TYPE 7 CEILING ASSEMBLY ABOVE. TYPICAL LOCATIONS INCLUDE RESIDENCE ENTRY LOBBY.
- TYPE 15 = NON-FIRE-RATED STAINED STRIP WOOD CEILING FASTENED THROUGH (1) LAYER OF 5/8" GYP. BD.; 25 GA. METAL FRAMING AT 24" O.C. SUSPENDED TO STRUCTURE ABOVE, WITH TYPE 7 CEILING ASSEMBLY ABOVE. TYPICAL LOCATIONS INCLUDE POOL CEILING, CAFE, TV LOUNGE, THE MARKET.
- U.S.S. - UNDERSIDE OF STRUCTURE

CEILING NOTES

1. WHERE SPRINKLER HEADS OCCUR IN AREAS WITH SUSPENDED CEILINGS, THEY ARE TO BE CENTERED ON CEILING TILES
2. COORDINATE MECHANICAL GRILLE LOCATIONS WITH LOCATION OF ALL ELECTRICAL ITEMS
3. PROVIDE 3/4" PLYWOOD COVERED WITH GMB FOR CURTAIN TRACK ATTACHMENT (TYPICAL). EXTEND 8" MIN. BEYOND JAMB EACH SIDE.
4. VAPOR BARRIER AT POOL AREA:
 - A. INDOOR POOL ENCLOSURES REQUIRE EXTREME ATTENTION TO DETAIL TO INSURE VAPOR BARRIER IS CONTINUOUS AND HAS NO BREACHES. ANY STAPLES, NAILS OR OTHER PENETRATING FASTENERS THROUGH THE VAPOR BARRIER MUST BE TAPED OVER WITH BARRIER TAPE. ANY JOINTS TO OTHER MATERIALS MUST BE FULLY SEALED WITH APPROPRIATE TAPE OF CAULKING. OPERCEE SHALL COORDINATE SYSTEM TO SEAL PENETRATIONS CREATED BY SHEATHING ATTACHMENT, SUCH AS INSTALLING BITUMENE STRIPS OVER STUDS OR STRAPPING, FAILURE TO CREATE CONTINUOUS BARRIER MAY CAUSE RAPID DETERIORATION OF STRUCTURE BEYOND.
 - B. PROVIDE 10 MIL POLY VAPOR BARRIER, INSTALLED AS NOTED ABOVE, AT ALL WALLS AND CEILINGS AT POOL ROOM, POOL TOILET AND POOL MECHANICAL ROOM.
 - C. VAPOR BARRIER AT CEILING IS TO BE AT LOWEST CEILING SYSTEM, NOT AT FIRE-RATED CEILING MEMBRANE ABOVE.

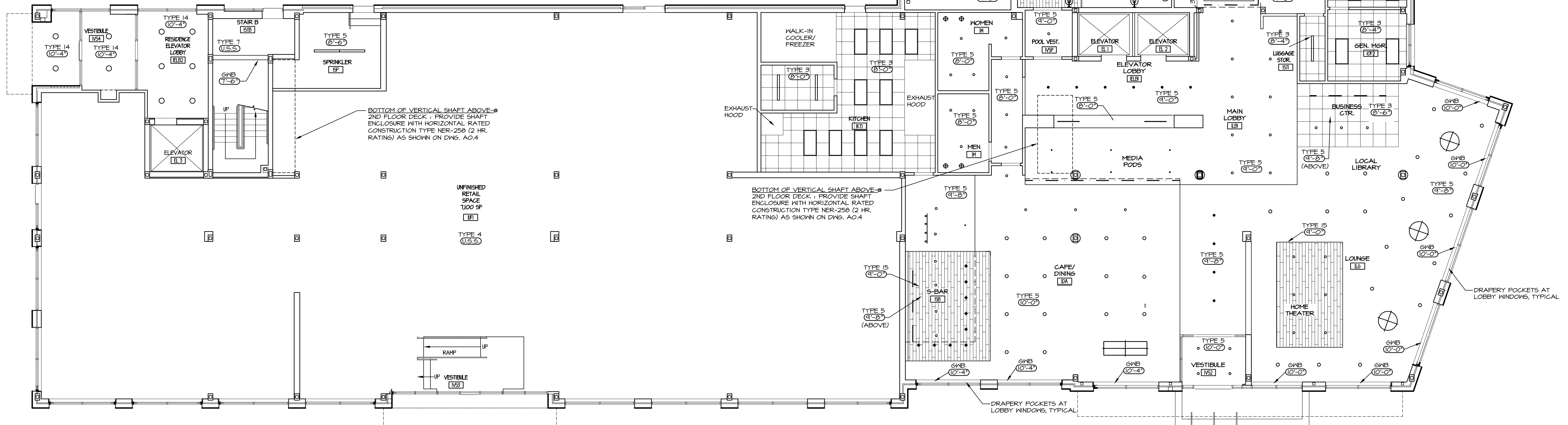

REVISION SCHEDULE	
DATE	REVISION DESCRIPTION
05-15-13	REVISED CEILING HEIGHTS, TYPES AND LIGHTING LAYOUTS. ADDED SHAFT BOTTOM CLOSURE AT STAIR A.
06-03-13	ADDED NOTES REGARDING VAPOR BARRIER AT POOL AREA. DELETED RECESSED CAN LIGHTS AT POOL AREA/ADDED WALL MTD. LIGHTS.

COPECEE
 CONSTRUCTION CORPORATION
 11 CORPORATE DRIVE, BELMONT, NH 03220
 PHONE (603) 527-9090 FAX (603) 527-9191

FIRST FLOOR
 CEILING PLAN

PROJECT: COMMERCIAL & MAPLE STREET
 MIXED USE DEVELOPMENT
 PORTLAND, ME

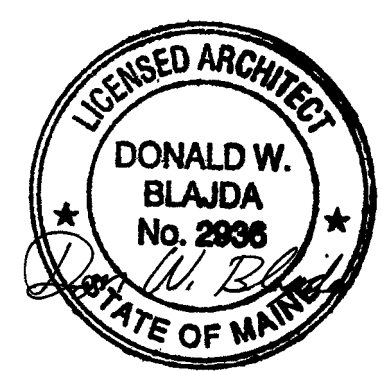

1 FIRST FLOOR CEILING PLAN
 A22 1/8" = 1'-0"

DATE:	05-09-13
SCALE:	SEE PLAN
DRAWN BY:	KPH
A22	
SHEET:	