

CONSTRUCTION SEQUENCING:

1. RELOCATE PEDESTRIAN DETOUR SIGN ACROSS HIGH STREET
2. ADJUST & INSTALL ADDITIONAL CHAIN LINK FENCE
3. INSTALL NEW STABILIZED CONSTRUCTION ENTRANCE/EXIT
4. INSTALL CONCRETE WASHOUTS AS NEEDED
5. CONSTRUCT FOUNDATION FOOTING CONSTRUCTION
6. CONSTRUCT FOUNDATION WALL CONSTRUCTION
7. CONSTRUCT INTERIOR FOUNDATIONS
8. CONSTRUCT INTERIOR UNDER-SLAB PLUMBING
9. CONSTRUCT PERIMETER DRAINAGE, WATER PROOF AND BACKFILL FOUNDATION

GENERAL NOTES:

1. DUST SHALL BE KEPT TO A MINIMUM. THE SITE SUBCONTRACTOR SHALL SPRAY WATER FOR DUST CONTROL. IF NECESSARY CALCIUM CHLORIDE CAN ALSO BE UTILIZED.
2. VIBRATION MONITORING SHALL BE IMPLEMENTED FOR ADJACENT STRUCTURES BY SEISMOGRAPHS RECORDINGS DURING ANY LEDGE BLASTING, HAMMERING, AND REMOVAL. A POST-MONITORING REPORT SHALL BE GENERATED.
3. NOISES CREATED BY CONSTRUCTION AND MAINTENANCE ACTIVITIES BETWEEN 7:00 AM AND 10:00 PM ARE EXEMPT FROM THE MAXIMUM PERMISSIBLE SOUND LEVELS SET FORTH IN SUBSECTION (b)3 OF PERFORMANCE STANDARDS SECTION 14-230.5.
4. THE HOURS OF CONSTRUCTION ARE 7:00 A.M. TO 7:00 P.M.. HOWEVER, IF IT IS NECESSARY TO PERFORM CONSTRUCTION ACTIVITIES OUTSIDE THE AFOREMENTIONED HOURS, THE GENERAL CONTRACTOR SHALL REQUEST PERMISSION FROM THE DEPARTMENT OF PUBLIC SERVICES AND ANY NOISE BETWEEN THE HOURS OF 10:00 PM OF ONE (1) DAY AND 7:00 AM OF THE FOLLOWING DAY SHALL NOT EXCEED (50) dBA.
5. THE GENERAL CONTRACTOR SHALL CONTACT IN ADVANCE THE ADJACENT LAND OWNERS BY EMAIL, TELEPHONE, OR IN PERSON TO NOTIFY OF ANY ACTIVITIES THAT MAY HAVE ADVERSE IMPACTS ON THEM.
6. TEMPORARY FENCE TO BE RELOCATED PERIODICALLY 10' TO 15' ON TO FOUNDRY LANE TO ACCOMMODATE WORK ON THE NORTH SIDE OF THE SITE.
7. TRUCKS SHALL UTILIZE WEST COMMERCIAL STREET WHEN TRAVELING TO AND FROM THE SITE.
8. THE CURRENT PAVEMENT MARKINGS FOR THE DIAGONAL PARKING ALONG COMMERCIAL SHALL BE "BLACKED OUT" WITH PAINT.
9. KNOX LOCKS SHALL BE INSTALLED ON ALL GATES TO ALLOW THE FIRE DEPARTMENT ACCESS TO THE SITE.

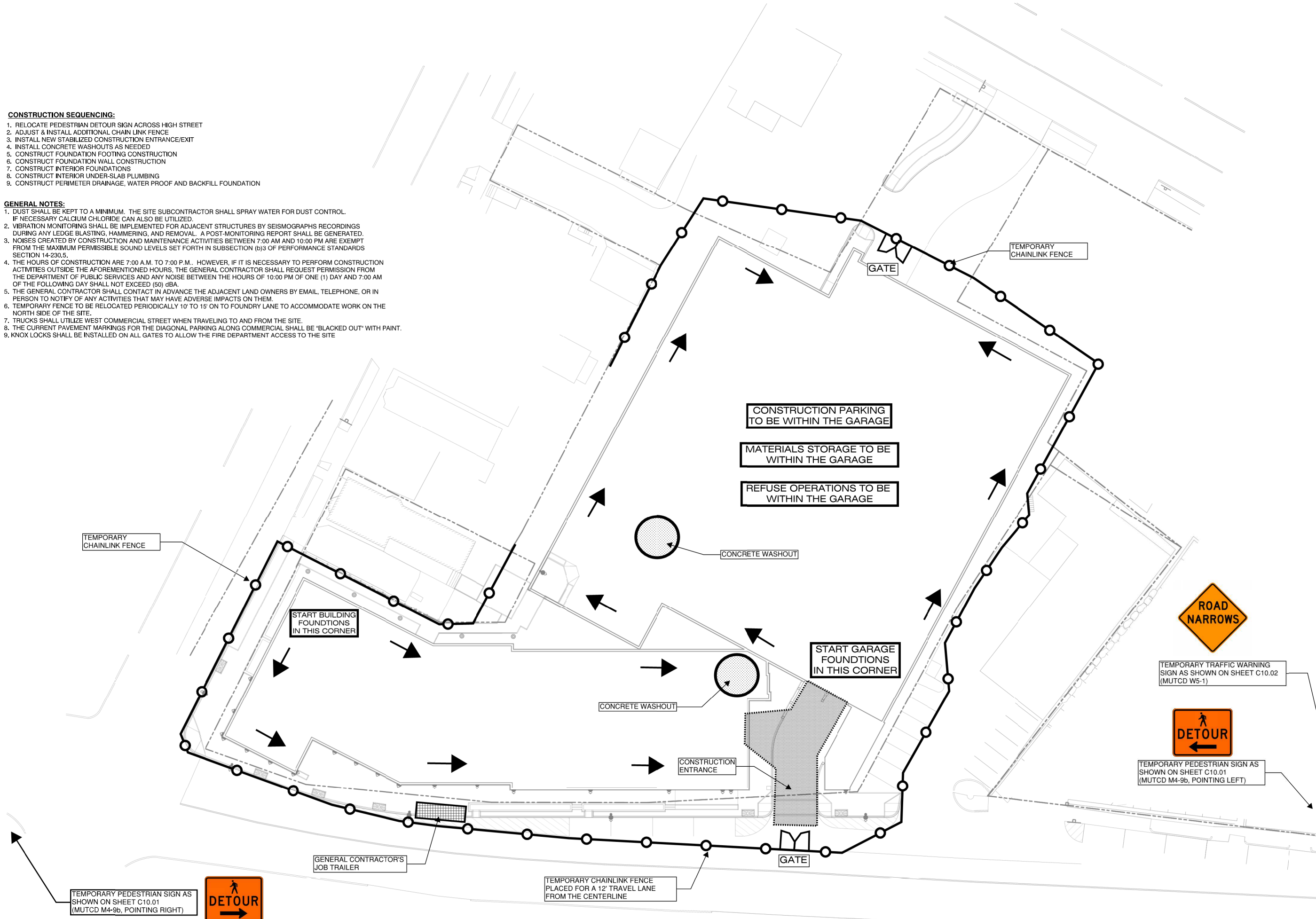

REVISION:

ISSUED: 8-14-15
SITE PLAN REVIEW

project architect: KK
drawn by: BS

CONSTRUCTION MANAGEMENT FOUNDATIONS

sheet number:
C10.02