

Tuesday, May 10, 2016 11:55:31 AM

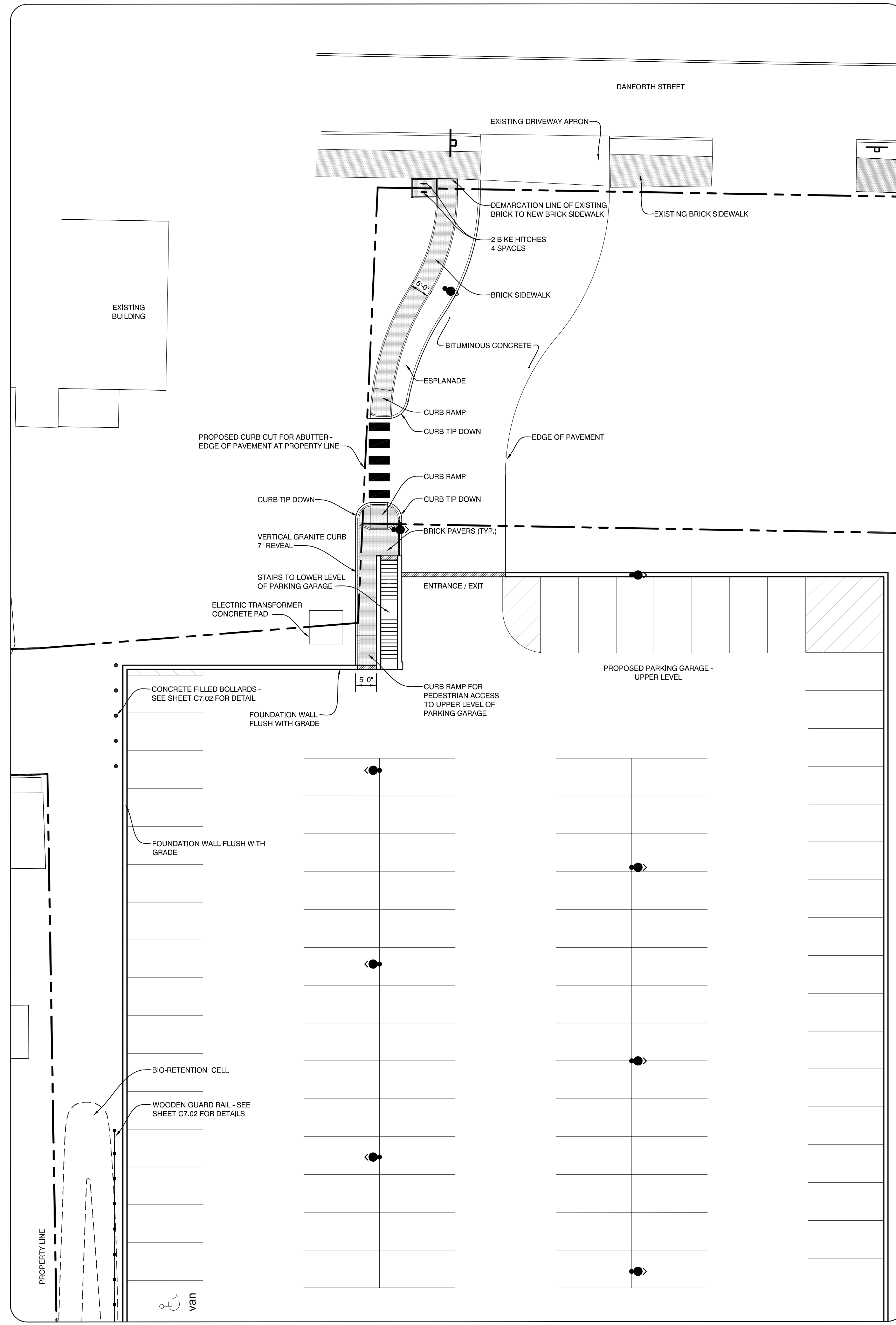

4 HARDSCAPE PLAN - PARKING GARAGE
1/16" = 1'-0"

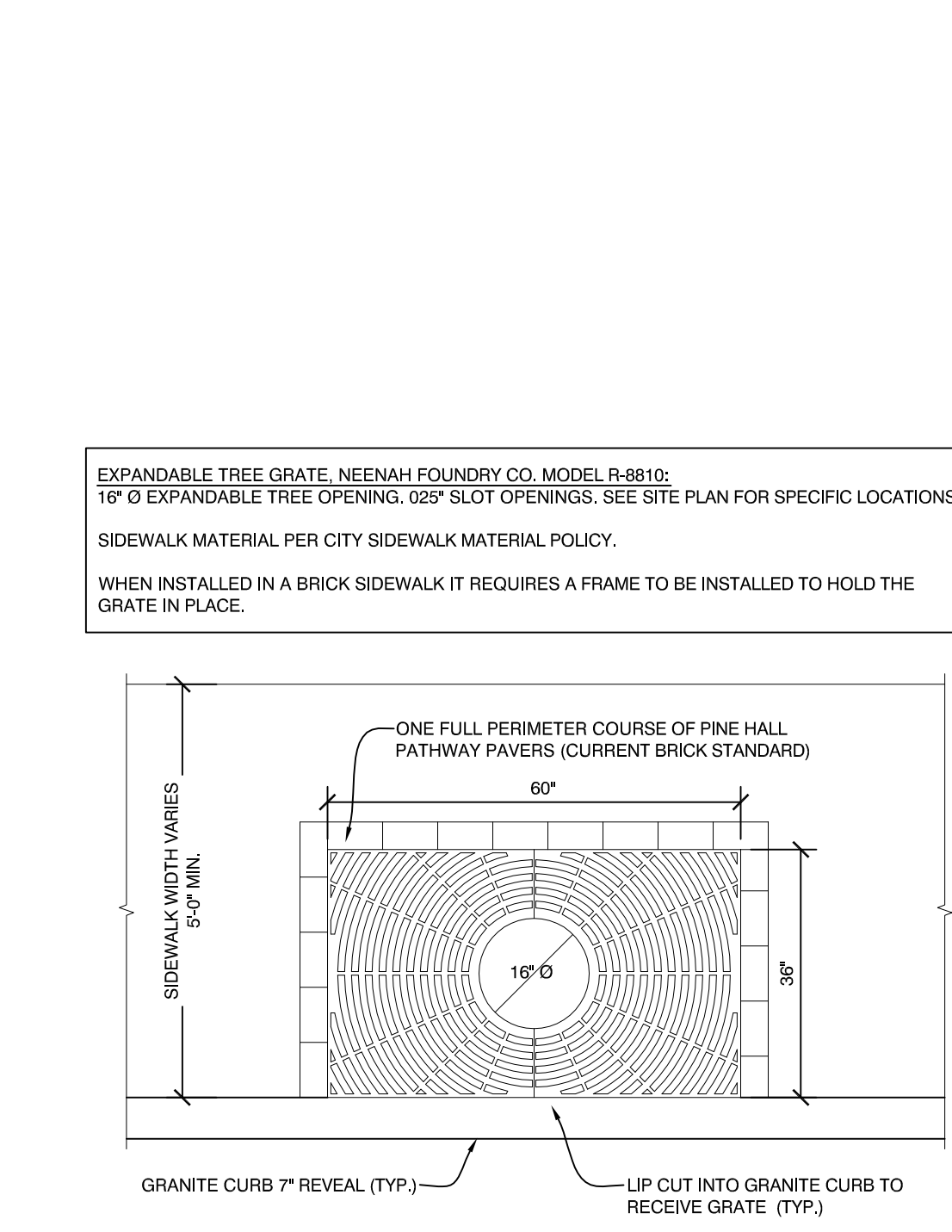

8 EXPANDABLE TREE GRATE - PLAN
1/2" = 1'-0"

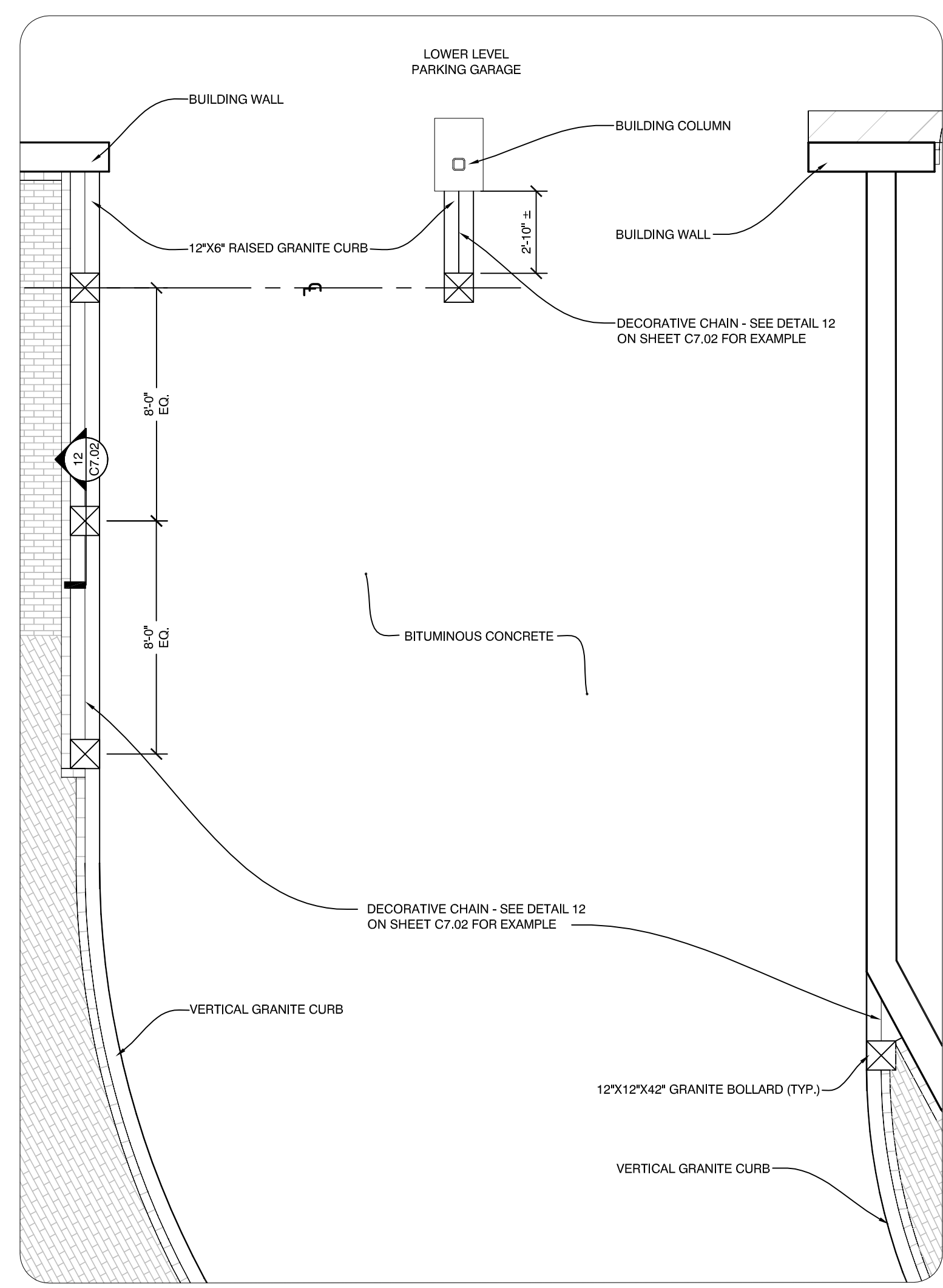

3 GRANITE BOLLARD - PLAN
1/4" = 1'-0"

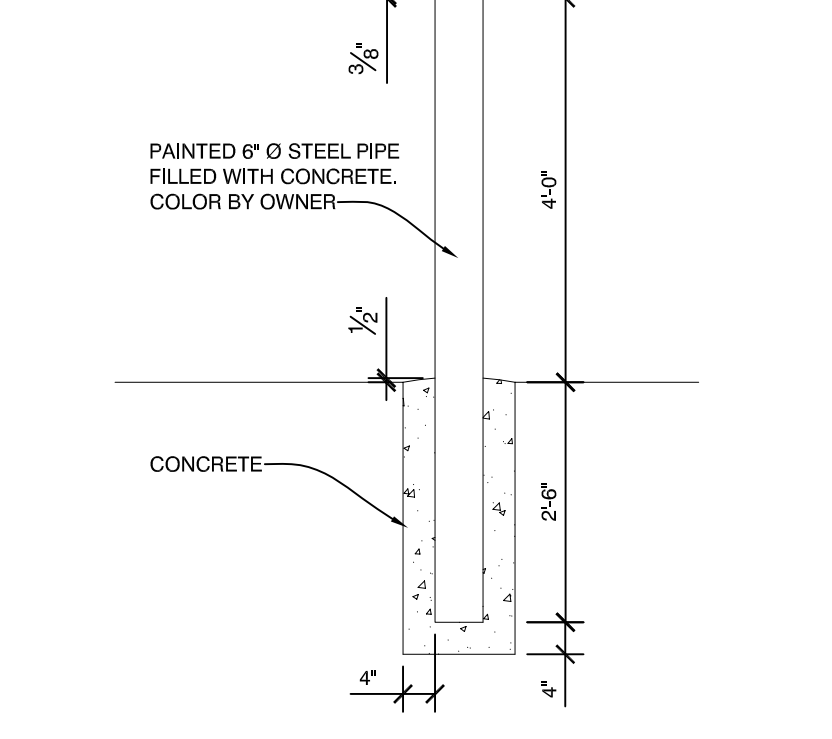

11 CONCRETE BOLLARD - SECTION
1/2" = 1'-0"

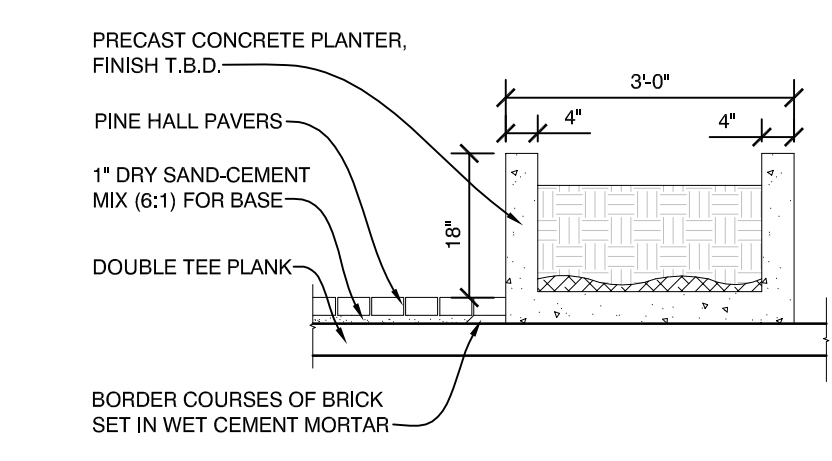

7 PATIO PLANTER - SECTION
1/2" = 1'-0"

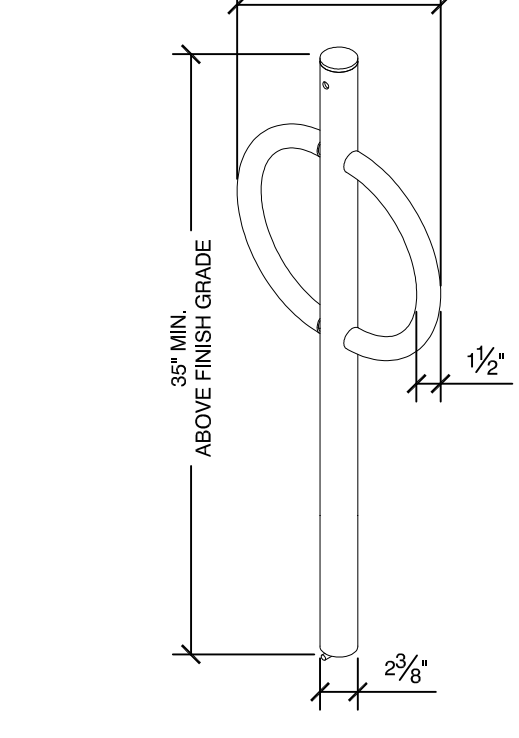

5 BIKE HITCH - ELEVATION & SECTION
NOT TO SCALE

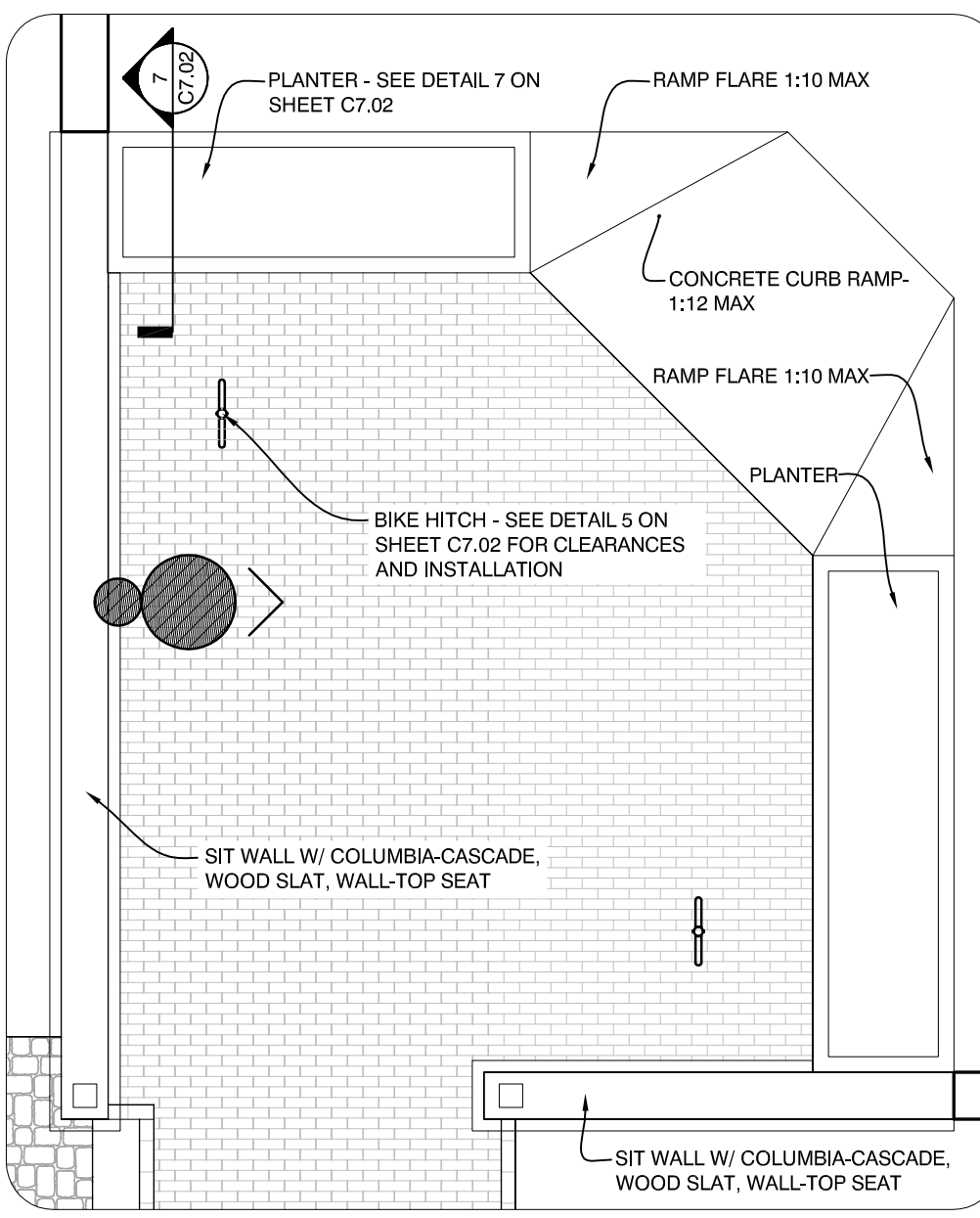

2 PATIO AT PARKING GARAGE - PLAN
1/4" = 1'-0"

12 GRANITE BOLLARD - SECTION & EXAMPLE
1/2" = 1'-0"

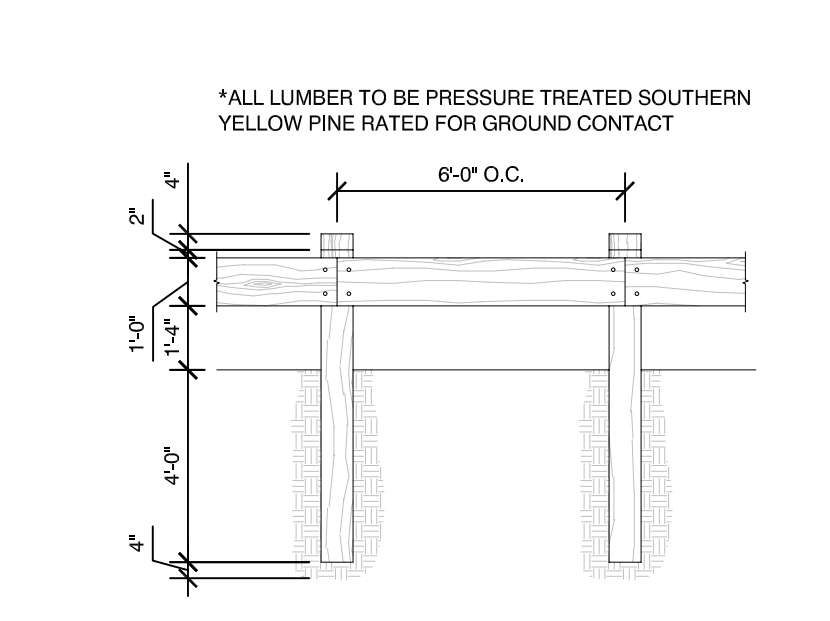

10 GUARDRAIL - ELEVATION
1/4" = 1'-0"

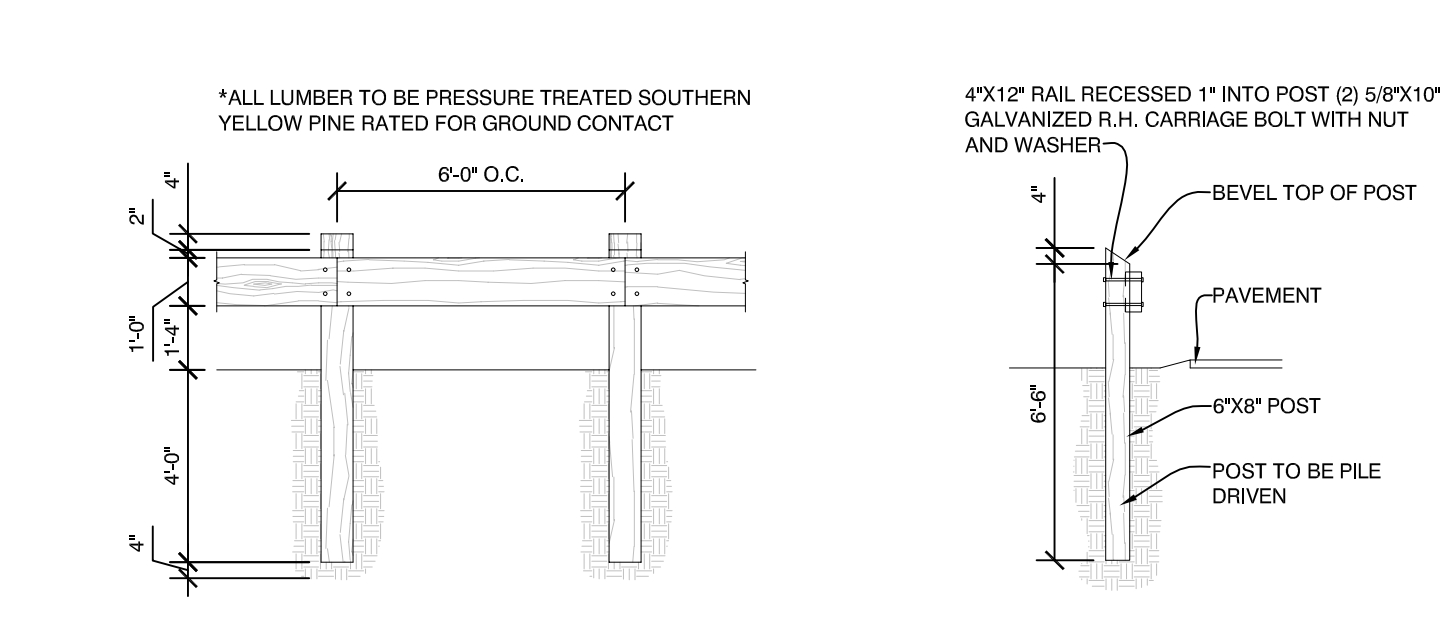

9 GUARDRAIL - SECTION
1/4" = 1'-0"

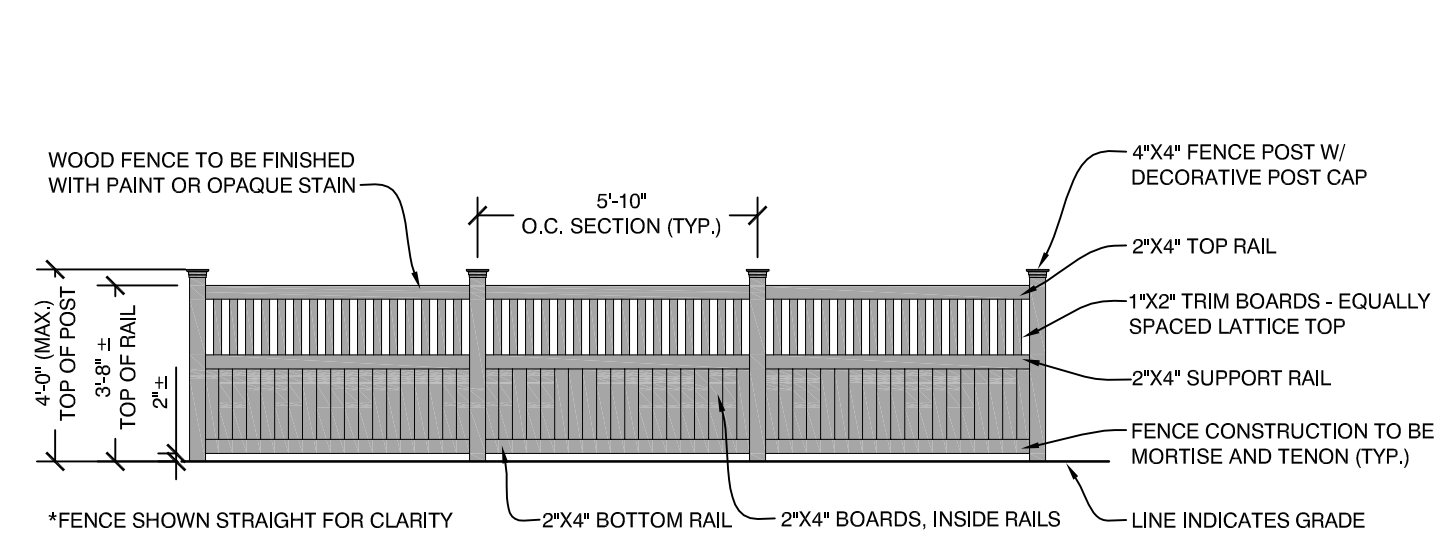

6 WOOD FENCE - ELEVATION
1/4" = 1'-0"

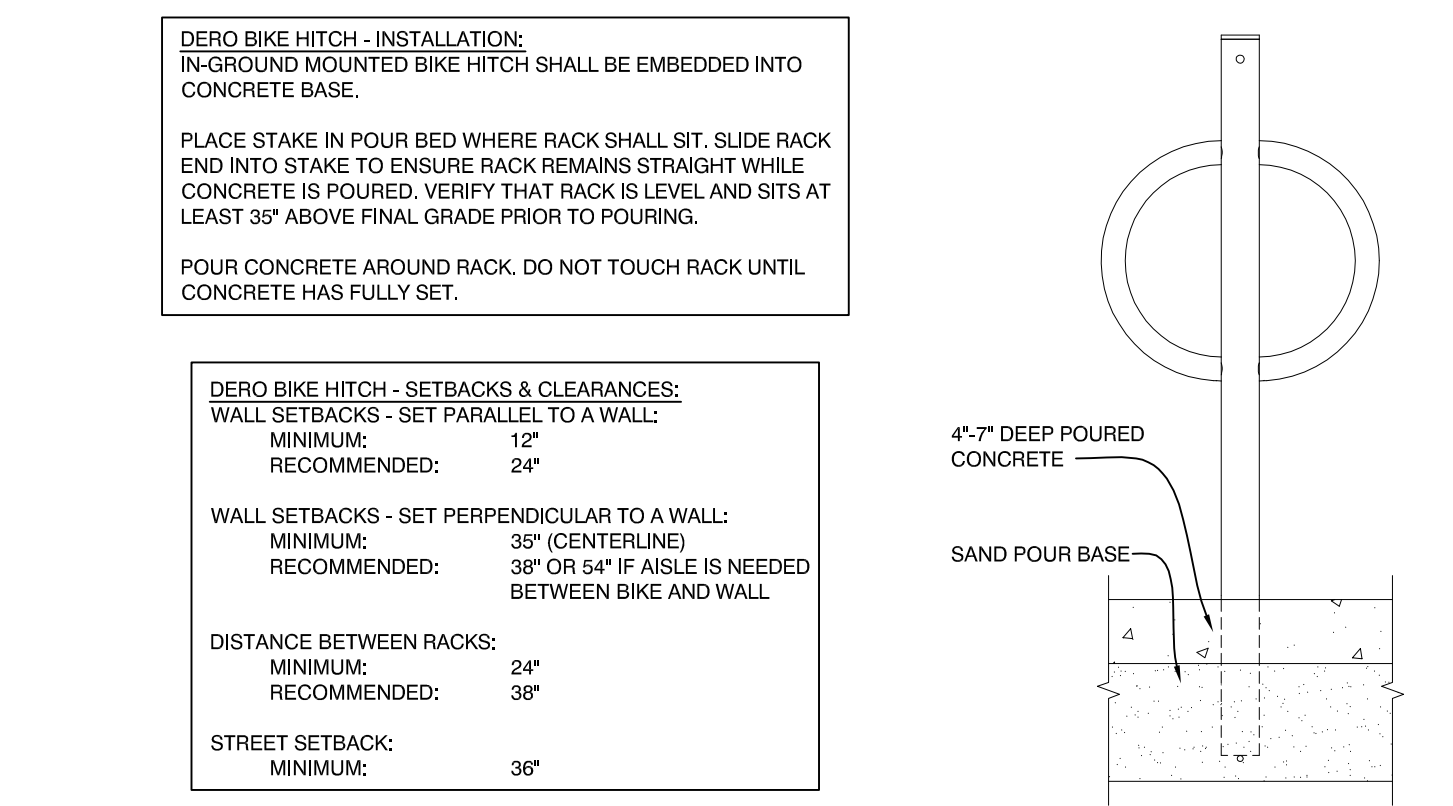

5 BIKE HITCH - INSTALLATION. IN-GROUND MOUNTED BIKE HITCH SHALL BE EMBEDDED INTO CONCRETE BASE. PLACE STAKE IN POUR BED WHERE RACK SHALL SIT. SLIDE RACK END INTO STAKE TO ENSURE RACK REMAINS STRAIGHT WHILE CONCRETE IS POURED. VERIFY THAT RACK IS LEVEL AND SITS AT LEAST 35\"/>

DERO BIKE HITCH - SETBACKS & CLEARANCES: WALL SETBACKS - SET PARALLEL TO A WALL: MINIMUM: 24\"/>

WALL SETBACKS - SET PERPENDICULAR TO A WALL: MINIMUM: 35\"/>

DISTANCE BETWEEN RACKS: MINIMUM: 24\"/>

STREET SETBACK: MINIMUM: 36\"/>

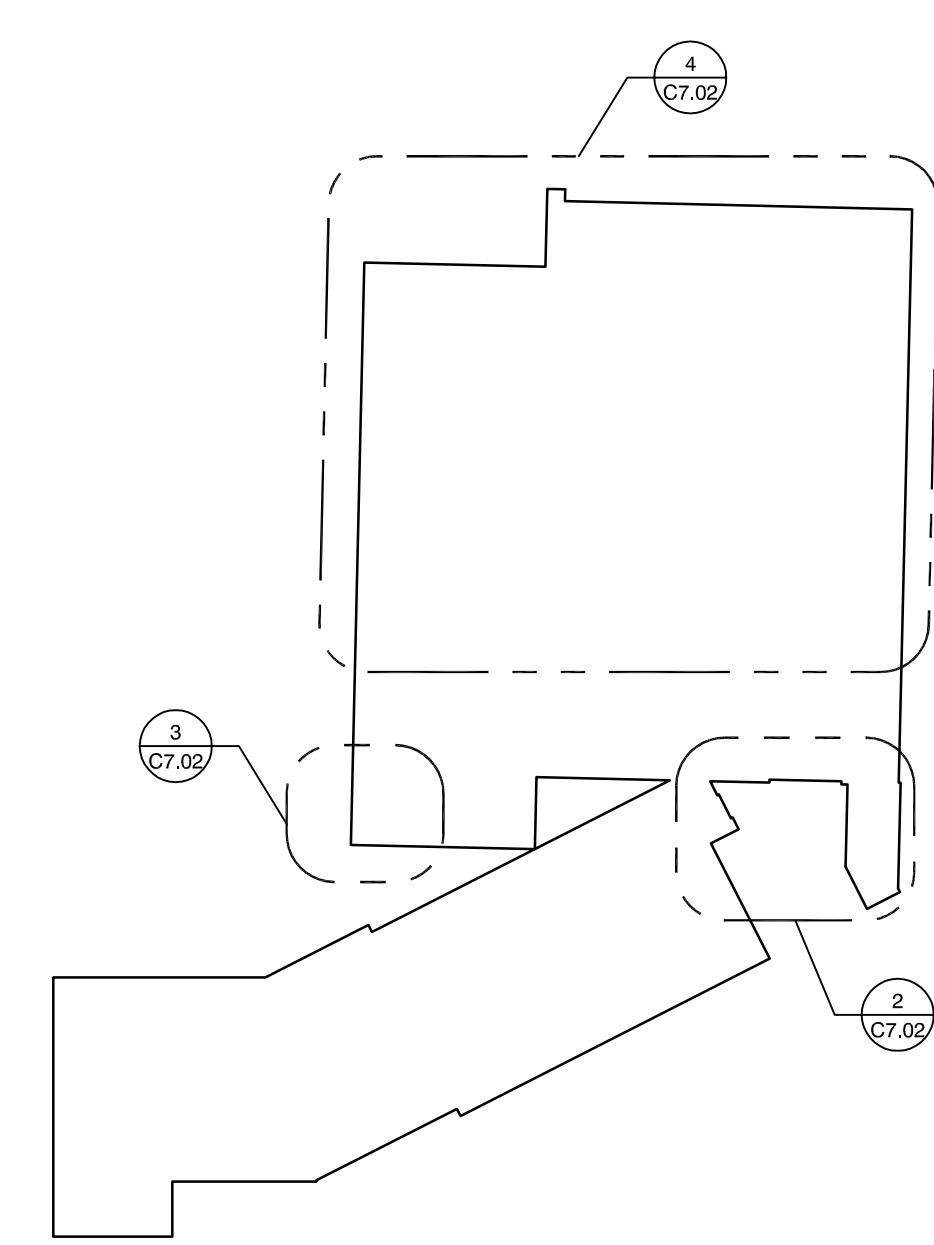

1 HARDSCAPE KEY PLAN
1/64" = 1'-0"

REVISION:

| |
|--|
| 11/16/15 - SITE PLAN REVIEW COMMENTS |
| 03/10/16 - TRANSFORMER LOCATION |
| 05/02/16 - CLARIFIED WOOD FENCE |
| 05/10/16 - CLARIFIED WOOD FENCE FINISH |

ISSUED:

| |
|------------------------------------|
| 08/14/15 - SITE PLAN REVIEW |
| 11/17/15 - SITE PLAN RESUBMISSION |
| 03/11/16 - FINAL PLAN RESUBMISSION |

project architect: KAK
drawn by: CDR

HARDSCAPE PLAN & DETAILS

sheet number:

C7.02