

Copyright © 2015 Opechee Construction Corporation  
Friday, August 14, 2015 3:32:30 PM

**CONSTRUCTION SEQUENCING:**

1. BEGIN GARAGE STEEL & PLANK ERECTION FOR AREA (1) AND CONTINUE IN NUMERICAL ORDER
2. INSTALL INTERIOR UNDER-SLAB PLUMBING AND UTILITIES WITHIN THE BUILDING
3. BEGIN BUILDING STEEL ERECTION FOR AREA (1) AND CONTINUE IN NUMERICAL ORDER

**GENERAL NOTES:**

1. DUST SHALL BE KEPT TO A MINIMUM. THE SITE SUBCONTRACTOR SHALL SPRAY WATER FOR DUST CONTROL. IF NECESSARY CALCIUM CHLORIDE CAN ALSO BE UTILIZED.
2. VIBRATION MONITORING SHALL BE IMPLEMENTED FOR ADJACENT STRUCTURES BY SEISMOGRAPHS RECORDINGS DURING ANY LEDGE BLASTING, HAMMERING, AND REMOVAL. A POST-MONITORING REPORT SHALL BE GENERATED.
3. NOISES CREATED BY CONSTRUCTION AND MAINTENANCE ACTIVITIES BETWEEN 7:00 AM AND 10:00 PM ARE EXEMPT FROM THE MAXIMUM PERMISSIBLE SOUND LEVELS SET FORTH IN SUBSECTION (b)3 OF PERFORMANCE STANDARDS SECTION 14-230.5.
4. THE HOURS OF CONSTRUCTION ARE 7:00 A.M. TO 7:00 P.M.. HOWEVER, IF IT IS NECESSARY TO PERFORM CONSTRUCTION ACTIVITIES OUTSIDE THE AFOREMENTIONED HOURS, THE GENERAL CONTRACTOR SHALL REQUEST PERMISSION FROM THE DEPARTMENT OF PUBLIC SERVICES AND ANY NOISE BETWEEN THE HOURS OF 10:00 PM OF ONE (1) DAY AND 7:00 AM OF THE FOLLOWING DAY SHALL NOT EXCEED (50) dBA.
5. THE GENERAL CONTRACTOR SHALL CONTACT IN ADVANCE THE ADJACENT LAND OWNERS BY EMAIL, TELEPHONE, OR IN PERSON TO NOTIFY OF ANY ACTIVITIES THAT MAY HAVE ADVERSE IMPACTS ON THEM.
6. THE EXISTING PAVEMENT MARKINGS FOR PARKING ALONG YORK AND HIGH STREET SHALL BE "BLACKED OUT" WITH PAINT.
7. KNOX LOCKS SHALL BE INSTALLED ON ALL GATES TO ALLOW THE FIRE DEPARTMENT ACCESS TO THE SITE.
8. SITEWORK CONSTRUCTION VEHICLES SHALL EXIT THE STABILIZED CONSTRUCTION ENTRANCE ON DANFORTH STREET.
9. SIDEWALK SNOW REMOVAL SHALL BE THE RESPONSIBILITY OF THE PROPERTY OWNER ALONG THEIR STREET FRONTAGE.
10. PROJECT DELIVERIES SHALL NOT BE SCHEDULED DURING PEAK TRAFFIC TIMES: MON THROUGH FRIDAY: 7-9AM AND 4-6PM.
11. EXISTING MONTHLY PARKING TENANTS WILL BE RELOCATED TO ALTERNATE PRIVATE LOCATIONS AND WILL NOT BE DISPLACED AS TO BURDEN PUBLIC PARKING FACILITIES/INFRASTRUCTURE.
12. REFUSE OPERATIONS WILL OCCUR WITHIN THE GARAGE.
13. ALL CONSTRUCTION PARKING WILL OCCUR WITHIN THE AREA OF THE GARAGE.
14. THE PHASING PORTION OF THE PLAN IS DIAGRAMMATIC DOES NOT REPRESENT ACTUAL PROPOSED LOCATIONS

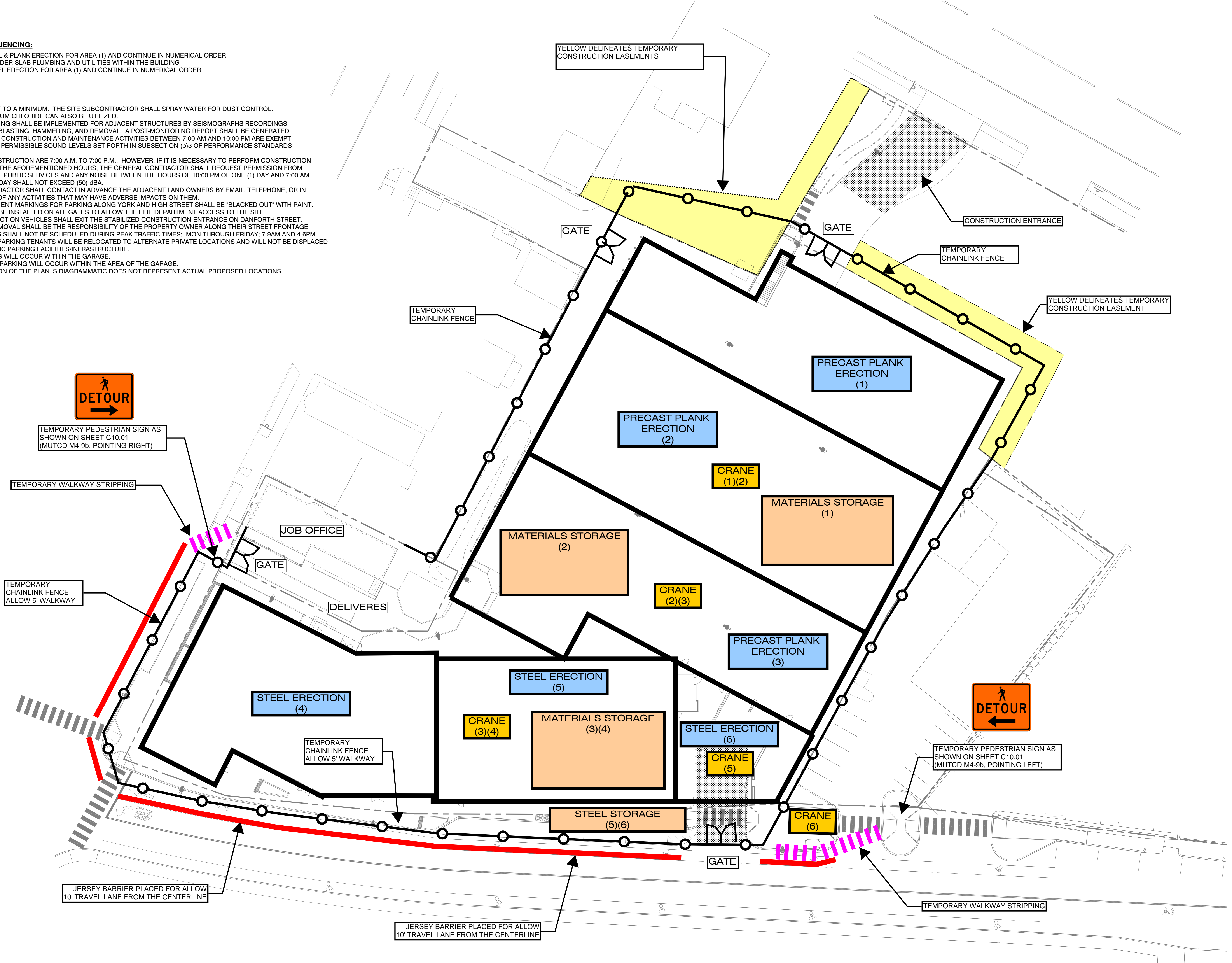

REVISION: 04-06-16 - PER CITY COMMENTS

ISSUED: 08-14-15 - SITE PLAN REVIEW  
04-06-16 - FINAL PLAN CITY APPROVAL

project architect: KK  
drawn by: BS

CONSTRUCTION  
MANAGEMENT  
STEEL & PLANK  
ERECTION

sheet number:  
**C10.03**