

OWNER:

ARCHETYPE, P.A.
ARCHITECTS

48 Union Wharf Portland, Maine 04101
(207) 772-6022 Fax (207) 772-4056

Project:

53 DANFORTH STREET
PORTLAND, ME

Scale

Date

100% CONST DOCS

1/4" = 1'-0"

15 JULY 2008

UNIT PLANS
G/H, I, J & K

E2.02

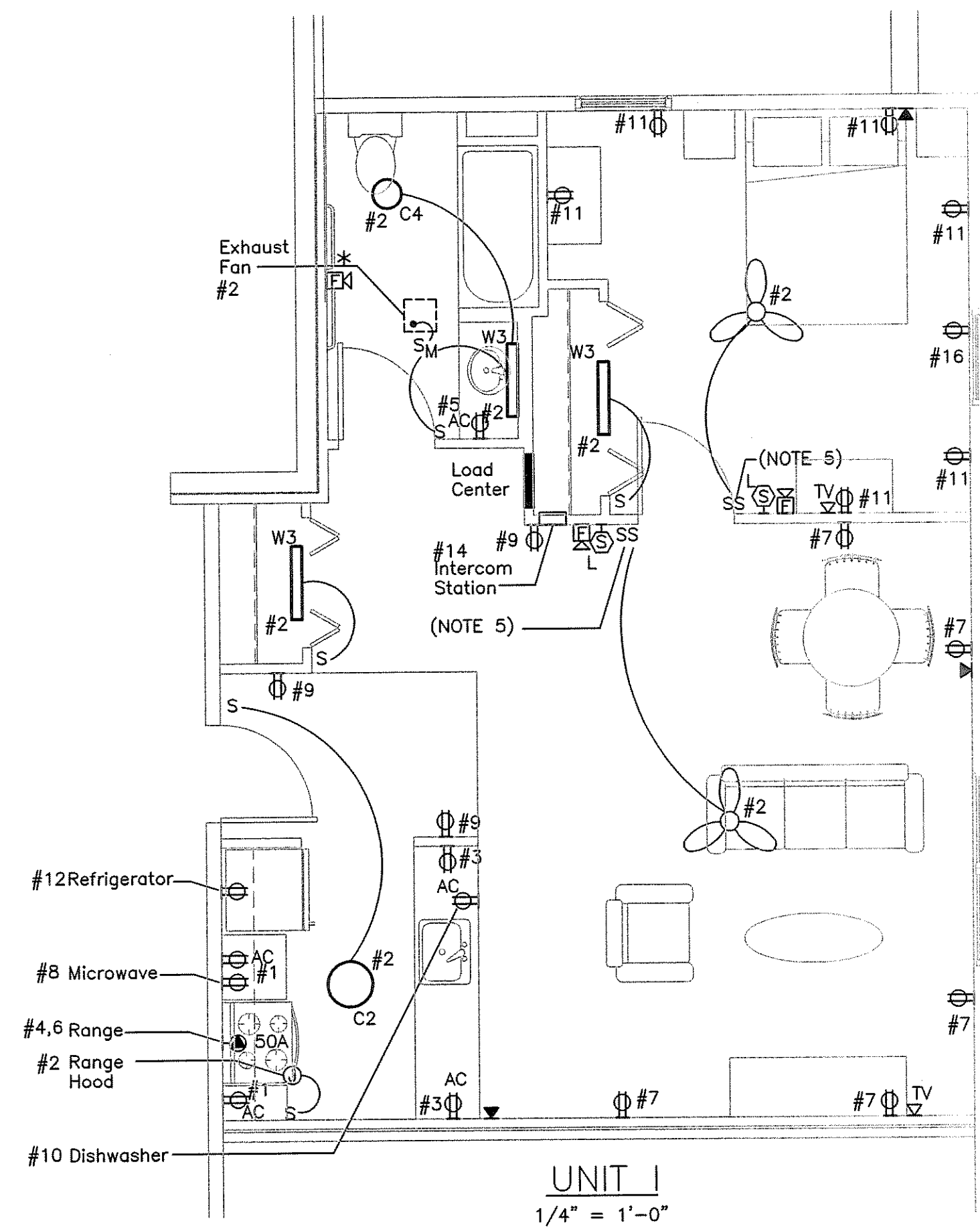

NOTES:
1. ALL 120V RECEPTACLES IN KITCHENS AND BATHROOMS SHALL BE GFCI RATED EXCEPT FOR THE DISHWASHER AND REFRIGERATOR. CIRCUITS IN INDIVIDUAL UNITS REFER TO UNIT LOAD CENTERS.
2. MINIMUM CIRCUIT BREAKER SIZE SHALL BE 20 AMP. MINIMUM WIRE SIZE SHALL BE #12 AWG.
3. CONNECT ALL RECEPTACLE CIRCUITS TO ARC-FAULT TYPE CIRCUIT BREAKERS IN LOAD CENTERS.
4. FOR RECEPTACLES INDICATED, CONNECT THE TOP HALF OF THE RECEPTACLE TO LIGHT SWITCH AS INDICATED, BOTTOM HALF SHALL REMAIN HOT AT ALL TIMES.
5. ALL RECEPTACLES SHALL BE TAMPER-PROOF.
6. SEE SHEET E2.01 FOR EXHAUST FAN WIRING DIAGRAM.
7. MOUNT THE LOAD CENTERS SO THAT THE HIGHEST OPERABLE PART IS IN NO GREATER THAN 48" AFF.

