

DISPLAY THIS CARD ON PRINCIPAL FRONTAGE OF WORK



# CITY OF PORTLAND

## BUILDING PERMIT

This is to certify that ASSOCIATES RGT

Located At 106 HIGH

Job ID: 2011-03-695-ALTCOMM

CBL: 039 - - A - 037 - 001 - - - -

has permission to outside seating 6 tables, 12 chairs

provided that the person or persons, firm or corporation accepting this permit shall comply with all of the provisions of the Statutes of Maine and of the Ordinances of the City of Portland regulating the construction, maintenance and use of the buildings and structures, and of the application on file in the department.

Notification of inspection and written permission procured before this building or part thereof is lathed or otherwise closed-in. 48 HOUR NOTICE IS REQUIRED.

A final inspection must be completed by owner before this building or part thereof is occupied. If a certificate of occupancy is required, it must be

Fire Prevention Officer

Code Enforcement Officer / Plan Reviewer

**THIS CARD MUST BE POSTED ON THE STREET SIDE OF THE PROPERTY.  
PENALTY FOR REMOVING THIS CARD**

## BUILDING PERMIT INSPECTION PROCEDURES

Please call 874-8703 or 874-8693 (ONLY)

or email: [buildinginspections@portlandmaine.gov](mailto:buildinginspections@portlandmaine.gov)

With the issuance of this permit, the owner, builder or their designee is required to provide adequate notice to the city of Portland Inspections Services for the following inspections. Appointments must be requested 48 to 72 hours in advance of the required inspection. The inspection date will need to be confirmed by this office.

- **Please read the conditions of approval that is attached to this permit!! Contact this office if you have any questions.**
- **Permits expire in 6 months. If the project is not started or ceases for 6 months.**
- **If the inspection requirements are not followed as stated below additional fees may be incurred due to the issuance of a "Stop Work Order" and subsequent release to continue.**

The project cannot move to the next phase prior to the required inspection and approval to continue, REGARDLESS OF THE NOTICE OF CIRCUMSTANCES.

IF THE PERMIT REQUIRES A CERTIFICATE OF OCCUPANCY, IT MUST BE PAID FOR AND ISSUED TO THE OWNER OR DESIGNEE BEFORE THE SPACE MAY BE OCCUPIED.



# PORTLAND MAINE

*Strengthening a Remarkable City, Building a Community for Life • [www.portlandmaine.gov](http://www.portlandmaine.gov)*

Director of Planning and Urban Development  
Penny St. Louis

Job ID: 2011-03-695-ALTCOMM

Located At: 106 HIGH

CBL: 039 - - A - 037 - 001 - - - -

## **Conditions of Approval:**

### **Building**

The outside dining permit is approved for the area delineated at the inspection and stated on the permit, and must be kept on site.

THIS PERMIT MUST BE RENEWED ANNUALLY.

The tables and chairs must not block any means of egress of any building, even during storage.

The outdoor seating may NOT be used until the permit is issued and posted on site.



# CITY OF PORTLAND, MAINE

Department of Building Inspections

## Original Receipt

Received from

Location of Work

Cost of Construction

\$

Building Fee:

Permit Fee

\$

Site Fee:

Certificate of Occupancy Fee:

Total:

Building (IL)

Plumbing (IS)

Electrical (I2)

Site Plan (U2)

Other

CBL:

Check #:

Total Collected \$

**No work is to be started until permit issued.**

**Please keep original receipt for your records.**

Taken by:

WHITE - Applicant's Copy

YELLOW - Office Copy

PINK - Permit Copy

## **Lannie Dobson - Order 198**

---

**From:** Katherine Jones  
**To:** Lannie Dobson  
**Date:** 5/27/2011 2:02 PM  
**Subject:** Order 198

**Lannie, we do not have the order downloaded yet, but this is copy of the passage at the Council meeting May 16th.**

### **Order 198-10/11**

Granting Municipal Officer's Approval of NCPTWO, LTD,  
d/b/a FLASK at 117 Spring Street. Request to Add Outdoor Dining on Public Property –  
Sponsored by Katherine L. Jones, City Clerk.  
The Sound Oversight Committee met on May 11th and voted to forward this item back to the  
City Council with a recommendation for approval.

Motion was made by Councilor Anton and seconded by Councilor Duson for passage. Passage  
9-0.

# City of Portland, Maine - Building or Use Permit Application

389 Congress Street, 04101 Tel: (207) 874-8703, FAX: (207) 8716

Job No: <b>2011-03-695-ALTCOMM</b>	Date Applied: <b>3/29/2011</b>	CBL: <b>039 - - A - 037 - 001 - - - -</b>	
Location of Construction: <b>106 HIGH ST/117 SPRING ST</b>	Owner Name: <b>ASSOCIATES RGT</b>	Owner Address: <b>44 OAK ST PORTLAND, ME - MAINE 04101</b>	Phone:
Business Name: <b>FLASK LOUNGE</b>	Contractor Name: <b>Jessica Lea Nolette</b>	Contractor Address:	Phone: <b>408-9020</b>
Lessee/Buyer's Name:	Phone:	Permit Type: <b>OUTDOOR - Outdoor Seating</b>	Zone: <b>B-3</b>
Past Use: <b>Restaurant/Class A Lounge</b>	Proposed Use: <b>Same: Restaurant/Class A Lounge – to have outside dining on the sidewalk</b>	Cost of Work:	CEO District:
		Fire Dept: <div style="display: flex; align-items: center;"> <div style="margin-right: 10px;"> <input checked="" type="checkbox"/> Approved  <input type="checkbox"/> Denied  <input type="checkbox"/> N/A         </div> <div style="font-size: 2em; color: blue;">N/A</div> </div>	Inspection: Use Group: Type: <div style="color: blue; font-size: 1.5em;">Outdoor Seating</div>
Proposed Project Description: <b>106 High St. / 117 Spring St. Flask Lounge – outside dining</b>		Pedestrian Activities District (P.A.D.) <div style="color: blue; font-size: 2em;">[Signature]</div>	
Permit Taken By: Lannie		<b>Zoning Approval</b>	

1. This permit application does not preclude the Applicant(s) from meeting applicable State and Federal Rules. 2. Building Permits do not include plumbing, septic or electrical work. 3. Building permits are void if work is not started within six (6) months of the date of issuance. False informatin may invalidate a building permit and stop all work.	<b>Special Zone or Reviews</b> <input type="checkbox"/> Shoreland <input type="checkbox"/> Wetlands <input type="checkbox"/> Flood Zone <input type="checkbox"/> Subdivision <input type="checkbox"/> Site Plan <input type="checkbox"/> Maj <input type="checkbox"/> Min <input type="checkbox"/> MM Date: <div style="color: blue; font-size: 1.5em;">OK 3/29/11</div>	<b>Zoning Appeal</b> <input type="checkbox"/> Variance <input type="checkbox"/> Miscellaneous <input type="checkbox"/> Conditional Use <input type="checkbox"/> Interpretation <input type="checkbox"/> Approved <input type="checkbox"/> Denied Date:	<b>Historic Preservation</b> <input type="checkbox"/> Not in Dist or Landmark <input type="checkbox"/> Does not Require Review <input type="checkbox"/> Requires Review <input type="checkbox"/> Approved <input type="checkbox"/> Approved w/Conditions <input type="checkbox"/> Denied Date:
	<b>CERTIFICATION</b>		

I hereby certify that I am the owner of record of the named property, or that the proposed work is authorized by the owner of record and that I have been authorized by the owner to make this application as his authorized agent and I agree to conform to all applicable laws of this jurisdiction. In addition, if a permit for work described in the appication is issued, I certify that the code official's authorized representative shall have the authority to enter all areas covered by such permit at any reasonable hour to enforce the provision of the code(s) applicable to such permit.

SIGNATURE OF APPLICANT	ADDRESS	DATE	PHONE
RESPONSIBLE PERSON IN CHARGE OF WORK, TITLE		DATE	PHON





Flask Lounge  
117 Spring St  
Portland, ME 04101  
Contact: Jessica Nolette  
207.408.9020

## Outdoor Dining Application Plot

30' x 4' pinned  
4-6-11  
NLA

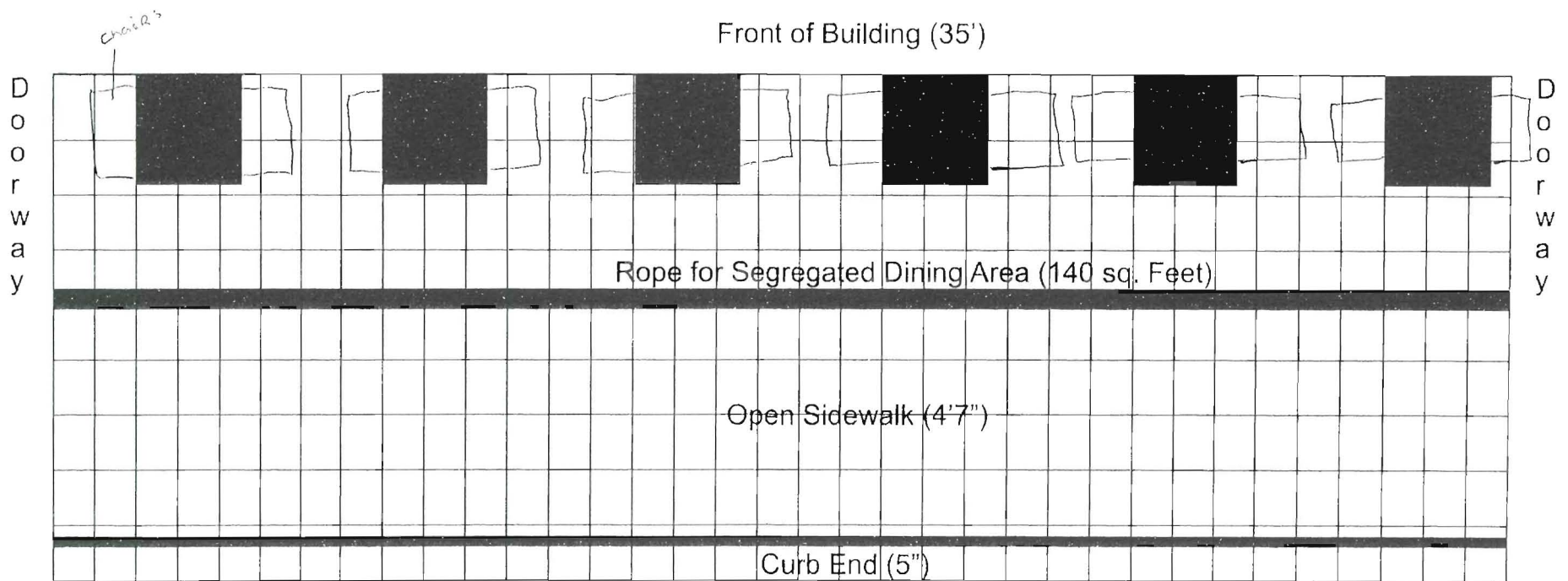

30' x 4' 120 sq. ft.

Dining Area (35' x 4' = 140 sq. feet)

Tables = 6

Seats = 12

Open Sidewalk Width & Curb = 5 feet

Spring Street

Squares Measure 1'



## Outdoor Dining Permit Application

If you or the property owner owes real estate or personal property taxes or user charges on any property within the City, payment arrangements must be made before permits of any kind are accepted.

<input checked="" type="checkbox"/> New Application for Outside Dining <input type="checkbox"/> Renewal Application for Outside Dining		
City Clerk signature for liquor license approval: <u>[Signature]</u> Pending Council Date: <u>4-25-11</u>		
Location/Address of Outdoor Seating: <u>117 Spring St. Portland, ME 04101</u> <u>1106 High St</u>		
Total Square Footage of Proposed Seating Area <sup>1</sup> <u>140 sq. feet</u>		Square Footage of Lot <u>1,650 sq. feet</u>
Tax Assessor's Chart, Block & Lot Chart# <u>039</u> Block# <u>A</u> Lot# <u>037</u>	Phone#: <u>207-408-9020</u>	Owner: <u>RGT Associates:</u> <u>Stephen Thomas</u>
Applicant *must be owner or Lessee Name: <u>Jessica Lea Nolette</u> Address: <u>21 Colonial Ave</u> City, State & Zip: <u>South Portland, ME</u>	Lessee/Buyer's Name: (If Applicable)	Annual Fee: <u>\$80</u> Total Sq. Ft. <u>140</u> Sq. Ft. Fee: <u>\$ 280</u> Total Fee: <u>\$ 360-</u>
Current use: <u>CLASS A Lounge</u>		
Business name: <u>Flask Lounge</u>		
Seating area dimensions: <u>35' x 4' = 140 sq. feet</u>		
How many chairs? <u>12</u> How many tables? <u>6</u>		
<input checked="" type="checkbox"/> Yes Alcohol is served. <input type="checkbox"/> No Alcohol being served.		
Who should we contact for the pre-inspection: <u>Jessica Lea Nolette</u>		
Mailing address: <u>21 Colonial Ave. South Portland</u> Phone: <u>207-408-9020</u>		

going in front of Council on wed. 4/20/11

**RECEIVED**

MAR 29 2011

applicant

Dept. of Building Inspections  
City of Portland Maine

Please submit all of the information outlined in the Outdoor Dining Application Checklist. Failure to do so will result in the automatic denial of your permit.

In order to be sure the City fully understands the full scope of the project, the Planning and Development Department may request additional information prior to the issuance of a permit. For further information visit us on-line at [www.portlandmaine.gov](http://www.portlandmaine.gov), stop by the Building Inspections office, room 315 City Hall or call 874-8703.

I hereby certify that I am the Owner of record of the named property, or that the owner of record authorizes the proposed work and that I have been authorized by the owner to make this application as his/her authorized agent. I agree to conform to all applicable laws of this jurisdiction. In addition, if a permit for work described in this application is issued, I certify that the Code Official's authorized representative shall have the authority to enter all areas covered by this permit at any reasonable hour to enforce the provisions of the codes applicable to this permit.

Signature of Applicant:

[Signature]

Date: 3/29/11

<sup>1</sup> In no instance shall the total square footage of dining area equal more than 10% of park space, unless the applicant receives a waiver from the Director of Parks and Recreation or his or her designee. This is not a permit; you may not commence ANY work until the permit is issued.



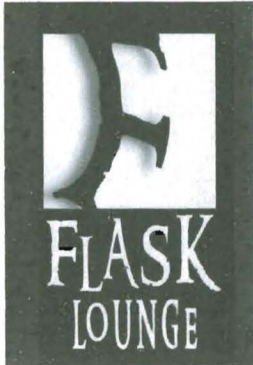

Flask Lounge  
 117 Spring St  
 Portland, ME 04101  
 Contact: Jessica Nolette  
 207.408.9020

## Outdoor Dining Application Plot

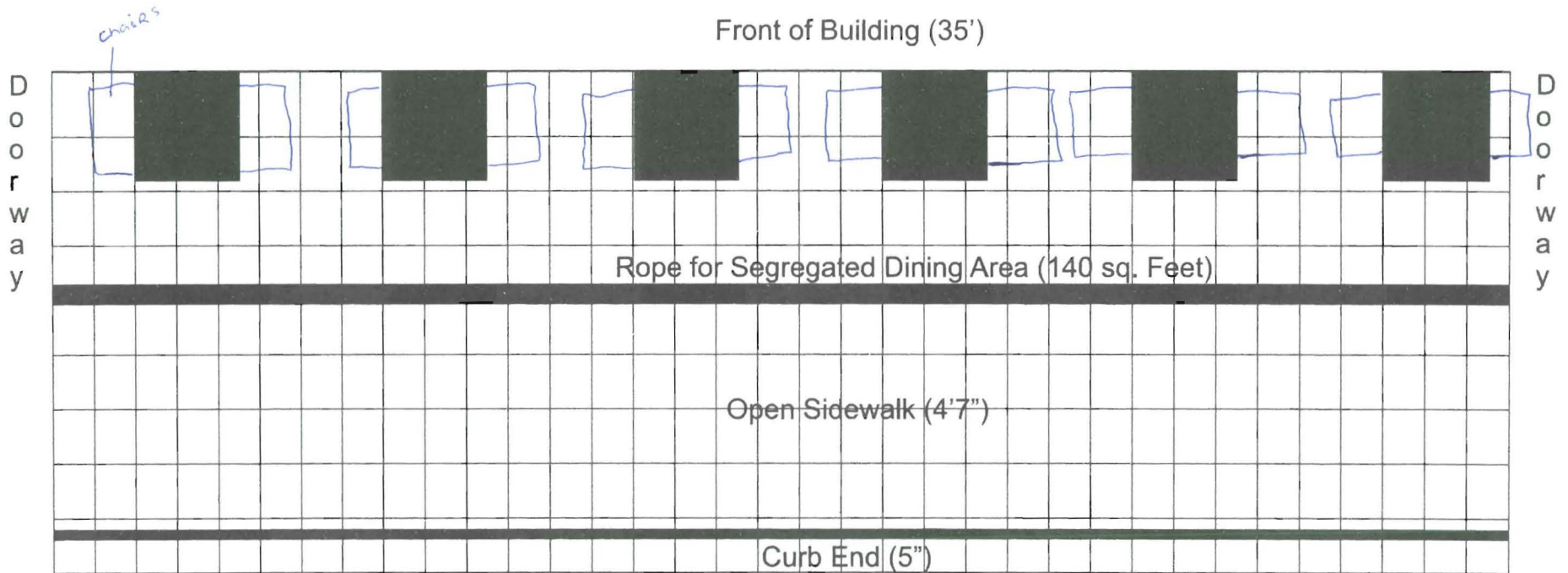

Dining Area (35' x 4' = 140 sq.feet)  
 Tables = 6  
 Seats = 12  
 Open Sidewalk Width & Curb = 5 feet

Squares Measure 1'

**ACORD**<sup>TM</sup>**CERTIFICATE OF LIABILITY INSURANCE**

DATE (MM/DD/YYYY)

03/22/2011

PRODUCER 207.646.7118

FAX 207.646.8294

Peoples Insurance

PO Box 1336

Ogunquit, ME 03907

THIS CERTIFICATE IS ISSUED AS A MATTER OF INFORMATION ONLY AND CONFERS NO RIGHTS UPON THE CERTIFICATE HOLDER. THIS CERTIFICATE DOES NOT AMEND, EXTEND OR ALTER THE COVERAGE AFFORDED BY THE POLICIES BELOW.

## INSURERS AFFORDING COVERAGE

NAIC #

INSURED NCP Two, Ltd

DBA: Flask

117 Spring Street

Portland, ME 04101

INSURER A: Great American E&amp;S Ins. Co.

INSURER B:

INSURER C:

INSURER D:

INSURER E:

## COVERAGES

THE POLICIES OF INSURANCE LISTED BELOW HAVE BEEN ISSUED TO THE INSURED NAMED ABOVE FOR THE POLICY PERIOD INDICATED. NOTWITHSTANDING ANY REQUIREMENT, TERM OR CONDITION OF ANY CONTRACT OR OTHER DOCUMENT WITH RESPECT TO WHICH THIS CERTIFICATE MAY BE ISSUED OR MAY PERTAIN, THE INSURANCE AFFORDED BY THE POLICIES DESCRIBED HEREIN IS SUBJECT TO ALL THE TERMS, EXCLUSIONS AND CONDITIONS OF SUCH POLICIES. AGGREGATE LIMITS SHOWN MAY HAVE BEEN REDUCED BY PAID CLAIMS.

INSR ADD'L LTR	INSRD	TYPE OF INSURANCE	POLICY NUMBER	POLICY EFFECTIVE DATE (MM/DD/YYYY)	POLICY EXPIRATION DATE (MM/DD/YYYY)	LIMITS	
		<b>GENERAL LIABILITY</b> <input checked="" type="checkbox"/> COMMERCIAL GENERAL LIABILITY <input type="checkbox"/> CLAIMS MADE <input checked="" type="checkbox"/> OCCUR  GEN'L AGGREGATE LIMIT APPLIES PER: <input type="checkbox"/> POLICY <input type="checkbox"/> PRO-JECT <input type="checkbox"/> LOC	<b>PAC3896056-03</b>	<b>11/01/2010</b>	<b>11/01/2011</b>	EACH OCCURRENCE	\$ <b>1,000,000</b>
						DAMAGE TO RENTED PREMISES (Ea occurrence)	\$ <b>50,000</b>
						MED EXP (Any one person)	\$ <b>1,000</b>
						PERSONAL & ADV INJURY	\$ <b>1,000,000</b>
						GENERAL AGGREGATE	\$ <b>2,000,000</b>
						PRODUCTS - COMPIOP AGG	\$ <b>1,000,000</b>
		<b>AUTOMOBILE LIABILITY</b> <input type="checkbox"/> ANY AUTO <input type="checkbox"/> ALL OWNED AUTOS <input type="checkbox"/> SCHEDULED AUTOS <input type="checkbox"/> HIRED AUTOS <input type="checkbox"/> NON-OWNED AUTOS				COMBINED SINGLE LIMIT (Ea accident)	\$
						BODILY INJURY (Per person)	\$
						BODILY INJURY (Per accident)	\$
						PROPERTY DAMAGE (Per accident)	\$
		<b>GARAGE LIABILITY</b> <input type="checkbox"/> ANY AUTO				AUTO ONLY - EA ACCIDENT	\$
						OTHER THAN EA ACC	\$
						AUTO ONLY: AGG	\$
		<b>EXCESS / UMBRELLA LIABILITY</b> <input type="checkbox"/> OCCUR <input type="checkbox"/> CLAIMS MADE  DEDUCTIBLE RETENTION \$				EACH OCCURRENCE	\$
						AGGREGATE	\$
							\$
							\$
							\$
		<b>WORKERS COMPENSATION AND EMPLOYERS' LIABILITY</b> ANY PROPRIETOR/PARTNER/EXECUTIVE OFFICER/MEMBER EXCLUDED? (Mandatory in NH) If yes, describe under SPECIAL PROVISIONS below				WC STATU-TORY LIMITS	OTH-ER
						E.L. EACH ACCIDENT	\$
						E.L. DISEASE - EA EMPLOYEE	\$
						E.L. DISEASE - POLICY LIMIT	\$
<b>A</b>		<b>OTHER Public Liability</b>	<b>PAC3896056-03</b>			<b>combined single limit \$400,000</b>	

DESCRIPTION OF OPERATIONS / LOCATIONS / VEHICLES / EXCLUSIONS ADDED BY ENDORSEMENT / SPECIAL PROVISIONS

City of Portland, Maine is Additional Insured in regards to Public Liability

## CERTIFICATE HOLDER

City of Portland  
389 Congress Street  
Portland, ME 04101

## CANCELLATION

SHOULD ANY OF THE ABOVE DESCRIBED POLICIES BE CANCELLED BEFORE THE EXPIRATION DATE THEREOF, THE ISSUING INSURER WILL ENDEAVOR TO MAIL 10 DAYS WRITTEN NOTICE TO THE CERTIFICATE HOLDER NAMED TO THE LEFT, BUT FAILURE TO DO SO SHALL IMPOSE NO OBLIGATION OR LIABILITY OF ANY KIND UPON THE INSURER, ITS AGENTS OR REPRESENTATIVES.

AUTHORIZED REPRESENTATIVE

Timothy Pinkham/SGL

ACORD 25 (2009/01)

© 1988-2009 ACORD CORPORATION. All rights reserved.

The ACORD name and logo are registered marks of ACORD



Address **117 Spring St**  
**Portland, ME 04101**

Notes Flask Lounge: Location &  
Intersecting Streets

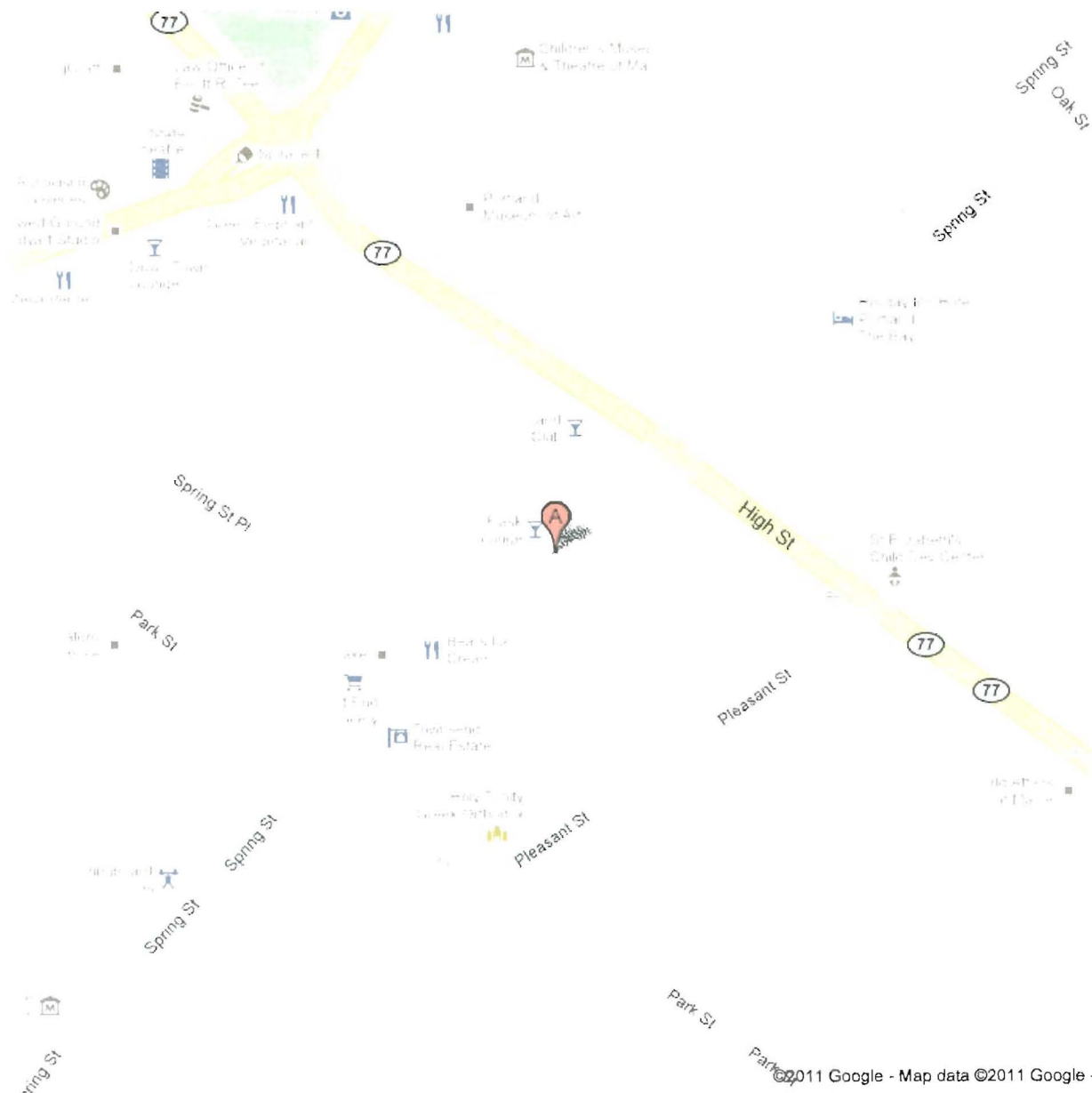

©2011 Google - Map data ©2011 Google -



Address **117 Spring St**  
**Portland, ME 04101**

**Save trees. Go green!**

Download Google Maps on your  
phone at [google.com/gmm](http://google.com/gmm)







Address **124 Spring Street**

Address is approximate

**Save trees. Go green!**

Download Google Maps on your phone at [google.com/gmm](http://google.com/gmm)





# Flask Lounge Outdoor Dining Furniture

## Wrought Iron Chair

Silla de Acero Forjado

34.5 in  
87.63 cm

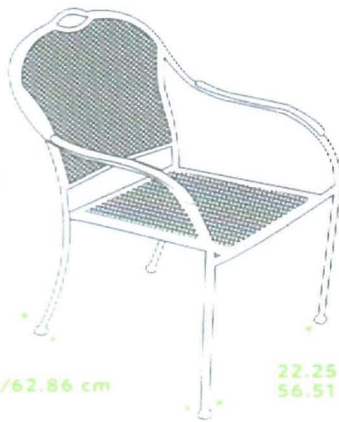

24.75 in/62.86 cm

22.25 in  
56.51 cm

samsclub.com

Distributed by:  
SAM'S WEST Inc.  
Bentonville, AR 72716  
1-800-585-9969  
MADE IN CHINA

ZS10655



## Wrought Iron Chair

Silla de Acero Forjado



Wrought Iron Table and Wrought Iron Bench  
sold separately at select Sam's Clubs and  
samsclub.com

La Mesa de Hierro Forjado y la Banca de Hierro  
Forjado se venden por separado en selectos  
Sam's Clubs y en samsclub.com

## Wrought Iron Table

Mesa de Hierro Forjado

28 in  
71.12 cm

28 in  
71.12 cm

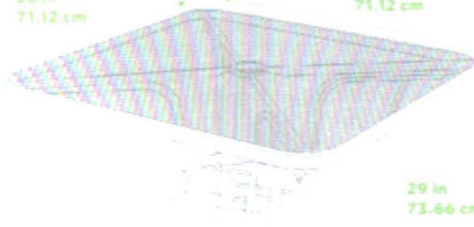

29 in  
73.66 cm

samsclub.com

Distributed by:  
SAM'S WEST Inc.  
Bentonville, AR 72716  
1-800-585-9969  
MADE IN CHINA

ZS091197



## Wrought Iron Table

Mesa de Hierro Forjado



Wrought Iron Bench sold separately at select  
Sam's Clubs and samsclub.com

Banca de Hierro Forjado se vende por separado en  
selectos Sam's Clubs y en samsclub.com

# Flask Lounge Outdoor Dining Furniture Specs

## Wrought Iron Chair

Silla de Acero Forjado

- Specifically designed for any outdoor commercial or residential use.
  - Stackable for simple storage.
  - Heavy 1.8 mm steel mesh for durability and comfort.
  - Adjustable foot pads for uneven surfaces.
  - 1 year limited warranty.
- 
- Diseñada específicamente para uso comercial o residencial en exteriores.
  - Apilable para un almacenamiento sencillo.
  - Malla de acero resistente de 1.80 mm para mayor durabilidad y confort.
  - Cojinetes ajustables en las patas para superficies dispares.
  - Orificio para sombrilla para mayor versatilidad.
  - Garantía limitada por 1 año.

## Wrought Iron Table

Mesa de Hierro Forjado

- Specifically designed for any outdoor commercial or residential use.
  - Easy assembly.
  - Heavy 1.8 mm steel mesh for durability and comfort.
  - Adjustable foot pads for uneven surfaces.
  - Umbrella hole for added versatility.
  - 1 year limited warranty.
- 
- Diseñada específicamente para uso comercial o residencial en exteriores.
  - Fácil ensamble.
  - Malla de acero resistente de 1.8 mm para mayor durabilidad y confort.
  - Cojinetes ajustables en las patas para superficies dispares.
  - Orificio para sombrilla para mayor versatilidad.
  - Garantía limitada por un año.





## OUTDOOR DINING PERMIT CHECKLIST

Permits are required for expanding food service establishments to the outside on City Property. The annual fee is \$80.00 plus \$2.00 per square foot of dining area on streets, sidewalks or other public ways and \$80.00 plus \$6.00 per square foot of dining area in city parks. For purposes of fee calculation, the area abutting the buildings which border Monument Square and extending ten (10) feet from the facade of said buildings shall be considered a sidewalk. The ten (10) foot area shall be measured from that portion of the facade that protrudes furthest into the sidewalk. The area beyond the ten (10) foot sidewalk shall be considered park space.

Outdoor dining is permitted year round under the permit; however, furniture must be removed in inclement weather to allow for sidewalk snow removal. **The permit must be renewed each year.**

All of the following information is required and must be submitted. You will also be required to fill out an Outdoor Dining Permit Application.

### A plot plan is required and must include:

- ☒ A drawing of the lot, where the building sits on the lot along with the lot and building dimensions
- ☒ The dimensional setback from the sidewalk to the building
- ☒ The location of the street, and if it's a corner lot, the intersecting streets
- ☒ The sidewalk along with its width and curbing location
- ☒ The location of the table and chair placement, including dimensions  
(NOTE: there must be a minimum of four feet of open sidewalk from the outer boundary of the seating area to the curb, and a minimum of five feet on corners, and egress from the building must be maintained free of obstruction per the building code and NFPA Life Safety Code).

### Additional Requirements:

- ☒ The permit holder is required to produce, at the time of submission, and maintain public liability insurance coverage in an amount of not less than four hundred thousand dollars (\$400,000) combined single limit for bodily injury, death and property damage, naming the City as an additional insured thereon.

### All permits for outdoor dining are issued subject to the following conditions:

- ☒ The tables and chairs must be placed within the permitted area on the sidewalk in such a manner as to allow the free and safe passage of pedestrian traffic. If the tables and chairs are moved and located outside of the permitted outdoor seating area, they must be relocated to within the permitted area. Failure to contain the tables and chairs to the permitted area may result in a reduced permitted area or a revocation of the permit.

- ☒ The permit holder is responsible for keeping the outdoor seating area clean. The sidewalk area where the tables and chairs are located must be kept neat and free from litter and debris.
- ☒ No food shall be prepared outside.
- ☒ If alcohol is to be served, the permit holder must notify the City's Business Licensing Office in room 203 of City Hall or by telephone at 874-8557 and obtain approval for the service of alcohol outdoors. Additionally, State law requires that any outdoor area serving alcohol be segregated from the rest of the public.
- ☒ All tables and chairs shall be removed prior to a predicted snowfall and while any snow or ice exists within the designated outdoor seating area or within four feet from the boundaries thereof. The City will not be responsible for damage to any tables, chairs or other property that is not properly removed when the City is engaged in sidewalk maintenance activities.
- ☒ The permit holder shall comply with all applicable rules and regulations implemented by the city regarding outdoor dining.

**Failure to comply with any of the above conditions will result in revocation or non-renewal of the permit.**

I/We fully understand that the City of Portland, its agents, officers and employees accept no responsibility and will not be liable for any injury, harm or damage to my/our person or property arising out of the establishment's occupancy of the sidewalk or park space. To the fullest extent permitted by law, I/We do hereby agree to assume all risk of injury, harm or damage to my/our person or property (including but not limited to all risk of injury, harm or damage to my/our property cause by the negligence of the City of Portland, its agents, officers or employees) arising out of the establishment's occupancy of the sidewalk or park space. I/We hereby agree, to the fullest extent permitted by law, to defend, indemnify and hold harmless the City of Portland, its agents, officers and employees, from and against all claims, damages, losses and expenses, just or unjust, including, but not limited to costs of defense and attorney's fees, arising out of the establishment's occupancy of the sidewalk or park space, provided that any such claims, damage, loss or expense (1) is attributable to bodily injury, sickness, disease, or death, or to injury to or destruction of tangible property including the loss of use there from, and (2) is caused in whole or in part by any negligent act or omission of the establishment, anyone directly or indirectly employed by it, or anyone for whose act it may be liable.

Signed and acknowledged:  Date: 3/29/11

Printed name Jessica Lea Nolette

Establishment Flask Lounge

Location 117 Spring St. Portland, ME

Flask Lounge  
117 Spring St.  
Portland, ME 04101  
contact: Jessica Nolette  
207.408.9020

3/25/2011

*Subject: Outdoor Seating Application*

*City of Portland,*

Flask Lounge requests your permission and applicable permits to allow future dining outdoors. We believe that outdoor seating will not only enhance Flask's business operations, but will likely become a popular neighborhood amenity. Seating outside cafes/bars/lounges helps create a vibrant and lively public space in our city, a privilege we hope to participate in. Enclosed are all documents necessary for reviewal.

Thank you for your consideration,  
Jessica Nolette  
*owner*



**Job Summary Report**  
**Job ID: 2011-03-695-ALTCOMM**

Report generated on Apr 11, 2011 3:26:22 PM

Page 1

<b>Job Type:</b>	Adds/Alter Commercial	<b>Job Description:</b>	106 High St. / 117 Spring St. Flask Lounge	<b>Job Year:</b>	2011
<b>Building Job Status Code:</b>	Initiate Plan Review	<b>Pin Value:</b>	1001	<b>Tenant Name:</b>	Flask Lounge
<b>Job Application Date:</b>		<b>Public Building Flag:</b>	N	<b>Tenant Number:</b>	
<b>Estimated Value:</b>		<b>Square Footage:</b>			
<b>Related Parties:</b>	ASSOCIATES RGT			Property Owner	

**Job Charges**

Fee Code Description	Charge Amount	Permit Charge Adjustment	Net Charge Amount	Payment Date	Receipt Number	Payment Amount	Payment Adjustment Amount	Net Payment Amount	Outstanding Balance
----------------------	---------------	--------------------------	-------------------	--------------	----------------	----------------	---------------------------	--------------------	---------------------

**Location ID: 5936**

**Location Details**

Alternate Id	Parcel Number	Census Tract	GIS X	GIS Y	GIS Z	GIS Reference	Longitude	Latitude
R00020	039 A 037 001		M				-70.262271	43.65308

Location Type	Subdivision Code	Subdivision Sub Code	Related Persons	Address(es)
1				106 HIGH STREET WEST

Location Use Code	Variance Code	Use Zone Code	Fire Zone Code	Inside Outside Code	District Code	General Location Code	Inspection Area Code	Jurisdiction Code
RETAIL & PERSONAL SERVICE		DOWNTOWN BUSINESS			Historic District		DISTRICT 3	CENTRAL BUSINESS DISTRICT

**Structure Details**

**Structure: Commercial Upgrades**

**Occupancy Type Code:**

Structure Type Code	Structure Status Type	Square Footage	Estimated Value	Address
Office & Professional Buildings	0			106 HIGH STREET WEST

Longitude	Latitude	GIS X	GIS Y	GIS Z	GIS Reference
-----------	----------	-------	-------	-------	---------------

User Defined Property	Value
Cook Tops	0
Dishwasher	0
Disposals	0
Fixtures-Fluorescent	0

*annie*

*with in Q*