

City of Portland, Maine – Building or Use Permit Application 389 Congress Street, 04101, Tel: (207) 874-8703, FAX: 874-8716

Location of Construction: 116 High Street Portland		Owner: Cumberland Club		Phone: 773-6402		Permit No: 990611
Owner Address: SAA		Lessee/Buyer's Name:		Phone:		
Contractor Name: ** Union Oil Co.		Address: ** 63 Ocean Street So. Portland		Phone: 799-1521		Permit Issued: Zone: D-2 CBL: 039-A-027 Zoning Approval: <i>[Signature]</i> Special Zone or Reviews: <input type="checkbox"/> Shoreland <input type="checkbox"/> Wetland <input type="checkbox"/> Flood Zone <input type="checkbox"/> Subdivision <input type="checkbox"/> Site Plan maj <input type="checkbox"/> minor <input type="checkbox"/> mm <input type="checkbox"/>
Past Use: Men's Club		Proposed Use: Same		COST OF WORK: \$ _____ PERMIT FEE: \$ 35.00		
Proposed Project Description: Install 3-330 Gal. Oil Tanks		FIRE DEPT. <input checked="" type="checkbox"/> Approved <input type="checkbox"/> Denied Signature: <i>[Signature]</i>		INSPECTION: Use Group: Type: Signature: <i>[Signature]</i>		PEDESTRIAN ACTIVITIES DISTRICT (P.A.D.) Action: Approved <input type="checkbox"/> Approved with Conditions: <input type="checkbox"/> Denied <input type="checkbox"/> Signature: _____ Date: _____
Permit Taken By: SP		Date Applied For: June 10, 1999 KA				

- This permit application does not preclude the Applicant(s) from meeting applicable State and Federal rules.
- Building permits do not include plumbing, septic or electrical work.
- Building permits are void if work is not started within six (6) months of the date of issuance. False information may invalidate a building permit and stop all work..

CERTIFICATION

I hereby certify that I am the owner of record of the named property, or that the proposed work is authorized by the owner of record and that I have been authorized by the owner to make this application as his authorized agent and I agree to conform to all applicable laws of this jurisdiction. In addition, if a permit for work described in the application is issued, I certify that the code official's authorized representative shall have the authority to enter all areas covered by such permit at any reasonable hour to enforce the provisions of the code(s) applicable to such permit

June 10, 1999

SIGNATURE OF APPLICANT ADDRESS: DATE: PHONE:

RESPONSIBLE PERSON IN CHARGE OF WORK, TITLE PHONE:

White-Permit Desk Green-Assessor's Canary-D.P.W. Pink-Public File Ivory Card-Inspector

CEO DISTRICT



THIS IS NOT A PERMIT/CONSTRUCTION CANNOT COMMENCE UNTIL THE PERMIT IS ISSUED

**Building or Use Permit Pre-Application
Attached Single Family Dwellings/Two-Family Dwelling
Multi-Family or Commercial Structures and Additions Thereto**

In the interest of processing your application in the quickest possible manner, please complete the Information below for a Building or Use Permit.

NOTEIf you or the property owner owes real estate or personal property taxes or user charges on ANY PROPERTY within the City, payment arrangements must be made before permits of any kind are accepted.**

Location/Address of Construction (include Portion of Building): <u>116 High ST.</u>			
Total Square Footage of Proposed Structure		Square Footage of Lot	
Tax Assessor's Chart, Block & Lot Number Chart# <u>039</u> Block# <u>A</u> Lot# <u>027</u>		Owner: <u>Cumberland CLUB</u>	Telephone#: <u>773 6402</u>
Owner's Address: <u>S.A.A.</u>		Lessee/Buyer's Name (If Applicable)	Cost Of Work: Fee \$ \$ <u>35.⁰⁰</u>
Proposed Project Description:(Please be as specific as possible) <u>INSTALL 3-330 GAL OIL TANKS 799-1521</u>			
Contractor's Name, Address & Telephone <u>UNION OIL CO 04106 63 OCEAN ST SO. PORT.</u>			Rec'd By <u>SP</u>
Current Use: <u>Men's CLUB</u>		Proposed Use: <u>Same</u>	

Separate permits are required for Internal & External Plumbing, HVAC and Electrical installation.

- All construction must be conducted in compliance with the 1996 B.O.C.A. Building Code as amended by Section 6-Art II.
- All plumbing must be conducted in compliance with the State of Maine Plumbing Code.
- All Electrical Installation must comply with the 1996 National Electrical Code as amended by Section 6-Art III.
- HVAC(Heating, Ventillation and Air Conditioning) installation must comply with the 1993 B.O.C.A. Mechanical Code.

You must Include the following with you application:

- 1) A Copy of Your Deed or Purchase and Sale Agreement
- 2) A Copy of your Construction Contract, if available
- 3) A Plot Plan/Site Plan

Minor or Major site plan review will be required for the above proposed projects. The attached checklist outlines the minimum standards for a site plan.

4) Building Plans

Unless exempted by State Law, construction documents must be designed by a registered design professional.

A complete set of construction drawings showing all of the following elements of construction:

- Cross Sections w/Framing details (including porches, decks w/ railings, and accessory structures)
- Floor Plans & Elevations
- Window and door schedules
- Foundation plans with required drainage and dampproofing
- Electrical and plumbing layout. Mechanical drawings for any specialized equipment such as furnaces, chimneys, gas equipment, HVAC equipment (air handling) or other types of work that may require special review must be included.

Certification

I hereby certify that I am the Owner of record of the named property, or that the proposed work is authorized by the owner of record and that I have been authorized by the owner to make this application as his/her authorized agent. I agree to conform to all applicable laws of this jurisdiction. In addition, if a permit for work described in this application is issued, I certify that the Code Official's authorized representative shall have the authority to enter all areas covered by this permit at any reasonable hour to enforce the provisions of the codes applicable to this permit.

Signature of applicant: <u>Edward F. Combes</u>	Date: <u>6-10-99</u>
---	----------------------

Building Permit Fee: \$25.00 for the 1st \$1000.cost plus \$5.00 per \$1,000.00 construction cost thereafter.
Additional Site review and related fees are attached on a separate addendum



OK.
2.

High ST

Cumberland Club
116 High St. Port
By-Union Oil Co.

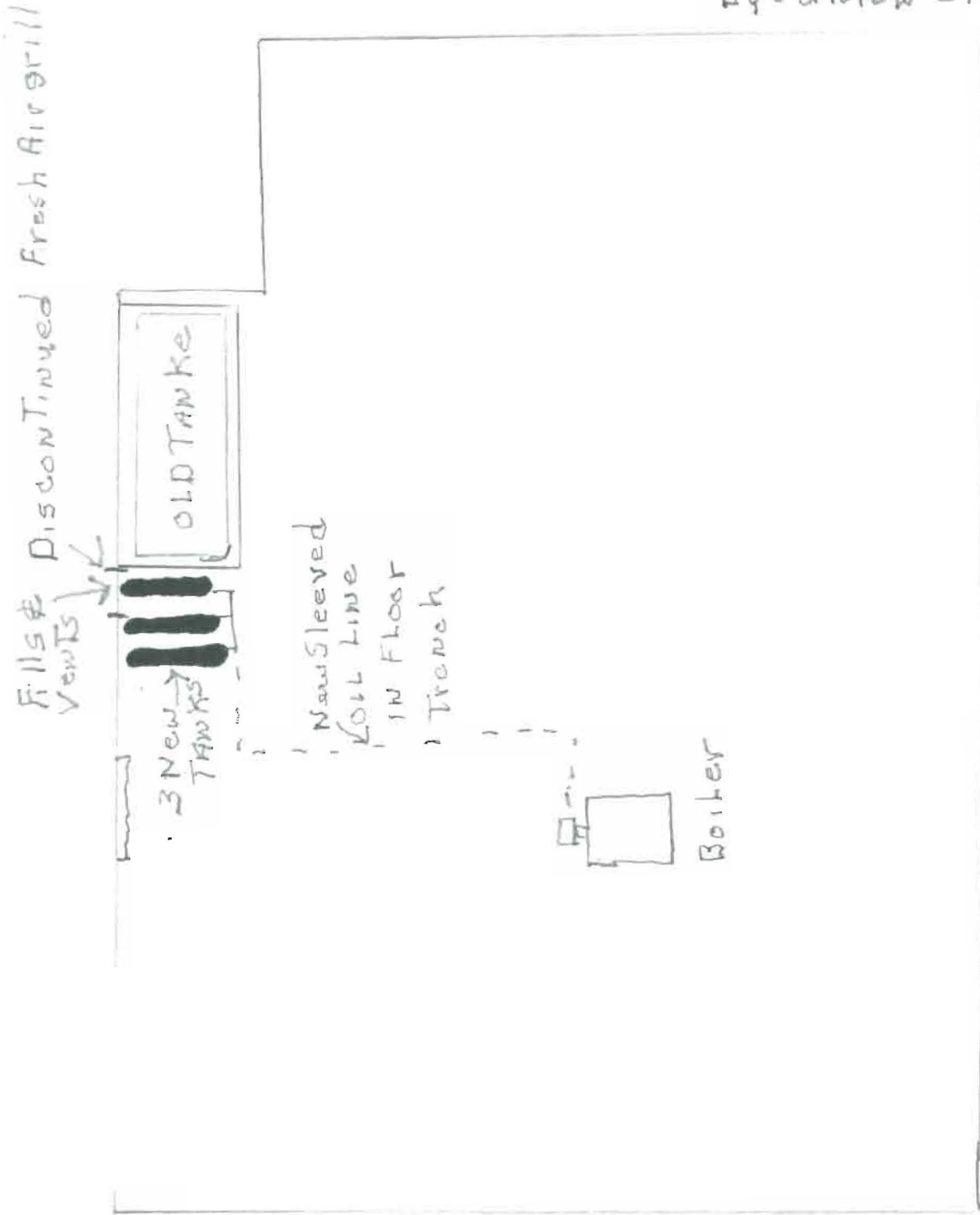

3 - 330 Gallon Tanks

All copyrights and other rights to rules text are reserved by the State of Maine. The text included in this publication is current to the effective date at the end of each chapter but is subject to change without notice. It is a version that is presumed accurate but which has not been officially certified by the Secretary of State.

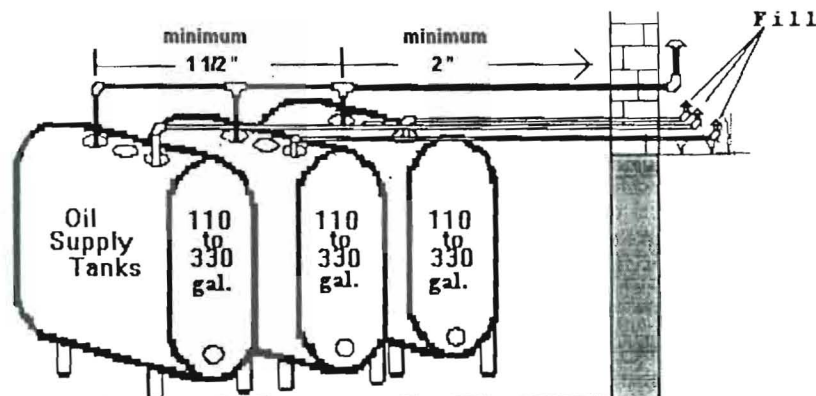

Figure 13(c)

Figure 13(d)

9-13.3.4 Oil shutoff valves shall be provided immediately adjacent to the burner supply connections at the bottom of the supply tanks.

9-13.3.5 The manifold at the cross connections of the burner supply line, shall be of wrought steel, wrought-iron pipe or copper tubing. (Standards for Wrought-Steel and Wrought-Iron Pipe, ANSI B36.10.) The manifold piping shall be as close to the shutoff valves as possible so that the distance between the tank and the last fitting shall not extend beyond (6) six inches from the face of the tanks and the final fitting (elbow or tee). See Figure 13(b).

9-13.3.6 Whenever three tanks are attached to supply one (1) burner, the burner supply cross connections, or manifold, shall be provided with an Oil Safety Valve (OSV) or Pressure Reducing Valve (PRV). See Figure 13(b). Because of the limited vacuum capability of the oil supply system, and the requirement for oil spill protection, whenever two or more burners are used an OSV or PRV shall be installed for each additional burner. See Figure 13(e). Manufacturer's instructions shall be consulted for other limitations or capabilities. On multiple tank installations, it is the installer's responsibility to ensure that return line product will not cause spillage.

All copyrights and other rights to rules text are reserved by the State of Maine. The text included in this publication is current to the effective date at the end of each chapter but is subject to change without notice. It is a version that is presumed accurate but which has not been officially certified by the Secretary of State.

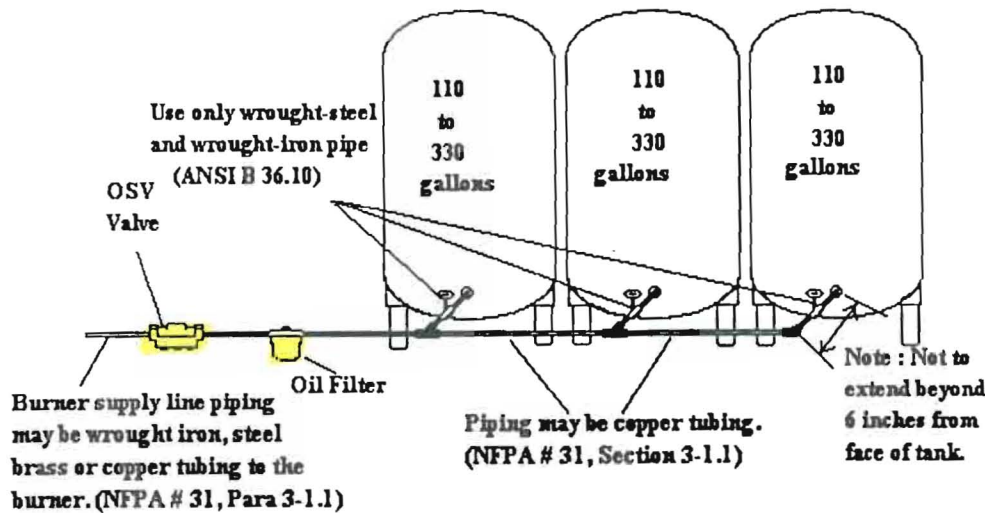

Figure 13 (b) Piping for three tank oil supply arrangement

9-13.3.2 Inside oil supply tanks in excess of 660 gallons and not more than 990 gallons aggregate capacity, may be installed to more than one oil burning appliance when installed in accordance with Figure 13(e). Only three tanks with an aggregate capacity of 990 gallons or less shall be attached as in Figure 13(e). Single tank installations in excess of 660 gallons shall comply with NFPA #31. The three tanks used shall be of equal size only, such as three (3) 330 gallon tanks, or three (3) 275 gallon tanks. See Figure 13(c), (d), and (e).

NOTE: This exception does not apply to outside use. See NFPA #31, Paragraph 2-4.5 and 2-4.6.

9-13.3.3 The top of the three tanks as arranged in Figure 12(b), (c), or (d) shall be on the same horizontal plane.