

PAVED PARKING LOT

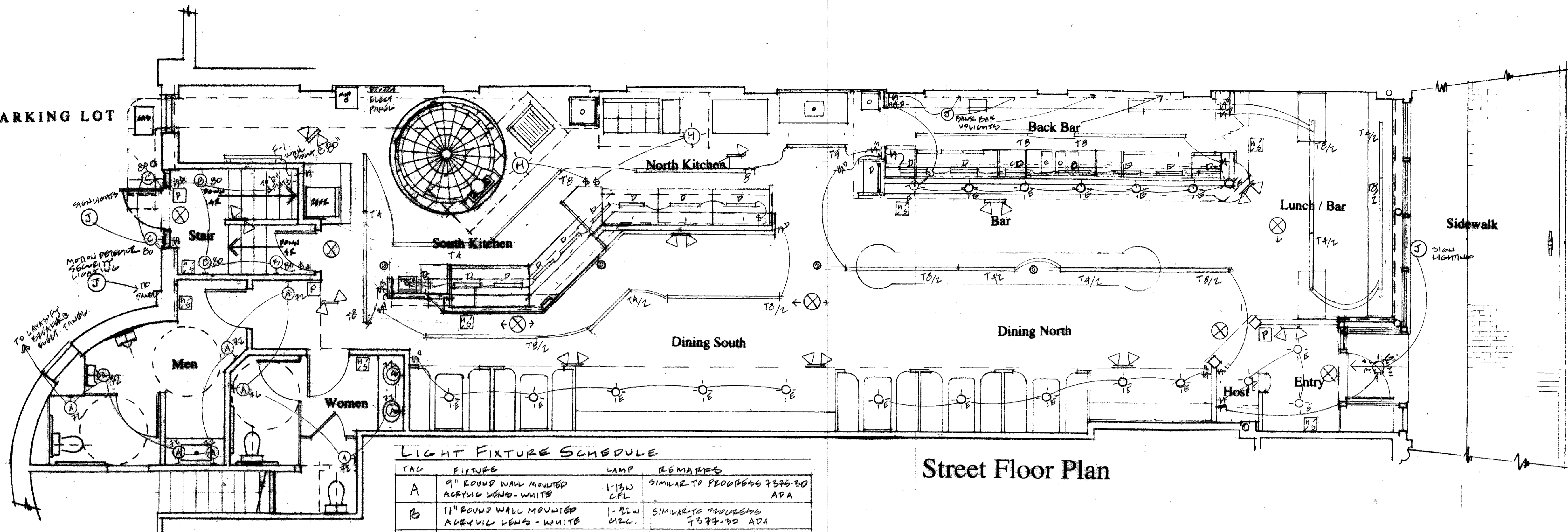

CONGRESS STREET

Street Floor Plan

LIGHT FIXTURE SCHEDULE

TAG	FIXTURE	LAMP	REMARKS
A	9" ROUND WALL MOUNTED ACRYLIC LENS - WHITE	1-13W CFL	SIMILAR TO PROGRESS 7376-30 ADA
B	11" ROUND WALL MOUNTED ACRYLIC LENS - WHITE	1-22W CFL	SIMILAR TO PROGRESS 7374-30 ADA
C	WALL MOUNTED EXTERIOR GLOBE - POLYCARB LENS - BLACK	2-3W CFL	SIMILAR TO PROGRESS P5698
D	24" UNDERCABINET LED STRIP	8 LED	MOUNT UNDER OVERHEAD SHOE + BAR LEDGE
E	2" APERTURE LED RECESSED DOWNLIGHT - WHITE	LED TRACK	JUNO MD1 LCO2 NARROW BEAM WITH LOW VOLTAGE DRIVER
F-1	4" FROSTED GLASS W/ WAX OR CEILING MOUNT	2 TB 32W	SURFACE OR CHAIN MOUNT IN PARALLEL PREP AREA
F-2	4" FROSTED GLASS VAPOR TIGHT	2 TB 32W	" " SCULLERY
F-3	COOLER FLOOR ELEMENTS	"	F-1 OR F-2 FOR COOLER SUPPLIER
G	EXTERIOR RECESSED BULB	LED	CONGRESS ST. ENTRY
H	KITCHEN EXHAUST HOOD LIGHTS	"	SUPPLIED WITH HOODS
T4	LIGHT TRACK W/ LENGTH IN FEET - BLACK	SINGLE CIRCUIT	SUPPORT PENDANT PLUGS + ACCELT FIXTURES DISTRIBUTION + TYPES TO BE DETERMINED
T4/2	" 2 CIRCUIT TRACK "	"	"

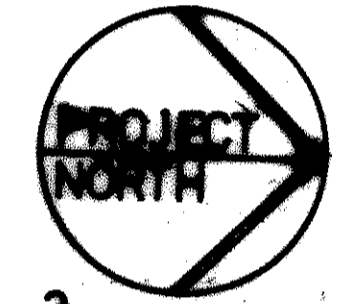

Graphic Scale 1/4 inch = 1 foot

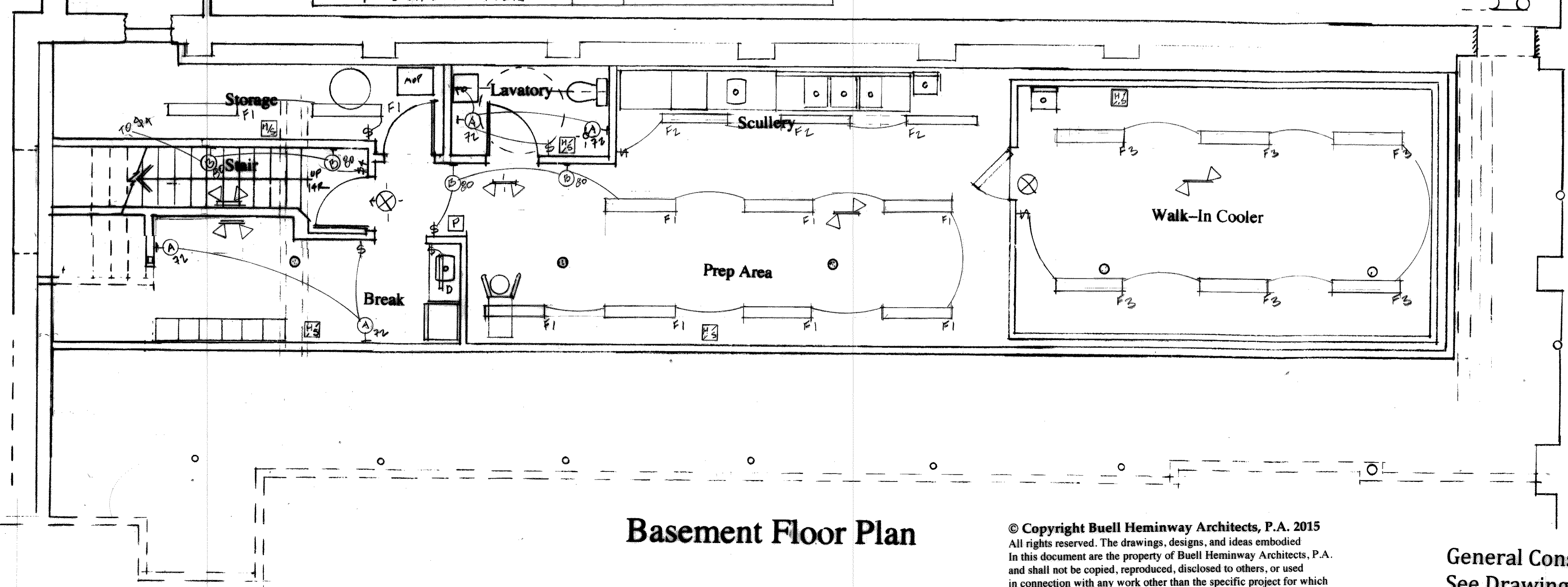

Basement Floor Plan

© Copyright Buell Heminway Architects, P.A. 2015
 All rights reserved. The drawings, designs, and ideas embodied in this document are the property of Buell Heminway Architects, P.A. and shall not be copied, reproduced, disclosed to others, or used in connection with any work other than the specific project for which they have been prepared, in whole or in part, without prior written authorization by Buell Heminway Architects, P.A.

General Construction Notes
 See Drawing S1.0

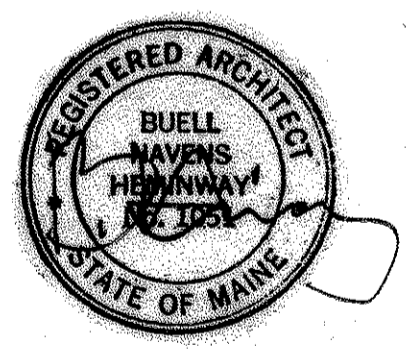

618 Congress Street
 Portland, Maine
 Restaurant
 for
 Lazzari LLC
 Buell Heminway
 ARCHITECTS
 PO Box 17733 DIS - Portland, Me 04112
 (207) 772-8892 - FAX 772-2870
 bheminway@gwi.net

Drawing Number and Title
E-2
 Lighting Plans and
 Fixture Schedule

Date: June 30, 2015
 Scale: 1/4"=1'-0"
 By: Buell