

© 2016 RYAN SENATORE ARCHITECTURE

OFFICE FIT-UP
622 CONGRESS STREET
PORTLAND, MAINE



RYAN SENATORE
ARCHITECTURE
565 CONGRESS STREET
PORTLAND, MAINE 04101
207-650-6414
senatorearchitecture.com

CONSULTANTS:

REVISIONS:

DATE: OCTOBER 31, 2016

PROJECT No. 1625

DRAWN BY: JPF, RJS

CHECKED BY: RJS

SCALE: AS NOTED

SHEET TITLE:
THIRD FLOOR
RCP

A1-5

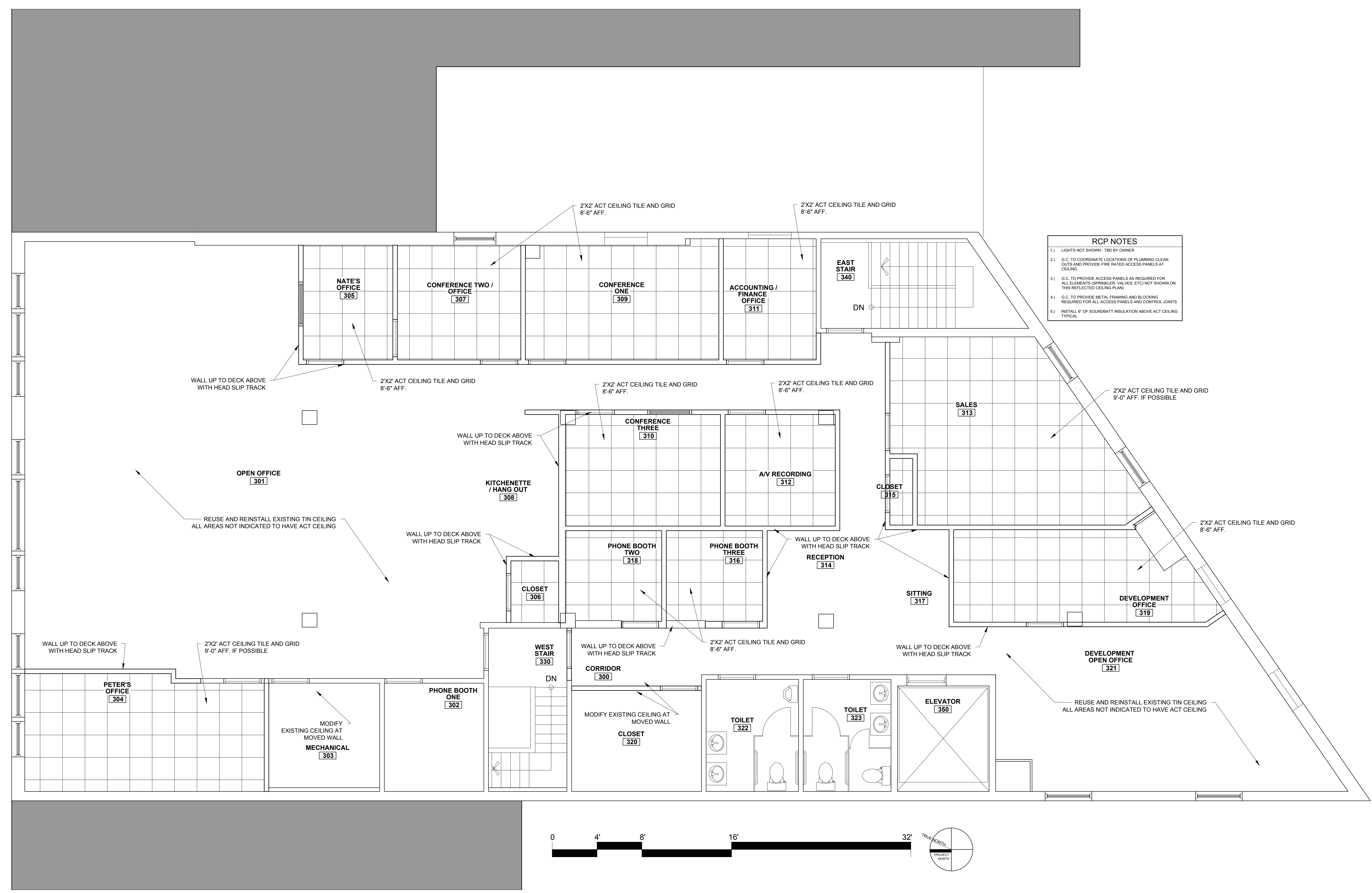

- RCP NOTES**
- 1) LIGHTS NOT SHOWN - TBD BY OWNER
 - 2) G.C. TO COORDINATE LOCATIONS OF PLUMBING CLEAN OUTS AND PROVIDE FIRE RATED ACCESS PANELS AT CEILING
 - 3) G.C. TO PROVIDE ACCESS PANELS AS REQUIRED FOR ALL ELEMENTS (SPRINKLER, VALVES, ETC) NOT SHOWN ON THIS REFLECTED CEILING PLAN
 - 4) G.C. TO PROVIDE METAL FRAMING AND BLOCKING REQUIRED FOR ALL ACCESS PANELS AND CONTROL JOINTS
 - 5) INSTALL 8" OF SOUND BATT INSULATION ABOVE ACT CEILING TYPICAL

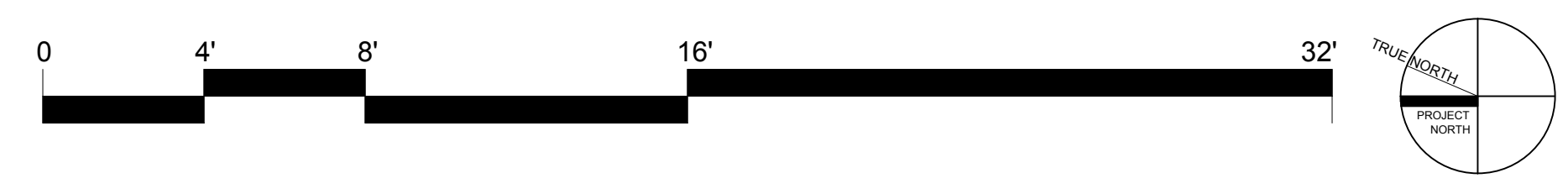

1 THIRD FLOOR REFLECTED CEILING PLAN
1/4" = 1'-0"