

EXISTING ROOF LEVEL & NEW LEVEL 3A FRAMING PLAN

1/4"=1'-0"

NOTES:

1. TOP OF SHTG EL. AT LEVEL 3A FLOOR 14'-3 3/4"
2. INDICATES SPAN DIRECTION OF 3/4" APA RATED SHEATHING.
3. H1 INDICATES (3)2x10 WOOD HEADER
H2 INDICATES (3)1 3/4x9 1/2 LVL
L1 INDICATES (2)L4x3 1/2x5/16 LLV PAINTED STEEL LINTEL
4. PROVIDE 2x4 SLEEPERS & NEW 3/4" APA RATED FLOOR SHTG THIS AREA. SEE ARCH DWGS FOR BUILD-UP DETAILS & ELEVATIONS.

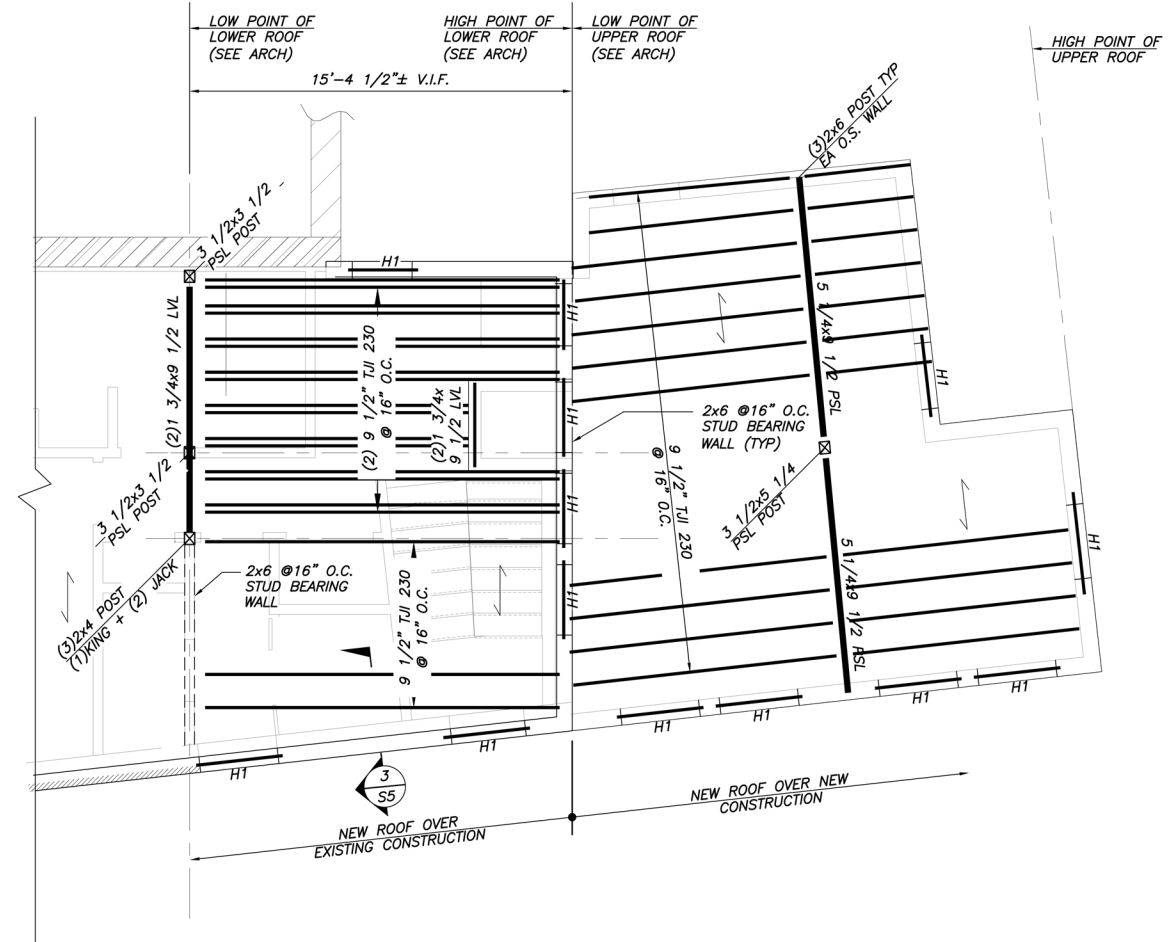

NEW ROOF FRAMING PLAN

1/4"=1'-0"

NOTES:

1. INDICATES SPAN DIRECTION OF 5/8" APA RATED SHEATHING.
2. H1 INDICATES (3)2x10 WOOD HEADER.
3. TOP OF SHTG EL. 32'-0 5/8" AT HIGH POINT.

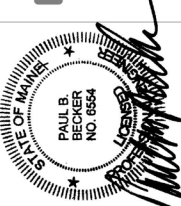

Rev No	Date	Issued For	Approved
	04/28/16	ISSUED FOR PERMIT ONLY	

**35 PLEASANT STREET
RENOVATION & ADDITION
LEVEL 3 & ROOF FRAMING PLAN**

Designed	Scale
DB	NOTED
Drawn	Date
APP	04/28/16
Checked	Becker Job Number
PBB	3620.01

THIS DRAWING IS AN INSTRUMENT OF SERVICE AND SHALL REMAIN THE PROPERTY OF BECKER STRUCTURAL ENGINEERS INC. IT SHALL NOT BE REPRODUCED, COPIED, LENT OR DISPOSED OF DIRECTLY OR INDIRECTLY NOW USED FOR ANY PURPOSE OTHER THAN FOR WHICH IT IS SPECIFICALLY FURNISHED AND MUST BE RETURNED TO BECKER STRUCTURAL ENGINEERS INC. ON COMPLETION OF WORK, IF REQUESTED.