

Door Schedule - Exterior doors by Thermotech						
No.	Size	WXH	Type	Material	Function	Comments
B01	3'-0"X 8'-0"	v.i.f.		Fiberglass		Exterior w/ full tempered light
B02	Existing					
B03	3'-0"X 6'-8"			Wood-solid core	Privacy	
B04	4'-0"X 3'-4"	v.i.f.		Wood-hollow core	Passage	Pair / Confirm ht.
B05	3'-0"X 6'-8"			Wood-solid core	Passage	
101	3'-0"X 7'-0"			Fiberglass		Exterior / solid panel
102	4'-0"X 6'-8"			Wood-solid core	Closet	Pair w/roller catch
103	Existing				Privacy	Pair / Confirm size
104	2'-8"X 6'-8"			Wood-solid core	Privacy	
105	2'-10"X 6'-8"			Wood-solid core		Pocket door w/recessed pull
106	2'-0"X 6'-8"			Wood-solid core	Passage	
107	2'-6"X 6'-8"			Wood-solid core	Privacy	
108	2'-6"X 6'-8"			Wood-solid core	Passage	Vent ?
109	3'-0"X 6'-8"			Wood-solid core	Privacy	Transom above
110	3'-0"X 6'-8"			Wood-solid core	Closet	
111	4'-0"X 6'-8"			Wood-solid core	Closet	Pair w/roller catch
112	2'-6"X 6'-8"			Wood-solid core	Closet	
113	Existing				Privacy	Rolling (top hung) Confirm size
201	3'-0"X 4'-8"	v.i.f.		Fiberglass		Exterior(outward acting) Solid panel

Window Types		Window Schedule	
	Fixed Storefront	Type	Size WXH Qty. Comments Type
	Fixed	A	6'-10"X 7'-4" 1 Fixed / Tempered / Nail/g fin A
	Fixed / Single Hung*	B	1'-9"X 1'-2" 1 Fixed / Tempered B
	Casement	C	0'-11"X 2'-0" 1 Casement C
	Awning	D	3'-0"X 2'-9" 1 Fixed / Tempered / Nail/g fin D
	Fixed / Awning	E	2'-10"X 5'-6" 4 Awning w/ fixed above E
		F	2'-8"X 5'-6" 2 Awning w/ fixed above F
		G	3'-2"X 5'-6" 1 Awning w/ fixed above G
		H	4'-2"X 2'-10" 1 Fixed / Tempered / Nail/g fin H
		I	2'-10"X 2'-9" 3 Awning / Tempered I
		J	0'-9 1/2"X 3'-6" 1 Fixed / Tempered J
		K	2'-9"X 1'-7" 4 Awning / Tempered K
		* L	3'-0"X 5'-1" 1 Single Hung* / Tempered L*
		M	3'-0"X 3'-0" 2 Awning / Tempered M
		N	3'-0"X 3'-0" 1 Fixed / Tempered N

Notes:  
 - See A1.3 for building elevations and window swings  
 - Confirm all window dimensions on site before ordering.  
 - Windows to be Thermotech Fiberglass Triple glazed fixed window w/ 2 SuperSpacer & 2 (low-e & argon).  
 - No brickmold or nail/g fin unless noted  
 - U-Value: 0.19 (0.16 glass)  
 - SHGC: 0.42 (0.61 glass)  
 - Visible light transmittance: 0.63  
 - Exterior Color: Black  
 - Interior hardware finish:  
 - Interior finish:  
 - \* denotes egress unit  
 - Provide screens w/ all operable units  
 - Extension jambs by Builder

**Door and Window Schedules**  
 SCALE: 1/2" = 1'-0" See A1.1 for Plans & A1.3 for Elevations

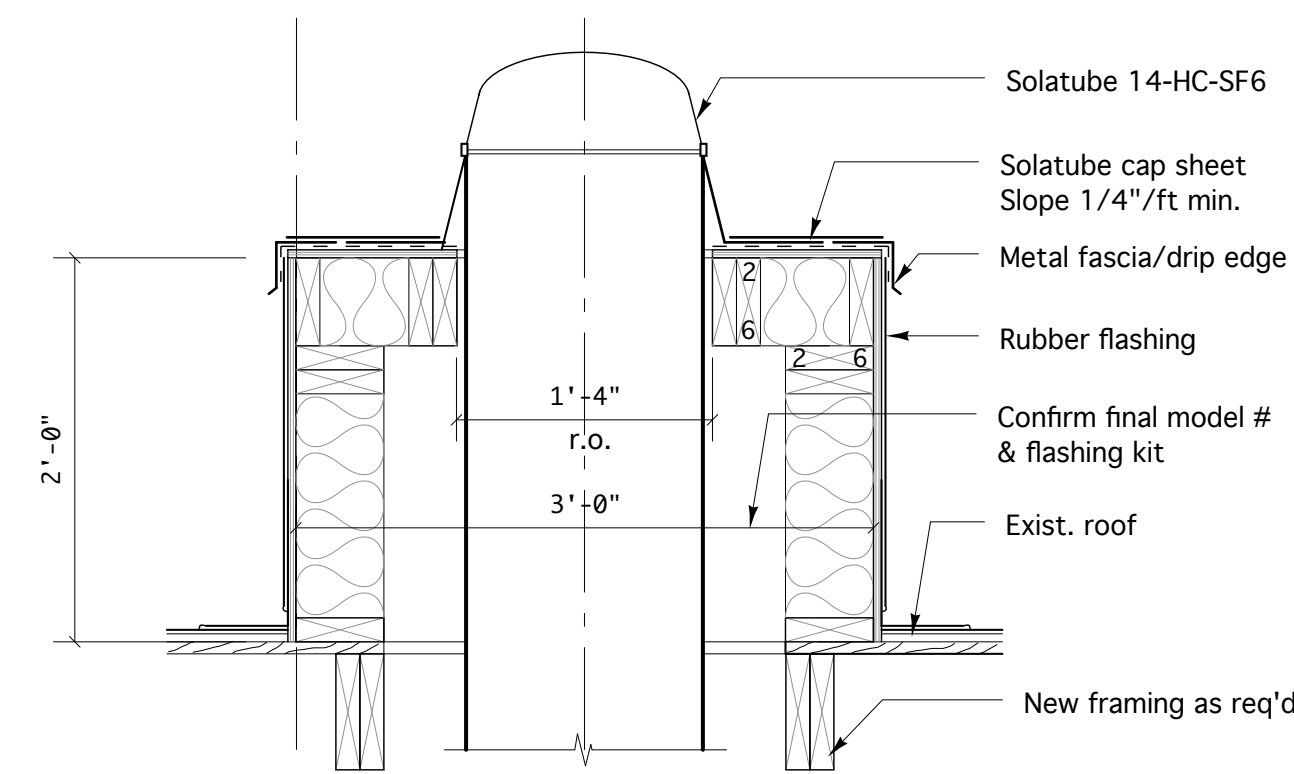

**4 Roof 'Tube Light' - Section**  
 SCALE: 1" = 1'-0"

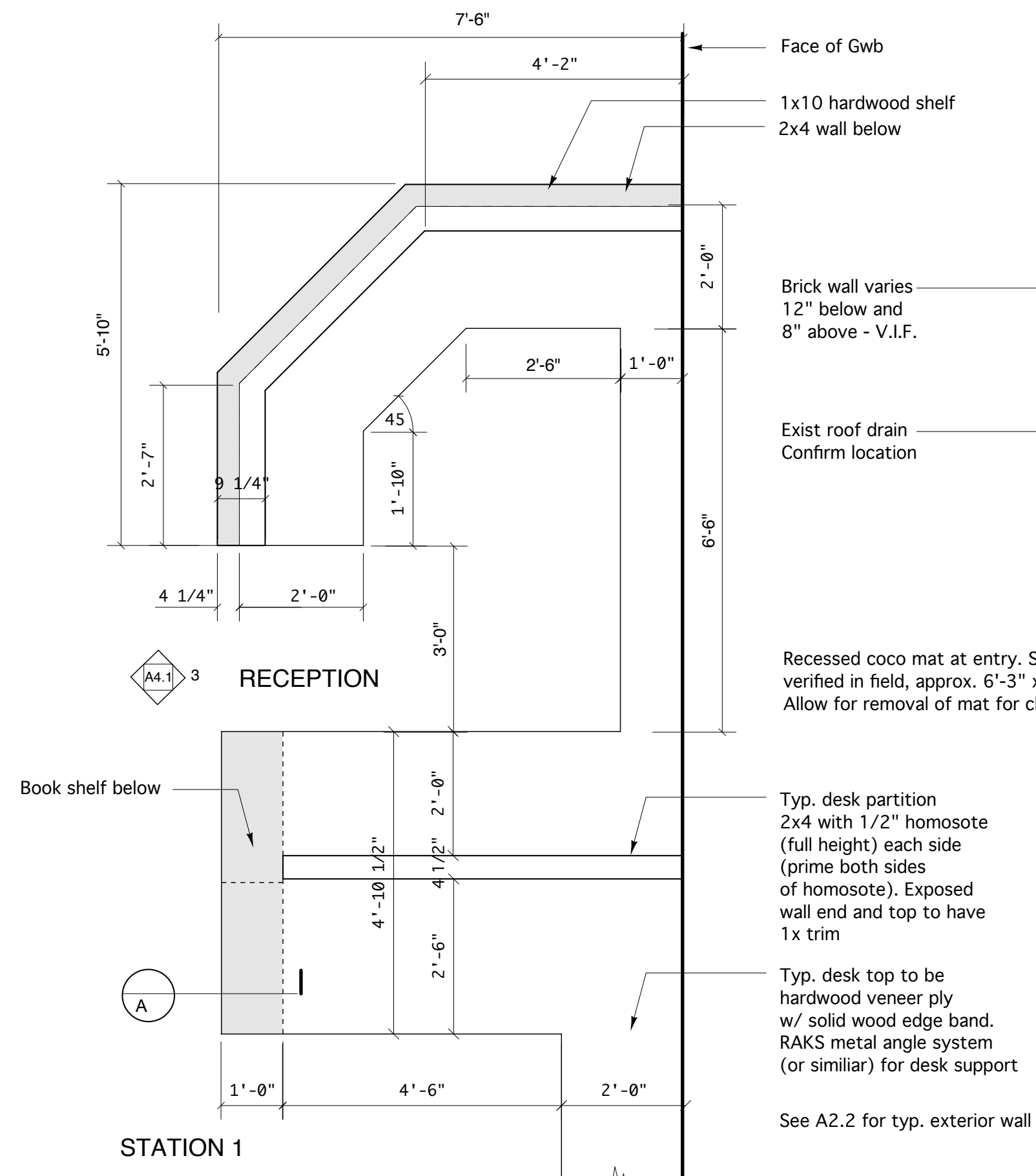

**3 Reception Desk - Plan**  
 SCALE: 1/2" = 1'-0" See A1.1 for Office Plan  
 All dimensions are from face to face of desks/millwork unless noted

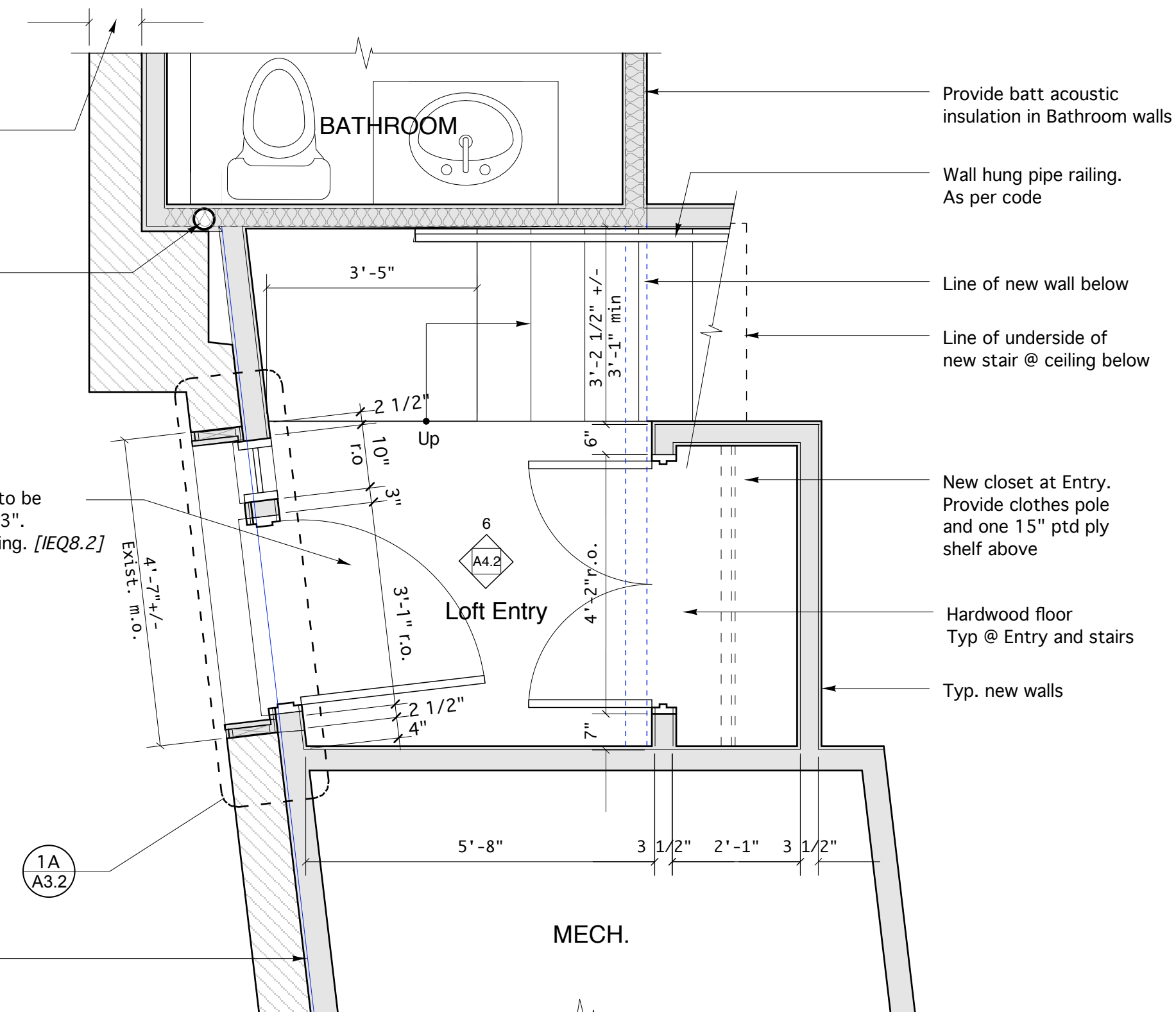

**2 Loft entry - Plan**  
 SCALE: 1/2" = 1'-0" See A1.1 for Loft Plan

**General Notes**  
 All dimensions are from face of stud to face of stud unless noted  
 Verify all dimensions in the field. Notify Architect of significant discrepancies.

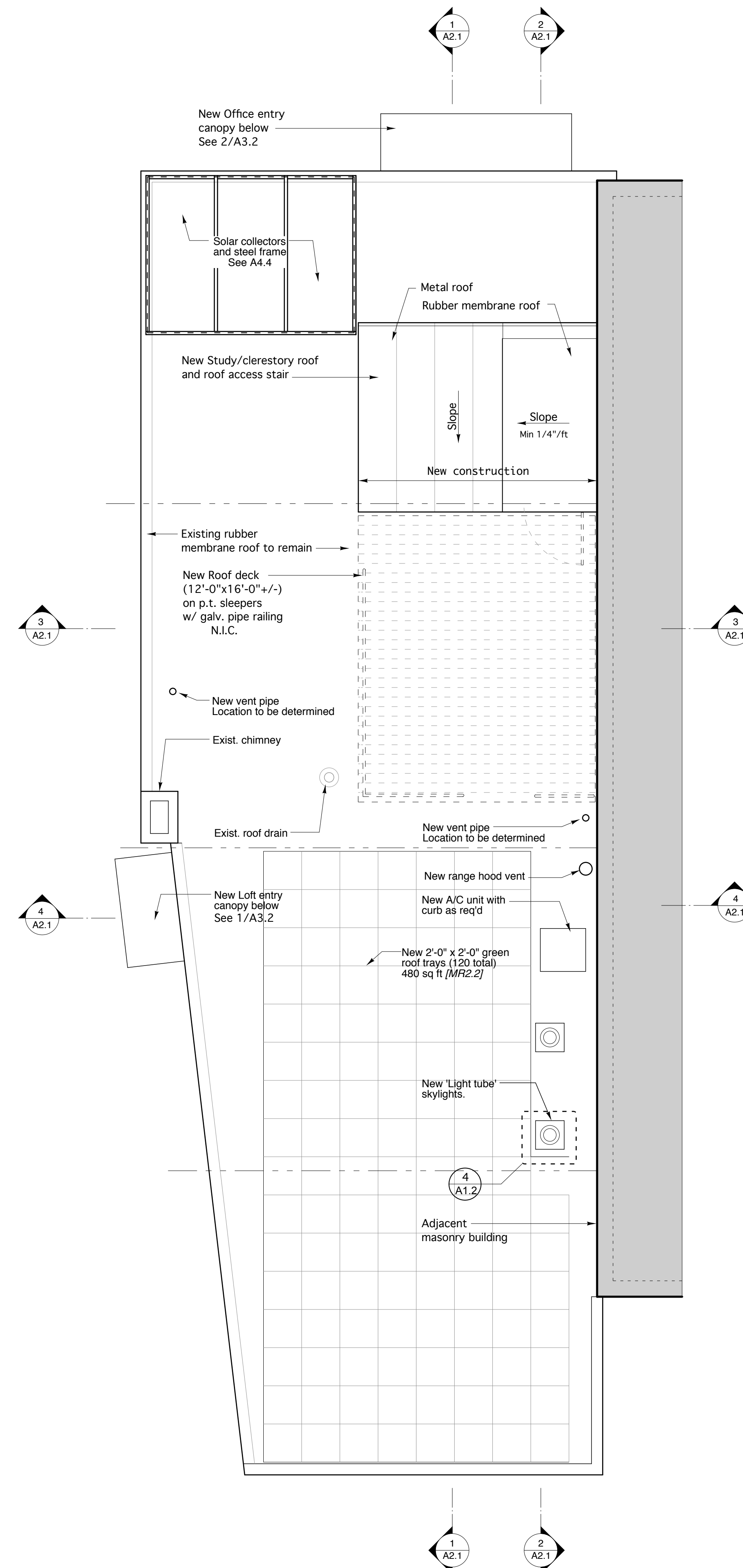

**1 Roof Plan**  
 SCALE: 1/4" = 1'-0"



**Richard Renner/Architects**  
 61 Pleasant Street  
 Suite 105  
 Portland, ME 04101  
 207.735.9599 fax  
 207.735.9599 fax

**Consultants:**

**35 Pleasant Street  
 Office and Loft Renovation**  
 35 Pleasant Street  
 Portland, Maine

**Roof Plan and Schedules**  
 Drawn by: File Name: A1.2 RoofPlan  
 Scale: As noted Project No. 2006-08  
 Date: 12.15.06 Revised:

**A1.2**