

Prepared For:
**LAFAYETTE
 PROPERTIES,
 LLC**
 155 LITTLEFIELD STREET
 BANGOR, MAINE 04401

Consultant:
Building Envelope Specialists
PO BOX 23897 SOUTH PORTLAND, MAINE 04116
 PHONE: 207-400-0886

Architect:
**ARCHETYPE
 architects**
 48 Union Wharf Portland, Maine 04101
 (207) 772-6022 ARCHETYPE@ARCHETYPEPA.COM

Project:
Holiday Inn
 88 Spring Street
 Portland, ME

Revisions:
 MARCH 3, 2017 95% CLIENT REVIEW
 JULY 10, 2017 CLIENT FINAL REVIEW

Date: **June 30, 2017**
 Scale: **As indicated**
DETAILS

BE13

NEW FULLY ADHERED 90 MIL EPDM ROOF
 MEMBRANE OVER 3/8" DENS DECK OVER
 NEW 2" POLYISOCYANURATE INSULATION
 AND NEW WOOD CURB MECHANICALLY
 FASTEN THROUGH DENS DECK TO METAL
 DECK BELOW

STANDARD EPDM TIE-IN WITH SEALANT

NEW BLOCKING

NEW MULTI PIECE BREAK METAL COPING
 WITH CONTINUOUS CLEATS HURRICANE
 NAILING OF BREAK METAL REQUIRED W/
 STAINLESS STEEL RING SHANK NAILS

V FORCE VAPOR BARRIER OR EQUAL

PAD OUT STEEL WITH 2X AND 5/8" PLYWOOD
 FOR SECURE CONNECTION AND BACKING
 OF BREAK METAL

BOTTOM CLEAT TO CREATE A PAN UNDER
 STRUCTURE

1/2" DIA. WEEP HOLES 24" O.C.

NEW CURTAIN WALL SYSTEM

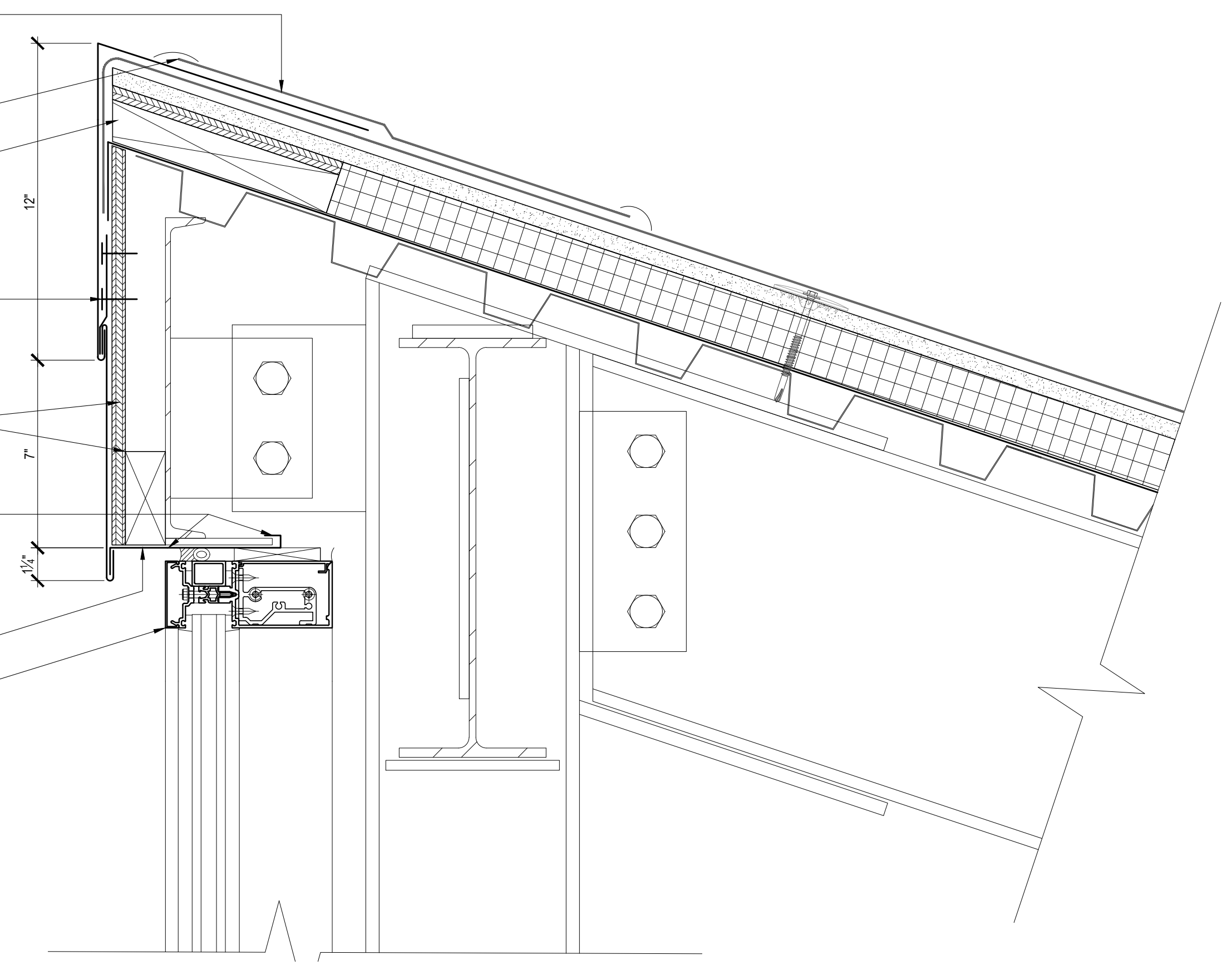

2 OVERSTORY ROOF DETAIL

SCALE: 3" = 1'-0"

SCALE: 3" = 1'-0"

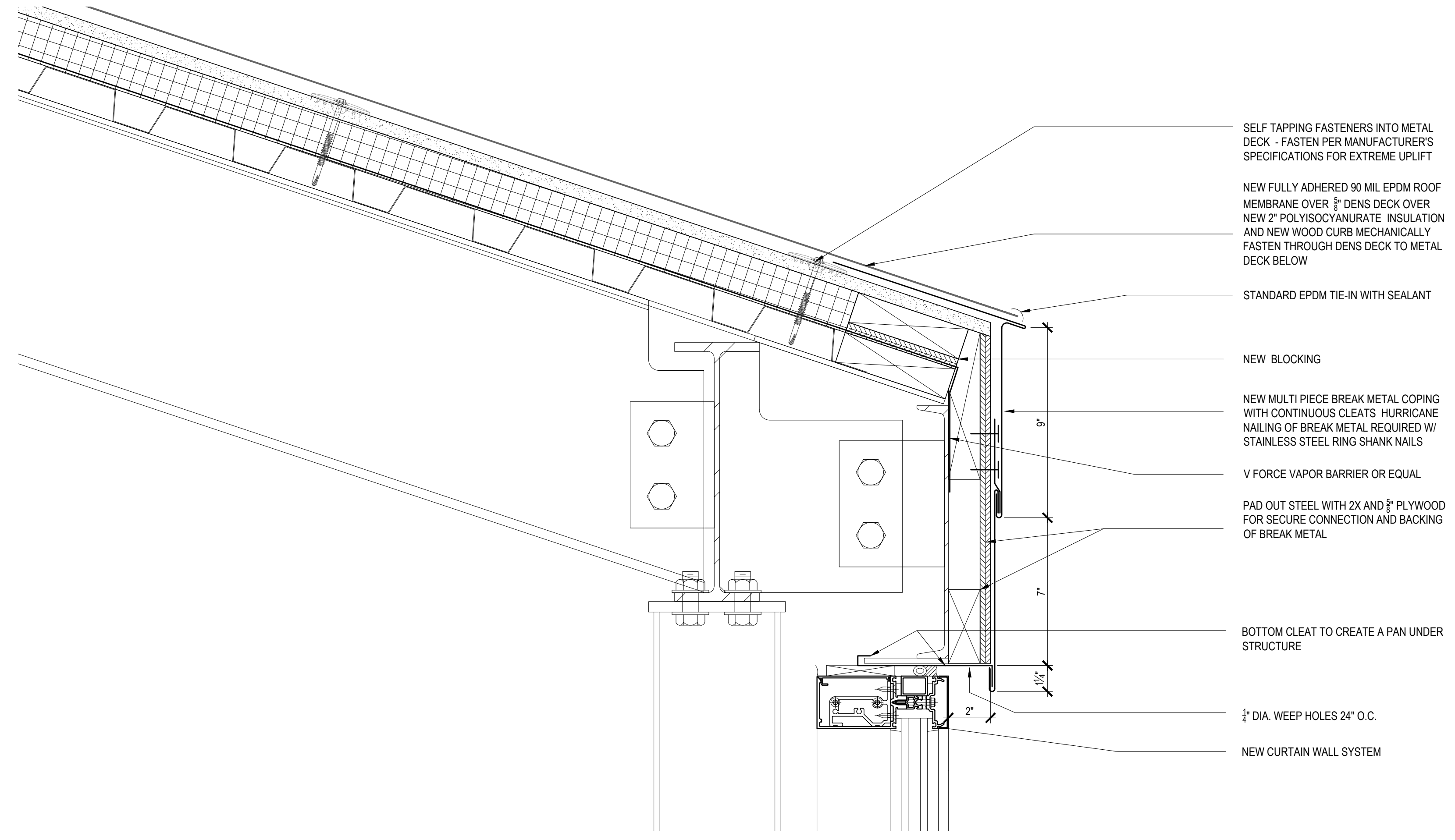

1 OVER STORY ROOF DETAIL

SCALE: 3" = 1'-0"

SCALE: 3" = 1'-0"