

THIRD FLOOR STAIR PLAN  
1/4" = 1'-0"

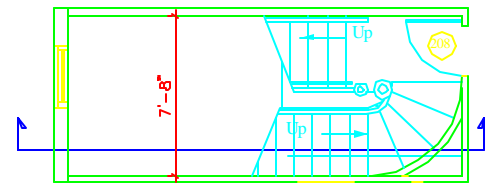

SECOND FLOOR STAIR PLAN  
1/4" = 1'-0"

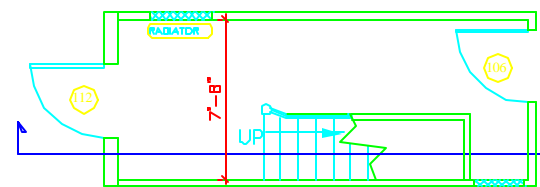

FIRST FLOOR STAIR PLAN  
1/4" = 1'-0"

LEGEND

NEW 1-HOUR RATED BEARING WALL (2X4 STUDS @ 16" O.C. W/ 5/8" G.B. BOTH SIDES)

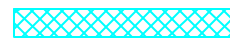

KEYED NOTES LEGEND

- ① CURVED PORTION OF WALL
- ② EXISTING FLOOR SYSTEM - 4X8 JOISTS @ 24" O.C. (V.J.F.)
- ③ EXISTING BEARING WALL (2X STUDS W/WOOD LATH & PLASTER BOTH SIDES)
- ④ REMOVE EXISTING FLOOR SYSTEM SHOWN DASHED - 4X8 JOISTS @ 24" O.C. IS TYPICAL
- ⑤ NEW 1-HOUR RATED BEARING WALL (2X4 STUDS @ 16" O.C. W/ 5/8" G.B. BOTH SIDES)
- ⑥ NEW LANDING
- ⑦ NEW WOOD STAIR W/42" GUARD RAILING AND 34" HANDRAIL BOTH SIDES.
- ⑧ NEW BEAM TO HEAD OFF EXISTING FLOOR FRAMING.
- ⑨ NEW 10" DIA. NON-STRUCTURAL FIBERGLASS COLUMN. - PTD.
- ⑩ TERMINATE EXISTING WOOD RAILING AT NEW COLUMN.
- ⑪ UNDER FOOTPRINT OF STAIRWELL INSTALL (2) LAYERS 5/8" FIRECODE C GYP. BD., TAPED.
- ⑫ INSTALL (2) 2X FIRE STOP BETWEEN JOISTS AT STAIRWELL.
- ⑬ (3) 2X SOLID BLOCKING
- ⑭ NEW 2x4 @ 16" O.C. WALL W/5/8" FIRECODE "C" G.B. BOTH SIDES, ALIGN WITH STAIRWELL WALL ABOVE.

ARCHETYPE, P.A.  
ARCHITECTS  
48 Union Wharf Portland, Maine 04101  
(207) 772-8022 Fax (207) 772-4056

Project:  
**90 - 92 HIGH STREET RENOVATIONS**  
90 - 92 HIGH STREET  
PORTLAND, MAINE

Date	Drawn By	Revisions

STAIR SECTION

A8