

- REFLECTED CEILING NOTES:**
1. FIRE SPRINKLERS SHALL BE LOCATED IN ALIGNMENT WITH OTHER CEILING ITEMS, TYPICALLY.
 2. FIRE SPRINKLERS SHALL BE CENTERED IN CEILING TILE.
 3. FIRE SPRINKLERS SHALL BE PLACED TO COORDINATE WITH LIGHT FIXTURE POSITIONS INDICATED.
 4. ALIGN CEILING ITEMS AS SHOWN, WITH COMMON CENTERLINES, INDICATED OTHERWISE.
 5. REFER TO ROOM FINISH SCHEDULE FOR CEILING HEIGHTS AND CEILING FINISHES TO BE PROVIDED.
 6. EXCEPT WHERE INDICATED, CENTER CEILING GRIDS IN ROOMS. USE HALF-TILES OR GREATER @ PERIMETERS AS POSSIBLE.
 7. PROVIDE ACCESS PANELS AS REQUIRED IN GYM CEILING FOR ACCESS TO MECHANICAL VALVES/ CONTROLS. REFERENCE MECHANICAL.

- SYMBOL LEGEND**
- 2x2 SUSPENDED CEILING PANEL AND GRID ASSEMBLY.
 - 2x4 SUSPENDED CEILING PANEL AND GRID ASSEMBLY.
 - OWB CEILING.
 - 1x4 PENDANT LIGHT FIXTURE.
 - DOWN LIGHT.
 - CEILING MOUNTED EXIT LIGHT.
 - RETURN AIR GRILLE.
 - SUPPLY AIR GRILLE.
 - EXHAUST AIR GRILLE.
 - RADIANT CEILING PANEL. SEE MECH ACCESS PANEL. - FINAL QUANTITIES, SIZES AND LOCATIONS TO BE DETERMINED IN FIELD.

- FLOOR PLAN NOTES:**
1. DO NOT SCALE THE DRAWINGS.
 2. EACH TRADE TO PROVIDE SMOKE OR FIRE SEALANT AT PENETRATIONS AS REQUIRED FOR WALL TYPE. ALL SEALANT, FIRE STOPPING, AND SMOKE STOPPING ASSEMBLIES SHALL BE U.L. LISTED.
 3. DIMENSIONS ARE FACE OF CONCRETE, FACE OF MASONRY, FACE OF PARTITIONS AND 8" FROM CORNER IN STUD UNLESS INDICATED OTHERWISE.
 4. REFER TO ALL CONSTRUCTION DOCUMENTS FOR REQUIREMENTS WORK. MAY AFFECT THE WORK IN ANOTHER AND COORDINATE.
 5. REFERENCE DETAILS FOR ADDITIONAL DIMENSIONAL INFORMATION.
 6. DOOR JAMBS SHALL BE LOCATED 6" FROM CORNER IN STUD UNLESS INDICATED OTHERWISE.
 7. PROVIDE BLOCKING IN WALLS AS NECESSARY WHERE CASEWORK, SHELVES, HANDRAILS, AND MISC. EQUIPMENT ARE LOCATED.
 8. PATCH ALL HOLES, WALLS AND CRACKS IN ROOMS TO RECEIVE NEW PAINT.
 9. G.C. TO CONTRIN EXISTING WALL RATINGS.
 10. FURNITURE DASHED IN BY OTHERS IS INDICATED FOR COORDINATION AND BLOCKING.
 11. PARTITION TYPE IS TYPICAL UNLESS NOTED OTHERWISE.

- WALL LEGEND**
- PARTITION TYPE. SEE G101
 - INDICATES NEW PARTITION/ WALL
- KEYED NOTES:**
- 1 REPAIR EXISTING OWB
 - 2 PROVIDE NEW FLOORING, PLASTIC LAMINATE PANELS AND DOORS @ FINISHES.
 - 3 REFRESH EXISTING WOOD PANELS.
 - 4 REPAIR CONCRETE MASON
 - 5 INFILL OPENING TO MATCH ADJACENT WALL CONSTRUCTION.

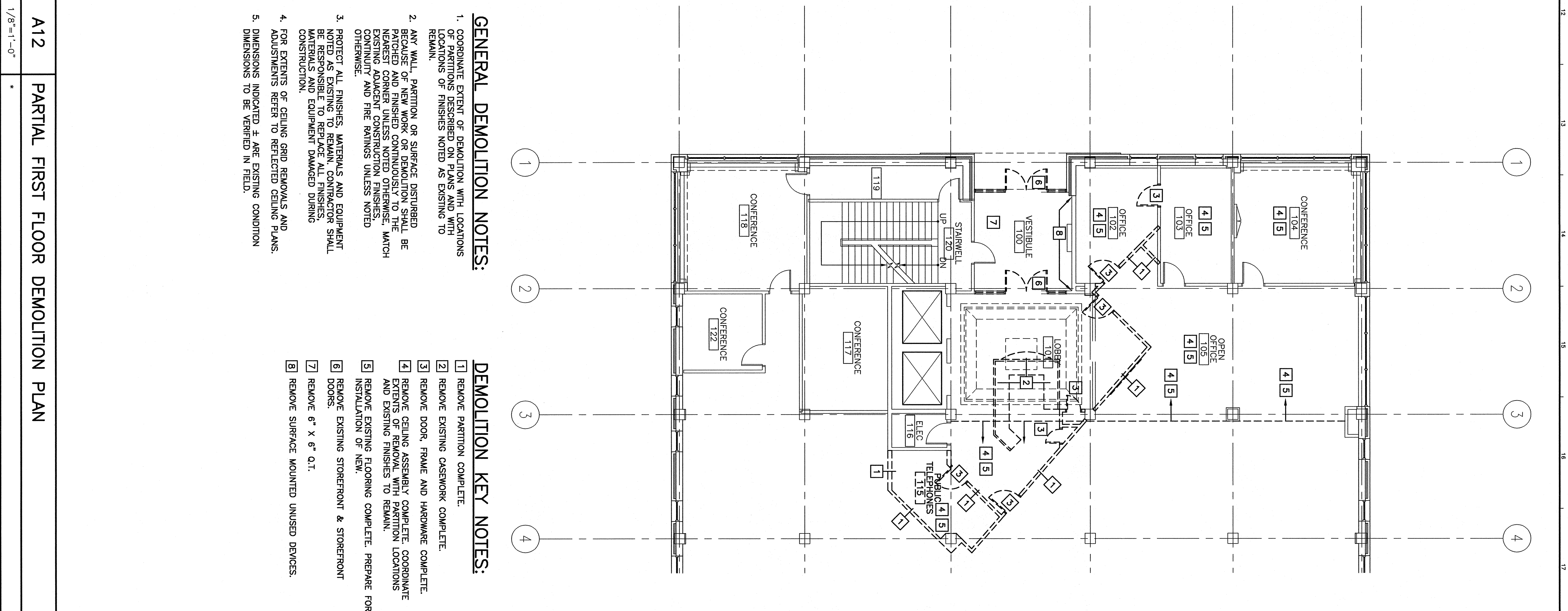
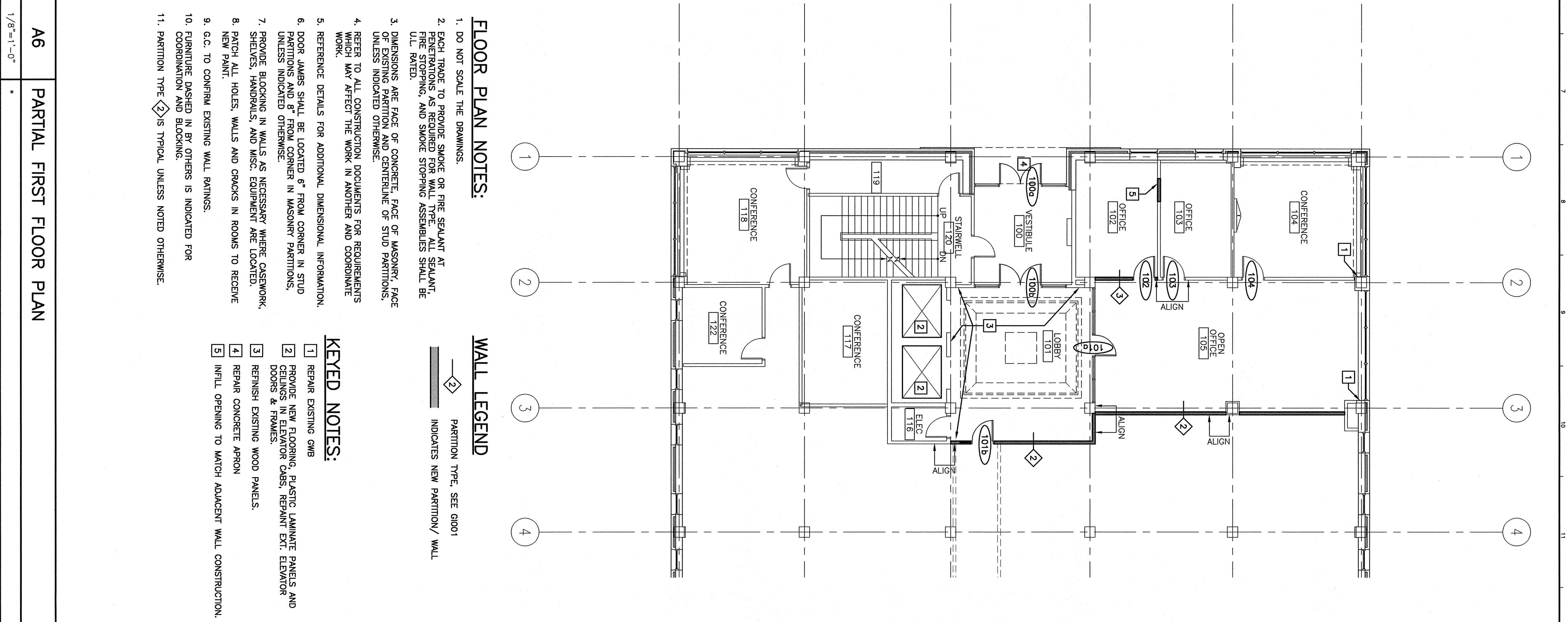

- GENERAL DEMOLITION NOTES:**
1. CONSPICUOUS EVIDENCE OF DEMOLITION WITH LOCATIONS INDICATED BY DIMENSIONS AND WORKMANSHIP LOCATIONS OF FINISHES NOTED AS EXISTING TO REMAIN.
 2. ANY WALL, PARTITION OR SURFACE DISTURBED BECAUSE OF NEW WORK OR DEMOLITION SHALL BE PATCHED AND FINISHED CONTIGUOUSLY TO THE EXISTING ADJACENT CONSTRUCTION FINISHES, WHICH CONTINUITY AND FIRE RATINGS UNLESS NOTED OTHERWISE.
 3. PROTECT ALL FINISHES, MATERIALS AND EQUIPMENT NOTED AS EXISTING TO REMAIN. CONTRACTOR SHALL BE RESPONSIBLE TO REPLACE ALL FINISHES, MATERIALS AND EQUIPMENT DAMAGED DURING CONSTRUCTION.
 4. FOR STUDENTS OF CEILING GRID REMOVALS AND ADVISMENTS REFER TO REFLECTED CEILING PLANS. DIMENSIONS INDICATED ± ARE EXISTING CONDITION TO BE VERIFIED IN FIELD.

- DEMOLITION KEY NOTES:**
- 1 REMOVE PARTITION COMPLETE.
 - 2 REMOVE EXISTING CASEWORK COMPLETE.
 - 3 REMOVE DOOR, FRAME AND HARDWARE COMPLETE.
 - 4 REMOVE CEILING ASSEMBLY COMPLETE. COORDINATE EXTENTS OF REMOVAL WITH PARTITION LOCATIONS AND EXISTING FINISHES TO REMAIN.
 - 5 REMOVE EXISTING FLOORING COMPLETE. PREPARE FOR INSTALLATION OF NEW.
 - 6 REMOVE EXISTING STOREFRONT & STOREFRONT DOORS.
 - 7 REMOVE 6" x 6" O.T.
 - 8 REMOVE SURFACE MOUNTED UNUSED DEVICES.

- GENERAL NOTES:**
1. FIELD VERIFY ALL DIMENSIONS AND LAYOUT PRIOR TO DISCREPANCIES OR INCONSISTENCIES. FAILURE TO REPORT ANY DISCREPANCIES WITHIN THESE CONSTRUCTION DOCUMENTS TO THE ARCHITECT WILL NOT BE GROUNDS FOR ADDITIONAL COST OR CHANGE ORDERS.
 2. CONTRACTOR SHALL BE RESPONSIBLE FOR PROVIDING ALL MATERIALS (UNLESS NOTED OTHERWISE), AND WORKMANSHIP IN ACCORDANCE WITH THE CITY AND LOCAL BUILDING CODES AND THEIR REQUIREMENTS.
 3. CONTRACTOR TO CONTRIN EXISTING WALL RATINGS.
 4. EACH TRADE TO PROVIDE SMOKE OR FIRE SEALANT AT PENETRATIONS AS REQUIRED FOR WALL TYPE. ALL SEALANT, FIRE STOPPING, AND SMOKE STOPPING ASSEMBLIES SHALL BE U.L. LISTED.
 5. DIMENSIONS ARE FACE OF CONCRETE, FACE OF MASONRY, FACE OF PARTITIONS AND 8" FROM CORNER IN STUD UNLESS INDICATED OTHERWISE.
 6. REFER TO ALL CONSTRUCTION DOCUMENTS FOR REQUIREMENTS WORK. MAY AFFECT THE WORK IN ANOTHER AND COORDINATE.
 7. REFER TO DETAILS FOR ADDITIONAL DIMENSIONAL INFORMATION.
 8. DOOR JAMBS SHALL BE LOCATED 6" FROM CORNER IN STUD UNLESS INDICATED OTHERWISE.
 9. PROVIDE BLOCKING IN WALLS AS NECESSARY WHERE CASEWORK, SHELVES, HANDRAILS, AND MISC. EQUIPMENT ARE LOCATED.
 10. PATCH ALL HOLES, WALLS AND CRACKS IN ROOMS TO RECEIVE NEW PAINT.
 11. DO NOT SCALE DRAWINGS.
 12. "PROVIDE" MEANS "FURNISH AND INSTALL".

REV. DESCRIPTION DATE

ISSUED FOR PERMITTING
07-18-07

CURRENT ISSUE STATUS:

PROJECT: FIRST FLOOR PARTIAL DEMO, FLOOR PLAN AND RCP

PROJECT LOCATION: 110 FREE STREET, PORTLAND, MAINE

ARCHITECT: S.M. R.T. ARCHITECTURE ENGINEERING PLANNING

144 Free Street, P.O. Box 618
Portland, Maine 04104
Tel: (207) 772-3486
Fax: (207) 772-1070

DATE: 1/8"=1'-0"

GRAPHIC SCALE: 0' 1'

PROJECT MANAGER: J.L.H.

JOB CWP/DRAWN: J.L.H.

DATE OF RECORD: AE101-07087

SHEET NO. AE101

PROJECT NO. 07087