

Project Title

**110 FREE STREET
BUILDING
RENOVATIONS**

PORTLAND, MAINE

HA Project No. **09146**

Key Plan

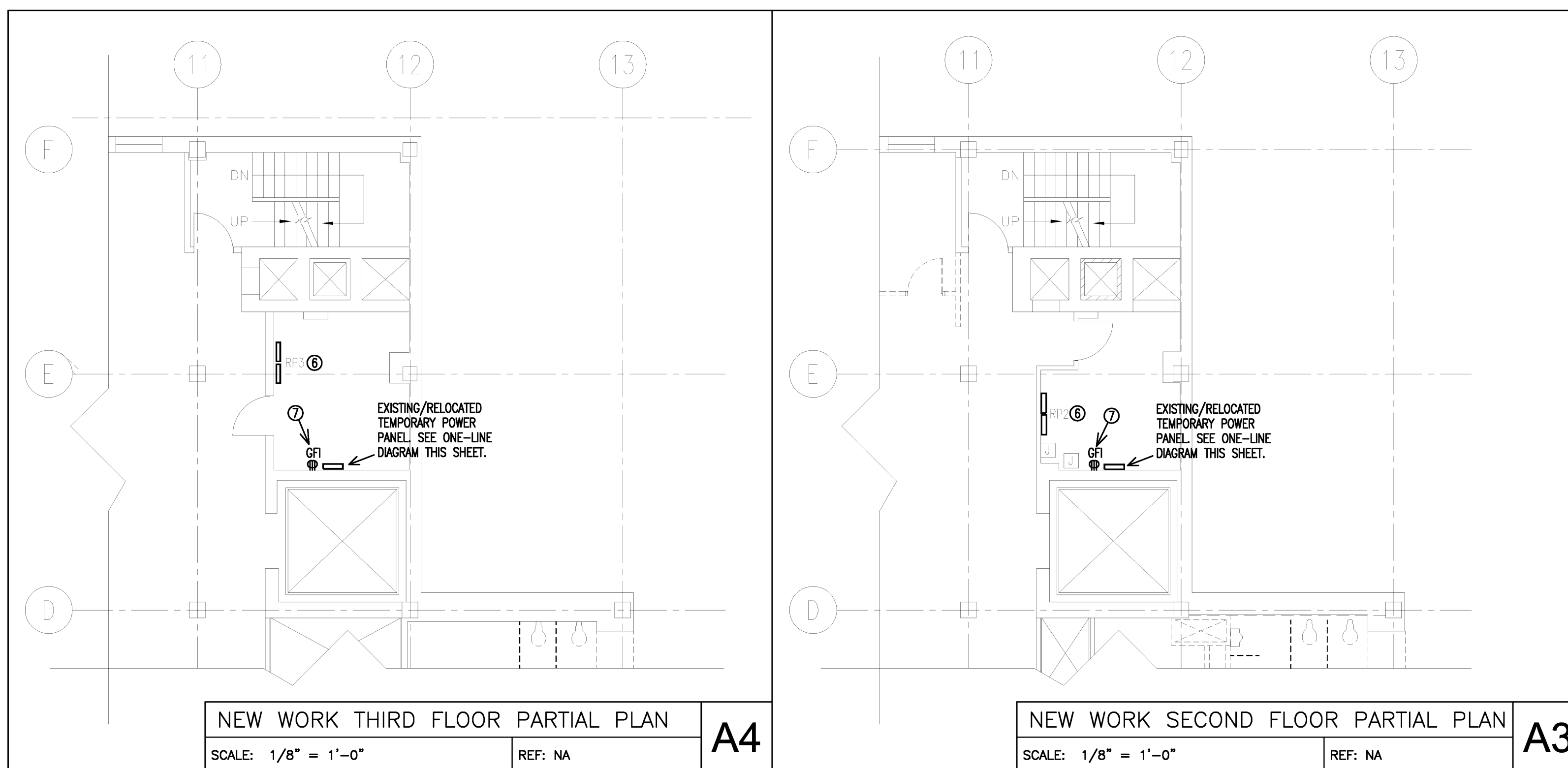

TEMPORARY NEW WORK KEY NOTES

- ① EXISTING CONDUITS THROUGH WALL TO EXISTING UNDERGROUND TRANSFORMER VAULT. COORDINATE WITH CENTRAL MAINE POWER COMPANY FOR CONNECTION REQUIREMENTS.
- ② PROVIDE ACCESS THROUGH EXISTING WALL. PROVIDE SLEEVE FOR PROTECTION OF TEMPORARY CONDUCTORS.
- ③ PROVIDE TEMPORARY 200A METER SOCKET. COORDINATE LOCATION AND REQUIREMENTS WITH CENTRAL MAINE POWER COMPANY.
- ④ TEMPORARY 200A CIRCUIT BREAKER, TEMPORARY SERVICE DISCONNECT.
- ⑤ TEMPORARY 100A CIRCUIT BREAKER TO POWER, EXISTING TO REMAIN PANEL SB1.
- ⑥ EXISTING ELECTRICAL PANEL/EQUIPMENT TO REMAIN.
- ⑦ PROVIDE DOUBLE DUPLEX RECEPTACLE. SEE GENERAL NOTES.

TEMPORARY NEW WORK GENERAL NOTES

1. PROVIDE TEMPORARY LIGHTING ON ALL FLOORS, IN ELECTRICAL ROOMS AND RECONNECT ALL STAIRWELL LIGHTING FIXTURES TO REMAIN.
2. PROVIDE ONE 120V CIRCUIT WITH DOUBLE DUPLEX, GROUND-FAULT INTERRUPTER RECEPTACLES AT EACH TEMPORARY PANEL LOCATION.
3. PROTECT ALL TEMPORARY FEEDERS/BRANCH CIRCUITS FOR FUTURE NEW CONSTRUCTION AND LOCATE AS NOT TO INTERFERE WITH NEW CONSTRUCTION.

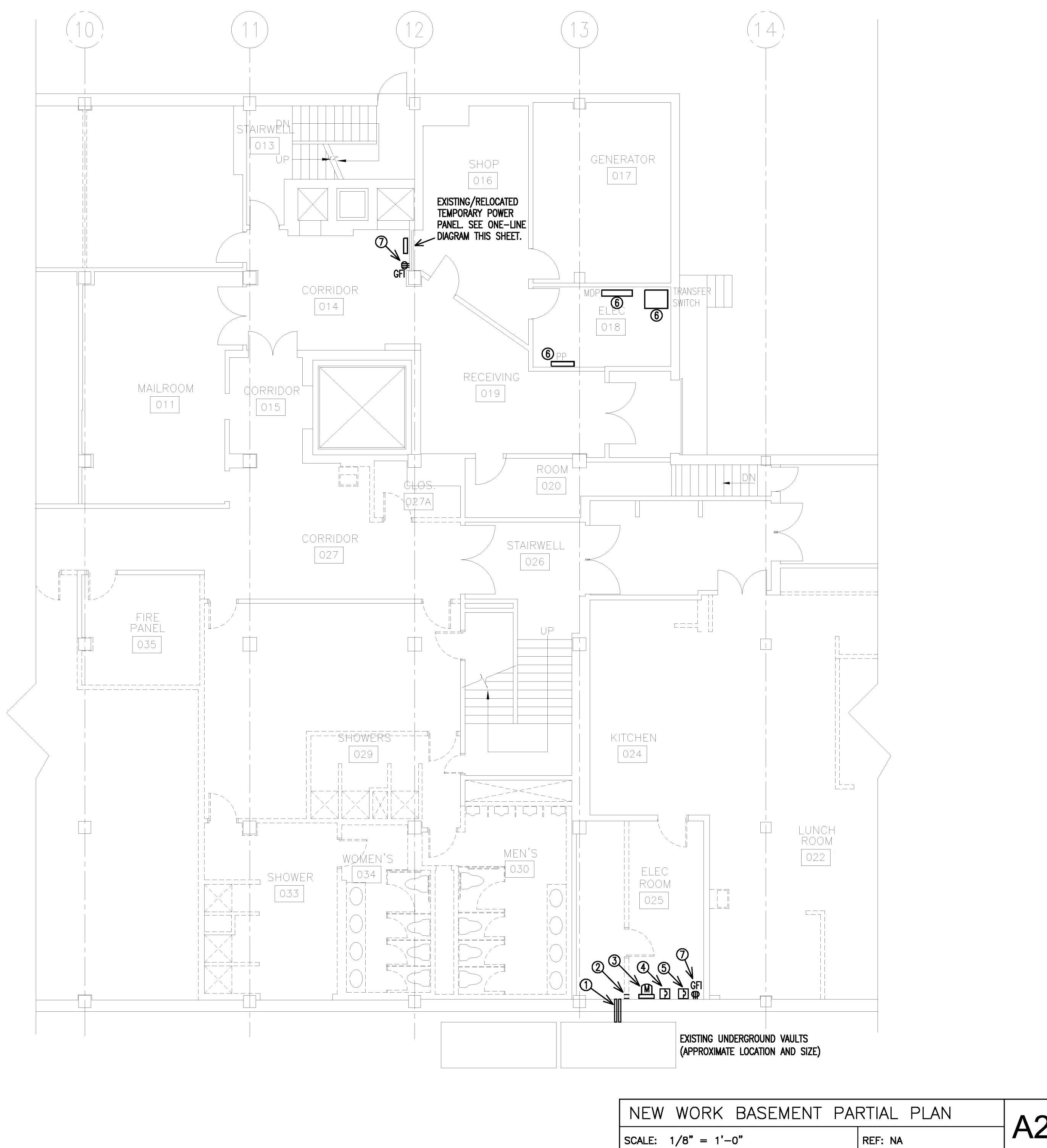

POWER ONE-LINE DEMOLITION KEY NOTES

- ① 100A TEMPORARY SERVICE CABLE (4-#3 & 1-#8 CU OR EQUIVALENT).
- ② 200A TEMPORARY SERVICE CABLE (4-#3/0 & 1-#6 CU OR EQUIVALENT).
- ③ PROVIDE #3/0, CU, GROUND IN 1" CONDUIT.
- ④ PROVIDE #3/0, CU, GROUND IN 1" CONDUIT. PROVIDE 20' OF EXTRA CONDUCTOR AT DISCONNECT FOR ATTACHMENT TO FUTURE PERMANENT SERVICE. COVER/PROTECT CABLE DURING DEMOLITION.
- ⑤ PROVIDE TEMPORARY, 200A BREAKER, 600V RATED AND ENCLOSURE. PROVIDE NEUTRAL AND GROUND BUS AS REQUIRED.
- ⑥ EXISTING ELECTRICAL EQUIPMENT, CONDUIT AND/OR CONDUCTORS. (TEMPORARY SERVICE)
- ⑦ PROVIDE TEMPORARY, 100A BREAKER, 600V RATED AND ENCLOSURE. PROVIDE NEUTRAL AND GROUND BUS AS REQUIRED.
- ⑧ EXISTING/RELOCATED TEMPORARY ELECTRICAL PANEL. COVER ALL EXISTING ACCESS HOLES IN ENCLOSURE. LOCATE IN EXISTING ELECTRICAL ROOM ON DESIGNATED FLOORS. SEE PARTIAL FLOOR PLAN THIS SHEET.
- ⑨ EXISTING/RELOCATED TEMPORARY ELECTRICAL PANEL. COVER ALL EXISTING ACCESS HOLES IN ENCLOSURE. LOCATE IN CORRIDOR. SEE PARTIAL FLOOR PLAN THIS SHEET.
- ⑩ EXISTING 200A LOAD CENTER. PROVIDE (3) 100A BRANCH BREAKERS FOR TEMPORARY POWER.
- ⑪ PROVIDE 200A METER SOCKET. LOCATION AND TYPE AS REQUIRED BY CENTRAL MAINE POWER COMPANY.
- ⑫ PROVIDE PERMANENT GROUNDING/BONDING CONNECTIONS TO EXISTING WATER SERVICES. SEE DRAWING ED06.0 AND ED06.5 FOR LOCATIONS OF WATER SERVICES.

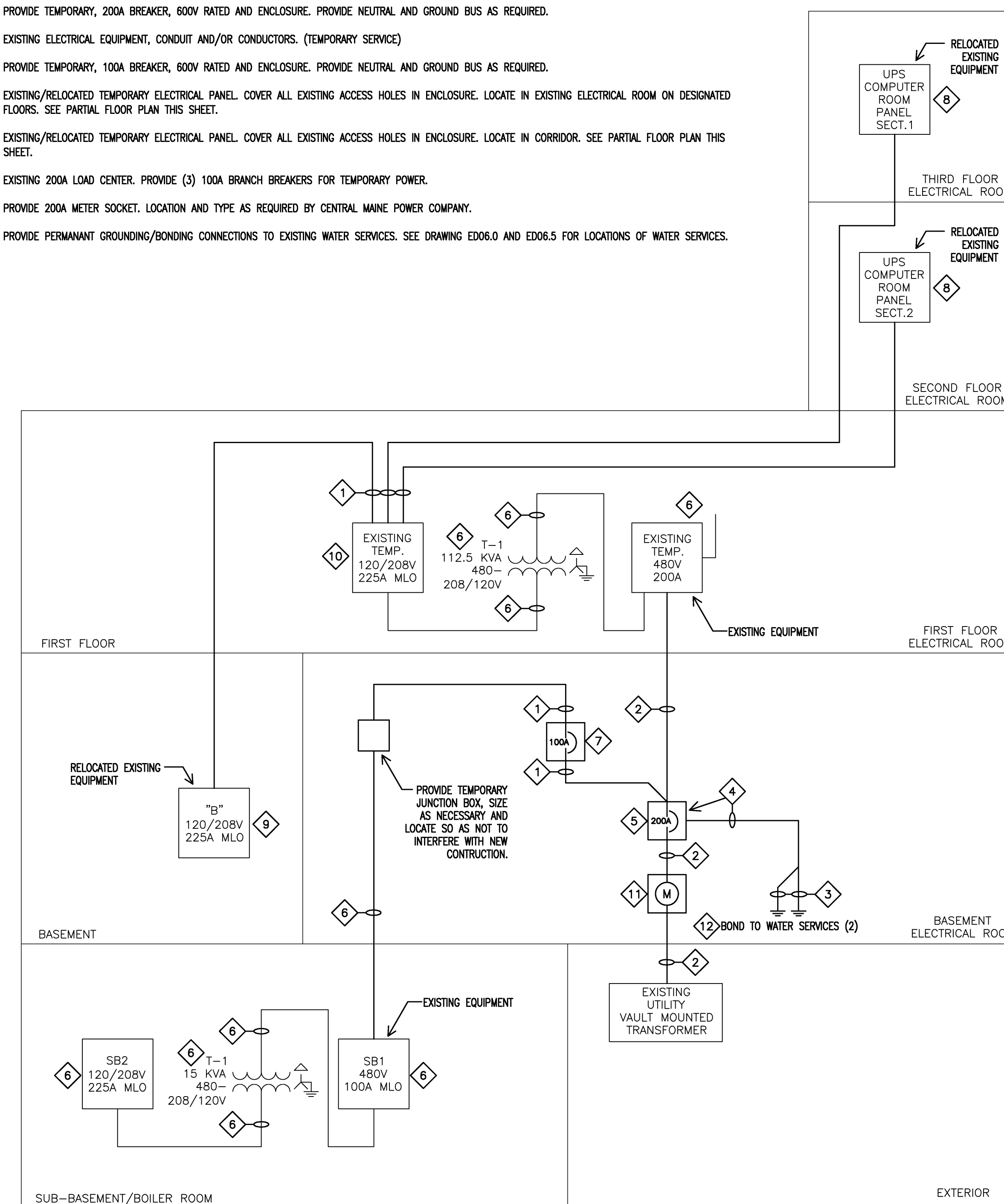

11/25/09 ISSUED FOR BID

Mark Date Description

Issue Dates

Drawing Status

**ELECTRICAL
TEMPORARY CONSTRUCTION POWER
ONE-LINE DIAGRAM/FLOOR PLAN**

PA / PE: WRH Drawn By: RJB

Drawing Number

ED40.1