

**M1 NORTH PANEL DIMENSIONS**  
1"=1'-0"

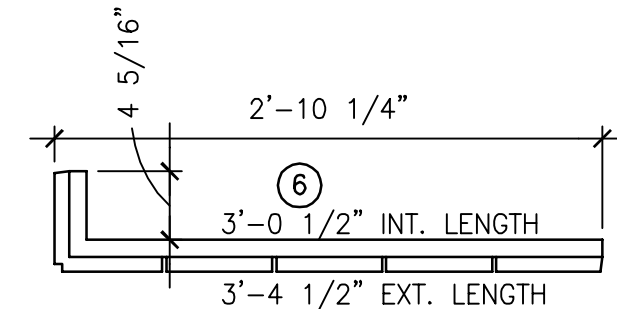

**M6 WEST PANEL DIMENSIONS**  
1"=1'-0"

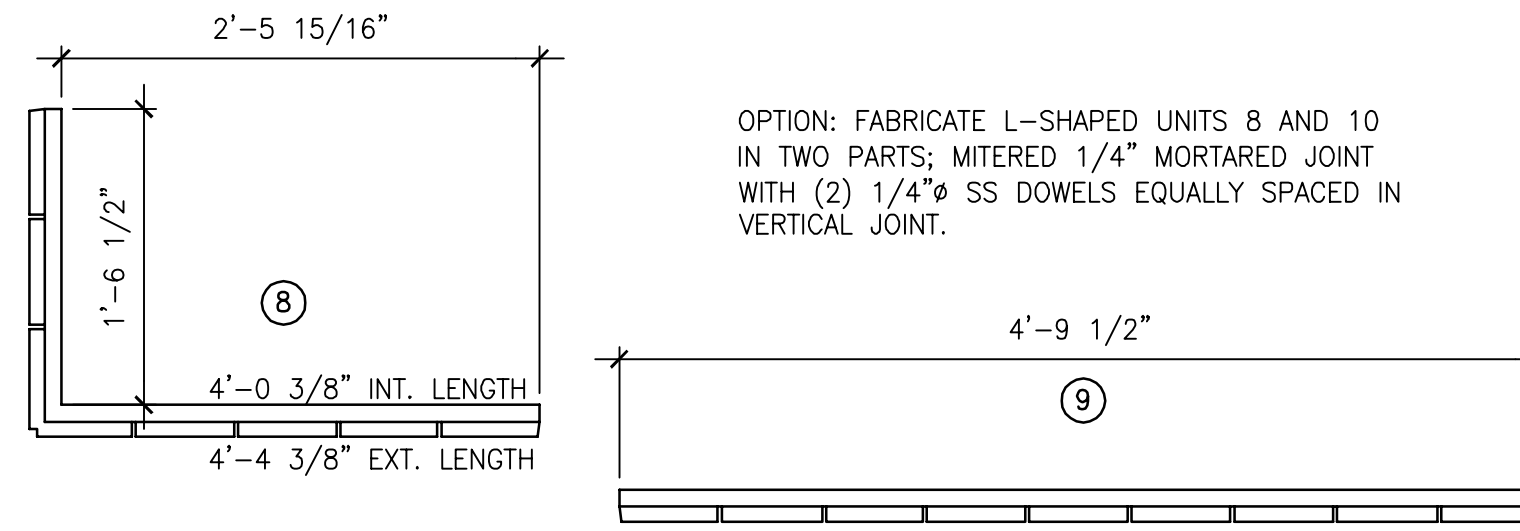

**M10 SOUTH PANEL DIMENSIONS**  
1"=1'-0"

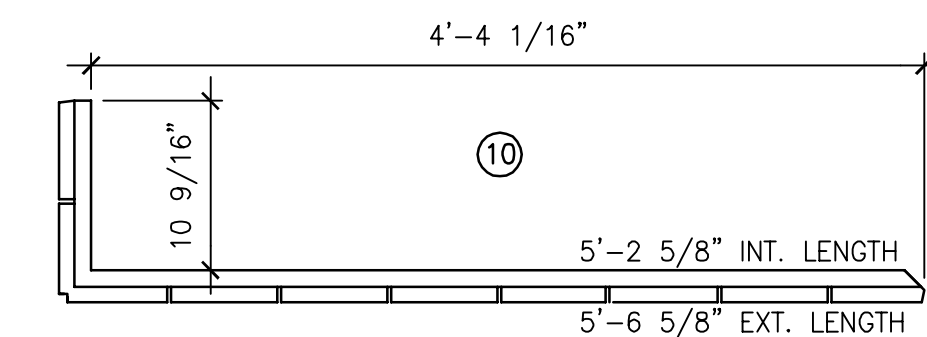

**M14 EAST PANEL DIMENSIONS**  
1"=1'-0"



**L1 NORTH - PART PLAN OF TOP EDGE**  
1"=1'-0"

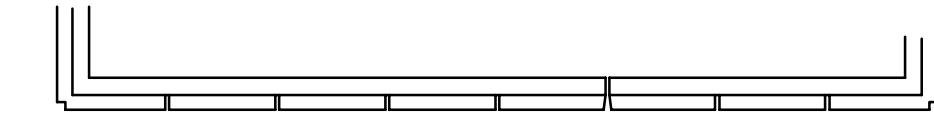

**L6 WEST - PART PLAN OF TOP EDGE**  
1"=1'-0"



**L10 SOUTH - PART PLAN OF TOP EDGE**  
1"=1'-0"



**L14 EAST - PART PLAN OF TOP EDGE**  
1"=1'-0"

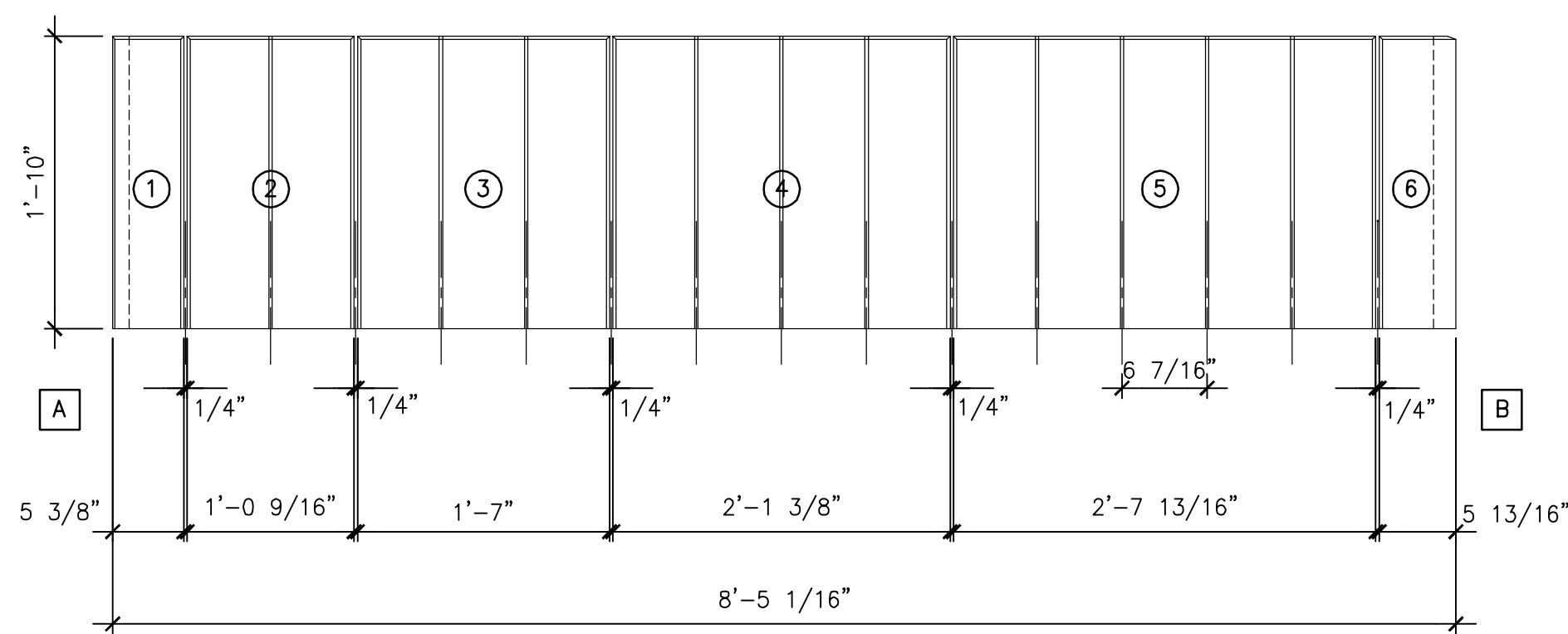

**H1 NORTH ELEVATION**  
1"=1'-0"

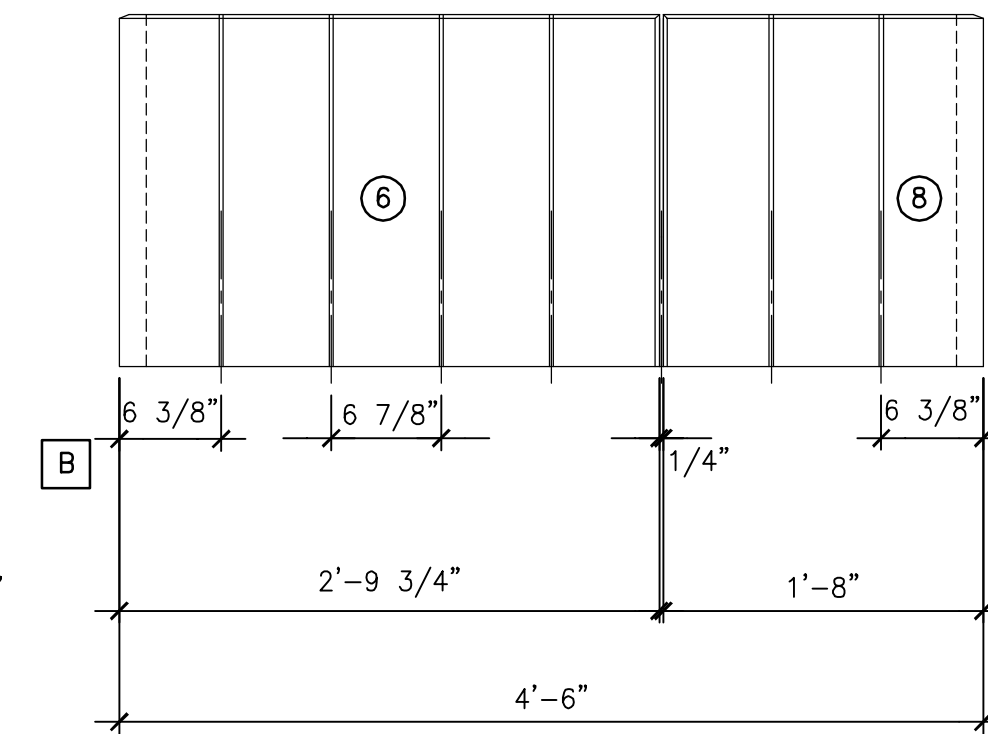

**H6 WEST ELEVATION**  
1"=1'-0"

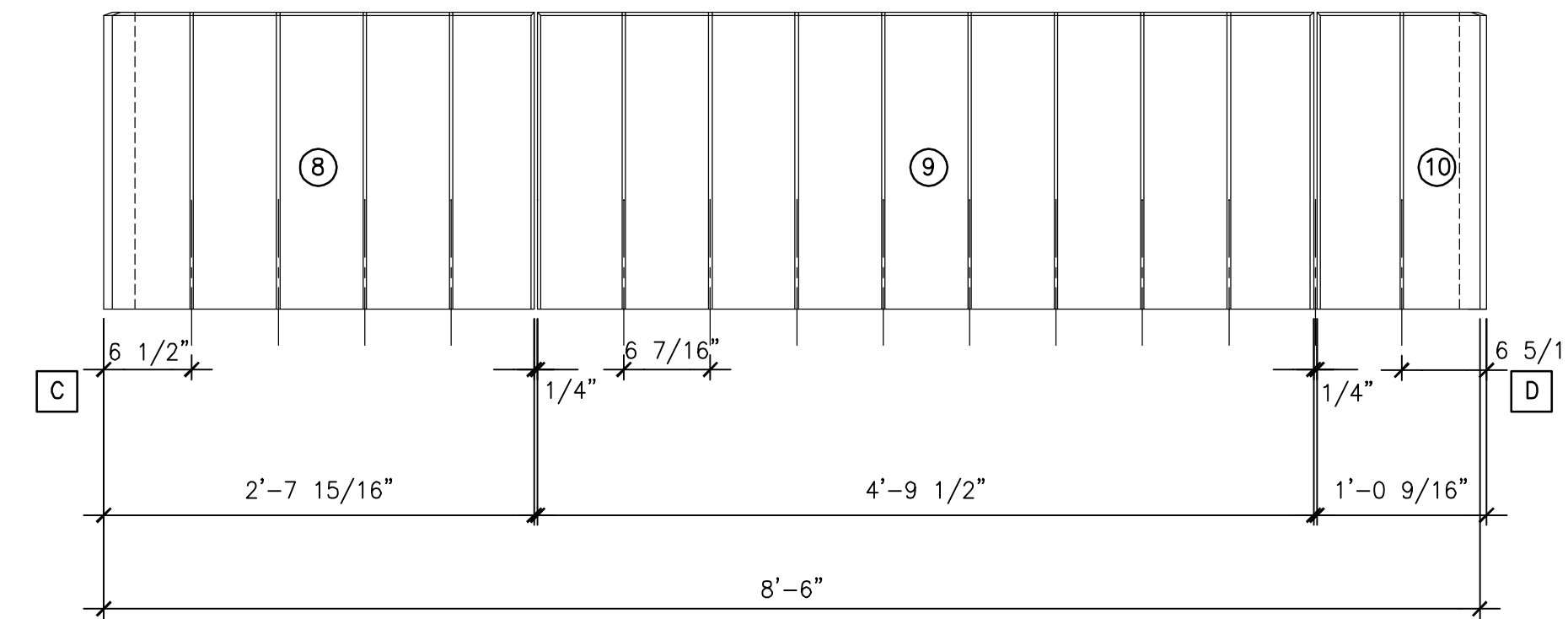

**H10 SOUTH ELEVATION**  
1"=1'-0"

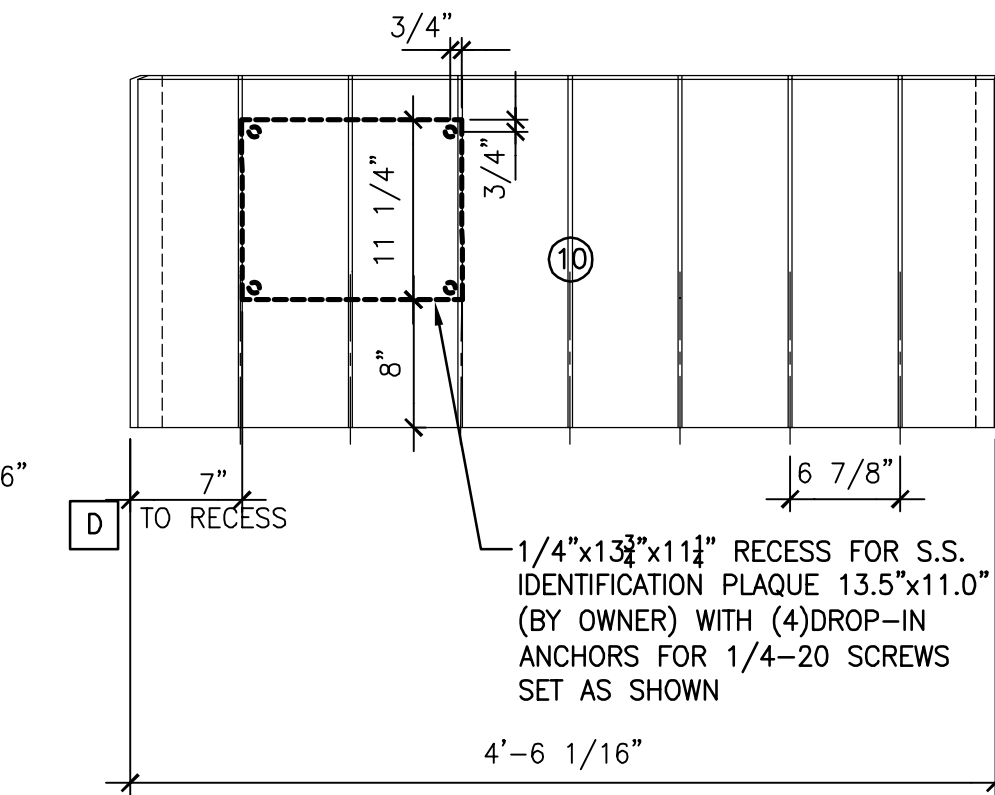

**H14 EAST ELEVATION**  
1"=1'-0"

**GENERAL**

1. VENEER IS TO BE CAST-STONE CONFORMING TO ASTM C1364 "SPECIFICATION FOR ARCHITECTURAL CAST STONE", FABRICATED BY A SINGLE SOURCE.
2. COLOR IS TO BE SATURATED BLACK (BASIS IS MGA CAST-STONE "PEWTER"); MORTAR SHALL BE PIGMENTED TO MATCH CAST-STONE. PROVIDE SAMPLE OF MATERIALS (10"x10") FOR APPROVAL PRIOR TO FABRICATION. APPLY COATING OF SEALANTS TO A PORTION OF SAMPLE TO SHOW EFFECT ON COLORING.
3. FINISHED UNITS SHALL MEET THE FOLLOWING TOLERANCES:
  - A. LENGTH: NOT TO EXCEED 1/480 OF UNIT LENGTH OR 1/8", WHICHEVER IS GREATER.
  - B. CROSS SECTION: DO NOT VARY FROM INDICATED DIMENSIONS BY MORE THAN 1/8"
  - C. WARP, BOW OR TWIST: NOT TO EXCEED 1/360 OF UNIT LENGTH OR 1/8", WHICHEVER IS GREATER.
4. CURE UNITS IN A MOIST CURING ROOM AT 95% OR GREATER RELATIVE HUMIDITY FOR 16 HOURS OR LONGER. KEEP UNITS DAMP NO FEWER THAN 6 DAYS AT A MEAN DAILY TEMPERATURE OF 60° (F).
5. ACID ETCH FINISHED/EXPOSED SIDES OF UNITS AFTER CURING TO REMOVE CEMENT FILM.
6. CAST GROOVE IN BASE OF UNITS TO RECEIVE ANCHOR, AND PROVIDE CONCEALED GROUT KEYS IN HIDDEN FACE OF PANEL.
7. SUBMIT DRAWINGS OF EACH UNIT LAYOUT. INCLUDE LOCATIONS OF KEYS, RECESSES, JOINTS AND EDGE TREATMENTS.

**MATERIALS**

1. CONCRETE USED IN VENEER IS TO HAVE A MINIMUM 28-DAY COMPRESSIVE STRENGTH OF 6500 PSI
2. AGGREGATES SHALL CONFORM TO ASTM C33, WITH A MAXIMUM SIZE OF 3/8".
3. ADMIXTURES:
  - A. DO NOT USE ADMIXTURES CONTAINING CALCIUM CHLORIDE. DO NOT USE ADMIXTURES WITH MORE THAN 0.1 PERCENT WATER-SOLUBLE CHLORIDE IONS BY MASS OF CEMENTITIOUS MATERIALS.
  - B. ONLY USE ADMIXTURES THAT ARE CERTIFIED BY MANUFACTURER AS COMPATIBLE WITH CEMENT AND OTHER ADMIXTURES USED.
  - C. WATER-REDUCING ADMIXTURES SHALL CONFORM WITH ASTM C494.
  - D. PROVIDE INTEGRAL WATER REPELLENT (LIQUID POLYMERIC) THAT DOES NOT REDUCE BOND STRENGTH (CONCRETE AND MORTAR).
4. REINFORCING SHALL BE GALVANIZED OR EPOXY COATED DEFORMED STEEL BARS (ASTM 615). PROVIDE REINFORCING AT A RATE OF 0.25 PERCENT OF CROSS-SECTIONAL AREA. NON-METALLIC, POLYMER BASED REINFORCING GRIDS MAY BE USED WITH PROJECT ARCHITECT/ENGINEER'S WRITTEN APPROVAL.
  - A. EMBEDDED ANCHORS ARE TO BE STAINLESS STEEL.
5. MORTAR
  - A. CEMENT SHALL CONFORM TO ASTM C150 (TYPE I OR II) FOR PORTLAND CEMENT AND ASTM C207 (TYPE S) FOR HYDRATED LIME. BLENDED MIXTURES SHALL BE PRE-PACKAGED, WITHOUT OTHER INGREDIENTS.
  - B. PIGMENTS (PER ASTM C979) USED SHALL BE COMPOUNDED FOR USE IN MORTAR MIXES WITH A RECORD OF SATISFACTORY PERFORMANCE. PROVIDE CEMENTS WITH NATURAL OR WHITE COLOR AS REQUIRED TO PRODUCE COLOR INDICATED.
  - C. AGGREGATE SHALL CONFORM TO ASTM C144, PROVIDE COLORED AGGREGATE AS NECESSARY TO PRODUCE REQUIRED COLOR.
  - D. MIX IN CONFORMANCE WITH ASTM C270 "PROPORTION SPECIFICATION", TYPE N.
6. GROUT
  - A. CEMENT SHALL CONFORM TO ASTM C150 (TYPE I OR II) FOR PORTLAND CEMENT AND ASTM C207 (TYPE S) FOR HYDRATED LIME. BLENDED MIXTURES SHALL BE PRE-PACKAGED, WITHOUT OTHER INGREDIENTS.
  - B. AGGREGATE SHALL CONFORM TO ASTM C404
  - C. PROPORTION GROUT PER ASTM C 476, TABLE 1; PROVIDE A SLUMP BETWEEN 8 AND 11 INCHES.
7. SEALER/FINISH: PROVIDE 2 PART ANTI-GRAFFITI SYSTEM BY NEW DIMENSIONS SOLUTIONS (OR APPROVED EQUAL) TO ALL FINISHED VENEER AND MORTAR FACES. BASE COAT OF "ONE COAT" PRIMER/SEALER, AND TOP COAT WITH "ND GRAFFITI SHIELD" (MATTE VERSION) SEALER AND FINISH. APPLY PER MANUFACTURER GUIDELINES AND PROVIDE WARRANTY MATERIALS TO OWNER.

**A1 VENEER NOTES**

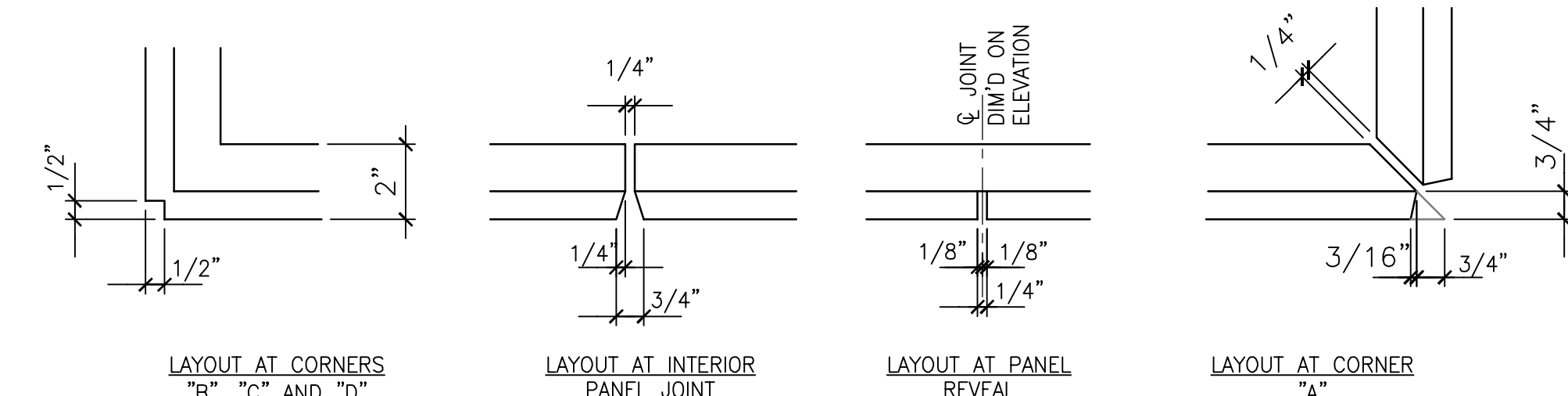

**TYPICAL JOINTS - TOP VIEW**

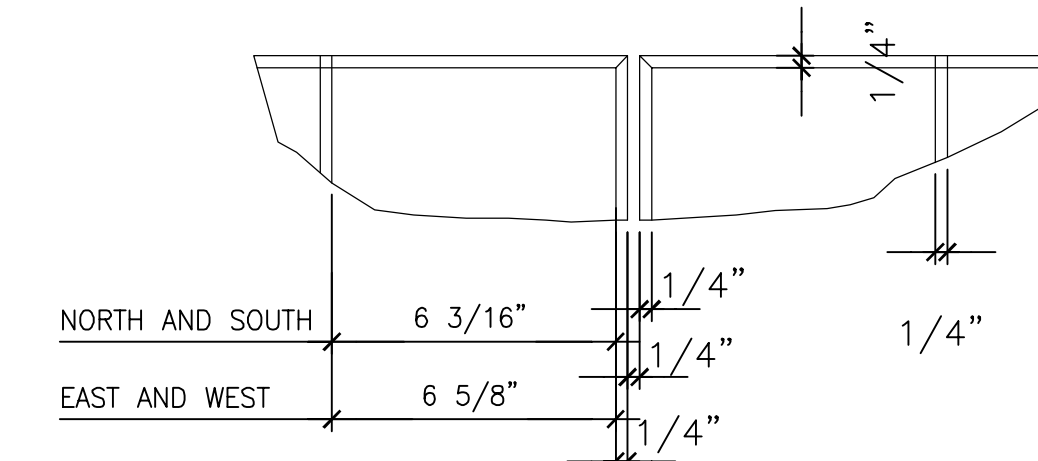

**TYPICAL JOINTS - ELEVATION**

**A11 TYPICAL PANEL JOINT DETAILS**  
3"=1'-0"

144 Elm Street, PO Box 819  
Portland, Maine 04104  
Tel: (207) 772-2846  
Fax: (207) 772-070  
www.arninc.com

ARCHITECTURE  
ENGINEERING  
PLANNING  
INTERIORS  
ENERGY

**SMRT**

STATE OF MAINE  
ANDREW D. BRADLEY  
No. 9840  
LICENSED PROFESSIONAL ENGINEER

PROJECT NORTH:

PROJECT NORTH

PORTLAND MUSEUM OF ART  
ROBERT INDIANA "SEVEN" PEDESTAL  
PORTLAND, MAINE

ISSUED FOR CONSTRUCTION  
10-08-14

CURRENT ISSUE STATUS:

REV	DATE	DESCRIPTION
0	10-08-14	ISSUED FOR CONSTRUCTION

GRAPHIC SCALE:  
0" = 1'

SCALE: AS NOTED

PROJECT MANAGER: ADB

JC/DRAWN BY: ADB/SJF

A/E OF RECORD: ADB

PROJECT NO.: 14142

SMRT FILE: S-201-14142

DATE:

SHEET TITLE:  
**VENEER ELEVATIONS AND LAYOUT**

SHEET No.  
**S-201**

© COPYRIGHT 2014 SMRT INC.