

FIRST FLOOR DEMOLITION PLAN
 SCALE: 1/4" = 1'-0"
 0 4'-0"

DEMOLITION NOTES

1. REMOVE WALLS AS NOTED ON PLANS. VERIFY THAT WALLS TO BE REMOVED ARE NON-LOAD BEARING. NOTIFY THE ARCHITECT OF ANY DISCREPANCIES. BEFORE PENETRATION OF JOISTS, BEAMS OR OTHERS STRUCTURAL MEMBERS, CONSULT WITH THE ARCHITECT FOR APPROVAL.
2. UNLESS OTHERWISE NOTED, DOORS, BASE, TRIM, ELECTRICAL ITEMS, AND SURFACE MOUNTED ITEMS TO BE REMOVED. UNLESS NOTED OTHERWISE, REMOVE WALLS TO THEIR FULL HEIGHT WHERE THEY ARE INDICATED FOR REMOVAL.
3. CARE SHALL BE TAKEN BY THE CONTRACTOR TO PROTECT EXISTING SYSTEMS AND SURFACES TO REMAIN. ALL DAMAGE RESULTING FROM THE CONTRACTOR'S OPERATIONS SHALL BE REPAIRED OR REPLACED AS APPROVED BY THE ARCHITECT AT NO ADDITIONAL COST TO THE OWNER.
4. WHERE REMOVALS OCCUR, PATCH HOLES AND AREAS OF MISSING FINISHES (I.E. EXPOSED STUD AREAS WHERE WALLS ARE REMOVED, FLOOR FINISHES, ETC.) TO MATCH EXISTING ADJACENT SURFACES. PROVIDE A SMOOTH AND CONTINUOUS SURFACE FREE OF SHADOW LINES.
5. WHERE NEW WALLS OR INFILLS ABUT OR INTERSECT EXISTING WALLS, ALIGN NEW FINISH WITH EXISTING FINISH AND FINISH JOINTS AT INTERSECTIONS SMOOTH AND CONTINUOUS.
6. THE CONTRACTOR SHALL NOTIFY THE ARCHITECT IMMEDIATELY FOR TESTING AND/OR REMOVAL OF HAZARDOUS MATERIALS. ANY ASBESTOS REMOVAL NECESSARY FOR THE SAFE IMPLEMENTATION OF THIS PROJECT SHALL BE CONTRACTED DIRECTLY BY THE OWNER. IF NECESSARY, THE CONTRACTOR SHALL COORDINATE WITH THESE EFFORTS IF ENCOUNTERED.
7. UNLESS OTHERWISE NOTED, ALL ITEMS ON DEMOLITION PLANS ARE EXISTING.
8. COORDINATE REMOVALS OF EXISTING BEVERAGE STATION, RECEPTIONIST DESK, AND FURNISHINGS WITH OWNER.

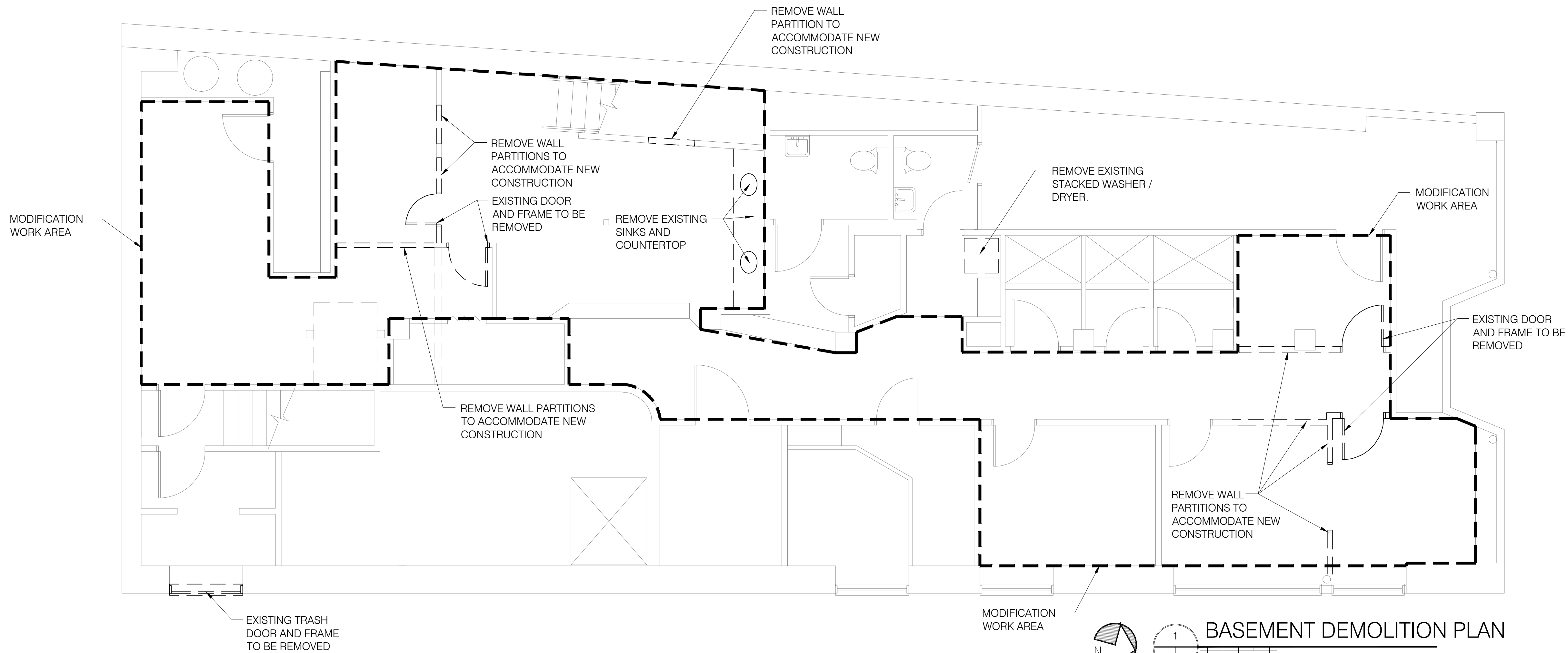

BASEMENT DEMOLITION PLAN
 SCALE: 1/4" = 1'-0"
 0 4'-0"

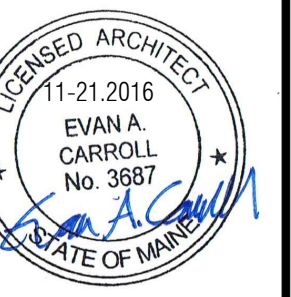

REVISIONS

1	
2	
3	
4	
5	