

DISPLAY THIS CARD ON PRINCIPAL FRONTAGE OF WORK
CITY OF PORTLAND

Please Read
Application And
Notes, If Any,
Attached

BUILDING INSPECTION

PERMIT

Permit Number: 040732

PERMIT ISSUED

JUL 12 2004

CITY OF PORTLAND

This is to certify that Children's Museum Of Maine childrens

has permission to move existing shiv to backyard of museum

AT 142 Free St

039 B003001

provided that the person or persons, firm or corporation accepting this permit shall comply with all of the provisions of the Statutes of Maine and of the ordinances of the City of Portland regulating the construction, maintenance and use of buildings and structures, and of the application on file in this department.

Apply to Public Works for street line and grade if nature of work requires such information.

Verification inspection must
give and written permission procured
before this building or part thereof
altered or enclosed-in.
-4- R NOTICE IS REQUIRED.

A certificate of occupancy must be
procured by owner before this building
or part thereof is occupied.

OTHER REQUIRED APPROVALS

Fire Dept. 6/24/04

Health Dept. _____

Appeal Board _____

Other _____
Department Name

[Signature] 6/24/04
Director - Building & Inspection Services

PENALTY FOR REMOVING THIS CARD

[Faint, illegible text at the bottom of the page]

City of Portland, Maine - Building or Use Permit Application
389 Congress Street, 04101 Tel: (207) 874-8703, Fax: (207) 874-8716

PERMIT ISSUED

Permit No: 04-0733		Issue Date: JUL 12 2004		CBL: 039 B003001					
Location of Construction: 142 Free St		Owner Name: Children's Museum Of Maine		Owner Address: Po Box 4041 CITY OF PORTLAND		Phone: 8281234			
Business Name:		Contractor Name: Childrens Museum		Contractor Address: 142 Free St Portland		Phone: 2078285723			
Lessee/Buyer's Name		Phone:		Permit Type: Alterations - Commercial			Zone: B-3		
Past Use: museum		Proposed Use: move existing ship to backyard of museum		Permit Fee: \$30.00		Cost of Work: \$500.00		CEO District: 1	
move existing ship to backyard of museum				FIRE DEPT: <input checked="" type="checkbox"/> Approved <input type="checkbox"/> Denied		INSPECTION: Use Group Type 2/1 6/24/04 Signature: [Signature]			
				Action: <input type="checkbox"/> Approved <input type="checkbox"/> Approved w/Conditions <input type="checkbox"/> Denied					
				Signature: Date:					
Permit Taken By: jodinea		Date Applied For: 06/03/2004		Zoning Approval					

<div>1. This permit application does not preclude the Applicant(s) from meeting applicable State and Federal Rules.</div> <div>2. Building permits do not include plumbing, septic or electrical work.</div> <div>3. Building permits are void if work is not started within six (6) months of the date of issuance. False information may invalidate a building permit and stop all work..</div>	<div>Special Zone or Reviews</div> <div><input type="checkbox"/> Shoreland</div> <div><input type="checkbox"/> Wetland</div> <div><input type="checkbox"/> Flood Zone</div> <div><input type="checkbox"/> Subdivision</div> <div><input checked="" type="checkbox"/> Site Plan Site plan to be submitted Maj <input type="checkbox"/> Minor <input type="checkbox"/> MM <input type="checkbox"/></div> <div>OK 6/9/04 date:</div>	<div>Zoning Appeal</div> <div><input type="checkbox"/> Variance</div> <div><input type="checkbox"/> Miscellaneous</div> <div><input type="checkbox"/> Conditional Use</div> <div><input type="checkbox"/> Interpretation</div> <div><input type="checkbox"/> Approved</div> <div><input type="checkbox"/> Denied</div> <div>date:</div>	<div>Historic Preservation</div> <div><input type="checkbox"/> Not in District or Landmarl</div> <div><input checked="" type="checkbox"/> Does Not Require Review (Imp. Structure)</div> <div><input type="checkbox"/> Requires Review</div> <div><input checked="" type="checkbox"/> Approved</div> <div><input type="checkbox"/> Approved w/Conditions</div> <div><input type="checkbox"/> Denied to D.A.</div> <div>late:</div>
	D. Anderson 3 6/14/04		

CERTIFICATION

I hereby certify that I am the owner of record of the named property, or that the proposed work is authorized by the owner of record and that I have been authorized by the owner to make this application as his authorized agent and I agree to conform to all applicable laws of this jurisdiction. In addition, if a permit for work described in the application is issued, I certify that the code official's authorized representative shall have the authority to enter all areas covered by such permit at any reasonable hour to enforce the provision of the code(s) applicable to such permit.

SIGNATURE OF APPLICANT	ADDRESS	DATE	PHONE
RESPONSIBLE PERSON IN CHARGE OF WORK, TITLE		DATE	PHONE

City of Portland, Maine - Building or Use Permit

389 Congress Street, 04101 Tel: (207) 874-8703, Fax: (207) 874-8716

Permit No: 04-0733			Date Applied For: 06/03/2004			CBL: 039 B003001					
Location of Construction: 142 Free St			Owner Name: Children's Museum Of Maine			Owner Address: Po Box 4041			Phone: () 828-1234		
Business Name:			Contractor Name: Childrens Museum			Contractor Address: 142 Free St Portland			Phone (207) 828-5723		
Lessee/Buyer's Name			Phone:				Permit Type: Alterations - Commercial				
Proposed Use: move existing ship to backyard of museum					Proposed Project Description: move existing ship to backyard of museum						
Dept: Historical			Status: Approved			Reviewer: Deborah Andrews			Approval Date: 06/14/2004		
Note:									Ok to Issue: <input checked="" type="checkbox"/>		
Dept: Zoning			Status: Approved			Reviewer: Marge Schmuckal			Approval Date: 06/09/2004		
Note: Sarah has site plan exemption									Ok to Issue: <input checked="" type="checkbox"/>		
Dept: Building			Status: Approved			Reviewer: Mike Nugent			Approval Date: 06/24/2004		
Note:									Ok to Issue: <input checked="" type="checkbox"/>		
1) The "Ship" is considered playground equipment and not subject to BOCA requirements.											
Dept: Fire			Status: Approved			Reviewer: Lt. MacDougal			Approval Date: 06/24/2004		
Note:									Ok to Issue: <input type="checkbox"/>		



Portland Museum of Art

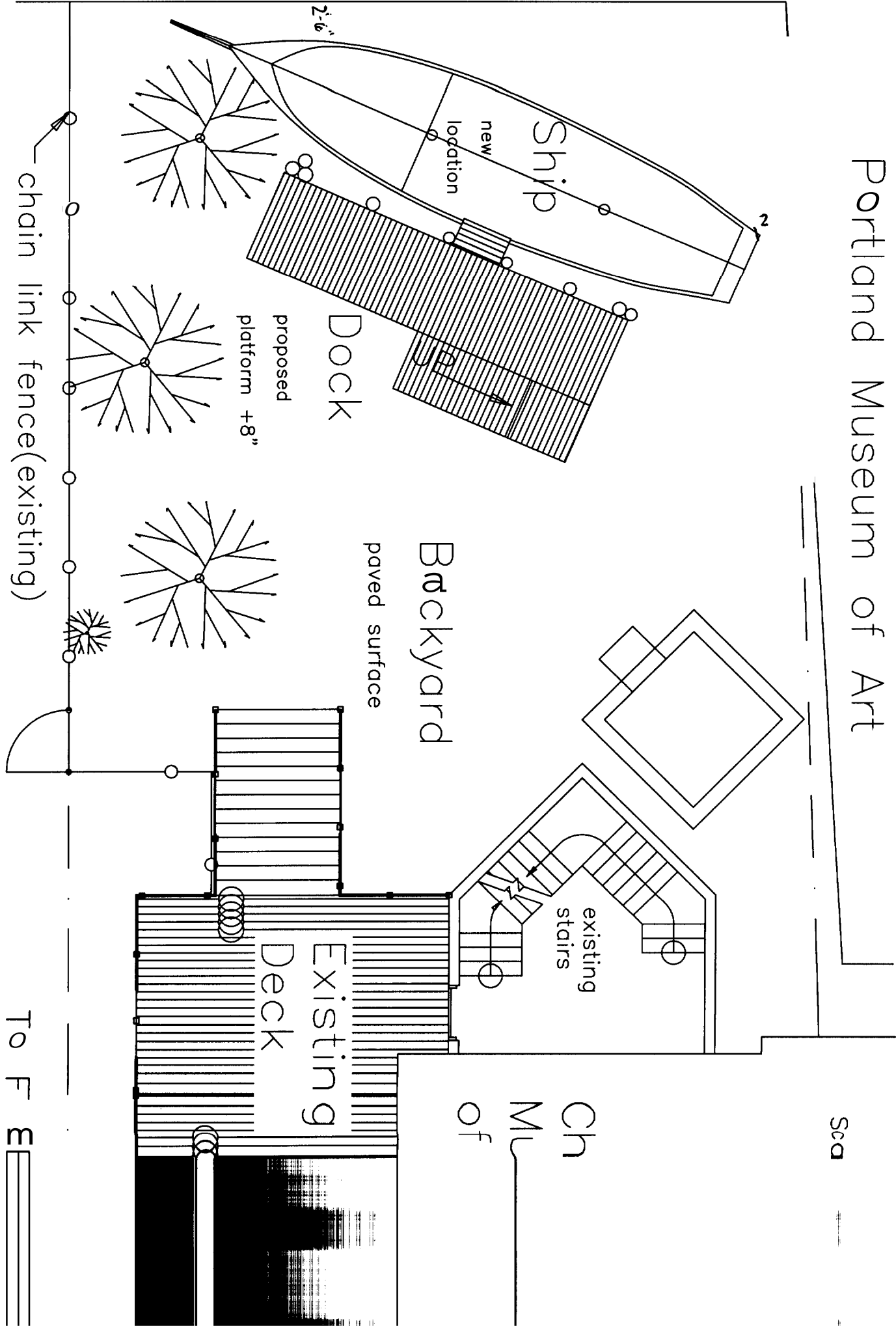

Holiday Parking Lot

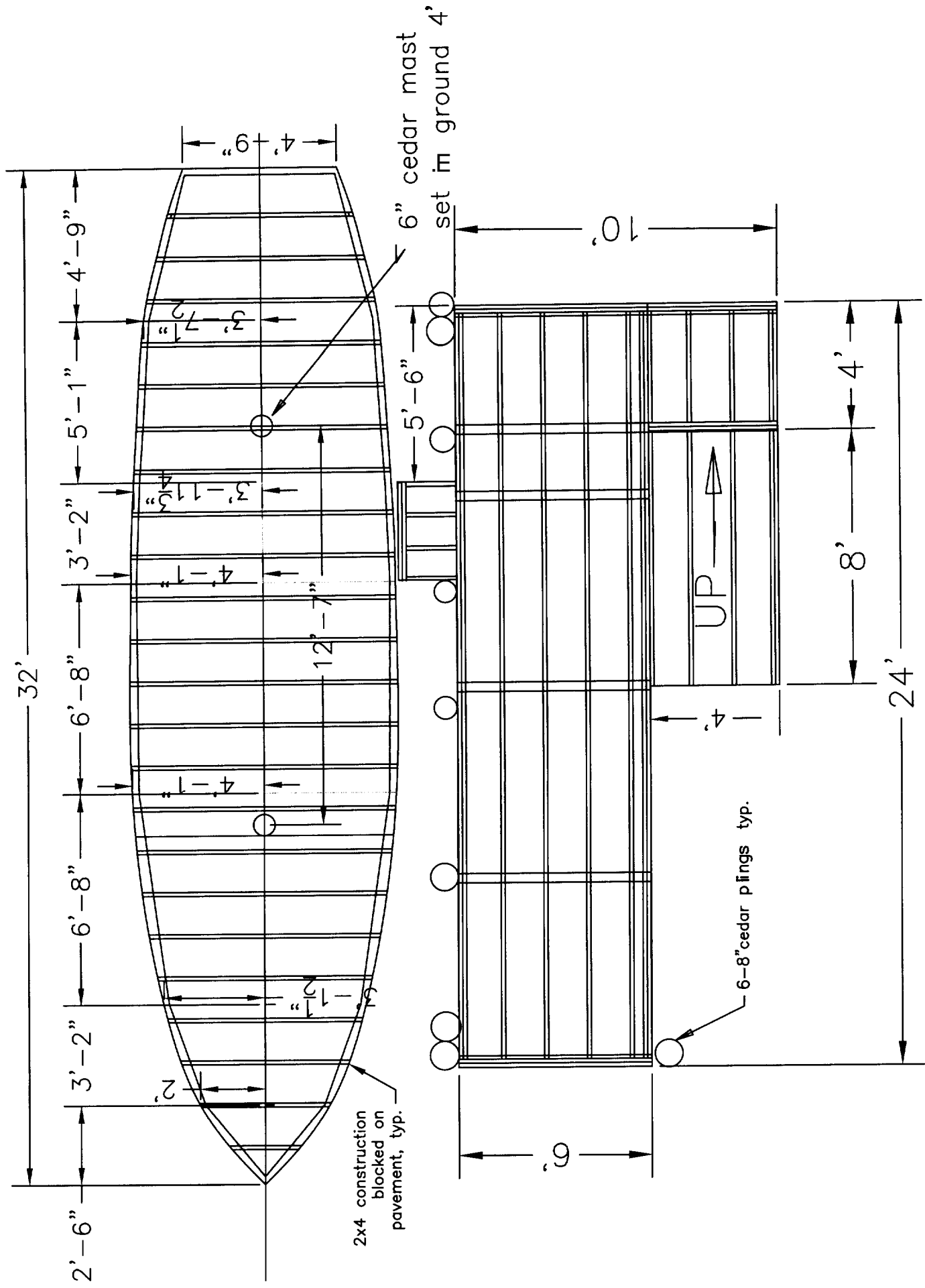

Ship framing plan Scale 1/4"=1'-0"



Commercial Building Permit Application

If you or the property owner owes real estate or personal property taxes or user charges on any property within the City, payment arrangements must be made before permits of any kind are accepted.

Location/Address of Construction: 142 FREE ST.		
Total Square Footage of Proposed Structure N/A Existing 17,250		Square Footage of Lot 9965
Tax Assessor's Chart, Block & Lot Chart# 039 Block# B Lot# 003		Owner: CHILDREN'S MUSEUM OF MAINE Telephone: 828 1234
Lessee/Buyer's Name (If Applicable)	Applicant name, address & telephone: Brewster Buttfield Children's Museum of Maine 142 FREE ST PORTLAND 828 5723 x240	Cost Of Work: \$ 500. Fee: \$ 300.00
Current Specific use: Museum		
Proposed Specific use: Same		
Project description: Move existing Ship to backyard.		
Contractor's name, address & telephone: Children's Museum		
Who should we contact when the permit is ready: Brewster Buttfield		
Mailing address: 142 Free St. 04101		
Phone: 828 5723 x240		

Please submit all of the information outlined in the Residential Application Checklist. Failure to do so will result in the automatic denial of your permit.

At the discretion of the Planning and Development Department, additional information may be required prior to permit approval. For further information stop by the Building Inspections office, room 315 City Hall or call 874 8703.

I hereby certify that I am the Owner of record of the named property, or that the owner of record authorizes the proposed work and that I have been authorized by the owner to make this application as his/her authorized agent. I agree to conform to all applicable laws of this jurisdiction. In addition, if a permit for work described in this application is issued, I certify that the Code Official's authorized representative shall have the authority to enter all areas covered by this permit at any reasonable hour to enforce the provisions of the codes applicable to this permit.

Signature of applicant: <i>Chyenne J. Olsen</i>	Date: 6/2/04
---	--------------

Permit Fee: \$30.00 for the first \$1000.00 Construction Cost, \$9.00 per additional \$1000.00 cost

This is not a Permit; you may not commence any work until the Permit is issued.

BUILDING PERMIT INSPECTION PROCEDURES

Please call **874-8703** or **874-8693** to schedule your inspections as agreed upon

Permits expire in 6 months, if the project is not started or ceases for 6 months.

The Owner or their designee is required to notify the inspections office for the following inspections and provide adequate notice. Notice must be called in 48-72 hours in advance in order to schedule an inspection:

By initializing at each inspection time, you are agreeing that you understand the inspection procedure and additional fees from a "Stop Work Order" and "Stop Work Order Release" will be incurred if the procedure is not followed as stated below.

A Pre-construction Meeting will take place upon receipt of your building permit.

<input checked="" type="checkbox"/> Footing/Building Location Inspection;	Prior to pouring concrete
<input checked="" type="checkbox"/> Re-Bar Schedule Inspection:	Prior to pouring concrete
<input checked="" type="checkbox"/> Foundation Inspection:	Prior to placing ANY backfill
<input checked="" type="checkbox"/> Framing/Rough Plumbing/Electrical:	Prior to any insulating or drywalling
<input checked="" type="checkbox"/> Final/Certificate of Occupancy:	Prior to any occupancy of the structure or use. NOTE: There is a \$75.00 fee per inspection at this point.

Certificate of Occupancy is not required for certain projects. Your inspector can advise you if your project requires a Certificate of Occupancy. All projects DO require a final inspection

If any of the inspections do not occur, the project cannot go on to the next phase, REGARDLESS OF THE NOTICE OR CIRCUMSTANCES.

CERTIFICATE OF OCCUPANCIES MUST BE ISSUED AND PAID FOR, BEFORE THE SPACE MAY BE OCCUPIED

Signature of Applicant/Designee

Date

Signature of Inspections Official

Date

CBL: 039-B403

Building Permit #: 040233