



Portland Maine Parcel Viewer

Find address or place

Permitting and Inspections Department
Approved with Conditions

08/14/2018

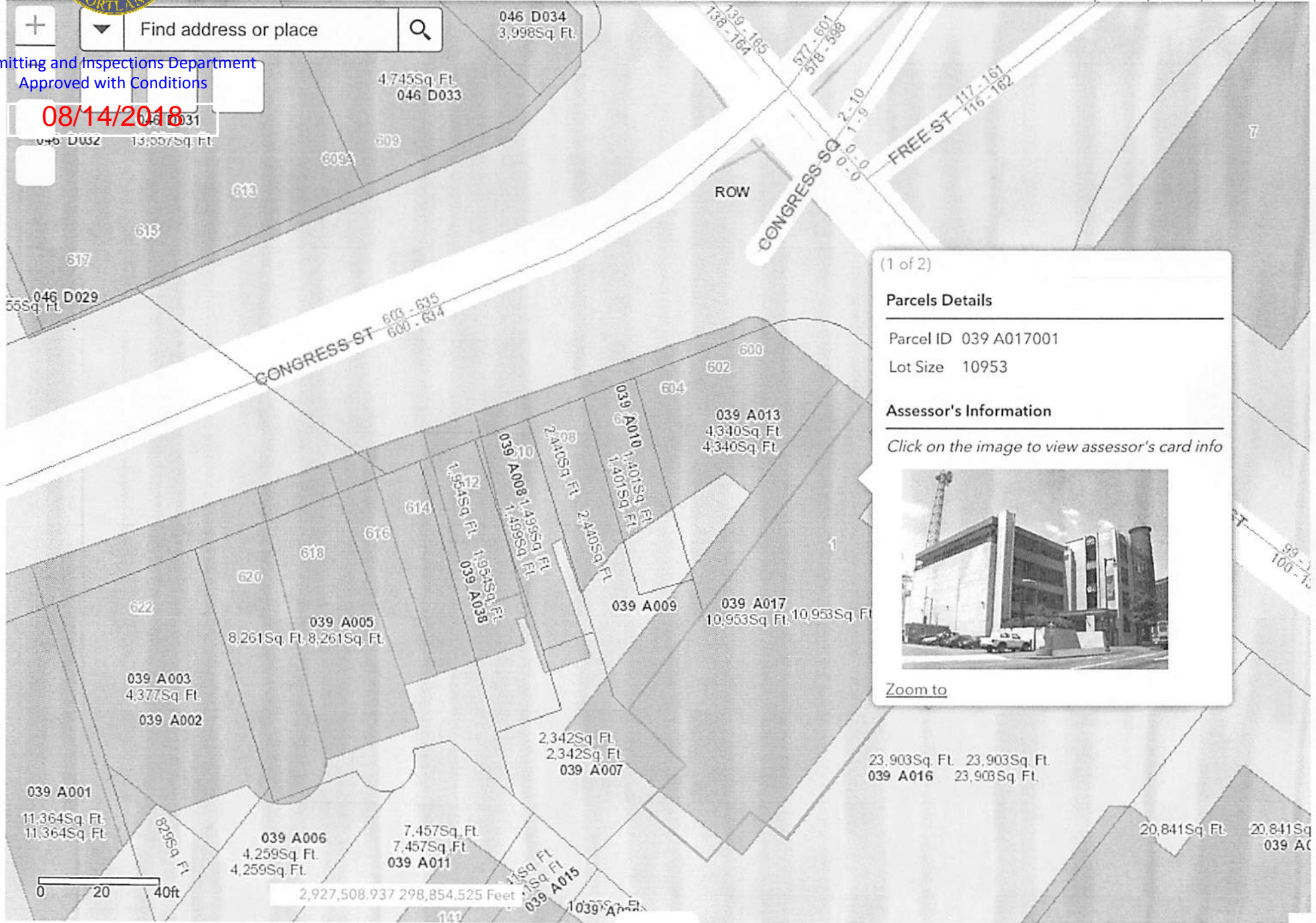

(1 of 2)

Parcels Details

Parcel ID 039 A017001
Lot Size 10953

Assessor's Information

Click on the image to view assessor's card info



[Zoom to](#)

0 20 40ft

2,927,508.937 298,854.525 Feet



This page contains a detailed description of the Parcel ID you selected.

[New Search!](#)

Permitting and Inspections Department
Approved with Conditions

08/14/2018

Services

[Applications](#)

[Doing Business](#)

[Maps](#)

[Tax Relief](#)

[Tax Roll](#)

[Q & A](#)

[browse city services a-z](#)

[browse facts and links a-z](#)



Best viewed at 800x600, with Internet Explorer

Current Owner Information:

CBL	039 A017001
Land Use Type	OFFICE & BUSINESS SERVICE
Verify legal use with Inspections Division	
Property Location	128 HIGH ST
Owner Information	PACIFIC & SOUTHERN COMPANY INC ONE CONGRESS SQ PORTLAND ME 04101
Book and Page	13537/178
Legal Description	39-A-17 HIGH ST 128-132
	10953 SF

Current Rental Registration

Acres 0.2514

Current Assessed Valuation:

TAX ACCT NO.	5912	OWNER OF RECORD AS OF APRIL 2017
LAND VALUE	\$405,800.00	PACIFIC & SOUTHERN COMPANY INC
BUILDING VALUE	\$2,411,700.00	
NET TAXABLE - REAL ESTATE	\$2,817,500.00	ONE CONGRESS SQ PORTLAND ME 04101
TAX AMOUNT	\$60,998.88	

Any information concerning tax payments should be directed to the Treasury office at 874-8490 or [e-mailed](#).

Building Information:

Building 1

Year Built	1968
Style/Structure Type	
# Units	1
Square Feet	40861

[View Sketch](#)

[View Map](#)

[View Picture](#)

Exterior/Interior Information:

Building 1

Levels	B1/B1
Size	5589
Use	PARKING GARAGE
Height	9
Walls	CONC LD BEAR
Heating	NONE
A/C	NONE

Building 1

Levels	B1/B1
Size	2907
Use	SUPPORT AREA
Height	9



Permitting and Inspections Department
Approved with Conditions

08/14/2018

Photo of
Proposed Signage
Banner
used in 2008
and in 2009.

liveandvolunteerportland.org
**GIVE. ADVOCATE.
VOLUNTEER.
LIVE UNITED.**

